

IBERVILLE®

LHTQ®

More Capacity !

(14.5 Cubic Inches)



**BC1304-LHTQ
Gangable**



**BC2304-LHTQ
Welded**

Quick to Install !



Holding Prongs

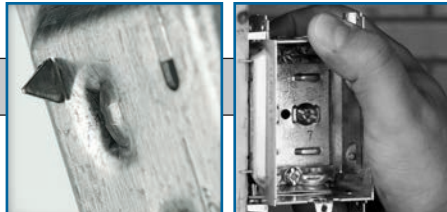

Positioning Guides

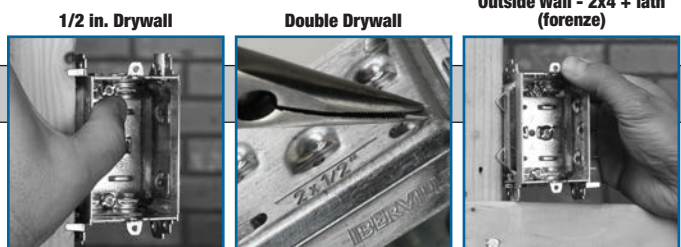

Embossed Mounting Slots



SP® Certified for single center screw mounting

(For single and double gang boxes.)

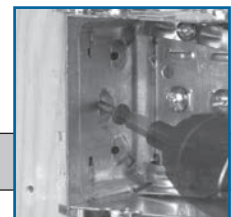

Check out our installation video for more features and benefits.

www.tnb.ca/video

www.tnb.ca

Thomas & Betts
A Member of the ABB Group

LHTQ FAMILY DEVICE BOXES



BC1018-LHTQ



BC1304-LHTQ



BC3104-LHTQ



BC2004-LHTQ



BC2304-LHTQ



BC2304-LHTQ-2



BC2304-LHTQ-3

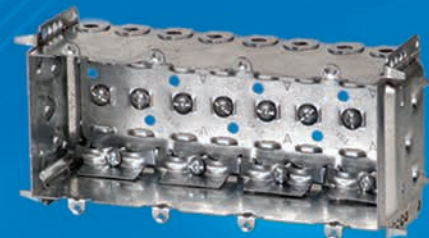

BC2304-LHTQ-4

LHTQ X-Ref

| Cat. No | Capacity (cu. in.) | LHTQ Family | Capacity (cu. in.) | Dimensions H x W x D (in.) |
|--------------|--------------------|---|--------------------|----------------------------|
| BC1104-LHT | 12.5 | BC1304-LHTQ BC1304-LHATQ (clamp for armoured cables) | 14.5 | 3 x 2 x 2-1/2 |
| BC2104-LLE | 12.5 | BC2304-LHTQ | 14.5 | 3 x 2 x 2-1/2 |
| BC2104-LLE-2 | 25 | BC2304-LHTQ-2 | 27 | 3 x 3-3/4 x 2-1/2 |
| BC2104-LLE-3 | 37.5 | BC2304-LHTQ-3 | 39.5 | 3 x 5-1/2 x 2-1/2 |
| BC2104-LLE-4 | 50 | BC2304-LHTQ-4 | 52 | 3 x 7-3/8 x 2-1/2 |
| BC1004-LH | 15 | BC1018-LHTQ | 18 | 3 x 2 x 3 |
| BC2004-LH | 18.5 | BC2004-LHTQ | 20.5 | 3-3/4 x 2-3/16 x 2-3/4 |
| BC3104-LH | 16 | BC3104-LHTQ | 16 | 3 x 2 x 2-1/2 |