

## Two-Bolt Connectors without Spacer

### Type 2B — Two-Bolt Connectors without Spacer

- Castings and bolts of high-strength copper alloy
- Removable neoprene washers capture each bolt in bottom casting, aiding installation
- CSA Certified and UL Listed

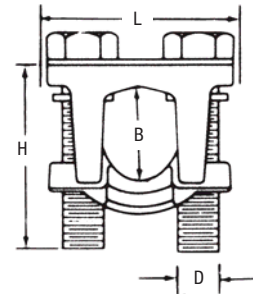

| Cat. No.      | Conductor Range (AWG or kcmil) |           |            |         | Conductor Diameter (B) |       | Bolt Head (in.) | Dimensions (in.) |       |      |
|---------------|--------------------------------|-----------|------------|---------|------------------------|-------|-----------------|------------------|-------|------|
|               | Main                           |           | Tap        |         | max.                   | min.  |                 | L                | H     | D    |
|               | max.                           | min.      | max.       | min.    |                        |       |                 |                  |       |      |
| <b>2B10</b>   | 1/0 str.                       | 2 str.    | 1/0 str.   | 10 sol. | 0.746                  | 0.394 | 1/2             | 1-5/16           | 1-3/4 | 5/16 |
| <b>2B20BB</b> | 2/0 str.                       | 2 str.    | 2/0 str.   | 8 sol.  | 0.838                  | 0.420 | 1/2             | 1-5/16           | 1-1/4 | 5/16 |
| <b>2B40</b>   | 4/0 str.                       | 1/0 str.  | 4/0 str.   | 6 sol.  | 1.056                  | 0.530 | 9/16            | 1-23/32          | 1-3/4 | 3/8  |
| <b>2B350</b>  | 350 kcmil                      | 4/0 str.  | 350 kcmil  | 4 sol.  | 1.362                  | 0.726 | 3/4             | 2-1/8            | 2     | 1/2  |
| <b>2B500</b>  | 500 kcmil                      | 350 kcmil | 500 kcmil  | 4 sol.  | 1.626                  | 0.883 | 3/4             | 2-1/4            | 2-1/2 | 1/2  |
| <b>2B800</b>  | 800 kcmil                      | 600 kcmil | 800 kcmil  | 2 sol.  | 2.062                  | 1.149 | 3/4             | 2-1/2            | 2-1/2 | 1/2  |
| <b>2B1000</b> | 1000 kcmil                     | 750 kcmil | 1000 kcmil | 2 sol.  | 2.304                  | 1.255 | 15/16           | 2-31/32          | 2-3/4 | 5/8  |

U.L. 486A

### Type 2B — One-Piece Two-Bolt Connectors without Spacer

- Castings and bolts of high-strength copper alloy
- One-piece construction
- Free bolt is held in place with neoprene washer during installation
- One extra length bolt allows top casting to swing free over two conductors of maximum range
- CSA Certified and UL Listed

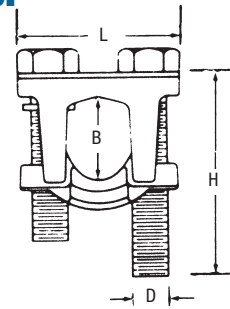

| Cat. No.       | Conductor Range (AWG or kcmil) |           |            |         | Conductor Diameter (B) |       | Bolt Head (in.) | Dimensions (in.) |       |      |
|----------------|--------------------------------|-----------|------------|---------|------------------------|-------|-----------------|------------------|-------|------|
|                | Main                           |           | Tap        |         | max.                   | min.  |                 | L                | H     | D    |
|                | max.                           | min.      | max.       | min.    |                        |       |                 |                  |       |      |
| <b>2B10X</b>   | 1/0 str.                       | 2 str.    | 1/0 str.   | 10 sol. | 0.746                  | 0.394 | 1/2             | 1-5/16           | 1-1/2 | 5/16 |
| <b>2B20X</b>   | 2/0 str.                       | 2 str.    | 2/0 str.   | 8 sol.  | 0.838                  | 0.420 | 1/2             | 1-5/16           | 1-1/2 | 5/16 |
| <b>2B40X</b>   | 4/0 str.                       | 1/0 str.  | 4/0 str.   | 6 sol.  | 1.056                  | 0.530 | 9/16            | 1-23/32          | 1-7/8 | 3/8  |
| <b>2B350X</b>  | 350 kcmil                      | 4/0 str.  | 350 kcmil  | 4 sol.  | 1.362                  | 0.726 | 3/4             | 2-1/8            | 2-1/4 | 1/2  |
| <b>2B500X</b>  | 500 kcmil                      | 350 kcmil | 500 kcmil  | 4 sol.  | 1.626                  | 0.883 | 3/4             | 2-1/4            | 2-1/2 | 1/2  |
| <b>2B800X</b>  | 800 kcmil                      | 600 kcmil | 800 kcmil  | 2 sol.  | 2.062                  | 1.149 | 3/4             | 2-1/2            | 2-3/4 | 1/2  |
| <b>2B1000X</b> | 1000 kcmil                     | 750 kcmil | 1000 kcmil | 2 sol.  | 2.304                  | 1.255 | 15/16           | 2-31/32          | 3-1/4 | 5/8  |

U.L. 486A