

# T&B Conduit Fittings

## Flexible Cord and Cable Fittings

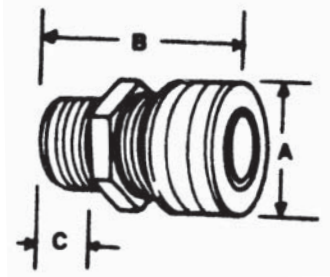

Body and gland nut are aluminum.



### Aluminum Liquidtight Strain Relief Fittings— Straight



Cat. No.	Hub Size	Throat Diam.	Cord Range	Dimensions (in.)		
				A	B	C
2920AL	1/2	9/16	.125-.375	1-1/8	1-3/4	5/8
2921AL	1/2	9/16	.310-.560	1-1/8	1-3/4	5/8
2922AL*	1/2	9/16	.500-.750	1-5/16	1-3/4	5/8
2930AL	3/4	13/16	.125-.375	1-5/16	1-25/32	3/8
2931AL	3/4	13/16	.310-.560	1-5/16	1-25/32	3/4
2932AL	3/4	13/16	.500-.750	1-5/16	1-25/32	3/4
2940AL	1	1-1/16	.310-.560	1-5/16	1-3/4	1-1/16
2941AL	1	1-1/16	.500-.750	1-5/16	1-3/4	1-1/16
2942AL	1	31/32	.700-.950	1-9/16	1-7/8	31/32

\* It may be necessary to remove sufficient outer covering of cable to permit conductors to pass through fitting body.

### Aluminum Liquidtight Strain Relief Fittings— 90° Elbow

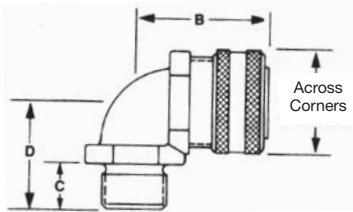

Body: malleable iron  
Gland Nut: aluminum

Cat. No.	Trade or Hub Size	Throat Diam.	Cord Range	Dimensions (in.)			
				A	B	C	D
4960AL	1/2	9/16	.125-.375	1-1/8	1-3/4	5/8	1-5/16
4961AL	1/2	9/16	.360-.560	1-1/8	1-3/4	5/8	1-5/16
4962AL*	1/2	9/16	.500-.750	1-5/16	1-23/64	5/8	1-3/8
4970AL	3/4	25/32	.125-.375	1-5/16	1-25/32	11/16	1-15/32
4971AL	3/4	25/32	.310-.560	1-5/16	1-25/32	11/16	1-15/32
4972AL	3/4	25/32	.500-.750	1-5/16	1-25/32	11/16	1-15/32
4980AL	1	15/16	.310-.560	1-5/16	2-1/32	13/16	1-3/4
4981AL	1	15/16	.500-.750	1-5/16	2-1/32	13/16	1-3/4
4982AL	1	15/16	.700-.950	1-9/16	2-11/16	13/16	2

\* It may be necessary to remove sufficient outer covering of cable to permit conductors to pass through fitting body.