

# T&B Conduit Fittings

## Flexible Cord and Cable Fittings

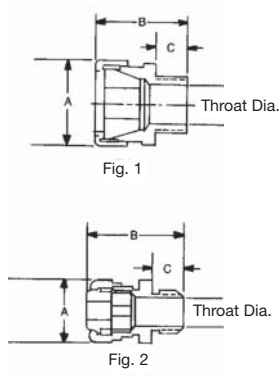

### Liquidtight Strain Relief Fittings



Cat. No.	Cable Size Range min.-max.	Hub Size	Throat Dia. (min.)	Fig.	Dimensions (in.)		
					A	B	C
2516 <sup>†</sup>	(.060-.125)	1/4"	23/64"	2	53/64	1-7/16	15/32
2517 <sup>†</sup>	(.120-.250)	1/4"	23/64"	2	53/64	1-7/16	15/32
2518 <sup>†</sup>	(.060-.150)	3/8"	29/64"	2	31/32	1-1/2	15/32
2519 <sup>**</sup>	(.150-.300)	3/8"	29/64"	2	31/32	1-1/2	15/32
2520	(.125-.250)	1/2"	9/16"	1	1-5/32	1-11/16	5/8
2521	(.250-.375)	1/2"	9/16"	1	1-5/32	1-11/16	5/8
2522	(.375-.500)	1/2"	9/16"	1	1-5/32	1-11/16	5/8
2523	(.450-.560)	1/2"	9/16"	1	1-5/32	1-11/16	5/8
2524 <sup>*</sup>	(.500-.625)	1/2"	5/8"	1	1-3/8	1-3/4	5/8
2525 <sup>*</sup>	(.625-.750)	1/2"	5/8"	1	1-3/8	1-3/4	5/8
2530	(.125-.250)	3/4"	13/16"	1	1-3/8	1-3/4	9/16
2531	(.250-.375)	3/4"	13/16"	1	1-3/8	1-3/4	9/16
2532	(.375-.500)	3/4"	13/16"	1	1-3/8	1-3/4	9/16
2534	(.500-.625)	3/4"	13/16"	1	1-3/8	1-3/4	9/16
2535	(.625-.750)	3/4"	13/16"	1	1-3/8	1-3/4	9/16
2536 <sup>*</sup>	(.750-.880)	3/4"	3/4"	1	1-11/16	1-15/16	5/8
2541	(.250-.375)	1"	49/64"	1	1-3/8	1-23/32	9/16
2542	(.375-.500)	1"	49/64"	1	1-3/8	1-23/32	9/16
2544	(.500-.625)	1"	49/64"	1	1-3/8	1-23/32	9/16
2545	(.625-.750)	1"	49/64"	1	1-3/8	1-23/32	9/16
2546	(.750-.875)	1"	63/64"	1	1-11/16	1-7/8	23/32
2547	(.875-.985)	1"	63/64"	1	1-11/16	1-7/8	9/16
2548 <sup>*</sup>	(.880-1.065)	1"	29/32"	1	2-3/32	2-3/8	25/32
2549 <sup>*</sup>	(1.065-1.205)	1"	29/32"	1	2-3/32	2-3/8	25/32
2558	(.880-1.065)	1-1/4"	1-17/64"	1	2-3/32	2-5/32	13/16
2559	(1.065-1.205)	1-1/4"	1-17/64"	1	2-3/32	2-5/32	13/16
2556 <sup>*</sup>	(1.187-1.375)	1-1/4"	1-1/4"	1	2-11/32	2-1/2	13/16
2557 <sup>*</sup>	(1.375-1.485)	1-1/4"	1-1/4"	1	2-11/32	2-1/2	13/16
2562	(.812-1.000)	1-1/2"	1-7/16"	1	2-11/32	2-1/2	11/16
2563	(1.000-1.187)	1-1/2"	1-7/16"	1	2-11/32	2-7/16	11/16
2564	(1.187-1.375)	1-1/2"	1-7/16"	1	2-11/32	2-7/16	11/16
2565 <sup>*</sup>	(1.375-1.625)	1-1/2"	1-29/64"	1	2-13/16	2-5/8	13/16
2573	(1.125-1.375)	2"	1-7/8"	1	2-13/16	2-5/8	13/16
2574	(1.375-1.625)	2"	1-7/8"	1	2-13/16	2-5/8	11/16
2575	(1.625-1.875)	2"	1-7/8"	1	2-13/16	2-5/8	11/16
2576 <sup>*</sup>	(1.750-1.965)	2"	1-29/32"	1	3-7/32	3-1/2	27/32
2577 <sup>*</sup>	(1.937-2.187)	2"	1-29/32"	1	3-7/32	3-1/2	27/32
2584	(1.750-1.965)	2-1/2"	2"	1	3-7/32	3-3/4	1-1/32
2585 <sup>*</sup>	(1.937-2.187)	2-1/2"	2"	1	3-7/32	3-3/4	1-1/32
2586 <sup>*</sup>	(2.156-2.360)	2-1/2"	2-5/32"	1	3-15/16	4-1/4	1-1/32
2587 <sup>*</sup>	(2.350-2.565)	2-1/2"	2-5/32"	1	3-15/16	4-1/4	1-1/32
2592	(2.156-2.360)	3"	2-13/32"	1	3-15/16	4-1/4	1-1/32
2593	(2.350-2.565)	3"	2-13/32"	1	3-15/16	4-1/4	1-1/32
2594	(2.535-2.750)	3"	2-13/32"	1	3-15/16	4-1/4	1-1/32
2595 <sup>*</sup>	(2.735-2.985)	3"	2-13/16"	1	4-11/16	4-13/16	1-1/8
2596 <sup>*</sup>	(2.970-3.220)	3"	2-13/16"	1	4-11/16	4-13/16	1-1/8

\* Remove sufficient outer covering of cable to permit conductors to pass thru fitting body.

<sup>†</sup> U.L. not applicable.

\*\* Not CSA Certified.

Complies with JIC standards.

U.L. Listed as liquidtight strain relief, and outlet bushing. CSA certified watertight when used with 5262 Series Sealing Ring Gasket (Sold separately).

Temperature rating: 105°C.

For Wiremesh Grips refer to page 80.



5262 Series  
Sealing Ring Gasket  
sold separately

# T&B Conduit Fittings

## Flexible Cord and Cable Fittings

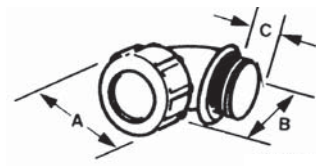

**Swing Radius**  
90° with neoprene bushings, tapered hub threads, malleable iron.

### Strain Relief Fittings

Cat. No.	Cable Size min.-max.	Hub Size	Dimensions (in.)			Throat Dia.
			A	B	C	
<b>2267</b>	(.125-.250)	1/2"	1-5/32	1-23/32	5/8	19/32
<b>2268</b>	(.250-.375)	1/2"	1-5/32	1-23/32	5/8	19/32
<b>2269</b>	(.375-.500)	1/2"	1-5/32	1-23/32	5/8	19/32
<b>2270</b>	(.450-.560)	1/2"	1-5/32	1-23/32	5/8	19/32
<b>2250*</b>	(.500-.625)	1/2"	1-3/8	1-11/16	9/16	39/64
<b>2251*</b>	(.625-.750)	1/2"	1-3/8	1-11/16	9/16	39/64
<b>2252</b>	(.125-.250)	3/4"	1-3/8	1-3/4	41/64	25/32
<b>2271</b>	(.250-.375)	3/4"	1-3/8	1-5/8	41/64	25/32
<b>2272</b>	(.375-.500)	3/4"	1-3/8	1-5/8	41/64	25/32
<b>2273</b>	(.500-.625)	3/4"	1-3/8	1-5/8	41/64	25/32
<b>2274*</b>	(.620-.750)	3/4"	1-3/8	1-5/8	41/64	25/32
<b>2253*</b>	(.750-.880)	3/4"	1-11/16	1-31/32	9/16	25/32
<b>2254</b>	(.375-.500)	1"	1-3/8	2	13/16	1
<b>2255</b>	(.500-.625)	1"	1-3/8	2	13/16	1
<b>2256*</b>	(.625-.750)	1"	1-3/8	2	13/16	1
<b>2275</b>	(.750-.875)	1"	1-11/16	2	13/16	1
<b>2276</b>	(.875-.985)	1"	1-11/16	2	13/16	1
<b>2257*</b>	(.880-1.065)	1"	2-3/32	2-21/32	25/32	15/16
<b>2258*</b>	(1.065-1.205)	1"	2-3/32	2-21/32	25/32	15/16
<b>2277</b>	(.880-1.065)	1-1/4"	2-3/32	2-7/8	27/32	1-5/16
<b>2278</b>	(1.065-1.205)	1-1/4"	2-3/32	2-7/8	27/32	1-5/16
<b>2279*</b>	(1.187-1.375)	1-1/4"	2-11/32	2-13/16	13/16	1-11/32
<b>2280*</b>	(1.375-1.485)	1-1/4"	2-11/32	2-13/16	13/16	1-11/32
<b>2281</b>	(.812-1.000)	1-1/2"	2-11/32	2-7/8	13/16	1-15/32
<b>2282</b>	(1.000-1.187)	1-1/2"	2-11/32	2-7/8	13/16	1-15/32
<b>2283*</b>	(1.187-1.375)	1-1/2"	2-11/32	2-7/8	13/16	1-15/32
<b>2284</b>	(1.125-1.375)	2"	2-13/16	3-1/4	27/32	1-31/32
<b>2285</b>	(1.375-1.625)	2"	2-13/16	3-1/4	27/32	1-31/32
<b>2286</b>	(1.625-1.875)	2"	2-13/16	3-1/4	27/32	1-31/32

\* Remove sufficient outer covering of cable to permit conductors to pass through fitting body.

Complies with J.I.C. standards and Federal Specs W-F-406B, W-F-408B.

Meets Coast Guard CG293

For Wiremesh Grips refer to page 80.

# T&B Conduit Fittings

## Flexible Cord and Cable Fittings

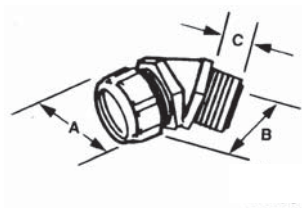

**Swing Radius**  
45° with neoprene bushings, tapered hub threads, malleable iron.

### Strain Relief Fittings

Cat. No.	Cable Size min.-max.	Hub Size	Dimensions (in.)			Throat Dia.
			A	B	C	
<b>2200</b>	(.125-.250)	1/2"	1-5/32	1-9/32	9/16	37/64
<b>2201</b>	(.250-.375)	1/2"	1-5/32	1-9/32	9/16	37/64
<b>2202</b>	(.375-.500)	1/2"	1-5/32	1-9/32	9/16	37/64
<b>2203</b>	(.450-.560)	1/2"	1-5/32	1-9/32	9/16	37/64
<b>2204*</b>	(.500-.625)	1/2"	1-3/8	1-13/32	9/16	37/64
<b>2205*</b>	(.625-.750)	1/2"	1-3/8	1-13/32	9/16	37/64
<b>2206-TB</b>	(.125-.250)	3/4"	1-3/8	1-13/32	5/8	25/32
<b>2207-TB</b>	(.250-.375)	3/4"	1-3/8	1-13/32	5/8	25/32
<b>2208-TB</b>	(.375-.500)	3/4"	1-3/8	1-13/32	5/8	25/32
<b>2209</b>	(.500-.625)	3/4"	1-3/8	1-13/32	5/8	25/32
<b>2210</b>	(.625-.750)	3/4"	1-3/8	1-13/32	5/8	25/32
<b>2211*</b>	(.750-.880)	3/4"	1-11/16	1-1/2	1-1/2	3/4
<b>2213</b>	(.375-.500)	1"	1-3/8	1-1/2	25/32	15/16
<b>2214</b>	(.500-.625)	1"	1-3/8	1-1/2	25/32	15/16
<b>2215</b>	(.625-.750)	1"	1-3/8	1-1/2	25/32	15/16
<b>2216</b>	(.750-.875)	1"	1-11/16	1-15/32	25/32	15/16
<b>2217*</b>	(.875-.985)	1"	1-11/16	1-15/32	25/32	15/16
<b>2218*</b>	(.880-1.065)	1"	2-3/32	1-31/32	25/32	15/16
<b>2219*</b>	(1.065-1.205)	1"	2-3/32	1-31/32	25/32	15/16
<b>2220-TB*</b>	(.880-1.065)	1-1/4"	2-3/32	1-29/32	13/16	1-5/16
<b>2221*</b>	(1.065-1.205)	1-1/4"	2-3/32	1-29/32	13/16	1-5/16
<b>2222*</b>	(1.187-1.375)	1-1/4"	2-11/32	2-1/4	13/16	1-21/64
<b>2223*</b>	(1.375-1.485)	1-1/4"	2-11/32	2-1/4	13/16	1-21/64

\* Remove sufficient outer covering of cable to permit conductors to pass through fitting body.

U.L. Listed as liquidtight strain relief, and outlet bushing.

CSA certified watertight.

For Wiremesh Grips refer to page 80.

# T&B Conduit Fittings

## Flexible Cord and Cable fittings



### CHASE® Liquidtight Cord Fittings

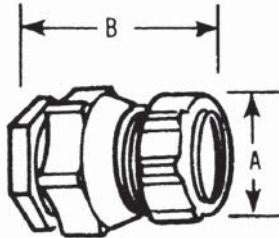
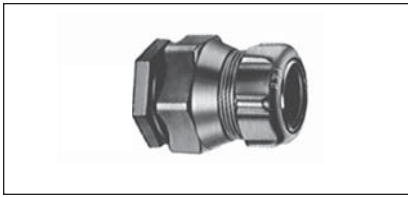

Cat. No.	Cable Size Range min.-max.	Hub Size	Throat Diam.	Dimensions (in.)	
				A	B
<b>2631</b>	(.125-.250)	1/2"	9/16"	1-1/16	1-5/8
<b>2632</b>	(.250-.375)	1/2"	9/16"	1-1/16	1-5/8
<b>2633</b>	(.375-.500)	1/2"	9/16"	1-1/16	1-5/8
<b>2634</b>	(.450-.560)	1/2"	9/16"	1-1/16	1-5/8
<b>2637</b>	(.125-.250)	3/4"	25/32"	1-3/8	1-3/16
<b>2638</b>	(.250-.375)	3/4"	25/32"	1-3/8	1-3/16
<b>2639</b>	(.375-.500)	3/4"	25/32"	1-3/8	1-3/16
<b>2640</b>	(.500-.625)	3/4"	25/32"	1-3/8	1-3/16
<b>2641</b>	(.625-.750)	3/4"	25/32"	1-3/8	1-3/16

CSA certified watertight.U.L. Listed as liquidtight strain relief, and outlet bushing.

Temperature Rating: 105°C.

Chase Liquidtight Cord Fittings are ideal for installation where space is limited inside the enclosure.

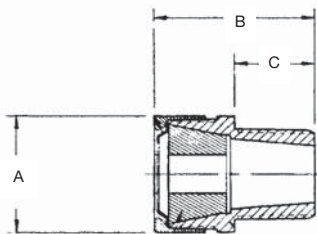
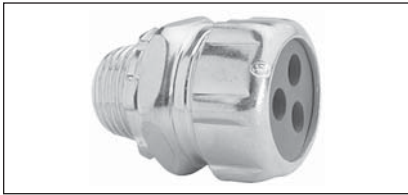

### Multi-Hole Cord Grip

Cat. No.	Hub Size	No. of Diam.	Cord Diam.	Dimensions (in.)		
				A	B	C
<b>2520-2</b>	1/2"	2	.220	1.125	1.687	.625
<b>2530-2</b>	3/4"	2	.220	1.375	1.750	.625
<b>2531-2</b>	3/4"	2	.260	1.375	1.750	.625
<b>2531-3</b>	3/4"	3	.260	1.375	1.750	.625
<b>2541-2*</b>	1"	2	.300	1.625	1.718	.781
<b>2542-2*</b>	1"	2	.375	1.625	1.718	.781
<b>2540-3</b>	1"	3	.225	1.625	1.718	.781
<b>2541-3</b>	1"	3	.300	1.625	1.718	.781
<b>2540-4</b>	1"	4	.220	1.625	1.718	.781
<b>2555-2</b>	1-1/4"	2	.500	2.093	2.375	.812

Range of cord diameter ±.010".

In many applications you have only room for one fitting but you need to run two cables, for example, proximity switches. Now you can provide strain relief and liquidtight protection with T&B's new multi-hole liquidtight strain relief fittings. With the ever increasing number of signal cables, now you have a solution to the problem of how to strain relieve multiple cables in one fitting.

\*UL Listed only

Temperature Rating: 105°C.