

T&B Conduit Fittings

Rigid and Intermediate Metal Conduit Fittings

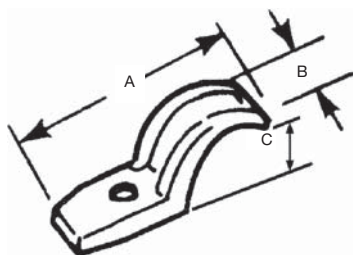

1275 Series
1276AL Series

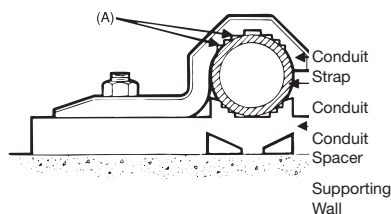

Designed to fit each size of conduit snugly. High reinforcing ribs on each side increase strength, reduce weight. Hot-dipped galvanized finish.

Conduit Straps

(For Rigid Metal Conduit and Intermediate Metal Conduit)

Application

- To support and securely fasten rigid metal conduit and intermediate metal to the supporting surface.

Features

- Rugged malleable iron/copper-free aluminum construction—snugly fits on the conduit.
- Designed to prevent accumulation of moisture and start of corrosion on vertical run of conduit (A).

Standard Material

1275 Series
Malleable Iron

1976AL Series
All copper-free

aluminum

Standard Finish

1275 Series

Hot Dipped Galvanized

1276AL Series

As Cast

Range

- 1275 Series**
3/8" through 6" conduit
- 1276AL Series**
1/2" through 6" conduit

Conformity

CSA C22.2 No. 18.3

ANSI C80.4

NFPA 70-2008 (ANSI)

Pipe Straps—Malleable Iron or Aluminum



Cat. No.		Size	Dimensions (in.)			Screw Size
Mal. Iron	Alum.		A	B	C	
1275 [†]	1275AL	3/8"	1-15/16"	19/32"	1/4"	1/4"
1276 [†]	1276AL [†]	1/2"	2-11/32"	23/32"	1/2"	1/4"
1277 [†]	1277AL [†]	3/4"	2-11/16"	21/32"	5/8"	1/4"
1278 [†]	1278AL [†]	1"	3-3/32"	11/16"	13/16"	1/4"
1279 [†]	1279AL [†]	1-1/4"	4-1/8"	13/16"	29/32"	5/16"
1280 [†]	1280AL	1-1/2"	4-1/2"	15/16"	1-17/32"	3/8"
1281	1281AL	2"	5-3/16"	1-1/8"	1-1/4"	7/16"
1282*	1282AL	2-1/2"	5-15/16"	1-1/2"	1-3/4"	1/2"
1283*	1283AL	3"	6-11/16"	1-5/8"	2-3/16"	1/2"
1284	1284AL	3-1/2"	7-19/32"	1-3/4"	2-3/4"	5/8"
1285*	1285AL	4"	8-5/16"	1-7/8"	2-13/16"	5/8"
1286**	1286AL**	4-1/2"	9-3/16"	1-15/16"	2-15/16"	5/8"
1287	1287AL	5"	9-15/16"	2"	3-1/4"	5/8"
1288	1288AL	6"	11-1/2"	2-7/16"	4-1/8"	5/8"

* May be used with EMT of same size.

[†] Not snap on type.

U.L. not applicable.

** Not CSA Certified

T&B Conduit Fittings

Rigid and Intermediate Metal Conduit Fittings

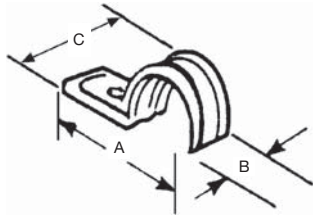

Elongated bolt hole makes alignment easy, even when holes in mounting surface are off center. Snap on features. Steel. Zinc plated

Pipe Straps—Steel

Cat. No.	Conduit Size	Dimensions (in.)			Screw Size
		A	B	C	
1210C†	3/8"	1-15/32	3/4	11/16	1/4"
1211C	1/2"	2	3/4	15/16	1/4"
1212C	3/4"	2-5/16	3/4	1"	1/4"
1213C	1"	3-13/16	3/4	1-17/64	1/4"
1214TB*	1-1/4"	2-31/32	1-9/16	1-9/16	3/8"
1215TB*	1-1/2"	3-23/32	1-13/16	1-13/16	3/8"
1216TB*	2"	4-7/16	2-5/16	2-5/16	3/8"

† Not snap on type.
U.L. not applicable.
* Not CSA Certified.

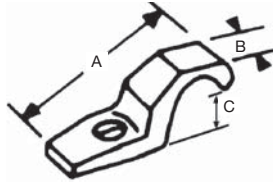

Malleable iron. Designed to fit each size of conduit snugly. High reinforcing ribs on each side increase strength, reduce weight.

Corrosion Resistant PVC Coated Rigid Conduit Straps



Cat. No.	Size	Bolt Size	Dimensions (in.)		
			A	B	C
1275CR	3/8"	1/4"	2	21/32	1/4
1276CR	1/2"	1/4"	2-13/32	25/32	1/2
1277CR	3/4"	1/4"	2-3/4	23/32	5/8
1278CR	1"	1/4"	3-5/32	3/4	13/16
1279CR	1-1/4"	3/8"	4-5/32	25/32	7/8
1280CR	1-1/2"	3/8"	4-9/16	1	1-7/32
1281CR	2"	1/2"	5-1/4	1-3/16	1-1/4

U.L. not applicable.

T&B Conduit Fittings

Rigid and Intermediate Metal Conduit Fittings

Conduit Spacers

(For Rigid Metal Conduit, Intermediate Metal Conduit and Electrical Metallic Tubing)

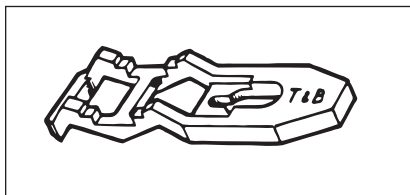

1350 Series
1350AL Series

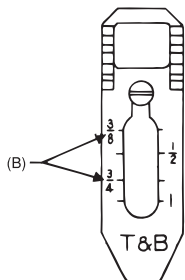
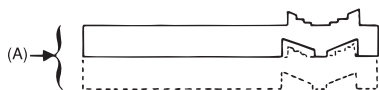
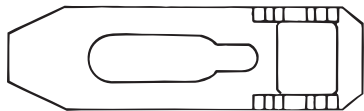

Application

- Provides mounting surface for conduit where installation requires air space between conduit and supporting surface.

Features

- Prevents conduit rusting from wall condensation.
- Spacers can be stacked one atop the other facilitating installation and eliminating expensive conduit off setting (A).
- Designed to cover wide range; marked with accurate size marking for proper positioning (B).

Standard Material

- 1350 Series**
Malleable Iron
- 1350AL Series**
Copper-free aluminum

Standard Finish

- 1350 Series**
Hot Dipped Galvanized
- 1350AL Series**
As Cast

Range

1/2" through 6" conduit

Conformity

- CSA C22.2 No. 18.3
- ANSI C80.4
- NFPA 70-2008 (ANSI)

T&B Conduit Fittings

Rigid and Intermediate Metal Conduit Fittings

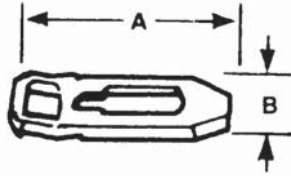

Used with T&B conduit straps to permit space between conduit and mounting surface. Eliminates need for costly offset-bending conduit and possible corrosive moisture traps when conduit is mounted directly to a surface. Hot-dipped galvanized finish, premountable and stackable to eliminate offsetting.

Pipe Spacers

Mat. Iron	Cat. No.		Size	Screw Size	Dimensions (in.)	
	Alum.				A	B
	1350	1350AL	3/8", 1/2", 3/4", 1"	#7	3"	7/8"
	1351	1351AL	1-1/4"-1-1/2"-2"	#12	5"	1-3/16"
	1352	1352AL	2-1/2"-3"	#12	9-9/16"	1-3/4"
	1353	1353AL	3-1/2"-4"	#14	7-9/16"	2"
	1354	1354AL	4-1/2"-5"-6"	#16	10-9/16"	2-9/16"

Conforms to CEC Rule 12-012 (5)
U.L. not applicable.



Pipe Spacers—PVC Coated

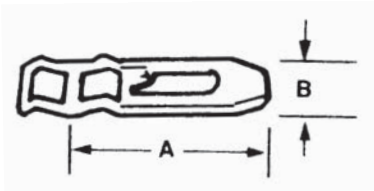

Corrosion resistant PVC coated malleable iron. Pre-mountable, stackable to eliminate offsetting. Spacers can be stacked for offsets on wall or into outlet box. Prevents conduit rusting from wall condensation. Eliminates offsetting of conduit.

Cat. No.	Conduit Size	Screw Size	Dimensions (in.)	
			A	B
1350CR	1/2"-3/4"-1"	#7	3	7/8
1351CR	1 1/4"-1-1/2"-2"	#12	5	3/8
1352CR	2-1/2"-3"	#12	6-9/16	1-3/4
1353CR	3-1/2"-4"	#14	7-9/16	2
1354CR	4-1/2"-5"-6"	#16	10-9/16	2-9/16

U.L. not applicable.
Conforms to CEC Rule 12-012 (5)