

## Motor Pigtail Connectors

**Quick, reliable change-out of electric motors with no bolting, taping or loose connections.**  
**One Line to One Load (two wire)**

C o m p r e s s i o n

- Complete line of motor lead disconnects for 600V and 5 kV applications, covering wire range from #16 through 4/0 AWG
- Fast, snap-together assembly offers maximum labor savings
- No need for nuts, bolts and washers or insulating tape – simply slide on reusable boot
- Total assembly fits into tight motor housings
- Quick disconnect – no knife cutting of melted tape, eliminating the risk of accidental cutting of wire insulation, resulting motor downtime and installer exposure
- Meet or exceed electrical and mechanical performance of bolted connections
- Constructed of high-conductivity copper with tin-plating
- Female disconnects equipped with beryllium copper interface band for dependable connections

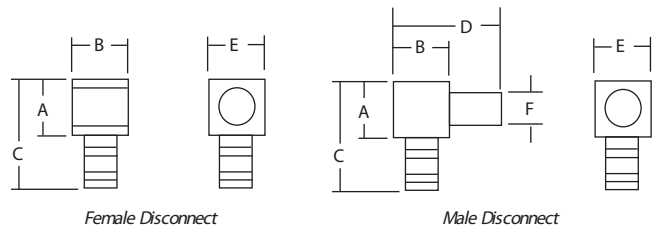

| CAT. NO. Certified to 600V |                 | Wire Size | Body Size | Color Code | Boot insulation | Dimensions in. (mm) |             |             |             |             |             | Strip Length (in.) |
|----------------------------|-----------------|-----------|-----------|------------|-----------------|---------------------|-------------|-------------|-------------|-------------|-------------|--------------------|
| Female Disconnect          | Male Disconnect |           |           |            |                 | A                   | B           | C           | D           | E           | F           |                    |
| MD1614F-0                  | MD1614M-0       | 16-14 AWG | 0         | Blue       | MDBOOT-0        | 0.25 (6.4)          | 0.25 (6.4)  | 0.63 (16.0) | 0.52 (13.2) | 0.25 (6.4)  | 0.13 (3.2)  | 3/8                |
| MD1614F-1                  | MD1614M-1       | 16-14 AWG | 1         | Blue       | MDBOOT-1        | 0.38 (9.7)          | 0.38 (9.7)  | 0.78 (19.8) | 0.75 (19.1) | 0.38 (9.7)  | 0.25 (6.4)  | 3/8                |
| MD1210F-1                  | MD1210M-1       | 12-10 AWG | 1         | Yellow     | MDBOOT-1        | 0.38 (9.7)          | 0.35 (8.9)  | 0.78 (19.8) | 0.75 (19.1) | 0.38 (9.7)  | 0.25 (6.4)  | 3/8                |
| MD1210F-2                  | MD1210M-2       | 12-10 AWG | 2         | Yellow     | MDBOOT-2        | 0.50 (12.7)         | 0.50 (12.7) | 0.90 (22.9) | 1.00 (25.4) | 0.50 (12.7) | 0.37 (9.4)  | 3/8                |
| MD8F-1                     | MD8M-1          | 8 AWG     | 1         | Red        | MDBOOT-1        | 0.38 (9.7)          | 0.38 (9.7)  | 0.82 (20.8) | 0.75 (19.1) | 0.38 (9.7)  | 0.25 (6.4)  | 7/16               |
| MD8F-2                     | MD8M-2          | 8 AWG     | 2         | Red        | MDBOOT-2        | 0.50 (12.7)         | 0.50 (12.7) | 0.95 (24.1) | 1.00 (25.4) | 0.50 (12.7) | 0.37 (9.4)  | 7/16               |
| MD6F-1                     | MD6M-1          | 6 AWG     | 1         | Blue       | MDBOOT-1        | 0.38 (9.7)          | 0.38 (9.7)  | 0.88 (22.4) | 0.75 (19.1) | 0.38 (9.7)  | 0.25 (6.4)  | 1/2                |
| MD6F-2                     | MD6M-2          | 6 AWG     | 2         | Blue       | MDBOOT-2        | 0.50 (12.7)         | 0.50 (12.7) | 1.02 (30.5) | 1.00 (25.4) | 0.50 (12.7) | 0.37 (9.4)  | 1/2                |
| MD4F-2                     | MD4M-2          | 4 AWG     | 2         | Grey       | MDBOOT-2        | 0.50 (12.7)         | 0.50 (12.7) | 1.03 (40.6) | 1.00 (25.4) | 0.50 (12.7) | 0.37 (9.4)  | 1/2                |
| MD2F-2                     | MD2M-2          | 2 AWG     | 2         | Brown      | MDBOOT-2        | 0.50 (12.7)         | 0.50 (12.7) | 1.09 (48.3) | 1.00 (25.4) | 0.50 (12.7) | 0.37 (9.4)  | 17/32              |
| MD2F-3                     | MD2M-3          | 2 AWG     | 3         | Brown      | MDBOOT-3        | 0.88 (22.4)         | 0.88 (22.4) | 1.46 (37.1) | 1.75 (44.5) | 0.88 (22.4) | 0.50 (12.7) | 17/32              |
| MD1F-2                     | MD1M-2          | 1 AWG     | 2         | Green      | MDBOOT-2        | 0.50 (12.7)         | 0.50 (12.7) | 1.23 (31.2) | 1.00 (25.4) | 0.50 (12.7) | 0.37 (9.4)  | 9/16               |
| MD1F-3                     | MD1M-3          | 1 AWG     | 3         | Green      | MDBOOT-3        | 0.88 (22.4)         | 0.88 (22.4) | 1.56 (39.6) | 1.75 (44.5) | 0.88 (22.4) | 0.50 (12.7) | 9/16               |
| MD10F-3                    | MD10M-3         | 1/0 AWG   | 3         | Pink       | MDBOOT-3        | 0.88 (22.4)         | 0.88 (22.4) | 1.56 (39.6) | 1.75 (44.5) | 0.88 (22.4) | 0.50 (12.7) | 9/16               |
| MD20F-3                    | MD20M-3         | 2/0 AWG   | 3         | Black      | MDBOOT-3        | 0.88 (22.4)         | 0.88 (22.4) | 1.59 (40.4) | 1.75 (44.5) | 0.88 (22.4) | 0.50 (12.7) | 5/8                |
| MD30F-3                    | MD30M-3         | 3/0 AWG   | 3         | Orange     | MDBOOT-3        | 0.88 (22.4)         | 0.88 (22.4) | 1.71 (43.4) | 1.75 (44.5) | 0.88 (22.4) | 0.50 (12.7) | 11/16              |
| MD40F-3                    | MD40M-3         | 4/0 AWG   | 3         | Purple     | MDBOOT-3        | 0.88 (22.4)         | 0.88 (22.4) | 1.81 (46.0) | 1.75 (44.5) | 0.88 (22.4) | 0.50 (12.7) | 3/4                |
| MD40F-4                    | MD40M-4         | 4/0 AWG   | 4         | Purple     | MDBOOT-4        | 1.25 (31.8)         | 1.25 (31.8) | 2.89 (73.4) | 2.69 (68.3) | 1.25 (31.8) | 0.81 (22.4) | -                  |
| MD250F-4                   | MD250M-4        | 250 kcmil | 4         | Yellow     | MDBOOT-4        | 1.25 (31.8)         | 1.25 (31.8) | 2.89 (73.4) | 2.69 (68.3) | 1.25 (31.8) | 0.81 (22.4) | -                  |
| MD350F-4                   | MD350M-4        | 350 kcmil | 4         | Red        | MDBOOT-4        | 1.25 (31.8)         | 1.25 (31.8) | 2.89 (73.4) | 2.69 (68.3) | 1.25 (31.8) | 0.81 (22.4) | -                  |
| MD500F-4                   | MD500M-4        | 500 kcmil | 4         | Brown      | MDBOOT-4        | 1.25 (31.8)         | 1.25 (31.8) | 2.89 (73.4) | 2.69 (68.3) | 1.25 (31.8) | 0.81 (22.4) | -                  |

Kits: page 84  
 Tooling: pp. 116-145 Die Selector Chart: pp. 146-153

# Motor Pigtail Connectors

## One Line to One Load (2 Wire)

(Continued)

### Quick, easy installation!

- 1 Choose appropriate Color-Keyed® disconnect for conductor size to be terminated. Note color of bands on disconnect barrel.
- 2 Select proper installing die by matching die color to disconnect barrel color bands.
- 3 Install die in T&B tool, insert stripped wire into barrel of disconnect and compress between color bands. Repeat for mating half.
- 4 Snap the two halves together and slip on insulator over mated connection. Secure insulator with TY-Rap® cable ties provided with the insulators.

Material: High-Conductivity Copper  
 Finish: Tin  
 Insulator: Thermoplastic Elastomer  
 Contact Material: Beryllium Copper



600V Version



5 kV Version



C o m p r e s s i o n

| CAT. NO.<br>Certified to 600V |                 | WT112M<br>WT111M<br>WT2000<br>ERG2002 | TBM25S<br>TBM20S | Installing Tools     |           |               |               |   |        |
|-------------------------------|-----------------|---------------------------------------|------------------|----------------------|-----------|---------------|---------------|---|--------|
|                               |                 |                                       |                  | TBM6, TBM6S, TBM6ORS |           | TBM5<br>TBM5S | TBM8<br>TBM8S | Hydraulic Tools and<br>TBM50S Hand Tool |        |
|                               |                 |                                       |                  | Upper Die            | Lower Die | Die Set       | Die Set       | Die Code                                | Color  |
| Female Disconnect             | Male Disconnect |                                       |                  |                      |           |               |               |   |        |
| MD1614F-0                     | MD1614M-0       | X                                     | -                | -                    | -         | -             | -             | -                                       | -      |
| MD1614F-1                     | MD1614M-1       | X                                     | -                | -                    | -         | -             | -             | -                                       | -      |
| MD1210F-1                     | MD1210M-1       | X                                     | -                | -                    | -         | -             | -             | -                                       | -      |
| MD1210F-2                     | MD1210M-2       | X                                     | -                | -                    | -         | -             | -             | -                                       | -      |
| MD8F-1                        | MD8M-1          | -                                     | X                | 13475                | 13477     | 13454         | 13461         | 21                                      | Red    |
| MD8F-2                        | MD8M-2          | -                                     | X                | 13475                | 13477     | 13454         | 13461         | 21                                      | Red    |
| MD6F-1                        | MD6M-1          | -                                     | X                | 13475                | 13477     | 13454         | 13461         | 24                                      | Blue   |
| MD6F-2                        | MD6M-2          | -                                     | X                | 13475                | 13477     | 13454         | 13461         | 24                                      | Blue   |
| MD4F-2                        | MD4M-2          | -                                     | X                | 13472                | 13476     | 13454         | 13461         | 29                                      | Grey   |
| MD2F-2                        | MD2M-2          | -                                     | X                | 13474                | 13477     | 13454         | 3461          | 33                                      | Brown  |
| MD2F-3                        | MD2M-3          | -                                     | X                | 13474                | 13477     | 13454         | 13461         | 33                                      | Brown  |
| MD1F-2                        | MD1M-2          | -                                     | -                | 13474                | 13477     | 13455         | 13462         | 37                                      | Green  |
| MD1F-3                        | MD1M-3          | -                                     | -                | 13474                | 13477     | 13455         | 13462         | 37                                      | Green  |
| MD10F-3                       | MD10M-3         | -                                     | -                | 13475                | 13477     | 13455         | 13462         | 42                                      | Pink   |
| MD20F-3                       | MD20M-3         | -                                     | -                | 13474                | 13477     | 13455         | 13462         | 45                                      | Black  |
| MD30F-3                       | MD30M-3         | -                                     | -                | 13474                | 13477     | 13455         | 13462         | 50                                      | Orange |
| MD40F-3                       | MD40M-3         | -                                     | -                | 13475                | 13477     | 13456         | 13463         | 54                                      | Purple |

Specifications:  
 Wire Range: No. 16 to 4/0 AWG  
 Rating: 600V, 90°C

Tooling: pp. 116-145

Die Selector Chart: pp.146-153

## Motor Pigtail Connectors

### Motor Pigtail Connector – One Line to Two Load (3 Wire)

- KON-TOUR® louvered contact bands
- Color-coded to match installing dies

Material: High-Conductivity Wrought Copper

Finish: Electro-Tin Plate

Contact Material: Beryllium Copper

C o m p r e s s i o n

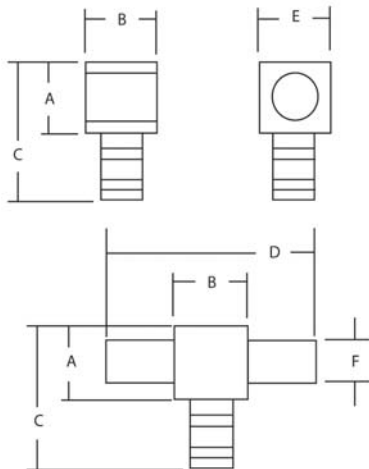

| CAT. NO. Certified to 600V |                 | Wire Size | Body Size | Color Code | Boot insulation | Dimensions in. (mm) |             |             |             |             |             | Strip Length (in.) |
|----------------------------|-----------------|-----------|-----------|------------|-----------------|---------------------|-------------|-------------|-------------|-------------|-------------|--------------------|
| Female Disconnect          | Male Disconnect |           |           |            |                 | A                   | B           | C           | D           | E           | F           |                    |
| MD1614F-0                  | M2D1614M-0      | 16-14 AWG | 0         | Blue       | MDBOOT-1        | 0.25 (6.4)          | 0.25 (6.4)  | 0.63 (16.0) | 0.52 (13.2) | 0.25 (6.4)  | 0.13 (3.3)  | 3/8                |
| MD1614F-1                  | M2D1614M-1      | 16-14 AWG | 1         | Blue       | MDBOOT-1        | 0.38 (9.7)          | 0.38 (9.7)  | 0.78 (19.8) | 0.75 (19.1) | 0.38 (9.7)  | 0.25 (6.4)  | 3/8                |
| MD1210F-1                  | M2D1210M-1      | 12-10 AWG | 1         | Yellow     | MDBOOT-1        | 0.38 (9.7)          | 0.35 (8.9)  | 0.78 (19.8) | 0.75 (19.1) | 0.38 (9.7)  | 0.25 (6.4)  | 3/8                |
| MD1210F-2                  | M2D1210M-2      | 12-10 AWG | 2         | Yellow     | MDBOOT-2        | 0.50 (12.7)         | 0.50 (12.7) | 0.90 (22.9) | 1.00 (25.4) | 0.50 (12.7) | 0.37 (9.4)  | 3/8                |
| MD8F-1                     | M2D8M-1         | 8 AWG     | 1         | Red        | MDBOOT-1        | 0.38 (9.7)          | 0.38 (9.7)  | 0.82 (20.8) | 0.75 (19.1) | 0.38 (9.7)  | 0.25 (6.4)  | 7/16               |
| MD8F-2                     | M2D8M-2         | 8 AWG     | 2         | Red        | MDBOOT-2        | 0.50 (12.7)         | 0.50 (12.7) | 0.95 (24.1) | 1.00 (25.4) | 0.50 (12.7) | 0.37 (9.4)  | 7/16               |
| MD6F-1                     | M2D6M-1         | 6 AWG     | 1         | Blue       | MDBOOT-1        | 0.38 (9.7)          | 0.38 (9.7)  | 0.88 (22.4) | 0.75 (19.1) | 0.38 (9.7)  | 0.25 (6.4)  | 1/2                |
| MD6F-2                     | M2D6M-2         | 6 AWG     | 2         | Blue       | MDBOOT-2        | 0.50 (12.7)         | 0.50 (12.7) | 1.02 (25.9) | 1.00 (25.4) | 0.50 (12.7) | 0.37 (9.4)  | 1/2                |
| MD4F-2                     | M2D4M-2         | 4 AWG     | 2         | Grey       | MDBOOT-2        | 0.50 (12.7)         | 0.50 (12.7) | 1.03 (26.2) | 1.00 (25.4) | 0.50 (12.7) | 0.37 (9.4)  | 1/2                |
| MD2F-2                     | M2D2M-2         | 2 AWG     | 2         | Brown      | MDBOOT-2        | 0.50 (12.7)         | 0.50 (12.7) | 1.09 (27.7) | 1.00 (25.4) | 0.50 (12.7) | 0.37 (9.4)  | 17/32              |
| MD2F-3                     | M2D2M-3         | 2 AWG     | 3         | Brown      | MDBOOT-3        | 0.88 (22.4)         | 0.88 (22.4) | 1.46 (37.1) | 1.75 (44.5) | 0.88 (22.4) | 0.50 (12.7) | 17/32              |
| MD1F-2                     | M2D1M-2         | 1 AWG     | 2         | Green      | MDBOOT-2        | 0.50 (12.7)         | 0.50 (12.7) | 1.23 (31.2) | 1.00 (25.4) | 0.50 (12.7) | 0.37 (9.4)  | 9/16               |
| MD1F-3                     | M2D1M-3         | 1 AWG     | 3         | Green      | MDBOOT-3        | 0.88 (22.4)         | 0.88 (22.4) | 1.56 (39.6) | 1.75 (44.5) | 0.88 (22.4) | 0.50 (12.7) | 9/16               |
| MD10F-3                    | M2D10M-3        | 1/0 AWG   | 3         | Pink       | MDBOOT-3        | 0.88 (22.4)         | 0.88 (22.4) | 1.56 (39.6) | 1.75 (44.5) | 0.88 (22.4) | 0.50 (12.7) | 9/16               |
| MD20F-3                    | M2D20M-3        | 2/0 AWG   | 3         | Black      | MDBOOT-3        | 0.88 (22.4)         | 0.88 (22.4) | 1.59 (40.4) | 1.75 (44.5) | 0.88 (22.4) | 0.50 (12.7) | 5/8                |
| MD30F-3                    | M2D30M-3        | 3/0 AWG   | 3         | Orange     | MDBOOT-3        | 0.88 (22.4)         | 0.88 (22.4) | 1.71 (43.4) | 1.75 (44.5) | 0.88 (22.4) | 0.50 (12.7) | 11/16              |
| MD40F-3                    | M2D40M-3        | 4/0 AWG   | 3         | Purple     | MDBOOT-3        | 0.88 (22.4)         | 0.88 (22.4) | 1.81 (46.0) | 1.75 (44.5) | 0.88 (22.4) | 0.50 (12.7) | 3/4                |

Operating Range: 600V max., 1000V max. in signs and fixtures.

Listing: UL Listed and CSA Certified for 12/8 AWG solid copper conductors and stranded copper conductors in the sizes shown.

Selection: Always use the same body size when selecting male and female disconnects.

For example: to connect a 2 AWG male to an 8 AWG female, select catalogue number M2DM-2 and MD8F-2. Both have body size 2.

Insulation: Use insulating boots matching the disconnect body size as indicated in the chart. To protect the connection from moisture and dirt use sealing compound Catalogue Number MDBOOT-SEAL.

Tooling: pp. 116-145

Die Selector Chart: pp.146-153

## Motor Pigtail Connectors

### Motor Pigtail Connector – One Line to Two Load (3 Wire)

(Continued)

- KON-TOUR® louvered contact bands
- Color-coded to match installing dies

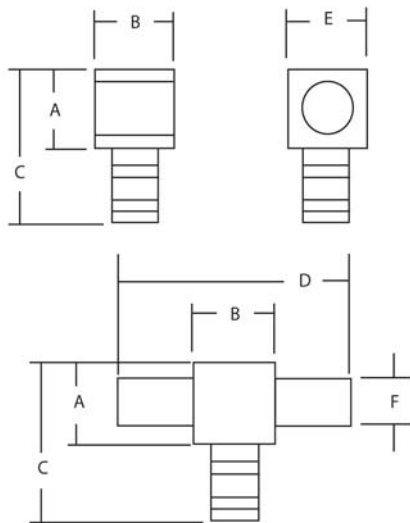

C o m p r e s s i o n



| CAT. NO.<br>Certified to 600V |                 | WT112M<br>WT111M<br>WT2000<br>ERG2002 | TBM25S<br>TBM20S | Installing Tools     |           |               |               |   |        |
|-------------------------------|-----------------|---------------------------------------|------------------|----------------------|-----------|---------------|---------------|---|--------|
|                               |                 |                                       |                  | TBM6, TBM6S, TBM6ORS |           | TBM5<br>TBM5S | TBM8<br>TBM8S | Hydraulic Tools and<br>TBM50S Hand Tool |        |
|                               |                 |                                       |                  | Upper Die            | Lower Die | Die Set       | Die Set       | Die Code                                | Color  |
| Female Disconnect             | Male Disconnect |                                       |                  |                      |           |               |               |   |        |
| MD1614F-0                     | M2D1614M-0      | X                                     | -                | -                    | -         | -             | -             | -                                       | -      |
| MD1614F-1                     | M2D1614M-1      | X                                     | -                | -                    | -         | -             | -             | -                                       | -      |
| MD1210F-1                     | M2D1210M-1      | X                                     | -                | -                    | -         | -             | -             | -                                       | -      |
| MD1210F-2                     | M2D1210M-2      | X                                     | -                | -                    | -         | -             | -             | -                                       | -      |
| MD8F-1                        | M2D8M-1         | -                                     | X                | 13475                | 13477     | 13454         | 13461         | 21                                      | Red    |
| MD8F-2                        | M2D8M-2         | -                                     | X                | 13475                | 13477     | 13454         | 13461         | 21                                      | Red    |
| MD6F-1                        | M2D6M-1         | -                                     | X                | 13475                | 13477     | 13454         | 13461         | 24                                      | Blue   |
| MD6F-2                        | M2D6M-2         | -                                     | X                | 13475                | 13477     | 13454         | 13461         | 24                                      | Blue   |
| MD4F-2                        | M2D4M-2         | -                                     | X                | 13472                | 13476     | 13454         | 13461         | 29                                      | Grey   |
| MD2F-2                        | M2D2M-2         | -                                     | X                | 13474                | 13477     | 13454         | 3461          | 33                                      | Brown  |
| MD2F-3                        | M2D2M-3         | -                                     | X                | 13474                | 13477     | 13454         | 13461         | 33                                      | Brown  |
| MD1F-2                        | M2D1M-2         | -                                     | -                | 13474                | 13477     | 13455         | 13462         | 37                                      | Green  |
| MD1F-3                        | M2D1M-3         | -                                     | -                | 13474                | 13477     | 13455         | 13462         | 37                                      | Green  |
| MD10F-3                       | M2D10M-3        | -                                     | -                | 13475                | 13477     | 13455         | 13462         | 42                                      | Pink   |
| MD20F-3                       | M2D20M-3        | -                                     | -                | 13474                | 13477     | 13455         | 13462         | 45                                      | Black  |
| MD30F-3                       | M2D30M-3        | -                                     | -                | 13474                | 13477     | 13455         | 13462         | 50                                      | Orange |
| MD40F-3                       | M2D40M-3        | -                                     | -                | 13475                | 13477     | 13456         | 13463         | 54                                      | Purple |

Tooling: pp. 116-145

Die Selector Chart: pp.146-153

## Motor Pigtail Connectors

### 5 KV Motor Pigtail Connector Supplied with Boot, Pin, Silicon Gel (Two Female Connectors Required)

Compression

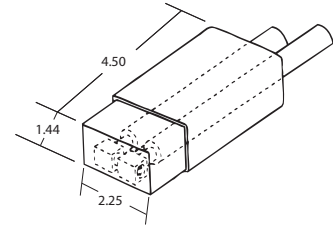
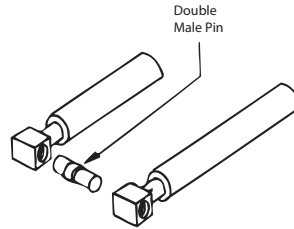

| CAT. NO.   | Wire Range AWG | Female Disconnect Cat. No. | Color Code   | Dimensions (in.) |             |             | Body Size |
|--|----------------|----------------------------|--------------|------------------|-------------|-------------|-----------|
|  |                |                            |              | L                | W           | H           |           |
| 5KVB00T-2L<br><small>(connection pin for two female connectors included)</small> | #8             | MD8F-2                     | Red          | 4.50 (114.3)     | 2.25 (57.2) | 1.44 (36.6) | 2         |
|  | #6             | MD6F-2                     | Blue         | 4.50 (114.3)     | 2.25 (57.2) | 1.44 (36.6) | 2         |
|  | #4             | MD4F-2                     | Grey         | 4.50 (114.3)     | 2.25 (57.2) | 1.44 (36.6) | 2         |
|  | #2             | MD2F-2                     | Brown        | 4.50 (114.3)     | 2.25 (57.2) | 1.44 (36.6) | 2         |
|  | #1             | MD1F-2                     | Green        | 4.50 (114.3)     | 2.25 (57.2) | 1.44 (36.6) | 2         |
| 5KVB00T-3L<br><small>(connection pin for two female connectors included)</small> | #2             | MD2F-3                     | Brown        | 4.50 (114.3)     | 2.25 (57.2) | 1.44 (36.6) | 3         |
|  | #1             | MD1F-3                     | Green        | 4.50 (114.3)     | 2.25 (57.2) | 1.44 (36.6) | 3         |
|  | 1/0            | MD10F-3                    | Pink         | 4.50 (114.3)     | 2.25 (57.2) | 1.44 (36.6) | 3         |
|  | 2/0            | MD20F-3                    | Black        | 4.50 (114.3)     | 2.25 (57.2) | 1.44 (36.6) | 3         |
|  | 3/0            | MD30F-3                    | Orange       | 4.50 (114.3)     | 2.25 (57.2) | 1.44 (36.6) | 3         |
| 4/0  | MD40F-3        | Purple                     | 4.50 (114.3) | 2.25 (57.2)      | 1.44 (36.6) | 3           |           |

\* Male pin supplied will fit all ranges and combinations of wire sizes per body size.

### Sealing of motor-disconnect boots

#### Sealant

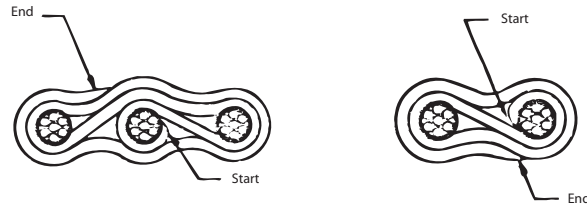

Sealant should be used with T&B MOTOR DISCONNECT Boots: MDBOOT-0, MDBOOT-1, MDBOOT-2 and MDBOOT-3.

The cable should be clean and free of grease and other foreign substances.

Apply two layers around each cable at the same distance from the connector.

Slide the assembly into boot, apply Ty-Rap® cable ties and work sealant around wires at end of boot to eliminate voids.

#### Specifications

- Description: Polybutene Compound
- Application Temperature: 4°C to 38°C (40°F to 100°F)
- Service Temperature: -40°C to 82°C (-40°F to 180°F)
- Dimensions: Width 1", Thickness 1/8", Length (std. roll) 10', wrapped on release liner
- Environmental Resistance: Resists normal aging process
- Chemical Resistance: Resists acids, bases and alcohols
- Dielectric Strength: 200 V/mil minimum
- Volume Resistivity: 1013 ohms/cm
- Flame Retardancy: Passed VO Vertical Flame Test

| CAT. NO.    | Description |
|-------------|-------------|
| MDBOOT-SEAL | Sealant     |

For water-tight applications, contact technical services.

## **Motor Pigtail Connectors**

### **Silicone Lubricant for High Voltage Electrical Work**



| <b>CAT. NO.</b> | <b>Size</b>     | <b>Std. Pkg.</b> |
|-----------------|-----------------|------------------|
| <b>2015</b>     | 5 grams         | 100 tubes        |
| <b>SL5</b>      | 5 oz./142 grams | 12 tubes         |

C o m p r e s s i o n