

## Pin Connectors for Aluminum/Copper Code Conductors

Converts an aluminum cable into a two-sizes-smaller copper pigtail.

### Bi-Pin® Bi-Metal Pin Connectors with Insulating Covers

- For 90°C, 600V applications
- Upgrades connection by eliminating cold flow and oxidation of aluminum
- Reduces oversized aluminum cable
- Enables termination of aluminum cable into a copper-only lug
- Barrel prefilled with joint compound

Material: Copper Wire/Aluminum Body  
 Finish: Electro-Tin Plated  
 Insulation: Neoprene (600V dielectric rating)

C o m p r e s s i o n

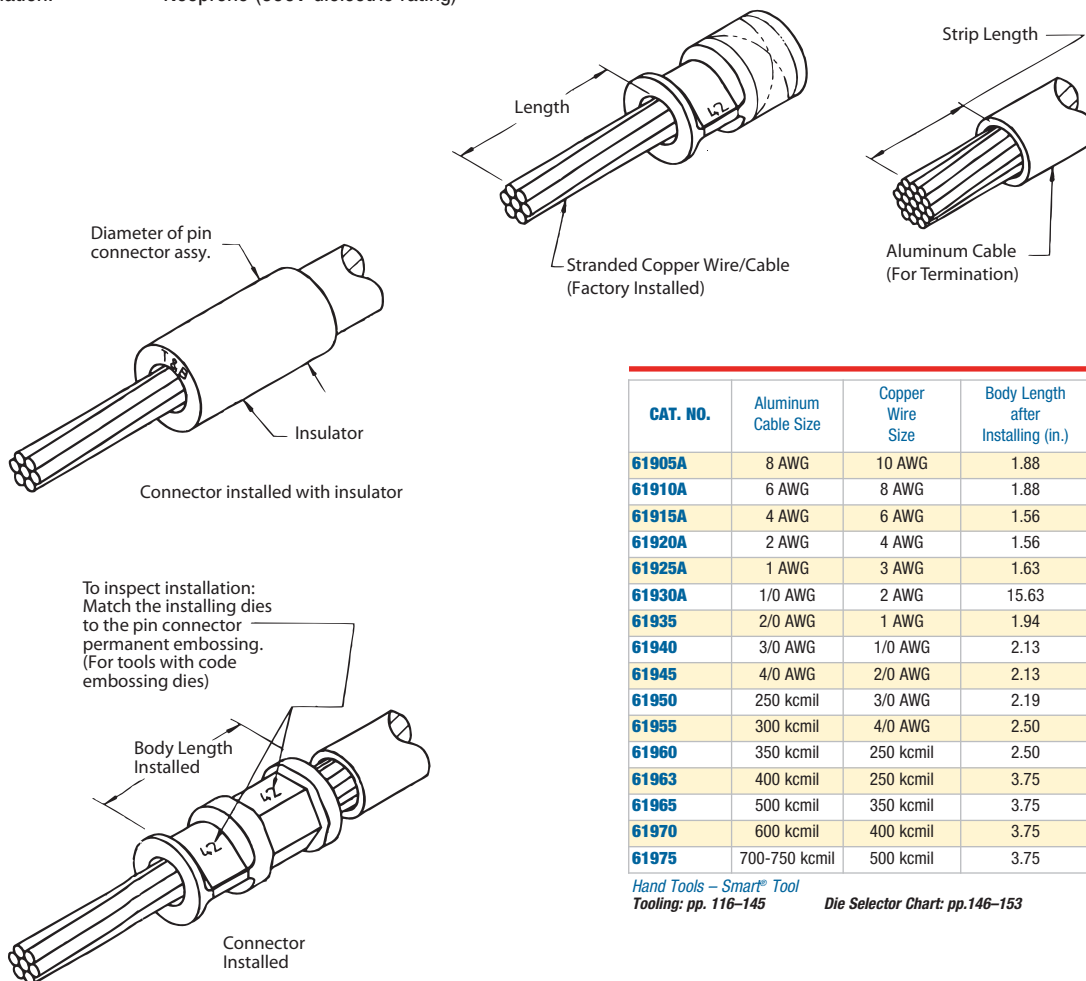

CAT. NO.	Aluminum Cable Size	Copper Wire Size	Body Length after Installing (in.)	Die Code No.	Color Code
61905A	8 AWG	10 AWG	1.88	24	Blue
61910A	6 AWG	8 AWG	1.88	24	Blue
61915A	4 AWG	6 AWG	1.56	45	Gold
61920A	2 AWG	4 AWG	1.56	45	Gold
61925A	1 AWG	3 AWG	1.63	50	Orange
61930A	1/0 AWG	2 AWG	15.63	50	Orange
61935	2/0 AWG	1 AWG	1.94	50	Orange
61940	3/0 AWG	1/0 AWG	2.13	60	Ruby
61945	4/0 AWG	2/0 AWG	2.13	60	Ruby
61950	250 kcmil	3/0 AWG	2.19	66	White
61955	300 kcmil	4/0 AWG	2.50	71H	Red
61960	350 kcmil	250 kcmil	2.50	71H	Red
61963	400 kcmil	250 kcmil	3.75	87H	Brown
61965	500 kcmil	350 kcmil	3.75	87H	Brown
61970	600 kcmil	400 kcmil	3.75	107H	Orange
61975	700-750 kcmil	500 kcmil	3.75	107H	Orange

Hand Tools – Smart® Tool Tooling: pp. 116–145 Die Selector Chart: pp.146–153

## Flag Lugs for Aluminum / Copper Code Conductor

C o m p r e s s i o n

### 90° Flag Lugs — 600V, 90° C

Material: Aluminum  
 Finish: Tin Plate  
 Insulation: PVC Dip Coated

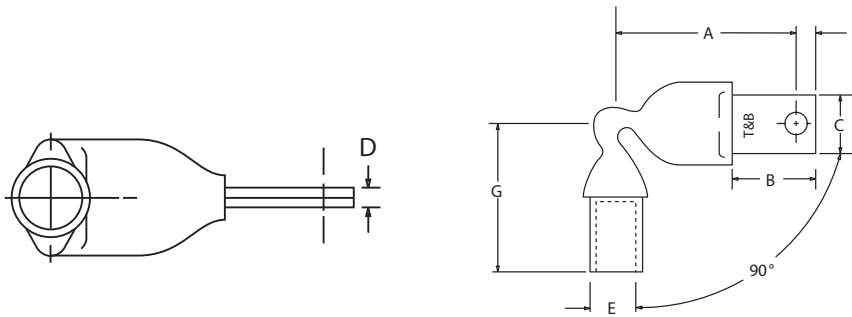
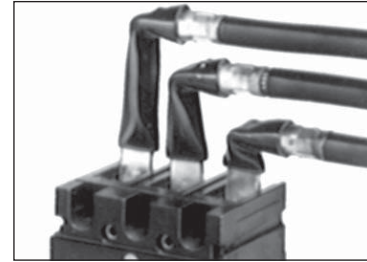

CAT. NO.	CU Cable Size	Stud Size (in.)	Phase	Dimensions (in.)							Die Code
				A	B	C	D	E	F	G	
10A-FT-14NTK	1/0	1/4	1	1.38	0.94	0.64	0.19	0.62	0.25	2.50	50
			2	2.13							
			3	2.88							
20A-FT-14NTK	2/0	1/4	1	1.93	1.14	0.64	0.22	0.70	0.25	2.50	54
			2	2.93							
			3	3.93							
30A-FT-14NTK	3/0	1/4	1	2.11	1.14	0.78	0.22	0.77	0.25	2.75	60
			2	3.11							
			3	4.11							
40A-FT-14NTK	4/0	1/4	1	2.04	1.14	0.78	0.25	0.86	0.25	3.13	66
			2	3.04							
			3	4.04							
250A-FT-14NTK	250 KCMIL	1/4	1	2.31	1.20	0.98	0.25	0.92	0.31	3.00	71
			2	3.44							
			3	4.57							
350A-FT-12NTK	350 KCMIL	1/4	1	2.31	1.45	1.09	0.31	1.09	0.56	3.94	87
			2	3.69							
			3	5.06							
500A-FT-12NTK	500 KCMIL	1/4	1	2.56	1.45	1.20	0.38	1.28	0.56	4.19	99
			2	4.06							
			3	5.69							
750A-FT-58NTK	750 KCMIL	1/4	1	2.63	1.70	1.49	0.38	1.50	0.81	4.39	115
			2	4.50							
			3	6.25							

\* Each Cat. No. consists of three connectors, (1) connector per phase. Connectors supplied with Thomas & Betts oxide inhibitor compound in wire bore.  
 Tooling: pp. 116-145 Die Selector Chart: pp.146-153