

## Connectors for Copper Conductors

### Copper Two-Way Splice for Certified to 600V and Recommended up to 15 kV Applications

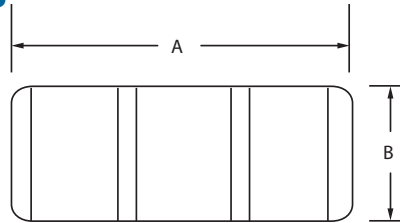

CAT. NO.	Cable Size**	Dimensions in. (mm)		Installing Tools 14 and 15 Ton Tool		
		A	B	Die Set Cat. No.	Strip Length (in.)	Color Code
54006-TB	#4 AWG	2.00 (50.8)	0.37 (9.4)	15CA29R	1-1/2	Grey
54007-TB	#2 AWG	2.13 (54.1)	0.41 (10.4)	15CA33R	1-5/8	Brown
54008-TB	#1 AWG	2.25 (57.2)	0.47 (11.9)	15CA37R	1-5/8	Green
54009-TB	1/0 AWG	2.38 (60.5)	0.52 (13.2)	15CA42R	1-3/4	Pink
54010	2/0 AWG	2.38 (60.5)	0.57 (14.5)	15CA45R	1-3/4	Black
54011	3/0 AWG	2.63 (66.8)	0.63 (16.0)	15CA49R	1-13/16	Orange
54012-TB	4/0 AWG	2.69 (68.3)	0.69 (17.5)	15CA54R	1-13/16	Purple
54013	250 kcmil	3.19 (81.0)	0.74 (18.8)	15CA60R	2-1/8	Ruby
54015	350 kcmil	4.13 (104.9)	0.89 (22.6)	15CA71R	2-5/8	Red
54018	500 kcmil	4.13 (104.9)	1.06 (40.6)	15CA87R	2-5/8	Brown
54023	750 kcmil	4.75 (120.7)	1.30 (33.0)	15CA106R	2-7/8	Black

\*Cat. No. 15505-TB Die Adaptor required for TBM151  
 \*\* Cable Size: Concentric and Compact strandings  
 Tooling: pp. 116-145 Die Selector Chart: pp.146-153

### Cast-Copper Two-Way Splice Connectors for Certified to 600V and Recommended up to 35 kV<sup>‡</sup> Applications – Heavy-duty



Material: Cast Copper  
 Finish: Electro Tin Plate

CAT. NO.	Cable Size	Die Code
53504	8 AWG	29
53505	6 AWG	29
53506	4 AWG	29
53507	2 AWG	45
53508	1 AWG	45
53509	1/0 AWG	45
53510	2/0 AWG	66
53511	3/0 AWG	66
53512	4/0 AWG	66
53513	250 kcmil	76
53515	350 kcmil	99
53518	500 kcmil	99
53523	750 kcmil	112

Use hydraulic tools with hex dies 13642M, 13400 and 21940.  
 Tooling: pp. 116-145 Die Selector Chart: pp.146-153  
<sup>‡</sup> For installations from 16 kV up to 35 kV, consult shielded cable manufacturers for stress relief and insulation requirements.

## Connectors for Copper Conductors

Constant O.D. enables faster, easier installation than contoured design.



### Cast-Copper Reducing Splices

C o m p r e s s i o n



Thomas & Betts takes the splicing of different-sized conductors to a new level of economy and efficiency with Color-Keyed Cast-Copper Reducing Splices. In addition to a lower cost, the key benefit to these splices is in their constant outer diameter. Unlike screw-machined, externally contoured splices, Cast-Copper Reducing Splices require

no change of tool or die between crimping each end. Just slide each wire easily into the chamfered barrel and use the same Color-Keyed tool and die to crimp both ends. The consistent O.D. also makes these splices faster and easier to insulate with clear heat-shrink wrap than a contoured splice. Sand-cast construction ensures high tensile strength for heavy-duty applications and tin-plated copper material provides high conductivity and superior corrosion-resistance.

- Ideal for telecom (inside office/outside plant), commercial, industrial MRO, and any other certified to 600V and recommended up to 35 kV\* applications requiring splicing of different-sized conductors
- Tin-plated, sand-cast copper construction provides superior tensile strength, high conductivity and excellent corrosion-resistance
- Easier to install and insulate than screw-machined, contour-designed reducing splices
- Constant O.D. saves time on installation by eliminating the need for crimp-tool/die change
- Fast and simple to insulate with clear or colored heat-shrink wrap
- Chamfered barrel facilitates easy wire insertion
- Compact, low-profile design takes up minimal space in cable tray or wire run
- Simple installation with Color-Keyed® crimp tools (12, 14 and 15 Ton tools).

CAT. NO.	Cond. 1 Size	Cond. 2 Size	Length in. (mm)	Dia. in. (mm)	Die Code	Die Color
251-30485-19	4/0 Str.	2 Str.	2.25 (57.2)	0.81 (20.6)	66	White
251-30485-91	500 kcmil Str.	300 kcmil Str.	3.31 (84.1)	0.81 (20.6)	99	Pink
251-30485-229	2/0 Str.	250 kcmil Str.	2.38 (60.5)	0.93 (23.6)	76	Blue
251-30485-247	2 Str.	8 Str.	0.56 (14.2)	0.59 (15.0)	45	Black
251-30485-294	4 Str.	2/0 Str.	2.25 (57.2)	0.84 (21.3)	66	White
251-30485-295	4/0 Str.	4 Str.	2.25 (57.2)	0.81 (20.6)	66	White
251-30485-331	4/0 Str.	350 kcmil Str.	3.31 (84.1)	0.53 (13.5)	99	Pink
251-30485-445	4/0 Str.	2/0 Str.	2.25 (57.2)	0.81 (20.6)	66	White
251-30485-495	1/0 Str.	2 Str.	1.56 (39.6)	0.59 (15.0)	45	Black
251-30485-610	6 Str.	8 Str.	1.21 (30.7)	0.38 (9.7)	29	Grey
251-30485-611	4 Str.	8 Str.	1.21 (30.7)	0.38 (9.7)	29	Grey
251-30485-612	4 Str.	6 Str.	1.21 (30.7)	0.38 (9.7)	29	Grey
251-30485-613	2 Str.	6 Str.	1.56 (39.6)	0.59 (15.0)	45	Black
251-30485-640	4/0 Str.	1/0 Str.	2.25 (57.2)	0.81 (20.6)	66	White
251-30485-653	2 Str.	250 kcmil Str.	2.38 (60.5)	0.93 (23.6)	76	Blue
251-30485-739	1/0 Str.	250 kcmil Str.	2.38 (60.5)	0.93 (23.6)	76	Blue
251-30485-882	400 kcmil Str.	350 kcmil Str.	3.31 (84.1)	0.53 (13.5)	99	Pink
251-30485-950	1/0 Str.	6 Str.	1.56 (39.6)	0.59 (15.0)	45	Black
251-30485-951	6 Str.	2/0 Str.	2.25 (57.2)	0.84 (21.3)	66	White
251-30485-1027	1/0 Str.	4 Str.	1.56 (39.6)	0.59 (15.0)	45	Black
251-30485-1029	1/0 Str.	#12 Str.	1.56 (39.6)	0.57 (14.5)	45	Black
251-30485-1030	10 Str.	4 Str.	1.21 (30.7)	0.38 (9.7)	29	Grey
251-30485-1031	12 Str.	4 Str.	1.21 (30.7)	0.38 (9.7)	29	Grey
251-30485-1032	#6 Str.	#10 Str.	1.21 (30.7)	0.38 (9.7)	29	Grey
251-30485-1033	12 Str.	6 Str.	1.21 (30.7)	0.38 (9.7)	29	Grey
251-30485-1034	14 Str.	8 Str.	1.21 (30.7)	0.38 (9.7)	29	Grey
251-30485-1035	1 Str.	1/0 Str.	1.56 (39.6)	0.59 (15.0)	45	Black
251-30485-1044	10 Str.	8 Str.	1.21 (30.7)	0.38 (9.7)	29	Grey
251-30485-1045	12 Str.	8 Str.	1.21 (30.7)	0.38 (9.7)	29	Grey
251-30485-1085	10 Str.	1/0 Str.	1.56 (39.6)	0.59 (15.0)	45	Black
251-30485-1086	10 Str.	2/0 Str.	2.25 (57.2)	0.84 (21.3)	66	White
251-30485-1087	4 Str.	250 kcmil Str.	2.38 (60.5)	0.93 (23.6)	76	Blue
251-30485-1088	400 kcmil Str.	250 kcmil Str.	3.31 (84.1)	0.53 (13.5)	99	Pink
251-30485-1089	14 Str.	8 Sol.	1.21 (30.7)	0.38 (9.7)	29	Grey
251-30485-1090	12 Str.	8 Sol.	1.21 (30.7)	0.38 (9.7)	29	Grey
251-30485-1091	10 Str.	8 Sol.	1.21 (30.7)	0.38 (9.7)	29	Grey
251-30485-1092	12 Str.	6 Sol.	1.21 (30.7)	0.38 (9.7)	29	Grey
251-30485-1093	8 Str.	6 Sol.	1.21 (30.7)	0.38 (9.7)	29	Grey
251-30485-1094	4 Str.	6 Sol.	1.21 (30.7)	0.38 (9.7)	29	Grey
251-30485-1095	2 Str.	6 Sol.	1.56 (39.6)	0.59 (15.0)	45	Black
251-30485-1096	12 Str.	4 Sol.	1.21 (30.7)	0.38 (9.7)	29	Grey
251-30485-1097	10 Str.	4 Sol.	1.21 (30.7)	0.38 (9.7)	29	Grey
251-30485-1098	8 Str.	4 Sol.	1.21 (30.7)	0.38 (9.7)	29	Grey
251-30485-1099	6 Str.	4 Sol.	1.21 (30.7)	0.38 (9.7)	29	Grey
251-30485-1100	1/0 Str.	4 Sol.	1.56 (39.6)	0.59 (15.0)	45	Black
251-30485-1130	Cast Copper*	12-4 Str.	1.28 (32.5)	0.38 (9.7)	29	Black
251-30485-1245	1/0 Flex	#4 Flex	2.25 (57.2)	0.81 (20.6)	66	White
251-30485-1246	#4 Flex	#8 Flex	1.56 (39.6)	0.57 (14.5)	45	Black

\* Cast Copper – Field Modifiable Special  
 † For installations from 16 kV up to 35 kV, consult shielded cable manufacturers for stress relief and insulation requirements.

## Connectors for Copper Conductors

Compact design for low-profile installation.

### Copper Reducing Splices

Thomas & Betts copper reducing splices are the most recent addition to the telecom line of copper compression lugs and connectors. They are designed for use in Central Office Equipment Installations in place of H-Taps in applications where the main cable is stepped down. When space is at a premium and standard H-Tap splicing options are too cumbersome, the Thomas & Betts reducing splices can be the right choice. These splices are available for a range of cables from 750 Flex to 6 Code.

- Requires less “real estate” in a Central Office
- Does not require a cover other than clear heat shrink
- One-person installation. Each side crimped separately
- Utilizes standard lug crimping dies. More standard tooling options. Lower tonnage tools can now install even the largest splice
- Hand tools can be used on splices for 500 Code/350 Flex and smaller
- Inspection holes verify cable is fully inserted into each barrel
- CSA certified up to 600V

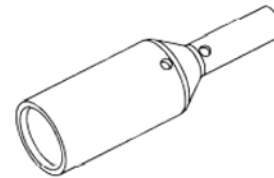

C o m p r e s s i o n

Splices for the following cable combinations are available. Appropriate quantities of pre-cut lengths of CSA listed clear heat shrink are provided with each splice:

CAT. NO.	Cable Sizes	Die Code		Number of Crimps Main Branch				
	Main Branch	Main	Branch	TBM21E TBM25S	TBM5(S) TBM6(S)	TBM6H TBM6BSCR TBM62BSCR	TBM14 13100A TBM14BSCR BPLT14BSCR (14 Ton.)	TBM15L TBM15BSC (15 Ton.)
TBRS75F-75C50FHS	750F-750C or 500F	Yellow 115H	Black 106H				4-4	4-4
TBRS75F-50C35FHS	750F-250C or 350F		Brown 87H				4-4	4-4
TBRS75F-25C4/0FHS	750F-250C or 4/0F		Yellow 62				4-2	4-2
TBRS75C50F-75C50FHS	750C or 500F-750C or 500F	Black 106H	Black 106H				4-4	4-4
TBRS75C50F-50C35FHS	750C or 500F-500C or 350F		Brown 87H				4-4	4-4
TBRS75C50F-25C4/0FHS	750C or 500F-250C or 4/0F		Yellow 62				4-2	4-2
TBRS75C50F-4/0CHS	750C or 500F-4/0C		Purple 54H				4-4	4-4
TBRS4/0C-2CHS	4/0C-2C	Purple 54H	Brown 33		4-2	4-2	4-2	4-2
TBRS4/0C-6CHS	4/0C-6C		Blue 24		4-2	4-2	4-2	4-2
TBRS2/0C1/0F-2CHS	2/0C or 1/0F-2C	Black 106H	Brown 33		3-2	2-2	2-2	2-2
TBRS2/0C1/0F-6CHS	2/0C or 1/0F-6C		Blue 24		3-2	3-2	3-2	3-2
TBRS1/0C1F-2CHS	1/0C-2C	Pink 42H	Brown 33		2-2	2-2	2-2	2-2
TBRS1/0C1F-6CHS	1/0C-6C		Blue 24		2-2	2-2	2-2	2-2
TBRS2C-6CHS	2C-6C		Brown 33		4-4	2-2	2-2	2-2

Tooling: pp. 116-145

Die Selector Chart: pp.146-153

NOTES:  
C = "CODE"  
F = "FLEX"