

**Connectors for Copper Conductors**

**C o m p r e s s i o n**

**Bell Ended Lugs –  
Standard Barrel  
Certified to 600V  
and Recommended  
up to 35 kV‡**

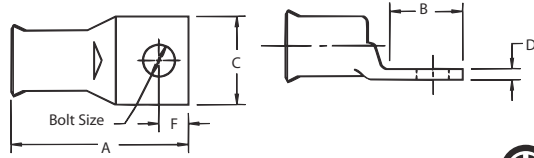

CAT. NO.	Cable Code	WIRE SIZE*		Classes					Bolt Size (in.)	Dimensions in. (mm)					Die Code	Die Color
		Navy	Flex	G	H	I	K	M		A	B	C	D	F		
54104BS	8	23	37/24	8	8	–	8	8	#10	1.06 (40.6)	0.46 (11.7)	0.40 (10.2)	0.07 (1.8)	0.21 (5.3)	21	Red
54105BS	6	30	61/24	5	5	5	5	5	1/4	1.18 (30.0)	0.56 (14.2)	0.43 (10.9)	0.10 (2.5)	0.25 (6.4)	24	Blue
54106BS	4	40-50	91/24	5	5	5	5	5	1/4	1.28 (32.5)	0.56 (14.2)	0.56 (14.2)	0.10 (2.5)	0.25 (6.4)	29	Grey
54139BS	3 and 4	40-50	91/24	4	4	4	4	4	5/16	1.43 (36.3)	0.78 (19.8)	0.59 (19.8)	0.07 (1.8)	0.34 (8.6)	29	Grey
54142BS	2	60	125/24	3	3	3	3	3	5/16	1.53 (38.9)	0.71 (18.0)	0.65 (16.5)	0.07 (1.8)	0.34 (8.6)	33	Brown
54147BS	1	75	150, 175/24	2	2	2	2	2	5/16	1.91 (48.5)	0.71 (18.0)	0.67 (17.0)	0.12 (3.0)	0.38 (9.7)	37	Green
54153BS	1/0	100	225/24	1	1	1	1	1	5/16	1.63 (41.4)	0.71 (18.0)	0.75 (19.1)	0.14 (3.6)	0.38 (9.7)	42	Pink
54110BS	2/0	125	275/24	1/0	1/0	1/0	1/0	1/0	3/8	1.88 (47.8)	0.81 (20.6)	0.81 (20.6)	0.14 (3.6)	0.38 (9.7)	45	Black
54165BS	3/0	150	325/24	2/0	2/0	2/0	2/0	2/0	1/2	2.21 (56.1)	1.06 (40.6)	0.93 (23.6)	0.14 (3.6)	0.50 (12.7)	50	Orange
54170BS	4/0	200	450/24	3/0	3/0	3/0	3/0	3/0	1/2	2.31 (58.7)	1.06 (40.6)	1.03 (33.0)	0.15 (3.8)	0.50 (12.7)	54	Purple
58165BS	250	–	550/24	4/0	4/0	4/0	4/0	4/0	1/2	2.46 (62.5)	1.12 (28.4)	1.25 (31.8)	0.18 (4.6)	0.50 (12.7)	62	Yellow
54114BS	300	300	650/24	250	250	250	250	–	1/2	2.46 (62.5)	1.12 (28.4)	1.25 (31.8)	0.18 (4.6)	0.50 (12.7)	66	White
5411440BS	300	300	650/24	250	250	250	250	–	1/2	2.38 (60.5)	1.12 (28.4)	1.25 (31.8)	0.18 (4.6)	0.50 (12.7)	66	White
54115260BS	350	350	650/24	–	–	250	250	250	1/2	2.63 (66.8)	1.18 (30.0)	1.38 (35.1)	0.20 (5.1)	0.56 (14.2)	66	White
54185BS	400	400	775/24	300	300	300	300	300	5/8	3.43 (87.1)	1.68 (42.7)	1.40 (35.6)	0.21 (5.3)	0.81 (20.6)	76	Blue
58177BS	500	–	925/24	400	400	400	400	400	5/8	3.00 (76.2)	1.31 (33.3)	1.63 (41.4)	0.25 (6.4)	0.81 (20.6)	80	N/A
58180BS	600	–	1100/24	–	–	450	450	450	5/8	3.63 (92.2)	1.68 (42.7)	1.78 (45.2)	0.26 (6.6)	0.81 (20.6)	94	Green
54122BS	700	–	1325/24	500	500	500	500	500	5/8	3.63 (92.2)	1.68 (42.7)	1.78 (45.2)	0.28 (7.1)	0.81 (20.6)	99	Pink
54123BS	750	–	–	600	–	–	–	550	5/8	3.63 (92.2)	1.68 (42.7)	1.93 (49.0)	0.31 (7.9)	0.81 (20.6)	106	Black
54124BS	800	800	–	–	–	–	600	–	5/8	3.81 (96.8)	1.68 (42.7)	2.00 (50.8)	0.31 (7.9)	0.63 (16.0)	107	Orange
54126BS	900	–	1925/24	–	–	750	–	–	5/8	4.12 (104.6)	1.81 (46.0)	2.18 (55.4)	0.37 (9.4)	0.88 (22.4)	115	Yellow

Tooling: pp. 112–141 Die Selector Chart: pp. 142–149  
Stranding will differ per class

‡ For installations from 16 kV up to 35 kV, consult shielded cable manufacturers for stress relief and insulation requirements.

## Connectors for Copper Conductors

**Bell Ended Lugs –  
Long Barrel  
Certified to 600V  
and Recommended  
up to 35 kV\***

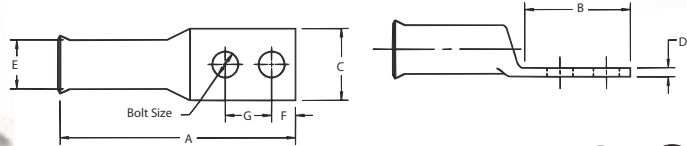

C o m p r e s s i o n

CAT. NO.	WIRE SIZE			Class					Bolt Size (in.)	Dimensions in. (mm)							Die Code	Die Color
	Code	Navy	Flex	G	H	I	K	M		A	B	C	D	E	F	G		
54850BEBS	8	23	8	8	8	-	8	-	1/4	2.19 (55.6)	1.88 (47.8)	0.42 (10.7)	0.07 (1.8)	0.26 (6.6)	0.25 (6.4)	0.63 (16.0)	21	Red
54851BEBS	8	23	8	8	8	-	8	-	1/4	2.31 (58.7)	1.59 (32.8)	0.47 (11.9)	0.06 (1.5)	0.26 (6.6)	0.25 (6.4)	0.75 (19.1)	21	Red
54851BE0616BS	8	23	8	8	8	-	8	-	3/8	3.00 (76.2)	2.10 (53.3)	0.56 (14.2)	0.06 (1.5)	0.26 (6.6)	0.38 (9.7)	1.00 (25.4)	21	Red
54852BE0616BS	6	30	6	5	5	5	5	-	3/8	2.93 (74.4)	1.93 (49.0)	0.59 (15.0)	0.06 (1.5)	0.30 (7.6)	0.38 (9.7)	1.00 (25.4)	24	Blue
54852BEBS	6	30	6	5	5	5	5	-	1/4	2.28 (57.9)	1.28 (32.5)	0.44 (11.2)	0.08 (2.0)	0.30 (7.6)	0.25 (6.4)	0.63 (16.0)	24	Blue
54852BE0412BS	6	30	6	5	5	5	5	-	1/4	2.43 (61.7)	1.43 (36.3)	0.43 (10.9)	0.07 (1.8)	0.30 (7.6)	0.25 (6.4)	0.75 (19.1)	24	Blue
54854BEBS	4-3	40-50	5	5	5	5	5	-	1/4	2.43 (61.7)	1.19 (30.2)	0.52 (13.2)	0.10 (2.5)	0.37 (9.4)	0.25 (6.4)	0.63 (16.0)	29	Grey
54854BE0412BS	4-3	40-50	5	5	5	5	5	-	1/4	2.31 (58.7)	1.31 (33.3)	0.56 (14.2)	0.09 (2.3)	0.37 (9.4)	0.25 (6.4)	0.75 (19.1)	29	Grey
54854BE0616BS	4-3	40-50	5	5	5	5	5	-	3/8	3.13 (79.5)	1.98 (50.3)	0.59 (15.0)	0.09 (2.3)	0.37 (9.4)	0.38 (9.7)	1.00 (25.4)	29	Grey
54855BE0412BS	2	60	3	3	3	3	3	3	1/4	2.63 (66.8)	1.35 (34.3)	0.68 (17.3)	0.11 (2.8)	0.41 (10.4)	0.25 (6.4)	0.75 (19.1)	33	Brown
54855BEBS	2	60	3	3	3	3	3	3	1/4	2.43 (61.7)	1.38 (35.1)	0.59 (15.0)	0.11 (2.8)	0.41 (10.4)	0.25 (6.4)	0.63 (16.0)	33	Brown
54856BEBS	2	60	3	3	3	3	3	3	3/16	2.78 (70.6)	1.63 (41.4)	0.59 (15.0)	0.11 (2.8)	0.41 (10.4)	0.38 (9.7)	0.75 (19.1)	33	Brown
54810BE0616BS	2	60	3	3	3	3	3	3	3/8	3.08 (96.5)	1.94 (49.3)	0.59 (15.0)	0.11 (2.8)	0.41 (10.4)	0.38 (9.7)	1.00 (25.4)	33	Brown
54811BEBS	2	60	3	3	3	3	3	3	1/2	4.28 (108.7)	3.00 (76.2)	0.88 (22.4)	0.09 (2.3)	0.41 (10.4)	0.50 (12.7)	1.75 (44.5)	33	Brown
54809BEBS	1	75	2	2	2	2	2	2	1/4	2.88 (73.2)	1.19 (30.2)	0.67 (17.0)	0.11 (2.8)	0.47 (11.9)	0.25 (6.4)	0.63 (16.0)	37	Green
54812BEBS	1	75	2	2	2	2	2	2	1/4	2.75 (69.9)	1.40 (35.6)	0.67 (17.0)	0.11 (2.8)	0.47 (11.9)	0.25 (6.4)	0.75 (19.1)	37	Green
54858BEBS	1	75	2	2	2	2	2	2	5/16	2.97 (75.4)	1.63 (41.4)	0.67 (17.0)	0.11 (2.8)	0.47 (11.9)	0.38 (9.7)	0.88 (22.4)	37	Green
54857BEBS	1	75	2	2	2	2	2	2	1/2	4.43 (112.5)	3.00 (76.2)	0.88 (22.4)	0.10 (2.5)	0.47 (11.9)	0.50 (12.7)	1.75 (44.5)	37	Green
54859BEBS	1/0	100	1	1	1	1	1	1	1/4	2.63 (66.8)	1.19 (30.2)	0.75 (19.1)	0.13 (3.3)	0.52 (13.2)	0.25 (6.4)	0.63 (16.0)	42	Pink
54813BEBS	1/0	100	1	1	1	1	1	1	1/4	2.71 (68.8)	1.38 (35.1)	0.75 (19.1)	0.13 (3.3)	0.52 (13.2)	0.25 (6.4)	0.75 (19.1)	42	Pink
54860BEBS	1/0	100	1	1	1	1	1	1	5/16	2.97 (75.4)	1.63 (41.4)	0.75 (19.1)	0.13 (3.3)	0.52 (13.2)	0.38 (9.7)	0.88 (22.4)	42	Pink
54860BE0616BS	1/0	100	1	1	1	1	1	1	3/8	3.23 (82.0)	1.93 (49.0)	0.75 (19.1)	0.13 (3.3)	0.52 (13.2)	0.38 (9.7)	1.00 (25.4)	42	Pink
54814BEBS	2/0	125	1/0	1/0	1/0	1/0	1/0	1/0	1/4	2.62 (66.5)	1.25 (31.8)	0.83 (21.1)	0.13 (3.3)	0.57 (14.5)	0.25 (6.4)	0.63 (16.0)	45	Black
54814BE0412BS	2/0	125	1/0	1/0	1/0	1/0	1/0	1/0	1/4	2.69 (68.3)	1.31 (33.3)	0.81 (20.6)	0.13 (3.3)	0.57 (14.5)	0.25 (6.4)	0.75 (19.1)	45	Black
54862BE0616BS	2/0	125	1/0	1/0	1/0	1/0	1/0	1/0	3/8	3.19 (81.0)	1.81 (46.0)	0.83 (21.1)	0.13 (3.3)	0.57 (14.5)	0.38 (9.7)	1.00 (25.4)	45	Black
54862BEBS	2/0	125	1/0	1/0	1/0	1/0	1/0	1/0	1/2	2.20 (55.9)	2.81 (71.4)	0.83 (21.1)	0.13 (3.3)	0.57 (14.5)	0.50 (12.7)	1.75 (44.5)	45	Black
54815BEBS	3/0	150	2/0	2/0	2/0	2/0	2/0	2/0	1/4	2.89 (73.4)	1.45 (36.8)	0.92 (23.4)	0.13 (3.3)	0.63 (16.0)	0.25 (6.4)	0.75 (19.1)	50	Orange
54816BEBS	3/0	150	2/0	2/0	2/0	2/0	2/0	2/0	3/8	3.25 (82.6)	1.63 (41.4)	0.92 (23.4)	0.13 (3.3)	0.63 (16.0)	0.38 (9.7)	1.00 (25.4)	50	Orange
54864BEBS	3/0	150	2/0	2/0	2/0	2/0	2/0	2/0	1/2	4.45 (113.0)	3.00 (76.2)	0.92 (23.4)	0.13 (3.3)	0.63 (16.0)	0.50 (12.7)	1.75 (44.5)	50	Orange
54817BEBS	4/0	200	3/0	3/0	3/0	3/0	3/0	3/0	1/4	3.15 (80.0)	1.38 (35.1)	1.03 (26.2)	0.14 (3.6)	0.70 (17.8)	0.50 (12.7)	0.75 (19.1)	54	Purple
54818BE0616BS	4/0	200	3/0	3/0	3/0	3/0	3/0	3/0	3/8	3.35 (85.1)	1.81 (46.0)	1.03 (26.2)	0.14 (3.6)	0.70 (17.8)	0.25 (6.4)	1.00 (25.4)	54	Purple
54818BEBS	4/0	200	3/0	3/0	3/0	3/0	3/0	3/0	3/8	4.38 (111.3)	2.63 (66.8)	1.03 (26.2)	0.14 (3.6)	0.70 (17.8)	0.38 (9.7)	1.75 (44.5)	54	Purple
54866BEBS	4/0	200	3/0	3/0	3/0	3/0	3/0	3/0	1/2	4.70 (119.4)	3.00 (76.2)	1.03 (26.2)	0.14 (3.6)	0.70 (17.8)	0.50 (12.7)	1.75 (44.5)	54	Purple
54868BE0616BS	250	-	4/0	4/0	4/0	4/0	4/0	4/0	3/8	3.83 (97.3)	1.93 (49.0)	1.13 (28.7)	0.14 (3.6)	0.77 (19.6)	0.50 (12.7)	1.00 (25.4)	62	Yellow
54868BEBS	250	-	4/0	4/0	4/0	4/0	4/0	4/0	1/2	4.92 (125.0)	3.00 (76.2)	1.13 (28.7)	0.14 (3.6)	0.77 (19.6)	0.50 (12.7)	1.75 (44.5)	62	Yellow
54819BEBS	300	300	262 kcmil	250 kcmil	250	250	250	-	3/8	5.04 (137.2)	2.80 (71.1)	1.25 (31.8)	0.15 (3.8)	0.85 (21.6)	0.50 (12.7)	1.00 (25.4)	66	White
54870BEBS	300	300	262 kcmil	250 kcmil	250	250	250	-	1/2	5.23 (132.8)	3.00 (76.2)	1.25 (31.8)	0.15 (3.8)	0.85 (21.6)	0.50 (12.7)	1.75 (44.5)	66	White
54822BEBS	400	400	313 kcmil	300 kcmil	300	300	300	-	1/4	4.38 (111.3)	1.93 (49.0)	1.41 (35.8)	0.17 (4.3)	0.96 (24.4)	0.63 (16.0)	0.75 (19.1)	76	Blue
54821BEBS	400	400	313 kcmil	300 kcmil	300	300	300	-	3/8	4.43 (112.5)	1.93 (49.0)	1.41 (35.8)	0.17 (4.3)	0.96 (24.4)	0.63 (16.0)	1.00 (25.4)	76	Blue
54874BEBS	400	400	313 kcmil	300 kcmil	300	300	300	-	1/2	5.51 (140.0)	3.00 (76.2)	1.41 (35.8)	0.17 (4.3)	0.96 (24.4)	0.63 (16.0)	1.75 (44.5)	76	Blue
54823BEBS	500	-	373 kcmil	400 kcmil	400	400	400	-	1/4	4.93 (125.2)	1.94 (49.3)	1.61 (40.9)	0.22 (5.6)	1.10 (27.9)	0.50 (12.7)	0.75 (19.1)	87	Brown
54876BE0616BS	500	-	373 kcmil	400 kcmil	400	400	400	-	3/8	5.00 (127.0)	1.93 (49.0)	1.61 (40.9)	0.22 (5.6)	1.10 (27.9)	0.50 (12.7)	1.00 (25.4)	87	Brown
54876BEBS	500	-	373 kcmil	400 kcmil	400	400	400	-	1/2	6.00 (152.4)	3.00 (76.2)	1.61 (40.9)	0.22 (5.6)	1.10 (27.9)	0.50 (12.7)	1.75 (44.5)	87	Brown
54824BEBS	-	-	444 kcmil	-	-	450	450	-	3/8	5.70 (144.8)	2.80 (71.1)	1.75 (44.5)	0.24 (6.1)	1.20 (30.5)	0.63 (16.0)	1.00 (25.4)	94	Green
54878BEBS	-	-	444 kcmil	-	-	450	450	-	1/2	5.83 (148.1)	3.00 (76.2)	1.75 (44.5)	0.24 (6.1)	1.20 (30.5)	0.63 (16.0)	1.75 (44.5)	94	Green
54880BEBS	700	-	535 kcmil	500 kcmil	500	500	500	-	1/2	6.20 (157.5)	3.00 (76.2)	1.94 (49.3)	0.27 (6.9)	1.33 (33.8)	0.63 (16.0)	1.75 (44.5)	106	Black
58826BEBS	900	-	777 kcmil	-	-	750	-	-	3/8	6.49 (164.8)	2.80 (71.1)	2.27 (57.7)	0.30 (7.6)	1.50 (38.1)	0.63 (16.0)	1.00 (25.4)	115	Yellow

Tooling: pp. 112-141 Die Selector Chart: pp. 142-149  
Stranding will differ per class

\* For installations from 16 kV up to 35 kV, consult shielded cable manufacturers for stress relief and insulation requirements.