

Connectors for Copper Conductors

Peep Holes Available!
Add suffix -PH

**Two-Hole Lugs
Long Barrel
Certified to 600V
and Recommended
up to 35 kV***

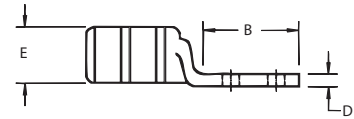
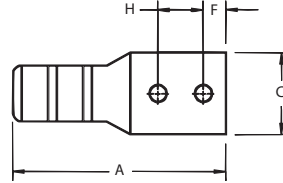

Material: High-Conductivity
Wrought Copper

Finish: Electro Tin Plate

C o m p r e s s i o n

CAT. NO.	WIRE SIZE		Bolt Size	Dimensions in. (mm)							Die Code	Die Color		
	Code	Flex Class G, H, I, K, M		A	B	C	D	E	F	H				
54801BE	#14-10 AWG		1/4	1.86 (47.2)	1.19 (30.2)	0.50 (12.7)	0.05 (1.3)	0.20 (5.1)	0.25 (6.4)	0.63 (16.0)	ERG2002	Yellow		
256-31426-3			#10	2.00 (50.8)	1.25 (31.2)	0.37 (9.4)	0.07 (1.8)	0.20 (5.1)	0.25 (6.4)	0.63 (16.0)	ERG2002	Yellow		
256-31426-3SPH			#10	2.00 (50.8)	1.25 (31.2)	0.37 (9.4)	0.07 (1.8)	0.20 (5.1)	0.22 (5.6)	0.63 - 0.75 (16.0) - (19.1)	ERG2002	Yellow		
256-30695-1298			1/4	1.89 (48.0)	1.22 (31.0)	0.50 (12.7)	0.05 (1.3)	0.20 (5.1)	0.25 (6.4)	0.63 (16.0)	ERG2002	Yellow		
256-30695-1730			1/4	1.98 (50.3)	1.31 (33.3)	0.50 (12.7)	0.05 (1.3)	0.20 (5.1)	0.25 (6.4)	0.63 - 0.75 (16.0) - (19.1)	ERG2002	Yellow		
54850BE	#8 AWG	# 8 AWG, #8 Weld 37/24	1/4	2.19 (55.6)	1.89 (48.0)	0.42 (10.7)	0.07 (1.78)	0.26 (6.6)	0.25 (6.4)	0.63 (16.0)	21	Red		
54851BE			1/4	2.31 (58.7)	1.29 (32.8)	0.47 (11.9)	0.06 (1.52)	0.26 (6.6)	0.25 (6.4)	0.75 (19.1)	21	Red		
256-30695-1157			3/8	3.00 (76.2)	2.10 (53.3)	0.56 (14.2)	0.06 (1.52)	0.26 (6.6)	0.38 (9.7)	1.00 (25.4)	21	Red		
54852BE	#6 AWG	#6 AWG, 61/24, #6 Weld	1/4	2.28 (57.9)	1.28 (32.5)	0.44 (11.1)	0.08 (2.03)	0.30 (7.6)	0.25 (6.4)	0.63 (16.0)	24	Blue		
256-30695-1014			1/4	2.63 (66.8)	1.63 (41.4)	0.43 (10.9)	0.08 (2.03)	0.30 (7.6)	0.25 (6.4)	1.00 (25.4)	24	Blue		
256-30695-1225			1/4	2.43 (61.7)	1.43 (36.3)	0.43 (10.9)	0.08 (2.03)	0.30 (7.6)	0.25 (6.4)	0.75 (19.1)	24	Blue		
256-30695-1158			3/8	2.93 (74.4)	1.93 (49.0)	0.59 (14.9)	0.06 (1.52)	0.30 (7.6)	0.38 (9.7)	1.00 (25.4)	24	Blue		
256-30695-868			1/2	4.18 (106.2)	3.00 (76.2)	0.88 (22.4)	0.11 (2.8)	0.30 (7.6)	0.50 (12.7)	1.75 (44.5)	24	Blue		
54854BE	#4 AWG	91/24, #5 AWG, #4 Weld	1/4	2.31 (58.7)	1.19 (30.2)	0.52 (13.1)	0.10 (2.5)	0.37 (9.4)	0.25 (6.4)	0.63 (16.0)	29	Grey		
256-30695-1246			1/4	2.31 (54.1)	1.31 (33.3)	0.56 (14.2)	0.09 (2.3)	0.37 (9.4)	0.25 (6.4)	0.75 (19.1)	29	Grey		
256-30695-1015			1/4	2.88 (73.2)	1.88 (47.8)	0.58 (14.7)	0.09 (2.3)	0.37 (9.4)	0.38 (9.7)	1.00 (25.4)	29	Grey		
256-30695-1337			5/16	2.75 (69.9)	1.75 (44.5)	0.56 (14.2)	0.10 (2.5)	0.37 (9.4)	0.34 (8.4)	1.00 (25.4)	29	Grey		
256-30695-1159			3/8	3.13 (79.5)	1.98 (50.3)	0.59 (14.9)	0.09 (2.3)	0.37 (9.4)	0.38 (9.7)	1.00 (25.4)	29	Grey		
256-30695-733			1/2	4.18 (106.2)	3.00 (76.2)	0.88 (22.4)	0.09 (2.3)	0.37 (9.4)	0.50 (12.7)	1.75 (44.5)	29	Grey		
256-30695-1016	#2-3 AWG	#3 AWG, 125/24	1/4	3.06 (77.7)	1.88 (47.8)	0.67 (17.0)	0.09 (2.3)	0.41 (10.4)	0.38 (9.7)	1.00 (25.4)	33	Brown		
54855BE			1/4	2.43 (61.7)	1.28 (32.5)	0.59 (14.9)	0.11 (2.8)	0.41 (10.4)	0.50 (12.7)	0.63 (16.0)	33	Brown		
256-30695-1300			1/4	2.63 (66.8)	1.35 (34.3)	0.68 (17.3)	0.11 (2.8)	0.41 (10.4)	0.25 (6.4)	0.75 (19.1)	33	Brown		
54856BE			5/16	2.78 (70.6)	1.63 (41.4)	0.59 (14.9)	0.11 (2.8)	0.41 (10.4)	0.38 (9.7)	0.75 (19.1)	33	Brown		
54810BE			3/8	3.80 (96.5)	2.57 (65.3)	0.59 (14.9)	0.11 (2.8)	0.41 (10.4)	0.38 (9.7)	1.75 (44.5)	33	Brown		
256-30695-1160			3/8	3.08 (78.2)	1.94 (49.3)	0.59 (14.9)	0.11 (2.8)	0.41 (10.4)	0.38 (9.7)	1.00 (25.4)	33	Brown		
256-30695-869			1/2	4.02 (102.1)	2.88 (73.2)	0.25 (6.4)	0.75 (19.1)	0.41 (10.4)	0.63 (16.0)	1.75 (44.5)	33	Brown		
54811BE			1/2	4.28 (108.7)	3.00 (76.2)	0.88 (22.4)	0.11 (2.8)	0.41 (10.4)	0.50 (12.7)	1.50 (38.1)	33	Brown		
54809BE			#1 AWG	#2 AWG 150/24 175/24 #2 Weld	1/4	2.88 (73.2)	1.19 (30.2)	0.67 (17.0)	0.11 (2.8)	0.47 (11.9)	0.25 (6.4)	0.63 (16.0)	37	Green
54812BE					1/4	2.75 (69.9)	1.40 (35.6)	0.67 (17.0)	0.11 (2.8)	0.47 (11.9)	0.25 (6.4)	0.75 (19.1)	37	Green
54858BE	5/16	2.94 (75.4)			1.63 (41.4)	0.67 (17.0)	0.11 (2.8)	0.47 (11.9)	0.38 (9.7)	0.88 (22.4)	37	Green		
256-30695-1161	3/8	3.30 (83.8)			1.98 (50.3)	0.67 (17.0)	0.11 (2.8)	0.47 (11.9)	0.38 (9.7)	1.00 (25.4)	37	Green		
54857BE	1/2	4.43 (112.5)			3.00 (76.2)	0.88 (22.4)	0.11 (2.8)	0.47 (11.9)	0.50 (12.7)	1.75 (44.5)	37	Green		
256-30695-1018	1/0 AWG	#1 AWG, 225/24	1/4	3.63 (92.2)	1.88 (47.8)	0.75 (19.0)	0.13 (3.3)	0.52 (13.2)	0.38 (9.7)	1.00 (25.4)	42	Pink		
256-30695-1018P			1/4	3.63 (92.2)	1.88 (47.8)	0.75 (19.0)	0.13 (3.3)	0.52 (13.2)	0.38 (9.7)	1.00 (25.4)	42	Pink		
54859BE			1/4	2.63 (66.8)	1.19 (30.2)	0.75 (19.0)	0.13 (3.3)	0.52 (13.2)	0.25 (6.4)	0.63 (16.0)	42	Pink		
54813BE			1/4	2.71 (68.8)	1.38 (35.1)	0.75 (19.0)	0.13 (3.3)	0.52 (13.2)	0.25 (6.4)	0.75 (19.1)	42	Pink		
54860BE			5/16	2.97 (75.4)	1.63 (41.4)	0.75 (19.0)	0.13 (3.3)	0.52 (13.2)	0.50 (12.7)	0.88 (22.4)	42	Pink		
256-30695-1162P			3/8	3.25 (82.3)	1.98 (50.3)	0.75 (19.0)	0.13 (3.3)	0.52 (13.2)	0.38 (9.7)	1.00 (25.4)	42	Pink		
256-30695-1162			3/8	3.23 (82.0)	1.93 (49.0)	0.75 (19.0)	0.13 (3.3)	0.52 (13.2)	0.38 (9.7)	1.00 (25.4)	42	Pink		
256-30695-593	1/2	4.33 (110.0)	3.00 (76.2)	0.75 (19.0)	0.13 (3.3)	0.52 (13.2)	0.63 (16.0)	1.75 (44.5)	42	Pink				

Tooling: pp. 116-145

Die Selector Chart: pp.146-153

* For installations from 16 kV up to 35 kV, consult shielded cable manufacturers for stress relief and insulation requirements.

Connectors for Copper Conductors

**Two-Hole Lugs
Long Barrel
Certified to 600V
and Recommended
up to 35 kV[‡](Continued)**



Peep Holes Available!
Add suffix -PH

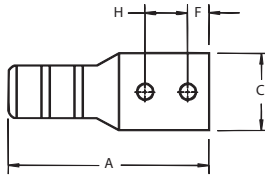

Material: High-Conductivity Wrought Copper

Finish: Electro Tin Plate



C O M P R E S S I O N

CAT. NO.	WIRE SIZE		Bolt Size	Dimensions in. (mm)							Die Code	Die Color
	Code	Flex Class G, H, I, K, M		A	B	C	D	E	F	H		
54814BE	2/0 AWG	1/0 AWG, 1/0 Weld 275/24	1/4	2.62 (66.5)	1.25 (31.8)	0.83 (21.1)	0.13 (3.3)	0.57 (14.5)	0.25 (6.4)	0.63 (16.0)	45	Black
256-30695-1299			1/4	2.69 (68.3)	1.31 (33.3)	0.81 (20.6)	0.13 (3.3)	0.57 (14.5)	0.25 (6.4)	0.75 (19.1)	45	Black
256-30695-1116			3/8	3.19 (81.0)	1.81 (46.0)	0.83 (21.1)	0.13 (3.3)	0.57 (14.5)	0.38 (9.7)	1.00 (25.4)	45	Black
256-30695-1116P			3/8	3.19 (81.0)	1.81 (46.0)	0.83 (21.1)	0.13 (3.3)	0.57 (14.5)	0.38 (9.7)	1.00 (25.4)	45	Black
54862BE			1/2	4.20 (106.7)	2.81 (71.4)	0.83 (21.1)	0.13 (3.3)	0.57 (14.5)	0.50 (12.7)	1.75 (44.5)	45	Black
54815BE	3/0 AWG	2/0 AWG, 2/0 Weld 325/24	1/4	2.89 (73.4)	1.45 (36.8)	0.92 (23.4)	0.13 (3.3)	0.63 (16.0)	0.25 (6.4)	0.75 (19.1)	50	Orange
54816BE			3/8	3.25 (82.6)	1.63 (41.4)	0.92 (23.4)	0.13 (3.3)	0.63 (16.0)	0.38 (9.7)	1.00 (25.4)	50	Orange
54864BE			1/2	4.48 (113.8)	3.00 (76.2)	0.94 (23.9)	0.13 (3.3)	0.63 (16.0)	0.50 (12.7)	1.75 (44.5)	50	Orange
54817BE	4/0 AWG	3/0 AWG, 3/0 Weld 450/24	1/4	3.15 (80.0)	1.38 (35.1)	1.03 (33.0)	0.14 (3.6)	0.70 (17.8)	0.25 (6.4)	0.75 (19.1)	54	Purple
54818BE			3/8	4.38 (111.3)	2.63 (66.8)	1.03 (33.0)	0.14 (3.6)	0.70 (17.8)	0.38 (9.7)	1.75 (44.5)	54	Purple
256-30695-1117			3/8	3.35 (85.1)	1.81 (46.0)	1.03 (33.0)	0.14 (3.6)	0.70 (17.8)	0.38 (9.7)	1.00 (25.4)	54	Purple
256-30695-1117P			3/8	3.50 (88.9)	1.88 (47.8)	1.03 (33.0)	0.14 (3.6)	0.70 (17.8)	0.38 (9.7)	1.00 (25.4)	54	Purple
54866BE			1/2	4.70 (119.4)	3.00 (76.2)	1.03 (33.0)	0.14 (3.6)	0.70 (17.8)	0.50 (12.7)	1.75 (44.5)	54	Purple
256-30695-1245	250 kcmil	4/0 AWG, 4/0 Weld 550/24	3/8	3.83 (97.3)	1.93 (49.0)	1.13 (28.7)	0.14 (3.6)	0.77 (19.6)	0.38 (9.7)	1.00 (25.4)	62	Yellow
256-30695-1245P			3/8	3.83 (97.3)	1.93 (49.0)	1.13 (28.7)	0.14 (3.6)	0.77 (19.6)	0.38 (9.7)	1.00 (25.4)	62	Yellow
54868BE			1/2	4.92 (125.0)	3.00 (76.2)	1.13 (28.7)	0.14 (3.6)	0.77 (19.6)	0.50 (12.7)	1.75 (44.5)	62	Yellow
54819BE	300 kcmil	250 kcmil 650/24 = 262 kcmil	3/8	5.04 (137.2)	2.80 (71.1)	1.25 (31.8)	0.15 (3.8)	0.85 (21.6)	0.38 (9.7)	1.00 (25.4)	66	White
54870BE			1/2	5.23 (132.8)	3.00 (76.2)	1.25 (31.8)	0.15 (3.8)	0.85 (21.6)	0.50 (12.7)	1.75 (44.5)	66	White
54820BE	350 kcmil	-	1/4	4.29 (109.0)	1.93 (49.0)	1.36 (34.5)	0.18 (4.6)	0.93 (23.6)	0.25 (6.4)	1.75 (44.5)	71	Red
256-30695-1118			3/8	4.33 (110.0)	1.93 (49.0)	1.36 (34.5)	0.18 (4.6)	0.93 (23.6)	0.38 (9.7)	1.00 (25.4)	71	Red
256-30695-1118P			3/8	4.33 (110.0)	1.93 (49.0)	1.36 (34.5)	0.18 (4.6)	0.93 (23.6)	0.38 (9.7)	1.00 (25.4)	71	Red
54872BE			1/2	5.40 (137.2)	3.00 (76.2)	1.36 (34.5)	0.18 (4.6)	0.93 (23.6)	0.50 (12.7)	1.75 (44.5)	71	Red
54822BE	400 kcmil	300 kcmil 775/24, 313 kcmil	1/4	4.38 (111.3)	1.93 (49.0)	1.41 (35.8)	0.17 (4.3)	0.96 (24.4)	0.25 (6.4)	0.75 (19.1)	76	Blue
54821BE			3/8	4.43 (112.5)	1.93 (49.0)	1.41 (35.8)	0.17 (4.3)	0.96 (24.4)	0.38 (9.7)	1.00 (25.4)	76	Blue
54874BE			1/2	5.51 (140.0)	3.00 (76.2)	1.41 (35.8)	0.17 (4.3)	0.96 (24.4)	0.50 (12.7)	1.75 (44.5)	76	Blue
54823BE	500 kcmil	400 kcmil 925/24, 350/373 kcmil	1/4	4.93 (125.2)	1.94 (49.3)	1.61 (40.9)	0.22 (5.6)	1.10 (27.9)	0.25 (6.4)	0.75 (19.1)	87	Brown
256-30695-1119			3/8	5.00 (127.0)	1.93 (49.0)	1.61 (40.9)	0.22 (5.6)	1.10 (27.9)	0.38 (9.7)	1.00 (25.4)	87	Brown
256-30695-1119P			3/8	5.00 (127.0)	1.93 (49.0)	1.61 (40.9)	0.22 (5.6)	1.10 (27.9)	0.38 (9.7)	1.00 (25.4)	87	Brown
54876BE			1/2	6.00 (152.4)	3.00 (76.2)	1.61 (40.9)	0.22 (5.6)	1.10 (27.9)	0.50 (12.7)	1.75 (44.5)	87	Brown
54824BE	600 kcmil	1100/24, 444 kcmil	3/8	5.70 (144.8)	2.80 (71.1)	1.75 (44.5)	0.24 (6.1)	1.20 (30.5)	0.38 (9.7)	1.00 (25.4)	94	Green
54878BE	700 kcmil	1325/24, 535 kcmil	1/2	5.83 (148.1)	3.00 (76.2)	1.75 (44.5)	0.24 (6.1)	1.20 (30.5)	0.50 (12.7)	1.75 (44.5)	94	Green
54879BE			1/2	5.83 (148.1)	3.00 (76.2)	1.80 (45.7)	0.24 (6.1)	1.25 (31.8)	0.50 (12.7)	1.75 (44.5)	99	Pink
256-30695-1222	750 kcmil	1325/24, 535 kcmil	3/8	5.25 (133.4)	2.06 (52.3)	1.94 (49.3)	0.27 (6.7)	1.33 (33.8)	0.50 (12.7)	1.00 (25.4)	106	Black
256-30695-1222P			3/8	5.25 (133.4)	2.06 (52.3)	1.94 (49.3)	0.27 (6.7)	1.33 (33.8)	0.50 (12.7)	1.00 (25.4)	106	Black
54880BE			1/2	6.20 (157.5)	3.00 (76.2)	1.94 (49.3)	0.27 (6.9)	1.33 (33.8)	0.50 (12.7)	1.75 (44.5)	106	Black
58884BE	900 kcmil	1600/24, 646 kcmil	1/2	6.16 (156.5)	3.00 (76.2)	1.94 (49.3)	0.27 (6.9)	1.33 (33.8)	0.50 (12.7)	1.75 (44.5)	106	Black
58826BE			1/2	6.74 (171.2)	3.00 (76.2)	2.18 (55.4)	0.31 (7.9)	1.50 (38.1)	0.50 (12.7)	1.75 (44.5)	115	Yellow
54826BE	1000 kcmil	-	3/8	6.49 (164.8)	2.80 (71.1)	2.27 (57.7)	0.30 (7.6)	1.55 (39.4)	0.38 (9.7)	1.00 (25.4)	125	N/A
54882BE			1/2	6.66 (169.2)	3.00 (76.2)	2.27 (57.7)	0.30 (7.6)	1.55 (39.4)	0.38 (9.7)	1.75 (44.5)	125	N/A
54888BE			1/2	7.88 (200.2)	3.00 (76.2)	2.42 (61.5)	0.35 (8.9)	1.67 (42.4)	0.63 (16.0)	1.75 (44.5)	140	N/A

Tooling: pp. 116-145 Die Selector Chart: pp.146-153
[‡] For installations from 16 kV up to 35 kV, consult shielded cable manufacturers for stress relief and insulation requirements.

Connectors for Copper Conductors

**Two-Hole Lugs
45° Long Barrel
Certified to 600V
and Recommended
up to 35 kV***

Material: High-Conductivity
Wrought Copper

Finish: Electro Tin Plate

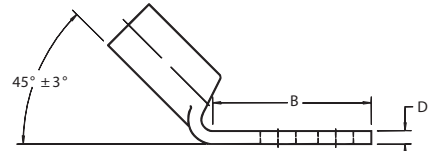
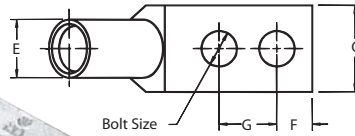
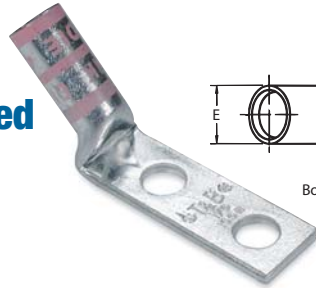

Peep Holes Available!
Add suffix -PH



C o m p r e s s i o n

CAT. NO.	WIRE SIZE		Bolt Size	Dimensions in. (mm)						Die Code	Color Code	
	Code	Flex Class G, H, I, K, M		B	C	D	E	F	G			
256-31426-3SPHUF	#14 – 10 AWG		#10	1.25 (31.75)	0.37 (9.4)	0.07 (1.8)	0.20 (5.1)	0.22 (5.6)	0.50 – 0.63 (12.7 – 16.0)	ERG2002	Yellow	
256-30695-1298UF			1/4	1.22 (31.0)	0.50 (12.7)	0.05 (1.3)	0.20 (5.1)	0.25 (6.4)	0.63 (16.0)	ERG2002	Yellow	
256-30695-1055UF			1/4	1.31 (33.3)	0.50 (12.7)	0.13 (3.3)	0.36 (9.1)	0.25 (6.4)	0.50 – 0.63 (12.7 – 16.0)	ERG2002	Yellow	
54850BEUF	#8 AWG	#8 AWG	1/4	1.89 (48.0)	0.42 (10.7)	0.07 (17.8)	0.26 (6.6)	0.25 (6.4)	0.63 (16.0)	21	Red	
54851BEUF		#8 Weld	1/4	1.29 (32.8)	0.47 (11.9)	0.06 (15.2)	0.26 (6.6)	0.25 (6.4)	0.75 (19.1)	21	Red	
54851BEUF0612			3/8	1.42 (36.1)	0.47 (11.9)	0.06 (15.2)	0.26 (6.6)	0.38 (9.7)	0.75 (19.1)	21	Red	
54852BEUF	#6 AWG	#6 AWG	1/4	1.28 (32.5)	0.44 (11.2)	0.08 (20.3)	0.30 (7.6)	0.25 (6.4)	0.38 (9.7)	24	Blue	
54852BEUF0416			#6 Weld	1/4	1.63 (41.4)	0.43 (10.9)	0.08 (20.3)	0.30 (7.6)	0.25 (6.4)	1.00 (25.4)	24	Blue
54852BEUF0412				1/4	1.43 (36.3)	0.43 (10.9)	0.08 (20.3)	0.30 (7.6)	0.25 (6.4)	0.75 (19.1)	24	Blue
54852BEUF0616				3/8	1.93 (49.0)	0.59 (15.0)	0.06 (15.2)	0.30 (7.6)	0.38 (9.7)	1.00 (25.4)	24	Blue
54852BEUF0828				1/2	3.00 (76.2)	0.88 (22.4)	0.11 (2.8)	0.30 (7.6)	0.50 (12.7)	1.75 (44.5)	24	Blue
54854BEUF	#4 AWG	#4 AWG	1/4	1.19 (30.2)	0.52 (13.2)	0.10 (2.5)	0.37 (9.4)	0.25 (6.4)	0.63 (16.0)	29	Grey	
54854BEUF0412			#4 Weld	1/4	1.31 (33.3)	0.56 (14.2)	0.09 (2.3)	0.37 (9.4)	0.25 (6.4)	0.75 (19.1)	29	Grey
54854BEUF0416				1/4	1.88 (47.8)	0.58 (14.7)	0.09 (2.3)	0.37 (9.4)	0.38 (9.7)	1.00 (25.4)	29	Grey
54854BEUF0516				5/16	1.75 (44.5)	0.56 (14.2)	0.10 (2.5)	0.37 (9.4)	0.63 (16.0)	1.00 (25.4)	29	Grey
54854BEUF0616				3/8	1.98 (50.3)	0.59 (15.0)	0.09 (2.3)	0.37 (9.4)	0.38 (9.7)	1.00 (25.4)	29	Grey
54854BEUF0828				1/2	3.00 (76.2)	0.88 (22.4)	0.09 (2.3)	0.37 (9.4)	0.50 (12.7)	1.75 (44.5)	29	Grey
54855BEUF0416	#2-3 AWG	#3 AWG	1/4	1.88 (47.8)	0.67 (17.0)	0.09 (2.3)	0.41 (10.4)	0.38 (9.7)	1.00 (25.4)	33	Brown	
54855BEUF			125/24	1/4	1.28 (32.5)	0.59 (15.0)	0.11 (2.8)	0.41 (10.4)	0.25 (6.4)	0.63 (16.0)	33	Brown
54855BEUF0412				1/4	1.35 (34.3)	0.68 (17.3)	0.11 (2.8)	0.41 (10.4)	0.25 (6.4)	0.75 (19.1)	33	Brown
54856BEUF				5/16	1.63 (41.4)	0.59 (15.0)	0.11 (2.8)	0.41 (10.4)	0.38 (9.7)	0.75 (19.1)	33	Brown
54810BEUF				3/8	2.57 (65.3)	0.59 (15.0)	0.11 (2.8)	0.41 (10.4)	0.38 (9.7)	1.75 (44.5)	33	Brown
54810BEUF0616				3/8	1.94 (49.3)	0.59 (15.0)	0.11 (2.8)	0.41 (10.4)	0.38 (9.7)	1.00 (25.4)	33	Brown
54811BEUF		1/2	3.00 (76.2)	0.88 (22.4)	0.11 (2.8)	0.41 (10.4)	0.50 (12.7)	1.75 (44.5)	33	Brown		
54809BEUF	#1 AWG	#2 AWG	1/4	1.19 (30.2)	0.67 (17.0)	0.11 (2.8)	0.47 (11.9)	0.25 (6.4)	0.63 (16.0)	37	Green	
54812BEUF			175/24	1/4	1.40 (35.6)	0.67 (17.0)	0.11 (2.8)	0.47 (11.9)	0.25 (6.4)	0.75 (19.1)	37	Green
54858BEUF			#2 Weld	5/16	1.63 (41.4)	0.67 (17.0)	0.11 (2.8)	0.47 (11.9)	0.63 (16.0)	0.88 (22.4)	37	Green
54857BEUF0616				3/8	1.98 (50.3)	0.67 (17.0)	0.11 (2.8)	0.47 (11.9)	0.38 (9.7)	1.00 (25.4)	37	Green
54857BEUF				1/2	3.00 (76.2)	0.88 (22.4)	0.11 (2.8)	0.47 (11.9)	0.50 (12.7)	1.75 (44.5)	37	Green
54859BEUF0416				1/4	1.88 (47.8)	0.75 (19.1)	0.13 (3.3)	0.52 (13.2)	0.38 (9.7)	1.00 (25.4)	42	Pink
54859BEUF0416PH		1/4	1.88 (47.8)	0.75 (19.1)	0.13 (3.3)	0.52 (13.2)	0.38 (9.7)	1.00 (25.4)	42	Pink		
54859BEUF	1/0 AWG	1 AWG	1/4	1.19 (30.2)	0.75 (19.1)	0.13 (3.3)	0.52 (13.2)	0.25 (6.4)	0.38 (9.7)	42	Pink	
54813BEUF			225/24	1/4	1.38 (35.1)	0.75 (19.1)	0.13 (3.3)	0.52 (13.2)	0.25 (6.4)	0.75 (19.1)	42	Pink
54860BEUF				5/16	1.63 (41.4)	0.75 (19.1)	0.13 (3.3)	0.52 (13.2)	0.38 (9.7)	0.88 (22.4)	42	Pink
54860BEUF0616				3/8	1.98 (50.3)	0.75 (19.1)	0.13 (3.3)	0.52 (13.2)	0.38 (9.7)	1.00 (25.4)	42	Pink
54860BEUF0616PH				3/8	1.93 (49.0)	0.75 (19.1)	0.13 (3.3)	0.52 (13.2)	0.38 (9.7)	1.00 (25.4)	42	Pink
54860BEUF0828				1/2	3.00 (76.0)	0.75 (19.1)	0.13 (3.3)	0.52 (13.2)	0.63 (16.0)	1.75 (44.5)	42	Pink
54814BEUF	2/0 AWG	1/0 AWG	1/4	1.25 (31.8)	0.83 (21.1)	0.13 (3.3)	0.57 (14.5)	0.25 (6.4)	0.63 (16.0)	45	Black	
54814BEUF0412			275/24	1/4	1.31 (33.3)	0.81 (20.6)	0.13 (3.3)	0.57 (14.5)	0.25 (6.4)	0.75 (19.1)	45	Black
54862BEUF0616			1/0 Weld	3/8	1.81 (46.0)	0.83 (21.1)	0.13 (3.3)	0.57 (14.5)	0.38 (9.7)	1.00 (25.4)	45	Black
54862BEUF0616PH				3/8	1.81 (46.0)	0.83 (21.1)	0.13 (3.3)	0.57 (14.5)	0.38 (9.7)	1.00 (25.4)	45	Black
54862BEUF				1/2	2.81 (71.4)	0.83 (21.1)	0.13 (3.3)	0.57 (14.5)	0.50 (12.7)	1.75 (44.5)	45	Black

Tooling: pp. 116-145

Die Selector Chart: pp.146-153

* For installations from 16 kV up to 35 kV, consult shielded cable manufacturers for stress relief and insulation requirements.

Connectors for Copper Conductors

Two-Hole Lugs
45° Long Barrel
Certified to 600V
and Recommended
up to 35 kV[‡](Continued)

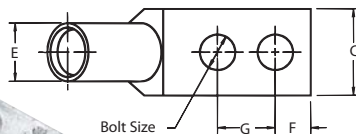
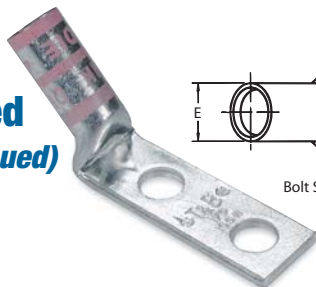

Peep Holes Available!
 Add suffix **-PH**

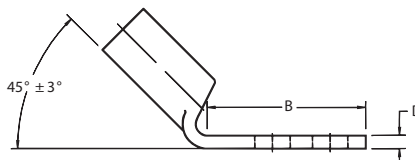

Material: High-Conductivity
 Wrought Copper

Finish: Electro Tin Plate

C O M P R E S S I O N

CAT. NO.	WIRE SIZE		Bolt Size	Dimensions in. (mm)						Die Code	Color Code
	Code	Flex Class G, H, I, K, M		B	C	D	E	F	G		
54815BEUF	3/0 AWG	2/0 AWG 325/24 2/0 Weld	1/4	1.45 (36.8)	0.92 (23.4)	0.13 (3.3)	0.63 (16.0)	0.25 (6.4)	0.75 (19.1)	50	Orange
54816BEUF			3/8	0.63 (41.4)	0.92 (23.4)	0.13 (3.3)	0.63 (16.0)	0.38 (9.7)	1.00 (25.4)	50	Orange
54864BEUF			1/2	3.00 (76.2)	0.94 (23.9)	0.13 (3.3)	0.63 (16.0)	0.50 (12.7)	1.75 (44.5)	50	Orange
54817BEUF	4/0 AWG	3/0 AWG 450/24 3/0 Weld	1/4	1.38 (35.1)	1.03 (33.0)	0.14 (3.6)	0.70 (17.8)	0.25 (6.4)	0.75 (19.1)	54	Purple
54818BEUF			3/8	2.63 (66.8)	1.03 (33.0)	0.14 (3.6)	0.70 (17.8)	0.38 (9.7)	1.75 (44.5)	54	Purple
54818BEUF0616			3/8	1.81 (46.0)	1.03 (33.0)	0.14 (3.6)	0.70 (17.8)	0.38 (9.7)	1.00 (25.4)	54	Purple
54818BEUF0616PH			3/8	1.88 (47.8)	1.03 (33.0)	0.14 (3.6)	0.70 (17.8)	0.38 (9.7)	1.00 (25.4)	54	Purple
54866BEUF			1/2	3.00 (76.2)	1.03 (33.0)	0.14 (3.6)	0.70 (17.8)	0.50 (12.7)	1.75 (44.5)	54	Purple
54868BEUF0616			1/2	3.00 (76.2)	1.03 (33.0)	0.14 (3.6)	0.70 (17.8)	0.50 (12.7)	1.75 (44.5)	54	Purple
54868BEUF0616	250 kcmil	4/0 AWG 550/24 4/0 Weld	3/8	1.93 (49.0)	1.13 (28.7)	0.14 (3.6)	0.77 (19.6)	0.38 (9.7)	1.00 (25.4)	62	Yellow
54868BEUF0616PH			5/8	1.93 (49.0)	1.13 (28.7)	0.14 (3.6)	0.77 (19.6)	0.38 (9.7)	1.00 (25.4)	62	Yellow
54868BEUF			1/2	3.00 (76.2)	1.13 (28.7)	0.14 (3.6)	0.77 (19.6)	0.50 (12.7)	1.75 (44.5)	62	Yellow
54819BEUF	300 kcmil	250 kcmil 650/24 = 262 kcmil	3/8	2.80 (71.1)	1.25 (31.8)	0.15 (3.8)	0.85 (21.6)	0.38 (9.7)	1.00 (25.4)	66	White
54870BEUF			1/2	3.00 (76.2)	1.25 (31.8)	0.15 (3.8)	0.85 (21.6)	0.50 (12.7)	1.75 (44.5)	66	White
54820BEUF	350 kcmil	650/24 262 kcmil	1/4	1.93 (49.0)	1.36 (34.5)	0.18 (4.6)	0.93 (23.6)	0.25 (6.4)	0.75 (19.1)	71	Red
54872BEUF0616			3/8	1.93 (49.0)	1.36 (34.5)	0.18 (4.6)	0.93 (23.6)	0.38 (9.7)	1.00 (25.4)	71	Red
54872BEUF0616PH			3/8	1.93 (49.0)	1.36 (34.5)	0.18 (4.6)	0.93 (23.6)	0.38 (9.7)	1.00 (25.4)	71	Red
54872BEUF			1/2	3.00 (76.2)	1.36 (34.5)	0.18 (4.6)	0.93 (23.6)	0.50 (12.7)	1.75 (44.5)	71	Red
54822BEUF	400 kcmil	775/24 313 kcmil	1/4	1.93 (49.0)	1.41 (35.8)	0.17 (4.3)	0.96 (24.4)	0.25 (6.4)	0.75 (19.1)	76	Blue
54821BEUF			3/8	1.93 (49.0)	1.41 (35.8)	0.17 (4.3)	0.96 (24.4)	0.38 (9.7)	1.00 (25.4)	76	Blue
54874BEUF			1/2	3.00 (76.2)	1.41 (35.8)	0.17 (4.3)	0.96 (24.4)	0.50 (12.7)	1.75 (44.5)	76	Blue
54823BEUF	500 kcmil	400 kcmil 925/24 350/373 kcmil	1/4	1.93 (49.0)	1.61 (40.9)	0.22 (5.6)	1.10 (27.9)	0.25 (6.4)	0.75 (19.1)	87	Brown
54876BEUF0616			3/8	1.93 (49.0)	1.61 (40.9)	0.22 (5.6)	1.10 (27.9)	0.38 (9.7)	1.00 (25.4)	87	Brown
54876BEUF0616PH			3/8	1.93 (49.0)	1.61 (40.9)	0.22 (5.6)	1.10 (27.9)	0.38 (9.7)	1.00 (25.4)	87	Brown
54876BEUF			1/2	3.00 (76.2)	1.61 (40.9)	0.22 (5.6)	1.10 (27.9)	0.50 (12.7)	1.75 (44.5)	87	Brown
54824BEUF	600 kcmil	1100/24 444 kcmil	3/8	2.80 (71.1)	1.75 (44.5)	0.24 (6.1)	1.20 (27.9)	0.38 (9.7)	1.00 (25.4)	94	Green
54878BEUF			1/2	3.00 (76.2)	1.75 (44.5)	0.24 (6.1)	1.20 (27.9)	0.50 (12.7)	1.75 (44.5)	94	Green
54880BEUF0616	750 kcmil	1325/24 535 kcmil	3/8	2.06 (52.3)	1.94 (49.3)	0.27 (6.9)	1.33 (33.8)	0.50 (12.7)	1.00 (25.4)	106	Black
54880BEUF0616PH			3/8	2.06 (52.3)	1.94 (49.3)	0.27 (6.9)	1.33 (33.8)	0.50 (12.7)	1.00 (25.4)	106	Black
54880BEUF			1/2	3.00 (76.2)	1.94 (49.3)	0.27 (6.9)	1.33 (33.8)	0.50 (12.7)	1.75 (44.5)	106	Black
58884BEUF		1600/24, 646 kcmil	1/2	3.00 (76.2)	1.94 (49.3)	0.27 (6.9)	1.33 (33.8)	0.50 (12.7)	1.75 (44.5)	106	Black
58826BEUF	900 kcmil	1925/24, 750/777 kcmil	1/2	3.00 (76.2)	2.18 (55.4)	0.31 (7.9)	1.50 (38.1)	0.50 (12.7)	1.75 (44.5)	115	Yellow
54826BEUF	1000 kcmil		3/8	2.80 (71.1)	2.27 (57.7)	0.30 (7.6)	1.55 (39.4)	0.38 (9.7)	1.00 (25.4)	125	N/A
54882BEUF			1/2	3.00 (76.2)	2.27 (57.7)	0.30 (7.6)	1.55 (39.4)	0.50 (12.7)	1.75 (44.5)	125	N/A

Tooling: pp. 116-145

Die Selector Chart: pp.146-153

‡ For installations from 16 kV up to 35 kV, consult shielded cable manufacturers for stress relief and insulation requirements.

Connectors for Copper Conductors

Two-Hole Lugs – 90° Long Barrel
Certified to 600V
and Recommended
up to 35 kV*
Applications

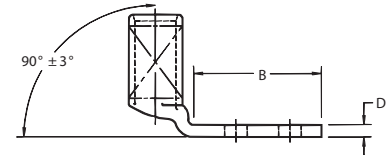
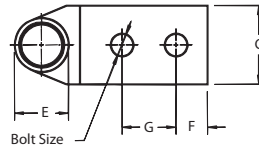

Peep Holes Available!
 Add suffix -PH

Material: High-Conductivity
 Wrought Copper
 Finish: Electro Tin Plate



C o m p r e s s i o n

CAT. NO.	WIRE SIZE		Bolt Size	Dimensions in. (mm)						Die Code	Color Code
	Code	Flex Class G, H, I, K, M		B	C	D	E	F	G		
54850BEUB	#8 AWG	#8 AWG 37/24 #8 Weld	1/4	1.89 (48.0)	0.42 (10.7)	0.07 (1.8)	0.26 (6.6)	0.21 (5.3)	0.63–0.75 (16.0–19.1)	21	Red
54851BEUB			1/4	0.29 (32.8)	0.47 (11.9)	0.06 (1.5)	0.26 (6.6)	0.25 (6.4)	0.75 (19.1)	21	Red
54851BEUB0616			3/8	2.10 (53.3)	0.56 (14.2)	0.06 (1.5)	0.26 (6.6)	0.38 (9.7)	1.00 (25.4)	21	Red
54852BEUB	#6 AWG	#6 AWG 61/24 #6 Weld	1/4	1.28 (32.5)	0.44 (11.2)	0.08 (2.0)	0.30 (7.6)	0.25 (6.4)	0.63 (16.0)	24	Blue
54852BEUB0412			1/4	1.43 (36.3)	0.43 (10.9)	0.08 (2.0)	0.30 (7.6)	0.25 (6.4)	0.75 (19.1)	24	Blue
54852BEUB0616			3/8	1.93 (49.0)	0.59 (15.0)	0.06 (1.5)	0.30 (7.6)	0.38 (9.7)	1.00 (25.4)	24	Blue
54852BEUB0828			1/2	3.00 (76.2)	0.88 (22.4)	0.11 (2.8)	0.30 (7.6)	0.50 (12.7)	1.75 (44.5)	24	Blue
54854BEUB	#4 AWG	#5 AWG 91/24 #4 Weld	1/4	1.19 (30.2)	0.52 (13.2)	0.10 (2.5)	0.37 (9.4)	0.25 (6.4)	0.63 (16.0)	29	Grey
54854BEUB0412			1/4	1.31 (33.3)	0.56 (14.2)	0.09 (2.3)	0.37 (9.4)	0.25 (6.4)	0.75 (19.1)	29	Grey
54854BEUB0416			1/4	1.88 (47.8)	0.58 (14.7)	0.09 (2.3)	0.37 (9.4)	0.38 (9.7)	1.00 (25.4)	29	Grey
54854BEUB0516			5/16	1.75 (44.5)	0.56 (14.2)	0.10 (2.5)	0.37 (9.4)	0.38 (9.7)	1.00 (25.4)	29	Grey
54854BEUB0616			3/8	1.98 (50.3)	0.59 (15.0)	0.09 (2.3)	0.37 (9.4)	0.38 (9.7)	1.00 (25.4)	29	Grey
54854BEUB0828			1/2	3.00 (76.2)	0.88 (22.4)	0.09 (2.3)	0.37 (9.4)	0.50 (12.7)	1.75 (44.5)	29	Grey
54858BEUB0416	#2-3 AWG	#3 AWG 125/24	1/4	1.88 (47.8)	0.67 (17.0)	0.09 (2.3)	0.41 (10.4)	0.38 (9.7)	1.00 (25.4)	33	Brown
54855BEUB			1/4	1.28 (32.5)	0.59 (15.0)	0.11 (2.8)	0.41 (10.4)	0.25 (6.4)	0.63 (16.0)	33	Brown
54855BEUB0412			1/4	1.35 (34.3)	0.68 (17.3)	0.11 (2.8)	0.41 (10.4)	0.25 (6.4)	0.75 (19.1)	33	Brown
54856BEUB			5/16	1.63 (41.4)	0.59 (15.0)	0.11 (2.8)	0.41 (10.4)	0.38 (9.7)	0.75 (19.1)	33	Brown
54810BEUB			3/8	2.57 (65.3)	0.59 (15.0)	0.11 (2.8)	0.41 (10.4)	0.38 (9.7)	1.75 (44.5)	33	Brown
54810BEUB0616			3/8	1.94 (49.3)	0.59 (15.0)	0.11 (2.8)	0.41 (10.4)	0.38 (9.7)	1.00 (25.4)	33	Brown
54811BEUB	#1 AWG	#2 AWG 150/24 175/24 #2 Weld	1/2	3.00 (76.2)	0.88 (22.4)	0.11 (2.8)	0.41 (10.4)	0.50 (12.7)	0.75 (19.1)	33	Brown
54809BEUB			1/4	1.19 (30.2)	0.67 (17.0)	0.11 (2.8)	0.47 (11.9)	0.25 (6.4)	0.63 (16.0)	37	Green
54812BEUB			1/4	1.40 (35.6)	0.67 (17.0)	0.11 (2.8)	0.47 (11.9)	0.25 (6.4)	0.75 (19.1)	37	Green
54858BEUB			5/16	1.63 (41.4)	0.67 (17.0)	0.11 (2.8)	0.47 (11.9)	0.38 (9.7)	0.88 (22.4)	37	Green
54857BEUB0616			3/8	1.98 (50.3)	0.67 (17.0)	0.11 (2.8)	0.47 (11.9)	0.38 (9.7)	1.00 (25.4)	37	Green
54857BEUB			1/2	3.00 (76.2)	0.88 (22.4)	0.11 (2.8)	0.47 (11.9)	0.50 (12.7)	1.75 (44.5)	37	Green
54859BEUB0416	1/0 AWG	1 AWG 225/24	1/4	1.88 (47.8)	0.75 (19.1)	0.13 (3.3)	0.52 (13.2)	0.38 (9.7)	1.00 (25.4)	42	Pink
54859BEUB0416PH			1/4	1.88 (47.8)	0.75 (19.1)	0.13 (3.3)	0.52 (13.2)	0.38 (9.7)	1.00 (25.4)	42	Pink
54859BEUB			1/4	1.19 (30.2)	0.75 (19.1)	0.13 (3.3)	0.52 (13.2)	0.25 (6.4)	0.63 (16.0)	42	Pink
54813BEUB			1/4	1.38 (35.1)	0.75 (19.1)	0.13 (3.3)	0.52 (13.2)	0.25 (6.4)	0.75 (19.1)	42	Pink
54860BEUB			5/16	1.63 (41.4)	0.75 (19.1)	0.13 (3.3)	0.52 (13.2)	0.38 (9.7)	0.88 (22.4)	42	Pink
54860BEUB0616			3/8	1.98 (50.3)	0.75 (19.1)	0.13 (3.3)	0.52 (13.2)	0.38 (9.7)	1.00 (25.4)	42	Pink
54860BEUB0828			1/2	3.00 (76.2)	0.75 (19.1)	0.13 (3.3)	0.52 (13.2)	0.38 (9.7)	1.75 (44.5)	42	Pink
54814BEUB			1/4	1.25 (31.8)	0.83 (21.1)	0.13 (3.3)	0.57 (14.5)	0.25 (6.4)	0.63 (16.0)	45	Black
54814BEUB0412			1/4	1.31 (33.3)	0.81 (20.6)	0.13 (3.3)	0.57 (14.5)	0.25 (6.4)	0.75 (19.1)	45	Black
54862BEUB0616			3/8	1.81 (46.0)	0.83 (21.1)	0.13 (3.3)	0.57 (14.5)	0.38 (9.7)	1.00 (25.4)	45	Black
54862BEUB0616PH	3/8	1.81 (46.0)	0.83 (21.1)	0.13 (3.3)	0.57 (14.5)	0.38 (9.7)	1.00 (25.4)	45	Black		
54862BEUB	1/2	2.81 (71.4)	0.83 (21.1)	0.13 (3.3)	0.57 (14.5)	0.50 (12.7)	0.75 (19.1)	45	Black		

Tooling: pp. 116–145

Die Selector Chart: pp. 146–153

* For installations from 16 kV up to 35 kV, consult shielded cable manufacturers for stress relief and insulation requirements.

Connectors for Copper Conductors

Two-Hole Lugs – 90° Long Barrel Certified to 600V and Recommended up to 35 kV*

(Continued)

Material: High-Conductivity
Wrought Copper

Finish: Electro Tin Plate

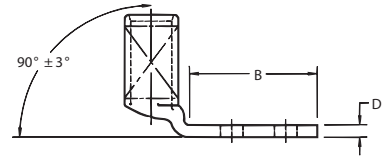
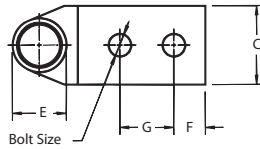

Peep Holes Available!
Add suffix -PH



C O M P R E S S I O N

CAT. NO.	Cable Code	WIRE SIZE		Dimensions in. (mm)						Die Code	Die Color
		Flex Class G, H, I, K, M	Bolt Size	B	C	D	E	F	G		
54815BEUB	3/0 AWG	2/0 AWG 325/24 2/0 Weld	1/4	1.45 (36.8)	0.92 (23.4)	0.13 (3.3)	0.63 (16.0)	0.25 (6.4)	0.75 (19.1)	50	Orange
54816BEUB			3/8	0.63 (41.4)	0.92 (23.4)	0.13 (3.3)	0.63 (16.0)	0.38 (9.7)	1.00 (25.4)	50	Orange
54864BEUB			1/2	3.00 (76.2)	0.94 (23.9)	0.13 (3.3)	0.63 (16.0)	0.50 (12.7)	1.75 (44.5)	50	Orange
54817BEUB	4/0 AWG	3/0 AWG 450/24 3/0 Weld	1/4	1.38 (35.1)	1.03 (33.0)	0.14 (3.6)	0.70 (17.8)	0.25 (6.4)	0.75 (19.1)	54	Purple
54818BEUB			3/8	2.63 (66.8)	1.03 (33.0)	0.14 (3.6)	0.70 (17.8)	0.38 (9.7)	1.75 (44.5)	54	Purple
54818BEUB0616			3/8	1.81 (46.0)	1.03 (33.0)	0.14 (3.6)	0.70 (17.8)	0.38 (9.7)	1.00 (25.4)	54	Purple
54818BEUB0616PH			3/8	1.88 (47.8)	1.03 (33.0)	0.14 (3.6)	0.70 (17.8)	0.38 (9.7)	1.00 (25.4)	54	Purple
54866BEUB			1/2	3.00 (76.2)	1.03 (33.0)	0.14 (3.6)	0.70 (17.8)	0.50 (12.7)	1.75 (44.5)	54	Purple
54868BEUB0616	250 kcmil	4/0 AWG 550/24 4/0 Weld	3/8	1.93 (49.0)	1.13 (28.7)	0.14 (3.6)	0.77 (19.6)	0.38 (9.7)	1.00 (25.4)	62	Yellow
54868BEUB0616PH			3/8	1.93 (49.0)	1.13 (28.7)	0.14 (3.6)	0.77 (19.6)	0.38 (9.7)	1.00 (25.4)	62	Yellow
54868BEUB			1/2	3.00 (76.2)	1.13 (28.7)	0.14 (3.6)	0.77 (19.6)	0.50 (12.7)	1.75 (44.5)	62	Yellow
54819BEUB	300 kcmil	250 kcmil 650/24 = 262 kcmil	3/8	2.80 (71.1)	1.25 (31.8)	0.15 (3.8)	0.85 (21.6)	0.38 (9.7)	1.00 (25.4)	66	White
54870BEUB			2	3.00 (76.2)	1.25 (31.8)	0.15 (3.8)	0.85 (21.6)	0.50 (21.6)	1.75 (44.5)	66	White
54820BEUB	350 kcmil	650/24 262 kcmil	1/4	1.93 (49.0)	1.36 (34.5)	0.18 (4.6)	0.93 (23.6)	0.25 (6.4)	0.75 (19.1)	71	Red
54872BEUB0616			3/8	1.93 (49.0)	1.36 (34.5)	0.18 (4.6)	0.93 (23.6)	0.38 (9.7)	1.00 (25.4)	71	Red
54872BEUB0616PH			3/8	1.93 (49.0)	1.36 (34.5)	0.18 (4.6)	0.93 (23.6)	0.38 (9.7)	1.00 (25.4)	71	Red
54872BEUB			1/2	3.00 (76.2)	1.36 (34.5)	0.18 (4.6)	0.93 (23.6)	0.50 (21.6)	1.75 (44.5)	71	Red
54822BEUB			1/4	1.93 (49.0)	1.41 (35.8)	0.17 (4.3)	0.96 (24.4)	0.25 (6.4)	0.75 (19.1)	76	Blue
54821BEUB	400 kcmil	775/24 313 kcmil	3/8	1.93 (49.0)	1.41 (35.8)	0.17 (4.3)	0.96 (24.4)	0.38 (9.7)	1.00 (25.4)	76	Blue
54874BEUB			1/2	3.00 (76.2)	1.41 (35.8)	0.17 (4.3)	0.96 (24.4)	0.50 (21.6)	1.75 (44.5)	76	Blue
54823BEUB	500 kcmil	400 kcmil 925/24 350/373 kcmil	1/4	1.94 (49.3)	1.61 (40.9)	0.22 (5.6)	1.10 (27.9)	0.25 (6.4)	0.75 (19.1)	87	Brown
54823BEUB0616			3/8	1.93 (49.0)	1.61 (40.9)	0.22 (5.6)	1.10 (27.9)	0.38 (9.7)	1.00 (25.4)	87	Brown
54876BEUB0616PH			3/8	1.93 (49.0)	1.61 (40.9)	0.22 (5.6)	1.10 (27.9)	0.38 (9.7)	1.00 (25.4)	87	Brown
54876BEUB			1/2	3.00 (76.2)	1.61 (40.9)	0.22 (5.6)	1.10 (27.9)	0.50 (21.6)	1.75 (44.5)	87	Brown
54824BEUB			1/4	1.94 (49.3)	1.61 (40.9)	0.22 (5.6)	1.10 (27.9)	0.25 (6.4)	0.75 (19.1)	87	Brown
54878BEUB	600 kcmil	1110/24, 444 kcmil	3/8	2.80 (71.1)	1.75 (44.5)	0.24 (6.1)	1.20 (30.5)	0.38 (9.7)	1.00 (25.4)	94	Green
54878BEUB			1/2	3.00 (76.2)	1.75 (44.5)	0.24 (6.1)	1.20 (30.5)	0.50 (21.6)	1.75 (44.5)	94	Green
54880BEUB0616	750 kcmil	1325/24, 535 kcmil	3/8	2.06 (52.3)	1.94 (6.9)	0.27 (6.9)	1.33 (33.8)	0.50 (21.6)	1.00 (25.4)	106	Black
54880BEUB0616PH			3/8	2.06 (52.3)	1.94 (6.9)	0.27 (6.9)	1.33 (33.8)	0.50 (21.6)	1.00 (25.4)	106	Black
54880BEUB			1/2	3.00 (76.2)	1.94 (6.9)	0.27 (6.9)	1.33 (33.8)	0.50 (21.6)	1.75 (44.5)	106	Black
58884BEUB		1600/24, 646 kcmil	1/2	3.00 (76.2)	1.94 (6.9)	0.27 (6.9)	1.33 (33.8)	0.50 (21.6)	1.75 (44.5)	106	Black
58826BEUB	900 kcmil	1925/24, 750/777 kcmil	1/2	3.00 (76.2)	2.18 (7.9)	0.31 (7.9)	1.50 (38.1)	0.50 (21.6)	1.75 (44.5)	115	Yellow
54826BEUB	1000 kcmil		3/8	2.80 (71.1)	2.27 (7.6)	0.30 (7.6)	1.55 (39.4)	0.38 (9.7)	1.00 (25.4)	125	N/A
54882BEUB			1/2	3.00 (76.2)	2.27 (7.6)	0.30 (7.6)	1.55 (39.4)	0.50 (21.6)	1.75 (44.5)	125	N/A

Tooling: pp. 116-145

Die Selector Chart: pp.146-153

* For installations from 16 kV up to 35 kV, consult shielded cable manufacturers for stress relief and insulation requirements.