

Connectors for Copper Conductors

Two-Hole Lugs – Standard Barrel Certified to 600V and Recommended up to 35 kV*

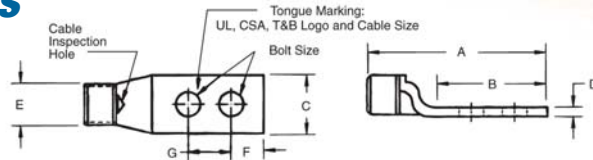

Material: High-Conductivity Wrought Copper
Finish: Electro Tin Plate



C o m p r e s s i o n

CAT. NO.	WIRE SIZE		Bolt Size	Dimensions in. (mm)							Die Code	Die Color
	Code	Flex Class G, H, I, K, M		A	B	C	D	E	F	G		
54201	#14-10 AWG		1/4	1.86 (47.2)	1.19 (30.2)	0.50 (12.7)	0.05 (1.3)	0.20 (5.1)	0.25 (6.4)	0.63 (16.0)	ERG2002	Yellow
256-30695-1302			3/8	2.48 (63.0)	1.81 (46.0)	0.56 (14.2)	0.04 (1.0)	0.22 (5.6)	0.38 (9.7)	1.00 (25.4)	ERG2002	Yellow
54204	#8 AWG	#8 AWG, 23 Navy #8 Weld 37/24	#10	1.88 (47.8)	1.18 (30.0)	0.42 (10.7)	0.08 (2.0)	0.26 (6.6)	0.25 (6.4)	0.63 (16.0)	21	Red
256-31426-33*			#10	1.88 (47.8)	1.18 (30.0)	0.41 (10.4)	0.06 (1.5)	0.26 (6.6)	0.23 (5.8)	0.75 (19.0)	21	Red
256-31426-33PH			#10	1.88 (47.8)	1.18 (30.0)	0.41 (10.4)	0.06 (1.5)	0.26 (6.6)	0.23 (5.8)	0.75 (19.0)	21	Red
542040410			1/4	2.01 (51.1)	1.31 (33.3)	0.42 (10.7)	0.08 (2.0)	0.26 (6.6)	0.25 (6.4)	0.63 (16.0)	21	Red
542040416			1/4	2.38 (60.5)	1.68 (42.7)	0.42 (10.7)	0.08 (2.0)	0.26 (6.6)	0.25 (6.4)	1.00 (25.4)	21	Red
256-30695-1094			1/4	2.50 (63.5)	1.81 (46.0)	0.56 (14.22)	0.05 (1.3)	0.26 (6.6)	0.25 (6.4)	0.75 (19.0)	21	Red
256-30695-251			3/8	2.50 (63.5)	1.81 (46.0)	0.56 (14.22)	0.05 (1.3)	0.26 (6.6)	0.38 (9.7)	1.00 (25.4)	21	Red
256-30695-1070	#6 AWG	#6 AWG, 30 Navy #6 Weld 61/24 133/0.014	#12	1.81 (46.0)	1.19 (30.2)	0.44 (11.2)	0.11 (2.8)	0.30 (7.6)	0.25 (6.4)	0.50 – 0.63 (12.7 – 16.0)	24	Blue
256-30695-1153			#10	1.98 (50.3)	1.28 (32.5)	0.44 (11.2)	0.08 (2.0)	0.30 (7.6)	0.25 (6.4)	0.50 (12.7)	24	Blue
256-30695-1183			#10	1.98 (50.3)	1.19 (30.2)	0.44 (11.2)	0.08 (2.0)	0.30 (7.6)	0.22 (5.6)	0.63 – 0.75 (16.0 – 19.0)	24	Blue
54205			1/4	1.98 (50.3)	1.28 (32.5)	0.44 (11.2)	0.08 (2.0)	0.30 (7.6)	0.25 (6.4)	0.63 (16.0)	24	Blue
256-30695-1095			1/4	2.13 (54.1)	1.31 (33.3)	0.43 (10.9)	0.08 (2.0)	0.30 (7.6)	0.25 (6.4)	0.75 (19.0)	24	Blue
256-30695-252			1/4	2.38 (60.5)	1.63 (41.4)	0.43 (10.9)	0.08 (2.0)	0.30 (7.6)	0.25 (6.4)	1.00 (25.4)	24	Blue
256-30695-372			1/4	2.13 (54.1)	1.43 (36.3)	0.43 (10.9)	0.08 (2.0)	0.30 (7.6)	0.25 (6.4)	0.75 (19.0)	24	Blue
256-30695-913			1/4	2.38 (60.5)	1.75 (44.5)	0.43 (10.9)	0.08 (2.0)	0.30 (7.6)	0.25 (6.4)	1.00 (25.4)	24	Blue
256-30695-253			3/8	2.58 (65.3)	1.81 (45.9)	0.55 (14.0)	0.08 (2.0)	0.30 (7.6)	0.38 (9.7)	1.00 (25.4)	24	Blue
54206			#4 AWG	#5 AWG 40-50 Navy 91/24 133/0.0177 49/0.029	1/4	2.03 (51.6)	1.28 (32.5)	0.52 (13.2)	0.10 (2.5)	0.37 (9.4)	0.25 (6.4)	0.63 (16.0)
256-30695-1184	5/16	2.31 (58.7)			1.63 (41.4)	0.52 (13.2)	0.10 (2.5)	0.37 (9.4)	0.31 (7.9)	1.00 (25.4)	29	Grey
256-30695-255	3/8	2.56 (65.0)			1.81 (45.9)	0.59 (15.0)	0.09 (2.3)	0.37 (9.4)	0.38 (9.7)	1.00 (25.4)	29	Grey
54207	#2 AWG	#3 AWG 60 Navy 125/24, #4 Weld	1/4	2.13 (54.1)	1.28 (32.5)	0.59 (15.0)	0.11 (2.8)	0.41 (10.4)	0.25 (6.4)	0.63 (16.0)	33	Brown
256-30695-1355			1/4	2.15 (54.6)	1.31 (33.3)	0.59 (15.0)	0.13 (3.3)	0.41 (10.4)	0.25 (6.4)	0.75 (19.0)	33	Brown
256-30695-1185			1/4	2.38 (60.5)	1.53 (38.9)	0.59 (15.0)	0.11 (2.8)	0.41 (10.4)	0.25 (6.4)	1.00 (25.4)	33	Brown
256-30695-257			3/8	2.67 (67.8)	1.81 (45.9)	0.60 (15.2)	0.10 (2.5)	0.41 (10.4)	0.38 (9.7)	1.00 (25.4)	33	Brown
256-30695-1049			1/2	3.75 (95.3)	2.88 (73.2)	0.75 (19.1)	0.09 (2.3)	0.41 (10.4)	0.31 (7.9)	1.75 (44.5)	33	Brown
54208	#1 AWG	#2 AWG, 75 Navy 150/24 175/24 133/0.0223	1/4	2.13 (54.1)	1.28 (32.5)	0.68 (17.3)	0.11 (2.8)	0.47 (11.9)	0.25 (6.4)	0.63 (16.0)	37	Green
256-30695-1233			5/16	2.69 (68.3)	1.62 (41.2)	0.69 (17.5)	0.13 (3.3)	0.47 (11.9)	0.34 (8.6)	1.00 (25.4)	37	Green
256-30695-1236			3/8	2.75 (69.9)	1.81 (45.9)	0.68 (17.3)	0.11 (2.8)	0.47 (11.9)	0.38 (9.7)	1.00 (25.4)	37	Green
256-30695-329	1/0 AWG	#1 AWG 100 Navy, #1 Weld 225/24 133/0.0254	1/4	2.75 (69.9)	1.81 (45.9)	0.75 (19.1)	0.14 (3.6)	0.52 (13.2)	0.38 (9.7)	0.75 (19.4)	42	Pink
54255			5/16	2.56 (65.0)	1.56 (39.6)	0.75 (19.1)	0.14 (3.6)	0.52 (13.2)	0.38 (9.7)	0.88 (22.4)	42	Pink
256-30695-1234			5/16	2.75 (69.9)	1.78 (45.2)	0.75 (19.1)	0.14 (3.6)	0.52 (13.2)	0.33 (8.4)	1.00 (25.4)	42	Pink
54209			3/8	2.88 (73.2)	1.93 (49.0)	0.75 (19.1)	0.13 (3.3)	0.52 (13.2)	0.38 (9.7)	1.00 (25.4)	42	Pink
256-30695-1265			3/8	3.50 (89.0)	2.57 (65.3)	0.75 (19.1)	0.14 (3.6)	0.52 (13.2)	0.38 (9.7)	1.75 (44.5)	42	Pink
256-30695-886			1/2	3.78 (96.0)	2.83 (71.2)	0.75 (19.1)	0.13 (3.3)	0.52 (13.2)	0.5 (12.7)	1.75 (44.5)	42	Pink
256-30695-1175	2/0 AWG	1/0 AWG, 125 Navy 1/0 Weld 275/24 133/0.0282	1/4	2.45 (6.2)	1.44 (36.6)	0.83 (21.1)	0.14 (3.6)	0.57 (14.5)	0.25 (6.4)	0.75 (19.0)	45	Black
54261			5/16	2.70 (68.6)	1.63 (41.4)	0.83 (21.1)	0.14 (3.6)	0.57 (14.5)	0.33 (8.4)	0.88 (22.4)	45	Black
256-30695-832			5/16	2.88 (73.2)	1.81 (45.9)	0.81 (20.6)	0.14 (3.6)	0.57 (14.5)	0.38 (9.7)	1.00 (25.4)	45	Black
54210			3/8	2.93 (74.4)	1.93 (49.0)	0.83 (21.1)	0.13 (3.3)	0.57 (14.5)	0.38 (9.7)	1.00 (25.4)	45	Black
54260			1/2	3.83 (97.3)	2.81 (71.4)	0.83 (21.1)	0.14 (3.6)	0.57 (14.5)	0.38 (9.7)	1.75 (44.5)	45	Black
54266	3/0 AWG	150 Navy, 2/0 Weld 2/0 AWG 325/24 133/0.0316 259/0.0227 427/0.0177	5/16	2.88 (73.2)	1.75 (44.5)	0.94 (23.9)	0.14 (3.6)	0.63 (16.0)	0.33 (8.4)	1.00 (25.4)	50	Orange
54211			3/8	2.94 (74.7)	1.81 (46.0)	0.94 (23.9)	0.14 (3.6)	0.63 (16.0)	0.38 (9.7)	1.00 (25.4)	50	Orange
54265			1/2	3.94 (100.1)	2.81 (71.4)	0.94 (23.9)	0.14 (3.6)	0.63 (16.0)	0.50 (12.7)	1.75 (44.5)	50	Orange

Call your Regional Sales Office for sizes not listed.
Tooling: pp. 116–145 Die Selector Chart: pp.146–153

* For installations from 16 kV up to 35 kV, consult shielded cable manufacturers for stress relief and insulation requirements.

* Blind End

Connectors for Copper Conductors

Two-Hole Lugs – Standard Barrel Certified to 600V and Recommended up to 35 kV[‡] *(Continued)*

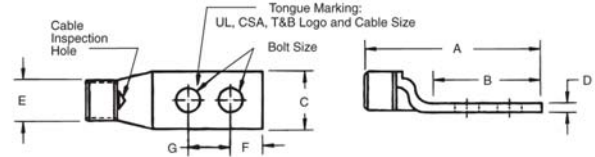

Material: High-Conductivity Wrought Copper
Finish: Electro Tin Plate



C o m p r e s s i o n

CAT. NO.	WIRE SIZE		Bolt Size	Dimensions in. (mm)							Die Code	Die Color
	Code	Flex Class G, H, I, K, M		A	B	C	D	E	F	G		
54212	4/0 AWG	3/0 AWG, 200 Navy 3/0 Weld 450/24 = 182 kcmil 703/0.0154	3/8	3.18 (80.8)	1.93 (49.0)	1.03 (26.2)	0.14 (3.6)	0.70 (17.8)	0.38 (9.7)	1.00 (25.4)	54	Purple
54270			1/2	4.25 (108.0)	3.00 (76.2)	1.03 (26.2)	0.14 (3.6)	0.70 (17.8)	0.50 (12.7)	1.75 (44.5)	54	Purple
256-30695-1247			1/4	3.06 (77.7)	1.44 (36.6)	1.03 (26.2)	0.16 (4.1)	0.70 (17.8)	0.38 (9.7)	0.63 (16.0)	54	Purple
256-30695-331			1/4	3.06 (77.7)	1.81 (46.0)	1.03 (26.2)	0.14 (3.6)	0.70 (17.8)	0.38 (9.7)	0.75 (19.1)	54	Purple
256-30695-1261			5/16	3.18 (80.8)	1.93 (49.0)	1.03 (26.2)	0.14 (3.6)	0.70 (17.8)	0.38 (9.7)	1.00 (25.4)	54	Purple
54213	250 kcmil	4/0 AWG 250 Navy	3/8	3.28 (83.3)	1.93 (49.0)	1.13 (28.7)	0.14 (3.6)	0.77 (19.6)	0.38 (9.7)	1.00 (25.4)	62	Yellow
54275			1/2	4.19 (106.4)	2.81 (71.4)	1.13 (28.7)	0.18 (4.6)	0.77 (19.6)	0.50 (12.7)	1.75 (44.5)	62	Yellow
256-30695-345	300 kcmil	4/0 AWG, 4/0 Weld 550/24 = 222 kcmil 133/0.0399 259/0.0286 637/0.018	3/8	3.25 (82.6)	1.69 (42.9)	1.25 (31.8)	0.15 (3.8)	0.79 (20.1)	0.38 (9.7)	0.88 (22.4)	62	Yellow
256-30695-835			3/8	4.25 (108.0)	2.80 (71.1)	1.25 (31.8)	0.15 (3.8)	0.79 (20.1)	0.38 (9.7)	1.00 (25.4)	62	Yellow
256-30695-452			3/8	3.13 (79.5)	1.88 (47.8)	1.25 (31.8)	0.16 (4.1)	0.79 (20.1)	0.38 (9.7)	0.88 (22.4)	62	Yellow
58265			1/2	3.94 (100.1)	2.81 (71.4)	0.94 (23.9)	0.14 (3.6)	0.79 (20.1)	0.50 (12.7)	1.75 (44.5)	62	Yellow
54214	300 kcmil	250 AWG 300 Navy 650/24 = 262 kcmil	3/8	3.45 (87.6)	1.93 (49.0)	1.25 (31.8)	0.15 (3.8)	0.85 (21.6)	0.38 (9.7)	1.00 (25.4)	66	White
54280			1/2	4.45 (113.0)	3.00 (76.2)	1.25 (31.8)	0.15 (3.8)	0.85 (21.6)	0.50 (12.7)	1.75 (44.5)	66	White
256-30695-332	350 kcmil	350 Navy	1/4	3.40 (86.4)	1.81 (46.0)	1.36 (34.5)	0.18 (4.6)	0.93 (23.6)	0.38 (9.7)	0.75 (19.1)	71	Red
256-30695-1240			5/16	4.18 (106.2)	2.63 (66.8)	1.36 (34.5)	0.18 (4.6)	0.93 (23.6)	0.38 (9.7)	1.75 (44.5)	71	Red
54215			3/8	3.51 (89.2)	1.93 (49.0)	1.36 (34.5)	0.18 (4.6)	0.93 (23.6)	0.38 (9.7)	1.00 (25.4)	71	Red
54282			1/2	4.60 (116.8)	3.00 (76.2)	1.36 (34.5)	0.18 (4.6)	0.93 (23.6)	0.50 (12.7)	1.75 (44.5)	71	Red
54216	400 kcmil	300 kcmil 313 kcmil 775/24	3/8	3.93 (99.8)	1.93 (49.0)	1.41 (35.8)	0.17 (4.3)	0.96 (24.4)	0.38 (9.7)	1.00 (25.4)	76	Blue
54283			3/8	3.88 (98.6)	1.93 (49.0)	1.41 (35.8)	0.17 (4.3)	0.96 (24.4)	0.38 (9.7)	1.75 (44.5)	76	Blue
256-30695-439	500 kcmil	400 Weld 925/24 = 373 kcmil 259/0.0393 427/0.0306	3/8	4.35 (110.5)	2.25 (57.2)	1.61 (40.9)	0.22 (5.6)	1.04 (26.4)	0.50 (12.7)	1.00 (25.4)	80	N/A
58277			1/2	5.06 (128.5)	3.00 (76.2)	1.61 (40.9)	0.22 (5.6)	1.04 (26.4)	0.50 (12.7)	1.75 (44.5)	80	N/A
256-30695-839			3/8	4.09 (103.9)	2.06 (52.3)	1.61 (40.9)	0.22 (5.6)	1.04 (26.4)	0.50 (12.7)	1.00 (25.4)	80	N/A
54218	500 kcmil	400 kcmil 500 Navy	3/8	3.96 (100.6)	1.93 (49.0)	1.61 (40.9)	0.22 (5.6)	1.10 (27.9)	0.38 (9.7)	1.00 (25.4)	87	Brown
54286			1/2	5.07 (128.8)	3.00 (76.2)	1.61 (40.9)	0.22 (5.6)	1.10 (27.9)	0.50 (12.7)	1.75 (44.5)	87	Brown
256-30695-188			1/2	4.06 (103.1)	2.31 (58.7)	1.63 (41.4)	0.22 (5.6)	1.10 (27.9)	0.50 (12.7)	1.25 (31.8)	87	Brown
54220	600 kcmil	-	3/8	4.13 (104.9)	1.93 (49.0)	1.75 (44.5)	0.24 (6.1)	1.20 (30.5)	0.38 (9.7)	1.00 (25.4)	94	Green
54289			1/2	5.23 (132.8)	3.00 (76.2)	1.75 (44.5)	0.24 (6.1)	1.20 (30.5)	0.50 (12.7)	1.75 (44.5)	94	Green
256-30695-1406	700 kcmil	550/535 1325/24 500 AWG	3/8	4.05 (102.9)	2.11 (53.6)	1.78 (45.2)	0.24 (6.1)	1.25 (31.8)	0.50 (12.7)	1.00 (25.4)	99	Pink
256-30695-842			3/8	4.30 (109.2)	2.06 (52.3)	1.80 (45.7)	0.28 (7.1)	1.25 (31.8)	0.50 (12.7)	1.00 (25.4)	99	Pink
256-30695-898			3/8	4.30 (109.2)	2.06 (52.3)	1.80 (45.7)	0.28 (7.1)	1.25 (31.8)	0.50 (12.7)	1.00 (25.4)	99	Pink
54291			1/2	5.18 (131.6)	3.00 (76.2)	1.84 (46.7)	0.23 (5.8)	1.25 (31.8)	0.50 (12.7)	1.75 (44.5)	99	Pink
58281			1/2	5.23 (132.8)	3.00 (76.2)	1.80 (45.7)	0.28 (7.1)	1.25 (31.8)	0.50 (12.7)	1.75 (44.5)	99	Pink
256-30695-237	750 kcmil	1325/24 = 535 kcmil	3/8	5.10 (129.5)	2.80 (71.1)	1.94 (49.3)	0.27 (6.9)	1.33 (33.8)	0.38 (9.7)	1.00 (25.4)	106	Black
54223			1/2	5.32 (135.1)	3.00 (76.2)	1.94 (49.3)	0.27 (6.9)	1.33 (33.8)	0.50 (12.7)	1.75 (44.5)	106	Black
256-30695-1376	800 kcmil	-	3/8	4.78 (121.4)	2.28 (57.9)	2.01 (51.1)	0.27 (6.9)	1.38 (35.1)	0.44 (11.2)	1.13 (28.7)	107	Orange
54224			1/2	5.50 (139.7)	3.00 (76.2)	2.01 (51.1)	0.27 (6.9)	1.38 (35.1)	0.50 (12.7)	1.75 (44.5)	107	Orange
256-30695-694	900 kcmil	1925/24 = 777 kcmil	3/8	4.65 (118.1)	2.06 (52.3)	2.18 (55.4)	0.31 (7.9)	1.50 (38.1)	0.50 (12.7)	1.00 (25.4)	115	Yellow
54226			1/2	5.59 (142.0)	3.00 (76.2)	2.18 (55.4)	0.31 (7.9)	1.50 (38.1)	0.50 (12.7)	1.75 (44.5)	115	Yellow
256-30695-846			3/8	4.60 (116.8)	2.06 (52.3)	2.12 (53.9)	0.31 (7.9)	1.50 (38.1)	0.50 (12.7)	1.00 (25.4)	115	Yellow
256-30695-844			5/8	5.00 (127.0)	2.63 (66.8)	2.18 (55.4)	0.31 (7.9)	1.50 (38.1)	0.56 (14.2)	1.50 (38.1)	115	Yellow
54228	1000 kcmil	1000 Navy	1/2	5.45 (138.4)	3.00 (76.2)	2.27 (57.7)	0.30 (7.6)	1.55 (39.4)	0.50 (12.7)	1.75 (44.5)	125	N/A

Call your Regional Sales Office for sizes not listed.

Tooling: pp. 116-145 Die Selector Chart: pp. 146-153

‡ For installations from 16 kV up to 35 kV, consult shielded cable manufacturers for stress relief and insulation requirements.

Connectors for Copper Conductors

**Two-Hole Lugs –
45° Standard Barrel
Certified to 600V
and Recommended
up to 35 kV***

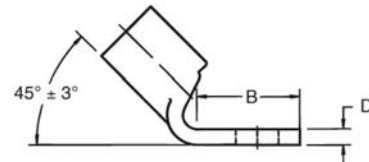
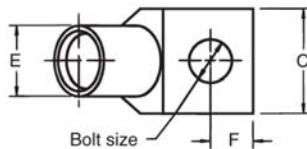

Material: High-Conductivity
Wrought Copper
Finish: Electro Tin Plate



C o m p r e s s i o n

CAT. NO.	WIRE SIZE		Bolt Size	Dimensions in. (mm)						Die Code	Die Color
	Code	Flex Class G, H, I, K, M		B	C	D	E	F	G		
256-31426-9	#14 – 10 AWG		#10	1.22 (31.0)	0.37 (9.4)	0.05 (1.3)	0.20 (5.1)	0.25 (6.4)	0.63 (16.0)	N/A	N/A
54204UF	#8 AWG	#8 AWG, 23 Navy #8 Weld 37/24	#10	1.18 (30.0)	0.42 (10.7)	0.08 (2.0)	0.26 (6.6)	0.25 (6.4)	0.63 (16.0)	21	Red
256-30695-1183UF	#6 AWG	#6 AWG, 30 Navy #6 Weld 61/24 133/0.014	#10	1.19 (30.2)	0.44 (11.2)	0.08 (2.0)	0.30 (7.6)	0.22 (5.6)	0.63 – 0.75 (16.0) – (19.1)	24	Blue
54205UF			1/4	1.28 (32.5)	0.44 (11.2)	0.08 (2.0)	0.30 (7.6)	0.25 (6.4)	0.63 (16.0)	24	Blue
54205UF0416			1/4	1.56 (39.6)	0.43 (10.9)	0.08 (2.0)	0.30 (7.6)	0.25 (6.4)	1.00 (25.4)	24	Blue
54206UF	#4 AWG	#5 AWG 40-50 Navy 91/24 133/0.0177 49/0.029	1/4	1.28 (32.5)	0.52 (13.2)	0.10 (2.5)	0.37 (9.4)	0.25 (6.4)	0.63 (16.0)	29	Grey
54207UF	#2 AWG	#3 AWG 60 Navy, #4 Weld 125/24	1/4	1.28 (32.5)	0.59 (15.0)	0.11 (2.8)	0.41 (10.4)	0.25 (6.4)	0.63 (16.0)	33	Brown
256-30695-257UF			3/8	1.81 (46.0)	0.60 (15.2)	0.11 (2.8)	0.41 (10.4)	0.38 (9.7)	1.00 (25.4)	33	Brown
54208UF	#1 AWG	#2 AWG, 75 Navy 150/24 175/24 133/0.0223	1/4	1.28 (32.5)	0.68 (17.3)	0.11 (2.8)	0.47 (11.9)	0.25 (6.4)	0.63 (16.0)	37	Green
54209UF	1/0 AWG	#1 AWG 100 Navy, #1 Weld 225/24 133/0.0254	3/8	1.93 (49.0)	0.75 (19.1)	0.13 (3.3)	0.52 (13.2)	0.38 (9.7)	1.00 (25.4)	42	Pink
54209UF0412			1/4	1.55 (39.4)	0.75 (19.1)	0.13 (3.3)	0.52 (13.2)	0.25 (6.4)	0.75 (19.1)	42	Pink
54261UF	2/0 AWG	1/0 AWG, 125 Navy 1/0 Weld 275/24 133/0.0282	5/16	1.63 (41.4)	0.83 (21.1)	0.14 (3.6)	0.57 (14.5)	0.33 (8.4)	0.88 (22.4)	45	Black
54210UF			3/8	1.93 (49.0)	0.83 (21.1)	0.13 (3.3)	0.57 (14.5)	0.38 (9.7)	1.00 (25.4)	45	Black
54260UF			1/2	2.81 (71.4)	0.83 (21.1)	0.14 (3.6)	0.57 (14.5)	0.38 (9.7)	1.75 (44.5)	45	Black
54266UF	3/0 AWG	2/0 AWG, 150 Navy 2/0 Weld 325/24 133/0.0316 259/0.0227 427/0.0177	5/16	1.75 (44.5)	0.94 (23.9)	0.14 (3.6)	0.63 (16.0)	0.33 (8.4)	1.00 (25.4)	50	Orange
54211UF			3/8	1.81 (46.0)	0.94 (23.9)	0.14 (3.6)	0.63 (16.0)	0.38 (9.7)	1.00 (25.4)	50	Orange
54265UF			1/2	2.81 (71.4)	0.94 (23.9)	0.14 (3.6)	0.63 (16.0)	0.25 (6.4)	1.75 (44.5)	50	Orange
54212UF	4/0 AWG	200 Navy, 3/0 AWG 3/0 Weld 450/24 703/0.0154	3/8	1.93 (49.0)	1.03 (26.2)	0.14 (3.6)	0.70 (17.8)	0.38 (9.7)	1.00 (25.4)	54	Purple
54270UF			1/2	3.00 (76.2)	1.03 (26.2)	0.14 (3.6)	0.70 (17.8)	0.25 (6.4)	1.75 (44.5)	54	Purple
54213UF	250 kcmil	4/0 AWG 250 Navy 550/24	3/8	1.93 (49.0)	1.13 (28.7)	0.14 (3.6)	0.77 (19.6)	0.38 (9.7)	1.00 (25.4)	62	Yellow
54275UF			1/2	2.81 (71.4)	1.13 (28.7)	0.18 (4.6)	0.77 (19.6)	0.25 (6.4)	1.75 (44.5)	62	Yellow
256-30695-399UF		4/0 Weld 550/24 133/0.0399 259/0.0286 637/0.018	3/8	2.80 (71.1)	1.25 (31.2)	0.15 (3.8)	0.79 (20.1)	0.38 (9.7)	1.00 (25.4)	62	Yellow
58265UF			1/2	2.81 (71.4)	0.94 (23.9)	0.14 (3.6)	0.79 (20.1)	0.25 (6.4)	1.75 (44.5)	62	Yellow

Call your Regional Sales Office for sizes not listed.
Tooling: pp. 116–145 Die Selector Chart: pp.146–153

* For installations from 16 kV up to 35 kV, consult shielded cable manufacturers for stress relief and insulation requirements.

Connectors for Copper Conductors

Two-Hole Lugs – 45° Standard Barrel Certified to 600V and Recommended up to 35 kV[‡] (Continued)

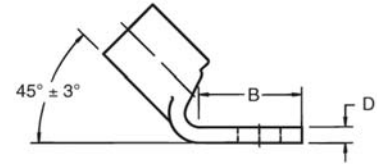
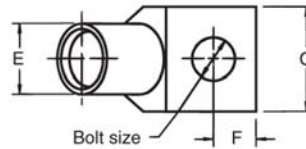

Material: High-Conductivity
Wrought Copper
Finish: Electro Tin Plate



C o m p r e s s i o n

CAT. NO.	WIRE SIZE		Bolt Size	Dimensions in. (mm)						Die Code	Die Color
	Code	Flex Class G, H, I, K, M		B	C	D	E	F	G		
54214UF	300 kcmil	250 AWG	3/8	1.93 (49.0)	1.25 (31.8)	0.15 (3.8)	0.85 (21.6)	0.38 (9.7)	1.00 (25.4)	66	White
54280UF		300 Navy 650/24 = 262 kcmil	1/2	3.00 (76.2)	1.25 (31.8)	0.15 (3.8)	0.85 (21.6)	0.50 (12.7)	1.75 (44.5)	66	White
54215UF	350 kcmil	350 Navy	3/8	1.93 (49.0)	1.36 (34.5)	0.18 (4.6)	0.93 (23.6)	0.38 (9.7)	1.00 (25.4)	71	Red
54282UF		650/24 = 262 kcmil	1/2	3.00 (76.2)	1.36 (34.5)	0.18 (4.6)	0.93 (23.6)	0.50 (12.7)	1.75 (44.5)	71	Red
54216UF	400 kcmil	300 kcmil	3/8	1.93 (49.0)	1.41 (35.8)	0.17 (4.3)	0.96 (24.4)	0.38 (9.7)	1.06 (26.9)	76	Blue
54283UF		713 kcmil 775/24	3/8	1.93 (49.0)	1.41 (35.8)	0.17 (4.3)	0.96 (24.4)	0.38 (9.7)	1.75 (44.5)	76	Blue
54277UF		400 Weld 925/24 = 373 kcmil 259/0.0393 427/0.0306	1/2	3.00 (76.2)	1.61 (40.9)	0.22 (5.6)	1.04 (26.4)	0.50 (12.7)	1.00 (25.4)	80	N/A
54218UF	500 kcmil	400 kcmil	3/8	1.93 (49.0)	1.61 (40.9)	0.22 (5.6)	1.10 (27.9)	0.38 (9.7)	1.75 (44.5)	87	Brown
54286UF		500 Navy 925/24 = 373 kcmil	1/2	3.00 (76.2)	1.61 (40.9)	0.22 (5.6)	1.10 (27.9)	0.50 (12.7)	1.00 (25.4)	87	Brown
54220UF	600 kcmil	1100/24 = 444 kcmil	3/8	1.93 (49.0)	1.75 (44.5)	0.24 (6.1)	1.20 (30.5)	0.38 (9.7)	1.75 (44.5)	94	Green
54289UF			1/2	3.00 (76.2)	1.75 (44.5)	0.24 (6.1)	1.20 (30.5)	0.50 (12.7)	1.75 (44.5)	94	Green
54291UF	700 kcmil	500 AWG 1325/24 = 535 kcmil	1/2	3.00 (76.2)	1.84 (46.7)	0.23 (5.8)	1.25 (31.8)	0.50 (12.7)	1.75 (44.5)	99	Pink
54281UF			1/2	3.00 (76.2)	1.84 (46.7)	0.28 (7.1)	1.25 (31.8)	0.50 (12.7)	1.75 (44.5)	99	Pink
256-30695-237UF	750 kcmil		3/8	2.80 (71.1)	1.94 (49.3)	0.27 (6.9)	1.33 (33.8)	0.38 (9.7)	1.00 (25.4)	106	Black
54223UF			1/2	3.00 (76.2)	1.94 (49.3)	0.27 (6.9)	1.33 (33.8)	0.50 (12.7)	1.75 (44.5)	106	Black
54224UF	800 kcmil		1/2	3.00 (76.2)	2.01 (51.1)	0.27 (6.9)	1.38 (35.1)	0.50 (12.7)	1.75 (44.5)	106	Black
54226UF	900 kcmil	1925/24 = 777 kcmil	1/2	3.00 (76.2)	2.18 (55.4)	0.31 (7.9)	1.50 (38.1)	0.50 (12.7)	1.75 (44.5)	115	Yellow
54228UF	1000 kcmil	1000 Navy	1/2	3.00 (76.2)	2.27 (57.7)	0.30 (7.6)	1.55 (39.4)	0.50 (12.7)	1.75 (44.5)	125	N/A

Call your Regional Sales Office for sizes not listed.

Tooling: pp. 116–145

Die Selector Chart: pp. 146–153

‡ For installations from 16 kV up to 35 kV, consult shielded cable manufacturers for stress relief and insulation requirements.

Connectors for Copper Conductors

**Two-Hole Lugs –
90° Standard Barrel
Certified to 600V
and Recommended
up to 35 kV***

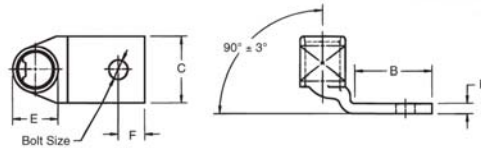

Material: High-Conductivity
Wrought Copper

Finish: Electro Tin Plate



CAT. NO.	WIRE SIZE		Bolt Size	Dimensions in. (mm)						Die Code	Die Color
	Code	Flex Class G, H, I, K, M		B	C	D	E	F	G		
256-31426-141	#14 – 10 AWG		#10	1.25 (31.2)	0.37 (9.4)	0.07 (1.8)	0.20 (5.1)	0.22 (5.6)	0.63 (16.0)	ERG2002	Yellow
256-31426-6SPH			#10	1.30 (33.0)	0.37 (9.4)	0.07 (1.8)	0.20 (5.1)	0.22 (5.6)	0.63 – 0.75 (16.0) – (19.1)	ERG2002	Yellow
256-31426-6			#10	1.30 (33.0)	0.37 (9.4)	0.07 (1.8)	0.20 (5.1)	0.22 (5.6)	0.63 (16.0)	ERG2002	Yellow
256-31426-6S			#10	1.30 (33.0)	0.37 (9.4)	0.07 (1.8)	0.20 (5.1)	0.22 (5.6)	0.63 – 0.75 (16.0) – (19.1)	ERG2002	Yellow
256-30695-1409	#8 AWG	#8 AWG, 23 Navy #8 Weld 37/24	#10	1.19 (30.2)	0.41 (10.4)	0.06 (1.5)	0.26 (6.6)	0.23 (5.8)	0.63 – 0.75 (16.0) – (19.1)	21	Red
54204UB			#10	1.25 (31.8)	0.42 (10.7)	0.08 (2.0)	0.26 (6.6)	0.25 (6.4)	0.63 (16.0)	21	Red
256-31426-33UB*			#10	1.19 (30.2)	0.41 (10.4)	0.06 (1.5)	0.26 (6.6)	0.23 (5.8)	0.63 (16.0)	21	Red
256-31426-33UBPH			#10	1.19 (30.2)	0.41 (10.4)	0.06 (1.5)	0.26 (6.6)	0.23 (5.8)	0.63 – 0.75 (16.0) – (19.1)	21	Red
256-30695-1411	#6 AWG	#6 AWG, 30 Navy #6 Weld 133/0.014 61/24	#10	1.19 (30.2)	0.44 (11.2)	0.08 (2.0)	0.30 (7.6)	0.23 (5.8)	0.63 – 0.75 (16.0) – (19.1)	24	Blue
256-30695-1183B			#10	1.19 (30.2)	0.44 (11.2)	0.08 (2.0)	0.30 (7.6)	0.23 (5.8)	0.63 – 0.75 (16.0) – (19.1)	24	Blue
256-30695-1356			#10	1.19 (30.2)	0.43 (10.1)	0.08 (2.0)	0.30 (7.6)	0.23 (5.8)	0.63 (16.0)	24	Blue
54205UB			1/4	1.28 (32.5)	0.44 (11.2)	0.08 (2.0)	0.30 (7.6)	0.25 (6.4)	0.63 (16.0)	24	Blue
256-30695-252UB			1/4	1.56 (39.6)	0.43 (10.1)	0.08 (2.0)	0.30 (7.6)	0.25 (6.4)	1.00 (25.4)	24	Blue
54206UB	#4 AWG	#5 AWG 40-50 Navy 91/24 133/0.0177 49/0.029	1/4	1.28 (32.5)	0.52 (13.2)	0.10 (2.5)	0.37 (9.4)	0.25 (6.4)	0.63 (16.0)	29	Grey
54207UB	#2 AWG	#3 AWG 60 Navy, #4 Weld 125/24	1/4	1.28 (32.5)	0.59 (15.0)	0.11 (2.8)	0.41 (10.4)	0.25 (6.4)	0.63 (16.0)	33	Brown
54208UB	#1 AWG	#2 AWG, 75 Navy 150/24 133/0.0223	1/4	1.28 (32.5)	0.68 (17.3)	0.11 (2.8)	0.47 (11.9)	0.25 (6.4)	0.63 (16.0)	37	Green
54209UB	1/0 AWG	1 AWG 100 Navy, #1 Weld 225/24 133/0.0254	3/8	1.93 (49.0)	0.75 (19.1)	0.13 (3.3)	0.52 (13.2)	0.38 (9.7)	1.00 (25.4)	42	Pink
54209UB0412			1/4	1.55 (39.4)	0.75 (19.1)	0.13 (3.3)	0.52 (13.2)	0.25 (6.4)	0.75 (19.1)	42	Pink
54261UB	2/0 AWG	1/0 AWG, 125 Navy 1/0 Weld 275/24 133/0.0282	5/16	1.63 (41.4)	0.83 (21.1)	0.14 (3.6)	0.57 (14.5)	0.34 (8.6)	0.88 (22.4)	45	Black
54210UB			3/8	1.93 (49.0)	0.83 (21.1)	0.13 (3.3)	0.57 (14.5)	0.38 (9.7)	1.00 (25.4)	45	Black
54260UB			1/2	2.81 (71.4)	0.83 (21.1)	0.14 (3.6)	0.57 (14.5)	0.38 (9.7)	1.75 (44.5)	45	Black
54266UB	3/0 AWG	2/0 AWG, 150 Navy 2/0 Weld 325/24 133/0.0316 259/0.0227 427/0.0177	5/16	1.75 (44.5)	0.94 (23.9)	0.14 (3.6)	0.63 (16.0)	0.34 (8.6)	1.00 (25.4)	50	Orange
54211UB			3/8	1.81 (46.0)	0.94 (23.9)	0.14 (3.6)	0.63 (16.0)	0.38 (9.7)	1.00 (25.4)	50	Orange
54265UB			1/2	2.81 (71.4)	0.94 (23.9)	0.14 (3.6)	0.63 (16.0)	0.38 (9.7)	1.75 (44.5)	50	Orange
54212UB	4/0 AWG	3/0 AWG, 200 Navy 3/0 Weld 450/24 703/0.0154	3/8	1.93 (49.0)	1.03 (26.2)	0.14 (3.6)	0.70 (17.8)	0.38 (9.7)	1.00 (25.4)	54	Purple
54270UB			1/2	3.00 (76.2)	1.03 (26.2)	0.14 (3.6)	0.70 (17.8)	0.50 (12.7)	1.75 (44.5)	54	Purple
54213UB	250 kcmil	4/0 AWG 250 Navy 550/24	3/8	1.93 (49.0)	1.13 (28.7)	0.14 (3.6)	0.77 (19.6)	0.38 (9.7)	1.00 (25.4)	62	Yellow
54275UB			1/2	2.81 (71.4)	1.13 (28.7)	0.18 (4.6)	0.77 (19.6)	0.50 (12.7)	1.75 (44.5)	62	Yellow
256-30595-399UB		4/0 AWG, 4/0 Weld 550/24 133/0.0399 259/0.0286 637/0.018	3/8	2.80 (71.1)	1.25 (31.8)	0.15 (3.8)	0.79 (20.1)	0.38 (9.7)	1.00 (25.4)	62	Yellow
58265UB			1/2	2.81 (71.4)	0.94 (23.9)	0.14 (3.6)	0.79 (20.1)	0.50 (12.7)	1.75 (44.5)	62	Yellow

Call your Regional Sales Office for sizes not listed.
Tooling: pp. 116–145 Die Selector Chart: pp.146–153

¥ For installations from 16 kV up to 35 kV, consult shielded cable manufacturers for stress relief and insulation requirements.
* Blind End

Connectors for Copper Conductors

C o m p r e s s i o n

Two-Hole Lugs – 90° Standard Barrel Certified to 600V and Recommended up to 35 kV* (Continued)

Material: High-Conductivity
Wrought Copper
Finish: Electro Tin Plate

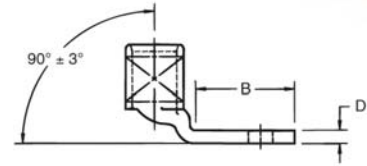
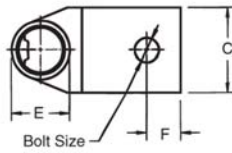

CAT. NO.	WIRE SIZE		Bolt Size	Dimensions in. (mm)						Die Code	Die Color
	Code	Flex Class G, H, I, K, M		B	C	D	E	F	G		
54214UB	300 kcmil	250 AWG	3/8	1.93 (49.0)	1.25 (31.8)	0.15 (3.8)	0.85 (21.6)	0.38 (9.7)	1.00 (25.4)	66	White
54280UB		300 Navy 650/24 = 262 kcmil	1/2	3.00 (76.2)	1.25 (31.8)	0.15 (3.8)	0.85 (21.6)	0.50 (12.7)	1.75 (44.5)	66	White
54215UB	350 kcmil	350 Navy	3/8	1.93 (49.0)	1.36 (34.5)	0.18 (4.6)	0.93 (23.6)	0.38 (9.7)	1.00 (25.4)	71	Red
54282UB		650/24 = 262 kcmil	1/2	3.00 (76.2)	1.36 (34.5)	0.18 (4.6)	0.93 (23.6)	0.50 (12.7)	1.75 (44.5)	71	Red
54216UB	400 kcmil	300/313 kcmil	3/8	1.93 (49.0)	1.41 (35.8)	0.17 (4.3)	0.96 (24.4)	0.38 (9.7)	1.06 (26.9)	76	Blue
54283UB		775/24	3/8	1.93 (49.0)	1.41 (35.8)	0.17 (4.3)	0.96 (24.4)	0.38 (9.7)	1.75 (44.5)	76	Blue
54277UB		400 Weld, 925/24, 373 kcmil 259/0.0393 427/0.0306	1/2	3.00 (76.2)	1.61 (40.9)	0.22 (5.6)	1.04 (26.4)	0.50 (12.7)	1.00 (25.4)	80	N/A
54218UB	500 kcmil	400 kcmil 500 Navy 925/24 = 373 kcmil	3/8	1.93 (49.0)	1.61 (40.9)	0.22 (5.6)	1.10 (27.9)	0.38 (9.7)	1.75 (44.5)	87	Brown
54286UB			1/2	3.00 (76.2)	1.61 (40.9)	0.22 (5.6)	1.10 (27.9)	0.50 (12.7)	1.75 (44.5)	87	Brown
256-30695-1221B			3/8		1.61 (40.9)	0.22 (5.6)	1.10 (27.9)	0.38 (9.7)	1.00 (25.4)	87	Brown
54220UB	600 kcmil	1100/24, 444 kcmil	3/8	1.93 (49.0)	1.75 (44.5)	0.24 (6.1)	1.20 (30.5)	0.38 (9.7)	1.75 (44.5)	94	Green
54289UB			1/2	3.00 (76.2)	1.75 (44.5)	0.24 (6.1)	1.20 (30.5)	0.50 (12.7)	1.75 (44.5)	94	Green
54291UB	700 kcmil	1325/24, 535 kcmil	1/2	3.00 (76.2)	1.84 (46.7)	0.23 (5.8)	1.25 (31.8)	0.50 (12.7)	1.75 (44.5)	99	Pink
54281UB			1/2	3.00 (76.2)	1.84 (46.7)	0.28 (7.1)	1.25 (31.8)	0.50 (12.7)	1.75 (44.5)	99	Pink
54223UB	750 kcmil		1/2	3.00 (76.2)	1.94 (49.3)	0.27 (6.9)	1.33 (33.8)	0.50 (12.7)	1.75 (44.5)	106	Black
54224UB	800 kcmil		1/2	3.00 (76.2)	2.01 (51.1)	0.27 (6.9)	1.38 (35.1)	0.50 (12.7)	1.75 (44.5)	106	Black
54226UB	900 kcmil	1925/24, 777 kcmil	1/2	3.00 (76.2)	2.18 (55.4)	0.31 (7.9)	1.50 (38.1)	0.50 (12.7)	1.75 (44.5)	115	Yellow
54228UB	1000 kcmil	1000 Navy	1/2	3.00 (76.2)	2.27 (57.7)	0.30 (7.6)	1.55 (39.4)	0.50 (12.7)	1.75 (44.5)	125	N/A

Tooling: pp. 116–145 Die Selector Chart: pp. 146–153

* For installations from 16 kV up to 35 kV, consult shielded cable manufacturers for stress relief and insulation requirements.