

Connectors for Copper Conductors

C o m p r e s s i o n

One-Hole Lugs – Standard Barrel Certified to 600V and Recommended up to 35 kV*

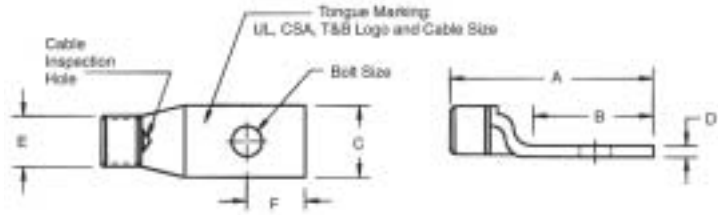

Material: High-Conductivity Wrought Copper
Finish: Electro Tin Plate



CAT. NO.	WIRE SIZE		Bolt Size	Dimensions in. (mm)						Die Code	Die Color
	Code	Flex Class G, H, I, K, M		A	B	C	D	E	F		
54101	#14-10 AWG		1/4	1.23 (31.2)	0.56 (14.2)	0.50 (12.7)	0.05 (1.3)	0.20 (5.1)	0.25 (6.4)	ERG2002	Yellow
54104	#8 AWG	#8 str., 23 Navy #8 Weld 37/24 0.180	#10	1.16 (29.5)	0.50 (12.7)	0.39 (9.9)	0.08 (2.0)	0.25 (6.4)	0.22 (5.6)	21	Red
54130			1/4	1.20 (30.5)	0.61 (15.5)	0.45 (11.4)	0.07 (1.8)	0.25 (6.4)	0.25 (6.4)	21	Red
54131			5/16	1.33 (33.8)	0.64 (16.3)	0.56 (14.2)	0.05 (1.3)	0.25 (6.4)	0.28 (7.1)	21	Red
54132			3/8	1.33 (33.8)	0.64 (16.3)	0.56 (14.2)	0.05 (1.3)	0.25 (6.4)	0.28 (7.1)	21	Red
54134	#6 AWG	#6 str., #30 Navy #6 Weld 61/24 133/0.014, 0.227	#10	1.23 (31.2)	0.53 (13.5)	0.44 (11.2)	0.07 (1.8)	0.31 (7.8)	0.22 (5.6)	24	Blue
54105			1/4	1.23 (31.2)	0.53 (13.5)	0.44 (11.2)	0.07 (1.8)	0.31 (7.8)	0.22 (5.6)	24	Blue
54135			5/16	1.41 (35.8)	0.67 (17.0)	0.60 (15.2)	0.07 (1.8)	0.31 (7.8)	0.31 (7.9)	24	Blue
54136			3/8	1.41 (35.8)	0.67 (17.0)	0.60 (15.2)	0.07 (1.8)	0.31 (7.8)	0.31 (7.9)	24	Blue
54138	#4 AWG	# 5 str., 40-50 Navy 91/24 133/0.0177, 49/0.029 0.265	#10	1.38 (35.1)	0.60 (15.2)	0.55 (14.0)	0.09 (2.3)	0.37 (9.4)	0.25 (6.4)	29	Grey
54106			1/4	1.38 (35.1)	0.60 (15.2)	0.55 (14.0)	0.09 (2.3)	0.37 (9.4)	0.25 (6.4)	29	Grey
54139			5/16	1.42 (36.1)	0.66 (16.8)	0.61 (15.5)	0.07 (1.8)	0.37 (9.4)	0.31 (7.9)	29	Grey
54140			3/8	1.42 (36.1)	0.66 (16.8)	0.61 (15.5)	0.07 (1.8)	0.37 (9.4)	0.31 (7.9)	29	Grey
54107	#2 AWG	#3 str., #60 Navy 125/24 #4 Weld 0.300	1/4	1.50 (38.1)	0.65 (16.5)	0.59 (15.0)	0.11 (2.8)	0.41 (10.4)	0.25 (6.4)	33	Brown
54142-TB			5/16	1.73 (43.9)	0.88 (22.4)	0.59 (15.0)	0.11 (2.8)	0.41 (10.4)	0.38 (9.7)	33	Brown
54143-TB			3/8	1.65 (41.9)	0.80 (20.3)	0.59 (15.0)	0.11 (2.8)	0.41 (10.4)	0.38 (9.7)	33	Brown
54145-TB			1/2	1.92 (48.8)	1.08 (27.4)	0.75 (19.1)	0.08 (2.0)	0.41 (10.4)	0.50 (12.7)	33	Brown
54108	#1 AWG	#2 str., 75 Navy, #2 Weld 150/24 175/24 133/0.0223, 0.360	1/4	1.50 (38.1)	0.65 (16.5)	0.68 (17.3)	0.11 (2.8)	0.47 (11.9)	0.25 (6.4)	37	Green
54147			5/16	1.73 (43.9)	0.93 (23.6)	0.68 (17.3)	0.11 (2.8)	0.47 (11.9)	0.38 (9.7)	37	Green
54148			3/8	1.78 (45.2)	0.98 (24.9)	0.68 (17.3)	0.11 (2.8)	0.47 (11.9)	0.38 (9.7)	37	Green
54150			1/2	2.10 (53.3)	1.25 (31.8)	0.76 (19.3)	0.11 (2.8)	0.47 (11.9)	0.50 (12.7)	37	Green
54152-TB	1/0 AWG	1 AWG, #100 Navy #1 Weld 225/24 133/0.0254, 0.389 min.	1/4	1.60 (40.6)	0.65 (16.5)	0.75 (19.1)	0.13 (3.3)	0.52 (13.2)	0.25 (6.4)	42	Pink
54153-TB			5/16	1.83 (46.5)	0.88 (22.4)	0.75 (19.1)	0.13 (3.3)	0.52 (13.2)	0.38 (9.7)	42	Pink
54109			3/8	1.88 (47.8)	0.93 (23.6)	0.75 (19.1)	0.13 (3.3)	0.52 (13.2)	0.38 (9.7)	42	Pink
54155-TB			1/2	2.20 (55.9)	1.25 (31.8)	0.75 (19.1)	0.13 (3.3)	0.52 (13.2)	0.50 (12.7)	42	Pink
54157	2/0 AWG	1/0 AWG, 125 Navy 1/0 Weld 275/24 427/0.0155, 438 min. 133/0.0282	1/4	1.65 (41.9)	0.65 (16.5)	0.83 (21.1)	0.13 (3.3)	0.57 (14.5)	0.25 (6.4)	45	Black
54158			5/16	1.88 (47.8)	0.88 (22.4)	0.83 (21.1)	0.13 (3.3)	0.57 (14.5)	0.38 (9.7)	45	Black
54110			3/8	1.93 (49.0)	0.93 (23.6)	0.83 (21.1)	0.13 (3.3)	0.57 (14.5)	0.38 (9.7)	45	Black
54160			1/2	2.25 (57.2)	1.25 (31.8)	0.83 (21.1)	0.13 (3.3)	0.57 (14.5)	0.50 (12.7)	45	Black

Call your Regional Sales Office for sizes not listed.

Tooling: pp. 112-141 Die Selector Chart: pp. 142-149

* For installations from 16 kV up to 35 kV, consult shielded cable manufacturers for stress relief and insulation requirements.

Connectors for Copper Conductors

One-Hole Lugs – Standard Barrel
Certified to 600V
and Recommended up to 35 kV*
(Continued)

Material: High-Conductivity Wrought Copper
Finish: Electro Tin Plate

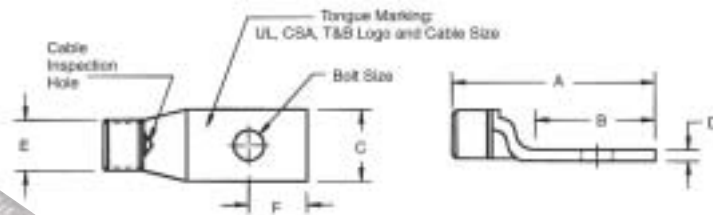

C O M P R E S S I O N

CAT. NO.	WIRE SIZE		Bolt Size	Dimensions in. (mm)						Die Code	Die Color
	Code	Flex Class G, H, I, K, M		A	B	C	D	E	F		
54162-TB	3/0 AWG	2/0 AWG, 150 Navy 2/0 Weld 325/24	1/4	1.75 (44.5)	0.65 (16.5)	0.92 (23.4)	0.13 (3.3)	0.63 (16.0)	0.25 (6.4)	50	Orange
54163-TB			5/16	1.98 (50.3)	0.88 (22.4)	0.92 (23.4)	0.13 (3.3)	0.63 (16.0)	0.38 (9.7)	50	Orange
54111			3/8	2.03 (51.6)	0.93 (23.6)	0.92 (23.4)	0.13 (3.3)	0.63 (16.0)	0.38 (9.7)	50	Orange
54165-TB			1/2	2.35 (59.7)	1.25 (31.8)	0.92 (23.4)	0.13 (3.3)	0.63 (16.0)	0.50 (12.7)	50	Orange
54167	4/0 AWG	3/0 AWG, 200 Navy 3/0 Weld 450/24	1/4	1.90 (48.3)	0.65 (16.5)	1.03 (26.2)	0.14 (3.6)	0.70 (17.8)	0.25 (6.4)	54	Purple
54168			5/16	2.13 (54.1)	0.87 (22.1)	1.03 (26.2)	0.14 (3.6)	0.70 (17.8)	0.38 (9.7)	54	Purple
54112			3/8	2.18 (55.4)	0.93 (23.6)	1.03 (26.2)	0.14 (3.6)	0.70 (17.8)	0.38 (9.7)	54	Purple
54170			1/2	2.50 (63.5)	1.25 (31.8)	1.03 (26.2)	0.14 (3.6)	0.70 (17.8)	0.50 (12.7)	54	Purple
58161		4/0 Weld 550/24	1/4	2.23 (56.6)	0.78 (19.8)	1.25 (31.8)	0.15 (3.8)	0.79 (20.1)	0.38 (9.7)	62	Yellow
58162			5/16	2.33 (59.2)	0.88 (22.4)	1.25 (31.8)	0.15 (3.8)	0.79 (20.1)	0.38 (9.7)	62	Yellow
58163			3/8	2.38 (60.5)	0.93 (23.6)	1.25 (31.8)	0.15 (3.8)	0.79 (20.1)	0.38 (9.7)	62	Yellow
58165			1/2	2.76 (70.1)	1.25 (31.8)	1.25 (31.8)	0.15 (3.8)	0.79 (20.1)	0.50 (12.7)	62	Yellow
58166			5/8	3.03 (77.0)	1.58 (40.1)	1.25 (31.8)	0.15 (3.8)	0.79 (20.1)	0.83 (21.1)	62	Yellow
54172-TB	250 kcmil	4/0 250 Navy 0.629 min.	1/4	2.00 (50.8)	0.65 (16.5)	1.13 (28.7)	0.14 (3.6)	0.77 (19.6)	0.50 (12.7)	62	Yellow
54173			5/16	2.23 (56.6)	0.88 (22.4)	1.13 (28.7)	0.14 (3.6)	0.77 (19.6)	0.38 (9.7)	62	Yellow
54174			3/8	2.28 (57.9)	0.93 (23.6)	1.13 (28.7)	0.14 (3.6)	0.77 (19.6)	0.38 (9.7)	62	Yellow
54113			1/2	2.60 (66.0)	1.25 (31.8)	1.13 (28.7)	0.14 (3.6)	0.77 (19.6)	0.50 (12.7)	62	Yellow
58168		250 Weld 650/24 = 262 kcmil 259/0.0311, 703/0.0189	1/2	2.70 (68.6)	1.25 (31.8)	1.25 (31.8)	0.15 (3.8)	0.85 (21.6)	0.50 (12.7)	66	White
54178	300 kcmil	250 kcmil 300 Navy 0.660	5/16	2.33 (59.2)	0.88 (22.4)	1.25 (31.8)	0.15 (3.8)	0.85 (21.6)	0.38 (9.7)	66	White
54179			3/8	2.43 (61.7)	0.93 (23.6)	1.25 (31.8)	0.15 (3.8)	0.85 (21.6)	0.38 (9.7)	66	White
54114			1/2	2.70 (68.6)	1.25 (31.8)	1.25 (31.8)	0.15 (3.8)	0.85 (21.6)	0.50 (12.7)	66	White
54181			5/8	3.03 (77.0)	1.58 (40.1)	1.25 (31.8)	0.15 (3.8)	0.85 (21.6)	0.75 (19.1)	66	White
58171		300 Weld, 259/0.034 427/0.0265, 889/0.0183 775/24 = 313 kcmil 0.719	1/2	2.85 (72.4)	1.25 (31.8)	1.36 (34.5)	0.18 (4.6)	0.93 (23.6)	0.50 (12.7)	71	Red
54115	350 kcmil	350 Navy 0.719	1/2	2.85 (72.4)	1.25 (31.8)	1.36 (34.5)	0.18 (4.6)	0.93 (23.6)	0.50 (12.7)	71	Red
54183			5/8	3.21 (81.5)	1.28 (32.5)	1.36 (34.5)	0.18 (4.6)	0.93 (23.6)	0.75 (19.1)	71	Red
58174		350 Weld, 259/0.0368 427/0.0285 889/0.0201	1/2	3.35 (85.1)	1.25 (31.8)	1.61 (40.9)	0.22 (5.6)	1.09 (27.7)	0.50 (12.7)	76	Blue
54116	400 kcmil	300 kcmil 400 Navy, 0.757	1/2	3.20 (81.3)	1.25 (31.8)	1.41 (35.8)	0.17 (4.3)	0.96 (24.4)	0.50 (12.7)	76	Blue
54185			5/8	3.53 (89.7)	1.58 (40.1)	1.41 (35.8)	0.17 (4.3)	0.96 (24.4)	0.75 (19.1)	76	Blue

Call your Regional Sales Office for sizes not listed.
 Tooling: pp. 112-141 Die Selector Chart: pp. 142-149
 * For installations from 16 kV up to 35 kV, consult shielded cable manufacturers for stress relief and insulation requirements.

Connectors for Copper Conductors

C o m p r e s s i o n

One-Hole Lugs – Standard Barrel Certified to 600V and Recommended up to 35 kV* (Continued)

Material: High-Conductivity Wrought Copper
Finish: Electro Tin Plate

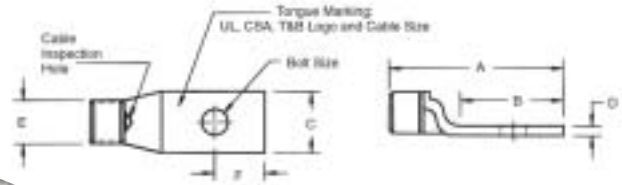

CAT. NO.	WIRE SIZE		Bolt Size	Dimensions in. (mm)						Die Code	Die Color
	Code	Flex Class G, H, I, K, M		A	B	C	D	E	F		
58177		400 Weld 925/24 = 373 kcmil 259/0.0393 or 427/0.0306, 0.799	1/2	3.31 (84.1)	1.25 (31.8)	1.61 (40.9)	0.22 (5.6)	1.04 (26.4)	0.50 (12.7)	80	N/A
54118	500 kcmil	925/24 500 Navy 0.850	1/2	3.30 (83.8)	1.25 (31.8)	1.61 (40.9)	0.22 (5.6)	1.10 (27.9)	0.50 (12.7)	87	Brown
54187			5/8	3.63 (92.2)	1.58 (40.1)	1.61 (40.9)	0.22 (5.6)	1.10 (27.9)	0.63 (16.0)	87	Brown
58180		1100/24 = 444 kcmil 500 Weld, 259/0.0417 427/0.0325, 703/0.0253	5/8	3.79 (96.3)	1.58 (40.1)	1.75 (44.5)	0.24 (6.1)	1.20 (30.5)	0.63 (16.0)	94	Green
54120	600 kcmil	0.956	5/8	3.79 (96.3)	1.58 (40.1)	1.75 (44.5)	0.24 (6.1)	1.20 (30.5)	0.63 (16.0)	94	Green
54122-TB	700 kcmil	–	5/8	3.68 (93.5)	1.58 (40.1)	1.84 (46.7)	0.23 (5.8)	1.26 (32.0)	0.63 (16.0)	99	Pink
58182		1325/24 = 500/535 kcmil 427/0.0342, 0.968	5/8	3.83 (97.3)	1.58 (40.1)	1.81 (46.0)	0.28 (7.1)	1.25 (31.8)	0.63 (16.0)	99	Pink
54123-TB	750 kcmil	1.060	5/8	3.87 (98.3)	1.58 (40.1)	1.94 (49.3)	0.27 (6.9)	1.33 (33.8)	0.63 (16.0)	106	Black
58184		1600/24 = 646 kcmil	5/8	3.80 (96.5)	1.58 (40.1)	1.94 (49.3)	0.27 (6.9)	1.33 (33.8)	0.63 (16.0)	106	Black
54124-TB	800 kcmil	800 Navy, 1.109	5/8	4.04 (102.6)	1.58 (40.1)	2.01 (51.1)	0.27 (6.9)	1.38 (35.1)	0.63 (16.0)	107	Orange
54126	900 kcmil	1925/24 = 750/777 kcmil 1.187	5/8	4.15 (105.4)	1.58 (40.1)	2.17 (55.1)	0.31 (7.9)	1.50 (38.1)	0.63 (16.0)	115	Yellow
54128	1000 kcmil	1000 Navy, 1.253	5/8	4.09 (103.9)	1.58 (40.1)	2.27 (57.7)	0.30 (7.6)	1.55 (39.4)	0.63 (16.0)	125	N/A

Call your Regional Sales Office for sizes not listed.

Tooling: pp. 112–141 Die Selector Chart: pp. 142–149

* For installations from 16 kV up to 35 kV, consult shielded cable manufacturers for stress relief and insulation requirements.

Connectors for Copper Conductors

One-Hole Lugs – 45° Standard Barrel Certified to 600V and Recommended up to 35 kV‡

Material: High-Conductivity
Wrought Copper

Finish: Electro Tin Plate

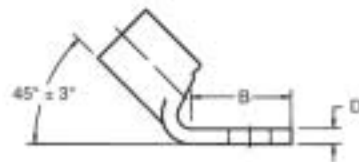
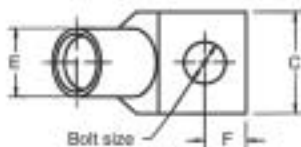

C o m p r e s s i o n

CAT. NO.	WIRE SIZE		Bolt Size	Dimensions in. (mm)					Die Code	Die Color
	Code	Flex Class G, H, I, K, M		B	C	D	E	F		
54104UF	#8 AWG	#8 str., 23 Navy #8 Weld 37/24 0.180	#10	0.50 (12.7)	0.39 (9.9)	0.08 (2.0)	0.25 (6.4)	0.22 (5.6)	21	Red
54130UF			1/4	0.61 (15.5)	0.45 (11.4)	0.07 (1.8)	0.25 (6.4)	0.25 (6.4)	21	Red
54131UF			5/16	0.64 (16.3)	0.56 (14.2)	0.05 (1.3)	0.25 (6.4)	0.28 (7.1)	21	Red
54132UF			3/8	0.64 (16.3)	0.56 (14.2)	0.05 (1.3)	0.25 (6.4)	0.28 (7.1)	21	Red
54134UF	#6 AWG	#6 str., 30 Navy #6 Weld 61/24 133/0.014 0.227	#10	0.53 (13.5)	0.44 (11.2)	0.07 (1.8)	0.31 (7.9)	0.22 (5.6)	24	Blue
54105UF			1/4	0.53 (13.5)	0.44 (11.2)	0.07 (1.8)	0.31 (7.9)	0.22 (5.6)	24	Blue
54135UF			5/16	0.67 (17.0)	0.60 (15.2)	0.07 (1.8)	0.31 (7.9)	0.31 (7.8)	24	Blue
54136UF			3/8	0.67 (17.0)	0.60 (15.2)	0.07 (1.8)	0.31 (7.9)	0.31 (7.8)	24	Blue
54138UF	#4 AWG	#5 str., 40-50 Navy 91/24 133/0.0177 49/0.029 0.265	#10	0.60 (15.2)	0.55 (14.0)	0.09 (2.3)	0.37 (9.4)	0.25 (6.4)	29	Grey
54106UF			1/4	0.60 (15.2)	0.55 (14.0)	0.09 (2.3)	0.37 (9.4)	0.25 (6.4)	29	Grey
54139UF			5/16	0.66 (16.8)	0.61 (15.5)	0.07 (1.8)	0.37 (9.4)	0.31 (7.8)	29	Grey
54140UF			3/8	0.66 (16.8)	0.61 (15.5)	0.07 (1.8)	0.37 (9.4)	0.31 (7.8)	29	Grey
54107UF	#2 AWG	#3 str. 60 Navy 125/24 #4 Weld 0.300	1/4	0.65 (16.5)	0.59 (15.0)	0.11 (2.8)	0.41 (10.4)	0.25 (6.4)	33	Brown
54142UF			5/16	0.88 (22.4)	0.59 (15.0)	0.11 (2.8)	0.41 (10.4)	0.38 (9.7)	33	Brown
54143UF			3/8	0.80 (20.3)	0.59 (15.0)	0.11 (2.8)	0.41 (10.4)	0.38 (9.7)	33	Brown
54145UF			1/2	1.08 (27.4)	0.75 (19.1)	0.08 (2.0)	0.41 (10.4)	0.50 (12.7)	33	Brown
54108UF	#1 AWG	#2 AWG, 75 Navy, #2 Weld 150/24 175/24 133/0.0223 0.360	1/4	0.65 (16.5)	0.68 (17.3)	0.11 (2.8)	0.47 (11.9)	0.25 (6.4)	37	Green
54147UF			5/16	0.93 (23.6)	0.68 (17.3)	0.11 (2.8)	0.47 (11.9)	0.38 (9.7)	37	Green
54148UF			3/8	0.98 (24.9)	0.68 (17.3)	0.11 (2.8)	0.47 (11.9)	0.38 (9.7)	37	Green
54150UF			1/2	1.25 (31.8)	0.76 (19.3)	0.11 (2.8)	0.47 (11.9)	0.50 (12.7)	37	Green
54152UF	1/0 AWG	#1 AWG 100 Navy, #1 Weld 225/24 133/0.0254 0.389	1/4	0.65 (16.5)	0.75 (19.1)	0.13 (3.3)	0.52 (13.2)	0.25 (6.4)	42	Pink
54153UF			5/16	0.88 (22.4)	0.75 (19.1)	0.13 (3.3)	0.52 (13.2)	0.38 (9.7)	42	Pink
54109UF			3/8	0.93 (23.6)	0.75 (19.1)	0.13 (3.3)	0.52 (13.2)	0.38 (9.7)	42	Pink
54155UF			1/2	1.25 (31.8)	0.75 (19.1)	0.13 (3.3)	0.52 (13.2)	0.50 (12.7)	42	Pink
54157UF	2/0 AWG	1/0 AWG, 125 Navy 1/0 Weld 275/24 427/0.0155, 133/0.0282	1/4	0.65 (16.5)	0.83 (21.1)	0.13 (3.3)	0.57 (14.5)	0.25 (6.4)	45	Black
54158UF			5/16	0.88 (22.4)	0.83 (21.1)	0.13 (3.3)	0.57 (14.5)	0.38 (9.7)	45	Black
54110UF			3/8	0.93 (23.6)	0.83 (21.1)	0.13 (3.3)	0.57 (14.5)	0.38 (9.7)	45	Black
54160UF			1/2	1.25 (31.8)	0.83 (21.1)	0.13 (3.3)	0.57 (14.5)	0.50 (12.7)	45	Black
54162UF	3/0 AWG	2/0 AWG, 150 Navy 2/0 Weld, 325/24 133/0.0316, 259/0.0227 427/0.0177	1/4	0.65 (16.5)	0.92 (23.4)	0.13 (3.3)	0.63 (16.0)	0.25 (6.4)	50	Orange
54163UF			5/16	0.88 (22.4)	0.92 (23.4)	0.13 (3.3)	0.63 (16.0)	0.38 (9.7)	50	Orange
54111UF			3/8	0.93 (23.6)	0.92 (23.4)	0.13 (3.3)	0.63 (16.0)	0.38 (9.7)	50	Orange
54165UF			1/2	1.25 (31.8)	0.92 (23.4)	0.13 (3.3)	0.63 (16.0)	0.50 (12.7)	50	Orange
58147UF*		375/24	1/4	0.78 (19.8)	1.03 (26.2)	0.16 (4.1)	0.70 (17.8)	0.34 (8.6)	50	Orange
58148UF*			5/16	0.78 (19.8)	1.03 (26.2)	0.16 (4.1)	0.70 (17.8)	0.34 (8.6)	50	Orange
58149UF*			3/8	0.81 (20.6)	1.03 (26.2)	0.16 (4.1)	0.70 (17.8)	0.38 (9.7)	50	Orange
58151UF*			1/2	1.06 (26.9)	1.03 (26.2)	0.16 (4.1)	0.70 (17.8)	0.50 (12.7)	50	Orange
54167UF	4/0 AWG	3/0 AWG 200 Navy, 3/0 Weld 450/24 703/0.0154	1/4	0.65 (16.5)	1.03 (26.2)	0.14 (3.6)	0.70 (17.8)	0.25 (6.4)	54	Purple
54168UF			5/16	0.87 (22.1)	1.03 (26.2)	0.14 (3.6)	0.70 (17.8)	0.38 (9.7)	54	Purple
54112UF			3/8	0.93 (23.6)	1.03 (26.2)	0.14 (3.6)	0.70 (17.8)	0.38 (9.7)	54	Purple
54170UF			1/2	1.25 (31.8)	1.03 (26.2)	0.14 (3.6)	0.70 (17.8)	0.50 (12.7)	54	Purple
58161UF		4/0 AWG, 4/0 Weld 550/24 133/0.0399 259/0.0286 637/0.0183	1/4	0.78 (19.8)	1.25 (31.8)	0.15 (3.8)	0.79 (20.1)	0.38 (9.7)	62	Yellow
58162UF			5/16	0.88 (22.4)	1.25 (31.8)	0.15 (3.8)	0.79 (20.1)	0.38 (9.7)	62	Yellow
58163UF			3/8	0.93 (23.6)	1.25 (31.8)	0.15 (3.8)	0.79 (20.1)	0.38 (9.7)	62	Yellow
58165UF			1/2	1.25 (31.8)	1.25 (31.8)	0.15 (3.8)	0.79 (20.1)	0.50 (12.7)	62	Yellow
58166UF			5/8	1.58 (40.1)	1.25 (31.8)	0.15 (3.8)	0.79 (20.1)	0.63 (16.0)	62	Yellow

* Not CSA approved.
Call your Regional Sales Office for sizes not listed.

‡ For installations from 16 kV up to 35 kV, consult shielded cable manufacturers for stress relief and insulation requirements.

Connectors for Copper Conductors

C o m p r e s s i o n

One-Hole Lugs – 45° Standard Barrel Certified to 600V and Recommended up to 35 kV[‡] (Continued)

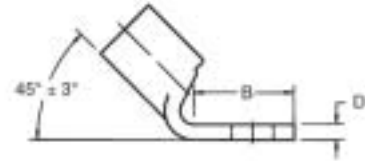
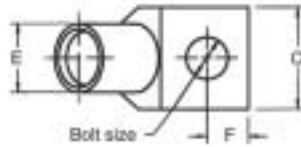

Material: High-Conductivity
Wrought Copper
Finish: Electro Tin Plate



CAT. NO.	WIRE SIZE		Bolt Size	Dimensions in. (mm)					Die Code	Die Color
	Code	Flex Class G, H, I, K, M		B	C	D	E	F		
54172UF	250 kcmil	4/0 AWG 250 Navy 550/24	1/4	0.65 (16.5)	1.13 (28.7)	0.14 (3.6)	0.77 (19.6)	0.25 (6.4)	62	Yellow
54173UF			5/16	0.88 (22.4)	1.13 (28.7)	0.14 (3.6)	0.77 (19.6)	0.38 (9.7)	62	Yellow
54174UF			3/8	0.93 (23.6)	1.13 (28.7)	0.14 (3.6)	0.77 (19.6)	0.38 (9.7)	62	Yellow
54113UF			1/2	1.25 (31.8)	1.13 (28.7)	0.14 (3.6)	0.77 (19.6)	0.50 (12.7)	62	Yellow
54168UF		250 Weld 650/24 259/0.0311, 703/0.0189	1/2	1.25 (31.8)	1.25 (31.8)	0.15 (3.8)	0.85 (21.6)	0.50 (12.7)	66	White
54178UF	300 kcmil	250 kcmil 300 Navy 650/24	5/16	0.88 (22.4)	1.25 (31.8)	0.15 (3.8)	0.85 (21.6)	0.38 (9.7)	66	White
54179UF			3/8	0.93 (23.6)	1.25 (31.8)	0.15 (3.8)	0.85 (21.6)	0.38 (9.7)	66	White
54114UF			1/2	1.25 (31.8)	1.25 (31.8)	0.15 (3.8)	0.85 (21.6)	0.50 (12.7)	66	White
54181UF			5/8	1.58 (40.1)	1.25 (31.8)	0.15 (3.8)	0.85 (21.6)	0.63 (16.0)	66	White
54171UF		300 kcmil, 300 Weld 259/0.034, 427/0.0265 889/0.0183 775/24 = 313 kcmil	1/2	1.25 (31.8)	1.36 (34.5)	0.18 (4.6)	0.93 (23.6)	0.50 (12.7)	71	Red
54115UF	350 kcmil	650/24 350 Navy 262 kcmil	1/2	1.25 (31.8)	1.36 (34.5)	0.18 (4.6)	0.93 (23.6)	0.50 (12.7)	71	Red
54183UF			5/8	1.58 (40.1)	1.36 (34.5)	0.18 (4.6)	0.93 (23.6)	0.63 (16.0)	71	Red
54174UF		350 Weld 259/0.0368, 427/0.0285 703/0.0224, 889/0.0201	1/2	1.25 (31.8)	1.61 (40.9)	0.22 (5.6)	1.09 (27.7)	0.50 (12.7)	76	Blue
54116UF	400 kcmil	300 kcmil 400 Navy 775/24, 313 kcmil	1/2	1.25 (31.8)	1.41 (35.8)	0.17 (4.3)	0.96 (24.4)	0.50 (12.7)	76	Blue
54185UF			5/8	1.58 (40.1)	1.41 (35.8)	0.17 (4.3)	0.96 (24.4)	0.63 (16.0)	76	Blue
54177UF		350 kcmil, 400 Weld 925/24 = 373 kcmil	1/2	1.25 (31.8)	1.61 (40.9)	0.22 (5.6)	1.04 (26.4)	0.50 (12.7)	80	N/A
58118UF	500 kcmil	925/24 500 Navy 400 kcmil	1/2	1.25 (31.8)	1.61 (40.9)	0.22 (5.6)	1.10 (27.9)	0.50 (12.7)	87	Brown
58187UF			5/8	1.58 (40.1)	1.61 (40.9)	0.22 (5.6)	1.10 (27.9)	0.63 (16.0)	87	Brown
58180UF		1100/24 = 444 kcmil 500 Weld, 259/0.0417 427/0.0325, 703/0.0253	5/8	1.58 (40.1)	1.75 (44.5)	0.24 (6.1)	1.20 (30.5)	0.50 (12.7)	94	Green
58120UF	600 kcmil	1110/24 = 444 kcmil	5/8	1.58 (40.1)	1.75 (44.5)	0.24 (6.1)	1.20 (30.5)	0.50 (12.7)	94	Green
58122UF	700 kcmil	1325/24 = 500 kcmil	5/8	1.58 (40.1)	1.84 (46.7)	0.23 (5.8)	1.26 (32.0)	0.50 (12.7)	99	Pink
54182UF		1325/24 = 535 kcmil 427/0.0342	5/8	1.58 (40.1)	1.81 (46.0)	0.28 (7.1)	1.25 (31.8)	0.63 (16.0)	99	Pink
54123UF	750 kcmil	1325/24 = 535 kcmil	5/8	1.58 (40.1)	1.94 (49.3)	0.27 (6.9)	1.33 (33.8)	0.63 (16.0)	106	Black
54184UF		1600/24 = 646 kcmil	5/8	1.58 (40.1)	1.94 (49.3)	0.27 (6.9)	1.33 (33.8)	0.63 (16.0)	106	Black
54124UF	800 kcmil	800 Navy	5/8	1.58 (40.1)	2.01 (51.1)	0.27 (6.9)	1.38 (35.1)	0.63 (16.0)	107	Orange
58126UF	900 kcmil	1925/24 = 777 kcmil	5/8	1.58 (40.1)	2.17 (55.1)	0.31 (7.9)	1.50 (38.1)	0.63 (16.0)	115	Yellow
58128UF	1000 kcmil	1000 Navy	5/8	1.58 (40.1)	2.27 (57.7)	0.30 (7.6)	1.55 (39.4)	0.63 (16.0)	125	N/A

Call your Regional Sales Office for sizes not listed.

Tooling: pp. 112-141 Die Selector Chart: pp. 142-149

‡ For installations from 16 kV up to 35 kV, consult shielded cable manufacturers for stress relief and insulation requirements.

Connectors for Copper Conductors

One-Hole Lugs – 90° Standard Barrel Certified to 600V and Recommended up to 35 kV‡

Material: High-Conductivity
Wrought Copper

Finish: Electro Tin Plate

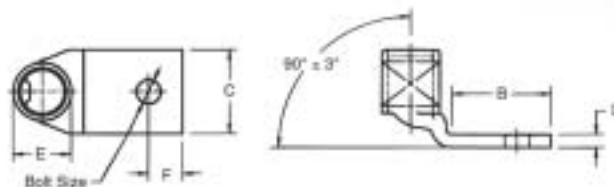

C o m p r e s s i o n

CAT. NO.	WIRE SIZE		Bolt Size	Dimensions in. (mm)					Die Code	Die Color
	Code	Flex Class G, H, I, K, M		B	C	D	E	F		
54104UB	#8 AWG	#8 str. 23 Navy #8 Weld 37/24 0.180	#10	0.50 (12.7)	0.39 (9.9)	0.08 (2.0)	0.25 (6.4)	0.22 (5.6)	21	Red
54130UB			1/4	0.61 (15.5)	0.45 (11.4)	0.07 (1.8)	0.25 (6.4)	0.25 (6.4)	21	Red
54131UB			5/16	0.64 (16.3)	0.56 (14.2)	0.05 (1.3)	0.25 (6.4)	0.28 (7.1)	21	Red
54132UB			3/8	0.64 (16.3)	0.56 (14.2)	0.05 (1.3)	0.25 (6.4)	0.28 (7.1)	21	Red
54134UB	#6 AWG	#6 AWG, 30 Navy #6 Weld 61/24 133/0.014 0.227	#10	0.53 (13.5)	0.44 (11.2)	0.07 (1.8)	0.31 (7.9)	0.22 (5.6)	24	Blue
54105UB			1/4	0.53 (13.5)	0.44 (11.2)	0.07 (1.8)	0.31 (7.9)	0.22 (5.6)	24	Blue
54135UB			5/16	0.67 (17.0)	0.60 (15.2)	0.07 (1.8)	0.31 (7.9)	0.31 (7.8)	24	Blue
54136UB			3/8	0.67 (17.0)	0.60 (15.2)	0.07 (1.8)	0.31 (7.9)	0.31 (7.8)	24	Blue
54138UB	#4 AWG	#5 AWG, 40/50 Navy 91/24 133/0.0177 49/0.029 0.265	#10	0.60 (15.2)	0.55 (14.0)	0.09 (2.3)	0.37 (9.4)	0.25 (6.4)	29	Grey
54106UB			1/4	0.60 (15.2)	0.55 (14.0)	0.09 (2.3)	0.37 (9.4)	0.25 (6.4)	29	Grey
54139UB			5/16	0.66 (16.8)	0.61 (15.5)	0.07 (1.8)	0.37 (9.4)	0.31 (7.8)	29	Grey
54140UB			3/8	0.66 (16.8)	0.61 (15.5)	0.07 (1.8)	0.37 (9.4)	0.31 (7.8)	29	Grey
54107UB	#2 AWG	#3 AWG 60 Navy 125/24 #4 Weld 0.300	1/4	0.65 (16.5)	0.59 (15.0)	0.11 (2.8)	0.41 (10.4)	0.25 (6.4)	33	Brown
54142UB			5/16	0.88 (22.4)	0.59 (15.0)	0.11 (2.8)	0.41 (10.4)	0.38 (9.7)	33	Brown
54143UB			3/8	0.80 (20.3)	0.59 (15.0)	0.11 (2.8)	0.41 (10.4)	0.38 (9.7)	33	Brown
54145UB			1/2	1.08 (27.4)	0.75 (19.1)	0.08 (2.0)	0.41 (10.4)	0.50 (12.7)	33	Brown
54108UB	#1 AWG	#2 AWG, 75 Navy, #2 Weld 150/24 175/24 133/0.0223 0.360	1/4	0.65 (16.5)	0.68 (17.3)	0.11 (2.8)	0.47 (11.9)	0.25 (6.4)	37	Green
54147UB			5/16	0.93 (23.6)	0.68 (17.3)	0.11 (2.8)	0.47 (11.9)	0.38 (9.7)	37	Green
54148UB			3/8	0.98 (24.9)	0.68 (17.3)	0.11 (2.8)	0.47 (11.9)	0.38 (9.7)	37	Green
54150UB			1/2	1.25 (31.8)	0.76 (19.3)	0.11 (2.8)	0.47 (11.9)	0.50 (12.7)	37	Green
54152UB	1/0 AWG	#1 AWG 100 Navy, #1 Weld 225/24 133/0.0254 0.389	1/4	0.65 (16.5)	0.75 (19.1)	0.13 (3.3)	0.52 (13.2)	0.25 (6.4)	42	Pink
54153UB			5/16	0.88 (22.4)	0.75 (19.1)	0.13 (3.3)	0.52 (13.2)	0.38 (9.7)	42	Pink
54109UB			3/8	0.93 (23.6)	0.75 (19.1)	0.13 (3.3)	0.52 (13.2)	0.38 (9.7)	42	Pink
54155UB			1/2	1.25 (31.8)	0.75 (19.1)	0.13 (3.3)	0.52 (13.2)	0.50 (12.7)	42	Pink
54157UB	2/0 AWG	1/0 AWG, 125 Navy 1/0 Weld 275/24 427/0.0155, 133/0.0282	1/4	0.65 (16.5)	0.83 (21.1)	0.13 (3.3)	0.57 (14.5)	0.25 (6.4)	45	Black
54158UB			5/16	0.88 (22.4)	0.83 (21.1)	0.13 (3.3)	0.57 (14.5)	0.38 (9.7)	45	Black
54110UB			3/8	0.93 (23.6)	0.83 (21.1)	0.13 (3.3)	0.57 (14.5)	0.38 (9.7)	45	Black
54160UB			1/2	1.25 (31.8)	0.83 (21.1)	0.13 (3.3)	0.57 (14.5)	0.50 (12.7)	45	Black
54162UB	3/0 AWG	2/0 AWG, 150 Navy, 2/0 Weld 325/24 133/0.0316, 259/0.0227 427/0.0177	1/4	0.65 (16.5)	0.92 (23.4)	0.13 (3.3)	0.63 (16.0)	0.25 (6.4)	50	Orange
54163UB			5/16	0.88 (22.4)	0.92 (23.4)	0.13 (3.3)	0.63 (16.0)	0.38 (9.7)	50	Orange
54111UB			3/8	0.93 (23.6)	0.92 (23.4)	0.13 (3.3)	0.63 (16.0)	0.38 (9.7)	50	Orange
54165UB			1/2	1.25 (31.8)	0.92 (23.4)	0.13 (3.3)	0.63 (16.0)	0.50 (12.7)	50	Orange
54167UB	4/0 AWG	3/0 AWG, 200 Navy, 3/0 Weld 450/24 703/0.0154	1/4	0.65 (16.5)	1.03 (26.2)	0.14 (3.6)	0.70 (17.8)	0.34 (8.6)	54	Purple
54168UB			5/16	0.87 (22.1)	1.03 (26.2)	0.14 (3.6)	0.70 (17.8)	0.34 (8.6)	54	Purple
54112UB			3/8	0.93 (23.6)	1.03 (26.2)	0.14 (3.6)	0.70 (17.8)	0.38 (9.7)	54	Purple
54170UB			1/2	1.25 (31.8)	1.03 (26.2)	0.14 (3.6)	0.70 (17.8)	0.50 (12.7)	54	Purple
58161UB	4/0 AWG	3/0 AWG, 4/0 Weld 550/24 133/0.0399 259/0.0286 637/0.0183	1/4	0.78 (19.8)	1.25 (31.8)	0.15 (3.8)	0.79 (20.1)	0.38 (9.7)	62	Yellow
58162UB			5/16	0.88 (22.4)	1.25 (31.8)	0.15 (3.8)	0.79 (20.1)	0.38 (9.7)	62	Yellow
58163UB			3/8	0.93 (23.6)	1.25 (31.8)	0.15 (3.8)	0.79 (20.1)	0.38 (9.7)	62	Yellow
58165UB			1/2	1.25 (31.8)	1.25 (31.8)	0.15 (3.8)	0.79 (20.1)	0.50 (12.7)	62	Yellow
58166UB			5/8	1.58 (40.1)	1.25 (31.8)	0.15 (3.8)	0.79 (20.1)	0.63 (16.0)	62	Yellow

Call your Regional Sales Office for sizes not listed.
Tooling: pp. 112–141 Die Selector Chart: pp. 142–149

‡ For installations from 16 kV up to 35 kV, consult shielded cable manufacturers for stress relief and insulation requirements.

Connectors for Copper Conductors

C o m p r e s s i o n

**One-Hole Lugs –
90° Standard Barrel
Certified to 600V
and Recommended
up to 35 kV[‡](Continued)**

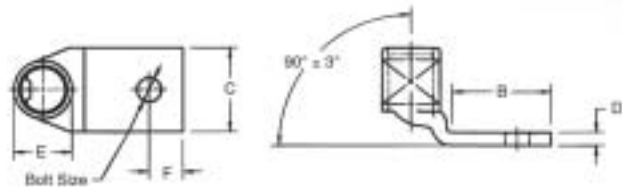

Material: High-Conductivity Wrought Copper
Finish: Electro Tin Plate



CAT. NO.	WIRE SIZE		Bolt Size	Dimensions in. (mm)					Die Code	Die Color
	Code	Flex Class G, H, I, K, M		B	C	D	E	F		
54172UB	250 kcmil	4/0 AWG 250 Navy 550/24	1/4	0.65 (16.5)	1.13 (28.7)	0.14 (3.6)	0.77 (19.6)	0.25 (6.4)	62	Yellow
54173UB			5/16	0.88 (22.4)	1.13 (28.7)	0.14 (3.6)	0.77 (19.6)	0.38 (9.7)	62	Yellow
54174UB			3/8	0.93 (23.6)	1.13 (28.7)	0.14 (3.6)	0.77 (19.6)	0.38 (9.7)	62	Yellow
54113UB			1/2	1.25 (31.8)	1.13 (28.7)	0.14 (3.6)	0.77 (19.6)	0.50 (12.7)	62	Yellow
54168UB	300 kcmil	250 Weld 650/24 = 262 kcmil 259/0.0311, 703/0.0189	1/2	1.25 (31.8)	1.25 (31.8)	0.15 (3.8)	0.85 (21.6)	0.50 (12.7)	66	White
54178UB			5/16	0.88 (22.4)	1.25 (31.8)	0.15 (3.8)	0.85 (21.6)	0.38 (9.7)	66	White
54179UB			3/8	0.93 (23.6)	1.25 (31.8)	0.15 (3.8)	0.85 (21.6)	0.38 (9.7)	66	White
54114UB			1/2	1.25 (31.8)	1.25 (31.8)	0.15 (3.8)	0.85 (21.6)	0.50 (12.7)	66	White
54181UB	5/8	1.58 (40.1)	1.25 (31.8)	0.15 (3.8)	0.85 (21.6)	0.63 (16.0)	66	White		
54171UB	350 kcmil	300 Weld, 259/0.034 427/0.0265, 889/0.0183 775/24 = 313 kcmil	1/2	1.25 (31.8)	1.36 (34.5)	0.18 (4.6)	0.93 (23.6)	0.50 (12.7)	71	Red
54115UB			1/2	1.25 (31.8)	1.36 (34.5)	0.18 (4.6)	0.93 (23.6)	0.50 (12.7)	71	Red
54183UB			5/8	1.58 (40.1)	1.36 (34.5)	0.18 (4.6)	0.93 (23.6)	0.63 (16.0)	71	Red
58174UB	400 kcmil	350 Weld 259/0.0368, 427/0.0285 703/0.0224, 889/0.0201	1/2	1.25 (31.8)	1.61 (40.9)	0.22 (5.6)	1.09 (27.7)	0.50 (12.7)	76	Blue
54116UB			1/2	1.25 (31.8)	1.41 (35.8)	0.17 (4.3)	0.96 (24.4)	0.50 (12.7)	76	Blue
54185UB			5/8	1.58 (40.1)	1.41 (35.8)	0.17 (4.3)	0.96 (24.4)	0.63 (16.0)	76	Blue
54177UB	500 kcmil	400 Weld 925/24 = 373 kcmil 259/0.0393, 427/0.0306	1/2	1.25 (31.8)	1.61 (40.9)	0.22 (5.6)	1.04 (26.4)	0.50 (12.7)	80	N/A
58118UB			1/2	1.25 (31.8)	1.61 (40.9)	0.22 (5.6)	1.10 (27.9)	0.50 (12.7)	87	Brown
58187UB			5/8	1.58 (40.1)	1.61 (40.9)	0.22 (5.6)	1.10 (27.9)	0.63 (16.0)	87	Brown
58180UB	600 kcmil	1100/24 = 444 kcmil 500 Weld, 259/0.0417 427/0.0325, 703/0.0253	5/8	1.58 (40.1)	1.75 (44.5)	0.24 (6.1)	1.20 (30.5)	0.50 (12.7)	94	Green
58120UB			5/8	1.58 (40.1)	1.75 (44.5)	0.24 (6.1)	1.20 (30.5)	0.50 (12.7)	94	Green
58122UB	700 kcmil	1325/24, 535 kcmil 500 AWG, 550/535	5/8	1.58 (40.1)	1.84 (46.7)	0.23 (5.8)	1.26 (32.0)	0.50 (12.7)	99	Pink
54182UB			5/8	1.58 (40.1)	1.81 (46.0)	0.28 (7.1)	1.25 (31.8)	0.63 (16.0)	99	Pink
54123UB	800 kcmil	1600/24 = 646 kcmil	5/8	1.58 (40.1)	1.94 (49.3)	0.27 (6.9)	1.33 (33.8)	0.63 (16.0)	106	Black
54184UB			5/8	1.58 (40.1)	1.94 (49.3)	0.27 (6.9)	1.33 (33.8)	0.63 (16.0)	106	Black
54124UB	900 kcmil	800 Navy	5/8	1.58 (40.1)	2.01 (51.1)	0.27 (6.9)	1.38 (35.1)	0.63 (16.0)	107	Orange
58126UB			5/8	1.58 (40.1)	2.17 (55.1)	0.31 (7.9)	1.50 (38.1)	0.63 (16.0)	115	Yellow
58128UB	1000 kcmil	1000 Navy	5/8	1.58 (40.1)	2.27 (57.7)	0.30 (7.6)	1.55 (39.4)	0.63 (16.0)	125	N/A

Call your Regional Sales Office for sizes not listed.

Tooling: pp. 112-141 Die Selector Chart: pp. 142-149

‡ For installations from 16 kV up to 35 kV, consult shielded cable manufacturers for stress relief and insulation requirements.