

Two-Bolt Connectors with Spacer

Type 2BW — One-Piece Two-Bolt Connectors with Spacer

- CSA Certified and UL Listed
- For use on copper conductors only
- Castings and bolts of high-strength copper alloy; spacer of ductile, high-conductivity copper alloy
- One-piece construction; contoured spacer is ringed and swings easily over the conductor

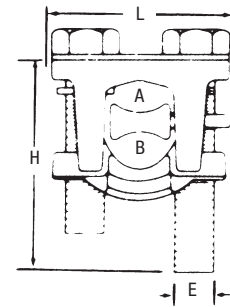

Cat. No.	Conductor Range (AWG or kcmil)				Conductor Diameter				Bolt Head (in.)	Dimensions (in.)		
	Main		Tap		A		B			L	H	E
	max.	min.	max.	min.	max.	min.	max.	min.				
2B10W	1/0 str.	2 str.	1/0 str.	10 sol.	0.373	0.292	0.373	0.102	1/2	1-5/16	1-5/8	5/16
2B20W	2/0 str.	2 str.	2/0 str.	8 sol.	0.419	0.292	0.419	0.128	1/2	1-5/16	1-5/8	5/16
2B40W	4/0 str.	1/0 str.	4/0 str.	6 sol.	0.528	0.368	0.528	0.162	9/16	1-23/32	2-1/8	3/8
2B350W	350 kcmil	4/0 str.	350 kcmil	4 sol.	0.681	0.522	0.681	0.204	3/4	2-1/8	2-1/2	1/2
2B500W	500 kcmil	350 kcmil	500 kcmil	4 sol.	0.813	0.679	0.813	0.204	3/4	2-1/4	2-3/4	1/2
2B800W	800 kcmil	600 kcmil	800 kcmil	2 sol.	1.031	0.891	1.031	0.258	3/4	2-1/2	3-1/4	1/2
2B1000W	1000 kcmil	750 kcmil	1000 kcmil	2 sol.	1.152	0.997	1.152	0.258	15/16	2-31/32	3-3/4	5/8

Type 2BPW — One-Piece Two-Bolt Connectors with Spacer

- CSA Certified and UL Listed
- For use on copper, aluminum and ACSR conductors

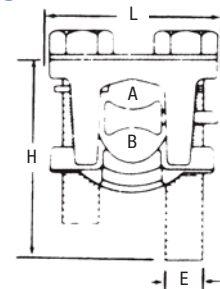

Cat. No.	Conductor Range (AWG or kcmil)				Conductor Diameter				Bolt Head (in.)	Dimensions (in.)		
	Main		Tap		A		B			L	H	E
	max.	min.	max.	min.	max.	min.	max.	min.				
2B10PW	1/0-2	1/0-6	1/0 str.-2 str.	1/0 str.-2 str.	0.398	0.292	0.398	0.102	1/2	1-5/16	1-5/8	5/16
2B20PW	2/0-2	2/0-6	2/0 str.-2 str.	1/0 str.-2 str.	0.447	0.292	0.447	0.128	1/2	1-5/16	1-5/8	5/16
2B40PW	4/0-1/0	4/0-6	4/0 str.-1/0 str.	4/0 str.-1/0 str.	0.563	0.368	0.563	0.162	9/16	1-23/32	2-1/8	3/8
2B350PW	350-4/0	350-4	350-4/0	350-4 sol.	0.680	0.522	0.680	0.204	3/4	2-1/8	2-1/2	1/2
2B500PW	397.5-336.4	397.5-4	500-350	500-4 sol.	0.813	0.679	0.813	0.204	3/4	2-1/4	2-3/4	1/2
2B800PW	666.6-397.5	666.6-2	800-600	800-2 sol.	1.031	0.891	1.031	0.258	3/4	2-1/2	3-1/4	1/2
2B1000PW	900-666.6	900-2	1000-750	1000-2 sol.	1.162	0.997	1.162	0.258	15/16	2-31/32	3-3/4	5/8