

The ultimate in corrosion protection!

OCAL-BLUE Conduit

- Hot-dip galvanized steel or aluminum conduit.
- Nominal .002" (2 mils) blue urethane coating on interior.
- Hot-dipped galvanized threads (steel).
- Minimum .040" (40 mils) PVC coating on exterior.
- Colour-coded thread protectors.
- Couplings shipped with conduit are packaged separately.



File #110787

Cat. No.		Pipe Size In. (mm)	Outside Diameter Steel Only in. (mm)	Outside Diameter With PVC in. (mm)	Nominal Wall Thickness Steel Only in. (mm)	Nominal Wall Thickness With PVC in. (mm)	Nominal Inside Diameter in. (mm)	Cross Section Area in Square in. (mm)	Length Without Couplings ft. (m)	Minimum Weight Per Foot Steel Only lb. (KG)
Steel	Aluminum									
COND1/2-	COND1/2SA-	1/2 (16)	0.84 (21.30)	0.92 (23.30)	0.10 (2.64)	0.14 (3.56)	0.63 (16.10)	0.30 (7.72)	9' 11-1/4" (3.03)	0.79 (35.83)
COND3/4-	COND3/4SA-	3/4 (21)	1.05 (26.70)	1.13 (28.70)	0.11 (2.71)	2.71 (3.73)	0.84 (21.20)	0.53 (13.53)	9' 11-1/4" (3.03)	1.05 (47.63)
COND1-	COND1SA-	1 (27)	1.32 (33.40)	1.40 (35.40)	0.13 (3.20)	0.17 (4.21)	1.06 (27.00)	0.86 (21.94)	9' 11" (3.02)	1.53 (69.40)
COND1-1/4-	COND1-1/4SA-	1-1/4 (35)	1.66 (42.20)	1.74 (44.10)	0.13 (3.37)	0.17 (4.39)	1.39 (35.40)	1.50 (37.97)	9' 11" (3.02)	2.01 (91.17)
COND1-1/2-	COND1-1/2SA-	1-1/2 (41)	1.90 (48.30)	1.98 (50.20)	0.14 (3.50)	0.18 (4.52)	1.62 (41.20)	2.04 (51.71)	9' 11" (3.02)	2.40 (112.95)
COND2-	COND2SA-	2 (53)	2.38 (60.30)	2.46 (62.30)	0.15 (3.70)	0.19 (4.72)	2.08 (52.90)	3.36 (85.21)	9' 11" (3.02)	3.32 (150.60)
COND2-1/2-	COND2-1/2SA-	2-1/2 (63)	2.88 (73.00)	2.96 (75.00)	0.19 (4.90)	0.23 (5.91)	2.49 (63.20)	4.80 (121.61)	9' 10-1/2" (3.01)	5.27 (239.05)
COND3-	COND3SA-	3 (78)	3.50 (88.90)	3.58 (90.90)	0.21 (5.20)	0.25 (6.22)	3.09 (78.50)	7.39 (187.80)	9' 10-1/2" (3.01)	6.83 (309.63)
COND3-1/2-	COND3-1/2SA-	3-1/2 (91)	4.00 (101.60)	4.08 (103.60)	0.22 (5.46)	0.26 (6.47)	3.57 (90.70)	9.87 (250.60)	9' 10-1/4" (3.00)	8.31 (376.94)
COND4-	COND4SA-	4 (103)	4.50 (114.30)	4.58 (116.30)	0.23 (5.71)	0.27 (6.73)	4.05 (102.90)	12.73 (323.34)	9' 10-1/4" (3.00)	9.73 (441.04)
*COND5-	COND5SA-	5 (129)	5.56 (141.30)	5.64 (143.30)	0.25 (6.22)	0.29 (7.23)	5.07 (128.90)	20.01 (508.15)	9' 10" (3.00)	13.14 (595.85)
*COND6-	COND6SA-	6 (155)	6.63 (168.30)	6.71 (170.30)	0.27 (6.75)	0.31 (7.87)	6.09 (154.80)	28.89 (733.83)	9' 10" (3.00)	17.46 (791.67)

Metric size designator (ANSI C80.1-1994).
 *Not CSA certified.

Cat. No.	Size	Material	Colour
COND 3/4 -			—
			— = space for colour identifier
		Blank = Steel	G = Grey
		SA = Aluminum	W = White
			B = Blue
			R = Red

Catalogue No. Example:
 COND3/4-G is 3/4" steel conduit coated in grey PVC.

Custom colours also available - Std. min. quantities are required. Please contact your Regional Sales Office.

Ocal™ Corrosion Protection for Electrical Conduit and Fittings

PVC-Coated Conduit Couplings

Corrosion-protected connections for conduit sections.

OCAL-BLUE Couplings

- Nominal .002" (2 mils) blue urethane coating on interior and threads.
- Minimum .040" (40 mils) PVC coating bonded to exterior.
- Couplings have straight threads (NPS), not tapered.
- Molded ribs on outer coating for easy installation (up to and including 4" trade size).
- Couplings have pressure-sealing sleeves to protect your connection.



File #110787

Cat. No.		Coupling Size in. (mm)	Minimum Length of Metal in. (mm)	Total Minimum Length Including Sleeve in. (mm)	Weight Steel Only lb./kg
Steel	Aluminum				
CPL1/2-	CPL1/2SA-	1/2 (16)	1.50 (38.10)	3.75 (95.25)	0.13 (0.6)
CPL3/4-	CPL3/4SA-	3/4 (21)	1.53 (38.91)	3.75 (95.25)	0.19 (0.85)
CPL1-	CPL1SA-	1 (27)	1.91 (48.41)	4.94 (139.70)	0.33 (0.15)
CPL1-1/4-	CPL1-1/4SA-	1-1/4 (35)	1.91 (48.41)	5.50 (139.70)	0.43 (.19)
CPL1-1/2-	CPL1-1/2SA-	1-1/2 (41)	1.91 (48.41)	5.75 (146.05)	0.56 (.25)
CPL2-	CPL2SA-	2 (53)	1.94 (49.19)	5.94 (150.79)	0.77 (.35)
CPL2-1/2-	CPL2-1/2SA-	2-1/2 (63)	2.88 (73.10)	6.88 (174.70)	1.85 (.83)
CPL3-	CPL3SA-	3 (78)	3.03 (76.98)	7.03 (178.58)	2.70 (1.22)
CPL3-1/2-	CPL3-1/2SA-	3-1/2 (91)	3.09 (78.58)	7.09 (180.18)	3.78 (1.70)
CPL4-	CPL4SA-	4 (103)	3.19 (80.97)	7.19 (182.57)	3.08 (1.39)
*CPL5-	CPL5SA-	5 (129)	3.37 (85.69)	7.37 (187.29)	5.00 (2.25)
*CPL6-	CPL6SA-	6 (155)	3.44 (87.29)	7.44 (188.89)	8.00 (3.60)

Metric size designator (ANSI C80.1-1994).
*Not CSA certified.

Cat. No.	Size	Material	Colour
CPL 3/4	-		
			— = space for colour identifier
		Blank = Steel	G = Grey
		SA = Aluminum	W = White
			B = Blue
			R = Red

Catalogue No. Example:
CPL1SA-B is 1" aluminum coupling coated in blue PVC.

Custom colours also available - Std. min. quantities are required. Please contact your Regional Sales Office.

Ocal™ Corrosion Protection for Electrical Conduit and Fittings

PVC-Coated Conduit Split Couplings and Nipples

Join threaded conduit where you can't use a standard coupling.

OCAL-BLUE Double-Coat Split Couplings

Split couplings serve as speed unions for cost-effective joining of two separate lengths of threaded conduit. Like other Ocal™ fittings, they're double coated in urethane and PVC to safeguard your entire conduit system against corrosion.

- Malleable iron construction.
- Nominal .002" (2 mils) blue urethane on both interior and exterior.
- Minimum .040" (40 mils) PVC bonded to exterior.
- Stainless steel hardware included.



Cat. No.	Colour
TCC1-	—
_ = space for colour identifier	
G =	Grey
W =	White
B =	Blue
R =	Red

Custom colours also available - Std. min. quantities are required. Please contact your Regional Sales Office.

NOTE — The use of standard couplings is recommended whenever possible over the use of split couplings, because standard couplings provide better overall corrosion protection.

Cat. No.	Pipe Size in. (mm)
TCC1-	1/2 (16)
TCC2-	3/4 (21)
TCC3-	1 (27)
TCC4-	1-1/4 (35)
TCC5-	1-1/2 (41)
TCC6-	2 (53)

Cat. No.	Pipe Size in. (mm)
TCC7-	2-1/2 (63)
TCC8-	3 (78)
TCC9-	3-1/2 (91)
TCC10-	4 (103)
*TCC12-	5 (129)
*TCC14-	6 (155)

*Metric size designator (ANSI C80.1-1994).
Not CSA certified.

Speed up your field installations with pre-threaded conduit nipples!

OCAL-BLUE Nipples

- Made from Ocal™ PVC-coated steel or aluminum conduit.
- Blue urethane coating over threads.
- Nominal .002" (2 mils) blue urethane on interior.
- Minimum .040" (40 mils) PVC coating on exterior.
- Colour-coded thread protectors for easy identification of conduit size.
- Available in 11 standard lengths — close and 2" to 12" with custom lengths available on request.
- Close nipples are coated only in urethane.



File #110787

Cat. No.	Size X Length	Material	Colour
NPL3/4X6-			—
		Blank = Steel	_ = space for colour identifier
		SA = Aluminum	G = Grey
			W = White
			B = Blue
			R = Red

Catalogue No. Example:
NPL3/4X6-G is 3/4" x 6" long steel nipple coated in grey PVC.

Custom colours also available - Std. min. quantities are required. Please contact your Regional Sales Office.

Ocal™ Corrosion Protection for Electrical Conduit and Fittings

PVC-Coated Conduit Nipples

OCAL-BLUE NIPPLES (continued)



File #110787

PVC-Coated Conduit Nipples — Steel

Pipe Size in. (mm)	Nipple Length										
	Close	2 (50.8)	2-1/2 (63.5)	3 (76.2)	3-1/2 (88.9)	4 (101.6)	5 (127.0)	6 (152.4)	8 (203.2)	10 (254.0)	12 (304.8)
1/2 (6)	CLNPL1/2-	NPL1/2X2-	NPL1/2X21/2-	NPL1/2X3-	NPL1/2X31/2-	NPL1/2X4-	NPL1/2X5-	NPL1/2X6-	NPL1/2X8-	NPL1/2X10-	NPL1/2X12-
3/4 (21)	CLNPL3/4-	NPL3/4X2-	NPL3/4X21/2-	NPL3/4X3-	NPL3/4X31/2-	NPL3/4X4-	NPL3/4X5-	NPL3/4X6-	NPL3/4X8-	NPL3/4X10-	NPL3/4X12-
1 (27)	CLNPL1-	NPL1X2-	NPL1X21/2-	NPL1X3-	NPL1X31/2-	NPL1X4-	NPL1X5-	NPL1X6-	NPL1X8-	NPL1X10-	NPL1X12-
1-1/4 (35)	CLNPL11/4-	NPL11/4X2-	NPL11/4X21/2-	NPL11/4X3-	NPL11/4X31/2-	NPL11/4X4-	NPL11/4X5-	NPL11/4X6-	NPL11/4X8-	NPL11/4X10-	NPL11/4X12-
1-1/2 (41)	CLNPL11/2-	NPL11/2X2-	NPL11/2X21/2-	NPL11/2X3-	NPL11/2X31/2-	NPL11/2X4-	NPL11/2X5-	NPL11/2X6-	NPL11/2X8-	NPL11/2X10-	NPL11/2X12-
2 (53)	CLNPL2-	—	NPL2X21/2-	NPL2X3-	NPL2X31/2-	NPL2X4-	NPL2X5-	NPL2X6-	NPL2X8-	NPL2X10-	NPL2X12-
2-1/2 (63)	CLNPL21/2-	—	—	—	NPL21/2X31/2-	NPL21/2X4-	NPL21/2X5-	NPL21/2X6-	NPL21/2X8-	NPL21/2X10-	NPL21/2X12-
3 (78)	CLNPL3-	—	—	—	NPL3X31/2-	NPL3X4-	NPL3X5-	NPL3X6-	NPL3X8-	NPL3X10-	NPL3X12-
3-1/2 (91)	CLNPL31/2-	—	—	—	—	NPL31/2X4-	NPL31/2X5-	NPL31/2X6-	NPL31/2X8-	NPL31/2X10-	NPL31/2X12-
4 (103)	CLNPL4-	—	—	—	—	NPL4X4-	NPL4X5-	NPL4X6-	NPL4X8-	NPL4X10-	NPL4X12-
*5 (129)	CLNPL5-	—	—	—	—	—	NPL5X5-	NPL5X6-	NPL5X8-	NPL5X10-	NPL5X12-
*6 (155)	CLNPL6-	—	—	—	—	—	NPL6X5-	NPL6X6-	NPL6X8-	NPL6X10-	NPL6X12-

PVC-Coated Conduit Nipples — Aluminum

Pipe Size in. (mm)	Nipple Length										
	Close	2 (50.8)	2-1/2 (63.5)	3 (76.2)	3-1/2 (88.9)	4 (101.6)	5 (127.0)	6 (152.4)	8 (203.2)	10 (254.0)	12 (304.8)
1/2 (6)	CLNPL1/2SA-	NPL1/2X2SA-	NPL1/2X21/2SA-	NPL1/2X3SA-	NPL1/2X31/2SA-	NPL1/2X4SA-	NPL1/2X5SA-	NPL1/2X6SA-	NPL1/2X8SA-	NPL1/2X10SA-	NPL1/2X12SA-
3/4 (21)	CLNPL3/4SA-	NPL3/4X2SA-	NPL3/4X21/2SA-	NPL3/4X3SA-	NPL3/4X31/2SA-	NPL3/4X4SA-	NPL3/4X5SA-	NPL3/4X6SA-	NPL3/4X8SA-	NPL3/4X10SA-	NPL3/4X12SA-
1 (27)	CLNPL1SA-	NPL1X2SA-	NPL1X21/2SA-	NPL1X3SA-	NPL1X31/2SA-	NPL1X4SA-	NPL1X5SA-	NPL1X6SA-	NPL1X8SA-	NPL1X10SA-	NPL1X12SA-
1-1/4 (35)	CLNPL11/4SA-	NPL11/4X2SA-	NPL11/4X21/2SA-	NPL11/4X3SA-	NPL11/4X31/2SA-	NPL11/4X4SA-	NPL11/4X5SA-	NPL11/4X6SA-	NPL11/4X8SA-	NPL11/4X10SA-	NPL11/4X12SA-
1-1/2 (41)	CLNPL11/2SA-	NPL11/2X2SA-	NPL11/2X21/2SA-	NPL11/2X3SA-	NPL11/2X31/2SA-	NPL11/2X4SA-	NPL11/2X5SA-	NPL11/2X6SA-	NPL11/2X8SA-	NPL11/2X10SA-	NPL11/2X12SA-
2 (53)	CLNPL2SA-	—	NPL2X21/2SA-	NPL2X3SA-	NPL2X31/2SA-	NPL2X4SA-	NPL2X5SA-	NPL2X6SA-	NPL2X8SA-	NPL2X10SA-	NPL2X12SA-
2-1/2 (63)	CLNPL21/2SA-	—	—	—	NPL21/2X31/2SA-	NPL21/2X4SA-	NPL21/2X5SA-	NPL21/2X6SA-	NPL21/2X8SA-	NPL21/2X10SA-	NPL21/2X12SA-
3 (78)	CLNPL3SA-	—	—	—	NPL3X31/2SA-	NPL21/2X4SA-	NPL3X5SA-	NPL3X6SA-	NPL3X8SA-	NPL3X10SA-	NPL3X12SA-
3-1/2 (91)	CLNPL31/2SA-	—	—	—	—	NPL31/2X4SA-	NPL31/2X5SA-	NPL31/2X6SA-	NPL31/2X8SA-	NPL31/2X10SA-	NPL31/2X12SA-
4 (103)	CLNPL4SA-	—	—	—	—	NPL4X4SA-	NPL4X5SA-	NPL4X6SA-	NPL4X8SA-	NPL4X10SA-	NPL4X12SA-
*5 (129)	CLNPL5SA-	—	—	—	—	—	NPL5X5SA-	NPL5X6SA-	NPL5X8SA-	NPL5X10SA-	NPL5X12SA-
*6 (155)	CLNPL6SA-	—	—	—	—	—	NPL6X5SA-	NPL6X6SA-	NPL6X8SA-	NPL6X10SA-	NPL6X12SA-

Metric size designator (ANSI C80.1-1994).
*Not CSA certified.

Ocal™ Corrosion Protection for Electrical Conduit and Fittings

Factory bent to save time and materials!

OCAL-BLUE Standard-Radius Elbows

- Fabricated from Ocal™ PVC-coated conduit.
- Standard radius in 30°, 45°, 60° and 90° available for immediate shipment.
- Colour-coded thread protectors for easy identification of conduit size.
- Special radius and degrees not listed are also available upon request.



File #110787

Cat. No.		Pipe Size	Radius "R"	Offset "C"	Straight End "D"	Unbent Length	Weight Each Steel Only
Steel	Aluminum	in. (mm)	in. (mm)	in. (mm)	in. (mm)	in. (mm)	lb. (kg)
ELL1/2-_-	ELL1/2-_-SA-_-	1/2 (16)	4.00 (101.60)	6.00 (152.40)	2.00 (50.80)	10.28 (261.19)	0.67 (16.95)
ELL3/4-_-	ELL3/4-_-SA-_-	3/4 (21)	4.50 (114.30)	6.50 (165.10)	2.00 (50.80)	11.07 (281.14)	0.95 (24.07)
ELL1-_-	ELL1-_-SA-_-	1 (27)	5.75 (146.05)	8.00 (203.20)	2.25 (57.15)	13.53 (343.71)	1.77 (44.97)
ELL1-1/4-_-	ELL1-1/4-_-SA-_-	1-1/4 (35)	7.25 (184.15)	9.50 (241.30)	2.25 (57.15)	15.89 (403.56)	2.55 (64.80)
ELL1-1/2-_-	ELL1-1/2-_-SA-_-	1-1/2 (41)	8.25 (209.55)	11.00 (279.40)	2.75 (69.85)	18.46 (468.86)	3.98 (101.13)
ELL2-_-	ELL2-_-SA-_-	2 (53)	9.50 (241.30)	13.00 (330.20)	3.50 (88.90)	21.92 (556.83)	6.33 (160.86)
ELL2-1/2-_-	ELL2-1/2-_-SA-_-	2-1/2 (63)	10.50 (266.70)	14.00 (355.60)	3.50 (88.90)	23.49 (596.73)	9.65 (245.09)
ELL3-_-	ELL3-_-SA-_-	3 (78)	13.00 (330.20)	16.50 (419.10)	3.50 (88.90)	27.42 (696.48)	15.42 (391.77)
ELL3-1/2-_-	ELL3-1/2-_-SA-_-	3-1/2 (91)	15.00 (381.00)	20.75 (527.05)	5.75 (146.05)	35.06 (890.57)	23.30 (591.84)
ELL4-_-	ELL4-_-SA-_-	4 (103)	16.00 (406.40)	21.75 (552.45)	5.75 (146.05)	36.63 (930.47)	29.68 (753.80)
*ELL5-_-	ELL5-_-SA-_-	5 (129)	24.00 (609.60)	31.00 (787.40)	7.00 (177.80)	51.70 (1313.16)	60.82 (1544.89)
*ELL6-_-	ELL6-_-SA-_-	6 (155)	30.00 (762.00)	39.00 (990.60)	9.00 (228.60)	65.12 (1654.15)	85.69 (2176.51)

Metric size designator (ANSI C80.1-1994).
*Not CSA certified.

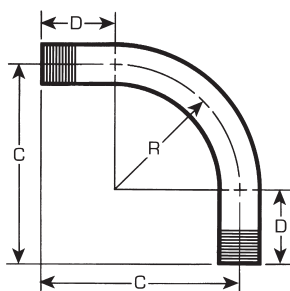

Cat. No.	Pipe Size	Angle	Material	Colour
ELL 3/4-	-	-	-	-
		30 = 30°	Blank = Steel	G = Grey
		45 = 45°	SA = Aluminum	W = White
		60 = 60°		B = Blue
		Blank = 90°		R = Red

Catalogue No. Example:
ELL3/ASA-W is a 3/4" trade size 90° aluminum elbow coated in white PVC.

Custom colours also available - Std. min. quantities are required. Please contact your Regional Sales Office.

Ocal™ Corrosion Protection for Electrical Conduit and Fittings

PVC-Coated Conduit Elbows

Choose the size and angle to meet your exact requirements.

OCAL-BLUE Large-Radius Elbows

- Fabricated from Ocal™ PVC-coated conduit.
- Standard radius in 90° available for immediate shipment.
- Special radius and degrees not listed are also available upon request.
- Colour-coded thread protectors for easy identification of conduit size.



File #110787

Cat. No.		Pipe Size in. (mm)	Radius "R"	Offset "C"	Straight End "D"	Unbent Length
Steel	Aluminum		in. (mm)	in. (mm)	in. (mm)	in. (mm)
LRELL_X12-_-	LRELL_X12-_-SA-_-	1 - 2-1/2 (27 - 63)	12.00 (304.80)	1' 9" (533.40)	9.00 (228.60)	3' 0" (914.40)
LRELL_X15-_-	LRELL_X15-_-SA-_-	1 - 3 (27 - 78)	15.00 (381.00)	2' 0" (609.60)	9.00 (228.60)	3' 6" (1066.80)
LRELL_X18-_-	LRELL_X18-_-SA-_-	1 - 4 (27 - 103)	18.00 (457.20)	2' 4" (711.20)	10.00 (254.00)	4' 0" (1219.20)
LRELL_X24-_-	LRELL_X24-_-SA-_-	1 - 4 (27 - 103)	24.00 (609.60)	2' 11" (889.00)	11.00 (279.40)	4' 11" (1498.60)
LRELL_X30-_-	LRELL_X30-_-SA-_-	1 - 6 (27 - 155)	30.00 (762.00)	3' 5" (1041.40)	11.00 (279.40)	5' 9" (1752.60)
LRELL_X36-_-	LRELL_X36-_-SA-_-	1 - 6 (27 - 155)	36.00 (914.40)	3' 11" (1193.80)	11.00 (279.40)	6' 6" (1981.20)
LRELL_X42-_-	LRELL_X42-_-SA-_-	1 - 6 (27 - 155)	42.00 (1066.80)	4' 6" (1371.60)	12.00 (304.80)	7' 6" (2286.00)
LRELL_X48-_-	LRELL_X48-_-SA-_-	1 - 6 (27 - 155)	48.00 (1219.20)	5' 0" (1524.00)	12.00 (304.80)	8' 6" (2590.80)
LRELL_X60-_-	LRELL_X60-_-SA-_-	2-1/2 - 6 (63 - 155)	60.00 (1524.00)	6' 0" (1828.80)	12.00 (304.80)	9' 10" (2997.20)

Metric size designator (ANSI C80.1-1994).
#5 and 6 inch not CSA certified.

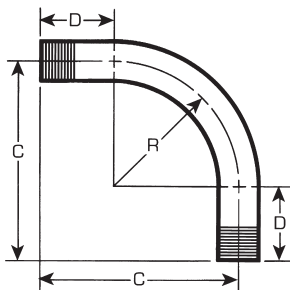

Cat. No.	Pipe Size	Radius	Angle	Material	Colour
LRELL_X12-_-					
	1 = 1"	30 = 30°		Blank = Steel	G = Grey
	2 = 2"	45 = 45°		SA = Aluminum	W = White
	etc.	60 = 60°			B = Blue
		Blank = 90°			R = Red

Catalogue No. Example:
LRELL3X18-45-G is a 3" trade size steel elbow with a radius of 18" and an angle of 45°, coated in grey PVC.

Custom colours also available - Std. min. quantities are required. Please contact your Regional Sales Office.

Ocal™ Corrosion Protection for Electrical Conduit and Fittings

PVC coating evenly molded around saddle prevents exposure of metal – an Ocal™ exclusive!

Ocal PVC-Coated Beam Clamps and U-Bolts

- Beam clamps support and attach conduit runs to structural beams.
- Molded right-angle beam clamps and U-bolts provide extra protection.
- Nuts are encapsulated, (RA) providing complete protection.
- Hex-shaped nuts fit standard wrenches.
- Stainless steel hardware included.
- Parallel (PAR) and edge (EC) clamps feature nominal .015” (15 mils) PVC coating for corrosion protection.
- Right-Angle clamps (RA) and U-Bolts (UB) feature nominal .040” (40 mils) PVC coating for corrosion protection.
- The coating is evenly molded around the saddle which only Ocal™ provides to prevent exposure to metal.

Cat. No.	Colour
RA 1 -	—
— = space for colour identifier	
G =	Grey
W =	White
B =	Blue
<i>Custom colours also available - Std. min. quantities are required. Please contact your Regional Sales Office.</i>	



Edge (EC)



Parallel (PAR)



Right Angle (RA)



U-Bolt (UB)

Cat. No.	Size	Colour
UB 1 -		—
— = space for colour identifier		
G =	Grey	
W =	White	
B =	Blue	
<i>Custom colours also available - Std. min. quantities are required. Please contact your Regional Sales Office.</i>		

PVC-Coated Beam Clamps

Cat. No.			Pipe Size	
Right Angle	Parallel	Edge	in.	(mm)
RA1/2- _—	PAR1/2- _—	EC1/2- _—	1/2	(16)
RA3/4- _—	PAR3/4- _—	EC3/4- _—	3/4	(21)
RA1- _—	PAR1- _—	EC1- _—	1	(27)
RA1-1/4- _—	PAR1-1/4- _—	EC1-1/4- _—	1-1/4	(35)
RA1-1/2- _—	PAR1-1/2- _—	EC1-1/2- _—	1-1/2	(41)
RA2- _—	PAR2- _—	EC2- _—	2	(53)
RA2-1/2- _—	PAR2-1/2- _—	—	2-1/2	(63)
RA3- _—	PAR3- _—	—	3	(78)
RA3-1/2- _—	PAR3-1/2- _—	—	3-1/2	(91)
RA4- _—	PAR4- _—	—	4	(103)

U-Bolts

Cat. No.	Pipe Size		“A” Dimension	
	in.	(mm)	in.	(mm)
UB1/2- _—	1/2	(16)	1.38	(34.93)
UB3/4- _—	3/4	(21)	1.56	(39.69)
UB1- _—	1	(27)	1.84	(46.83)
UB1-1/4- _—	1-1/4	(35)	2.19	(55.56)
UB1-1/2- _—	1-1/2	(41)	2.50	(63.50)
UB2- _—	2	(53)	2.97	(75.41)
UB2-1/2- _—	2-1/2	(63)	3.47	(88.11)
UB3- _—	3	(78)	4.09	(103.98)
UB3-1/2- _—	3-1/2	(91)	4.59	(116.68)
UB4- _—	4	(103)	5.09	(129.38)
UB5- _—	5	(129)	6.63	(168.28)
UB6- _—	6	(155)	8.00	(203.20)

Metric size designator (ANSI C80.1-1994).

Oocal™ Corrosion Protection for Electrical Conduit and Fittings

Conduit Clamps and Straps

Support conduit on walls and structures.

Pipe Straps

- Available in malleable iron/stamped steel with nominal .015" (15 mils) PVC coating in your choice of blue, white or grey.
- Choose one- or two-hole versions.
- Sized to allow for the extra thickness of the PVC coating.



PVC-Coated Pipe Straps

Cat. No.		Pipe Size in. (mm)
One-Hole Malleable Iron	Two-Hole Stamped Steel	
1HMS1/2- __	2HS1/2- __	1/2 (16)
1HMS3/4- __	2HS3/4- __	3/4 (21)
1HMS1- __	2HS1- __	1 (27)
1HMS1-1/4- __	2HS1-1/4- __	1-1/4 (35)
1HMS1-1/2- __	2HS1-1/2- __	1-1/2 (41)
1HMS2- __	2HS2- __	2 (53)
1HMS2-1/2- __	2HS2-1/2- __	2-1/2 (63)
1HMS3- __	2HS3- __	3 (78)
1HMS3-1/2- __	2HS3-1/2- __	3-1/2 (91)
1HMS4- __	2HS4- __	4 (103)

Metric size designator (ANSI C80.1-1994).

Cat. No.	Pipe Size in. (mm)
CB1/2- __	1/2 (16)
CB3/4- __	3/4 (21)
CB1- __	1 (27)
CB1-1/4- __	1-1/4 (35)
CB1-1/2- __	1-1/2 (41)
CB2- __	2 (53)
CB2-1/2- __	2-1/2 (63)
CB3- __	3 (78)
CB3-1/2- __	3-1/2 (91)
CB4- __	4 (103)

Metric size designator (ANSI C80.1-1994).

Use as spacers with one-hole pipe straps.

Ocal PVC-Coated Clamp-Back Spacers

- Provides space for air flow between conduit and mounting surface.
- Nominal .015" (15 mils) PVC coating for corrosion protection.



Cat. No.	Colour
CB1-	—
— = space for colour identifier	
G =	Grey
W =	White
B =	Blue
R =	Red

Custom colours also available - Std. min. quantities are required. Please contact your Regional Sales Office.