

Sta-Kon[®]

METRIC CONNECTORS

Thomas & Betts

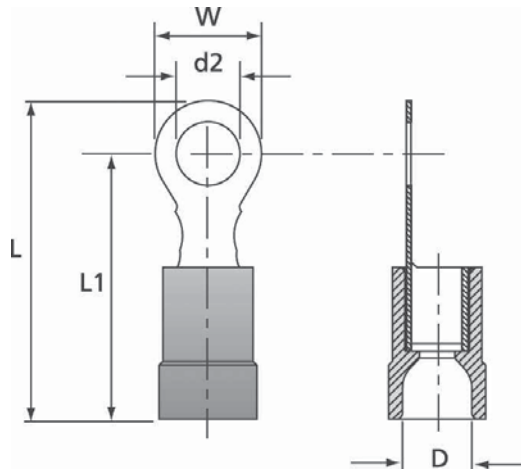
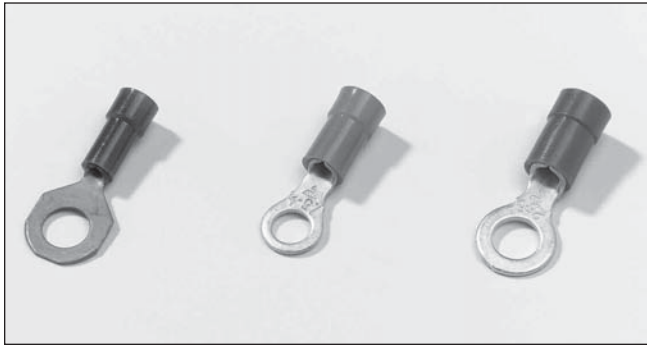

Technical Information

Material	Electrolytic copper
Plating	Tin plated
Marking	Wire size and bolt size stamped on the tongue
Metal barrel	Brazed seam to prevent barrel separation
Insulation	PC = Polycarbonate
Temperature resistance	+115°C / +125°C
Colour coding of the insulation	According to the wire size
Cable insertion	Easy entry

Ordering Information

Cat. No.	Wire Size Range (mm ²)	Colour	Stud Hole Size d2	Dimensions				Wt. (g/100)	Qty. (pieces)	Crimping Tool
				W (mm)	L (mm)	D (mm)	L1 (mm)			
RZ3	0.25 - 0.75	Green	M3	5.5	18.0	3.2	15.0	36	100	ERG2510
RZ4	0.25 - 0.75	Green	M4	7.5	21.0	3.2	17.5	45	100	
RZ5	0.25 - 0.75	Green	M5	9.0	22.0	3.2	17.5	51	100	
RA3RR	0.5 - 1.5	Red	M3	5.5	19.0	4.0	16.0	60	100	ERG2001A WT2124Y
RA4RR	0.5 - 1.5	Red	M4	7.0	20.5	4.0	17.0	71	100	
RA5RR	0.5 - 1.5	Red	M5	9.0	22.5	4.0	18.0	79	100	
RA6RR	0.5 - 1.5	Red	M6	11.0	26.5	4.0	21.0	96	100	
RB3	1.5 - 2.5	Blue	M3	5.5	19.0	4.5	16.0	75	100	
RB4-EU	1.5 - 2.5	Blue	M4	7.0	20.5	4.5	17.0	92	100	
RB5	1.5 - 2.5	Blue	M5	9.0	22.5	4.5	18.0	96	100	ERG2001A WT2124Y
RB6	1.5 - 2.5	Blue	M6	11.0	26.5	4.5	21.0	117	100	
RB8	1.5 - 2.5	Blue	M8	14.0	27.5	4.5	21.0	141	100	
RC4	4.0 - 6.0	Yellow	M4	8.0	24.0	6.4	20.5	158	100	
RC5	4.0 - 6.0	Yellow	M5	9.0	25.0	6.4	20.5	166	100	
RC6-EU	4.0 - 6.0	Yellow	M6	11.0	28.5	6.4	23.0	179	100	
RC8	4.0 - 6.0	Yellow	M8	14.0	31.0	6.4	24.0	220	100	
RC10E	4.0 - 6.0	Yellow	M10	17.0	34.0	6.4	25.5	245	100	

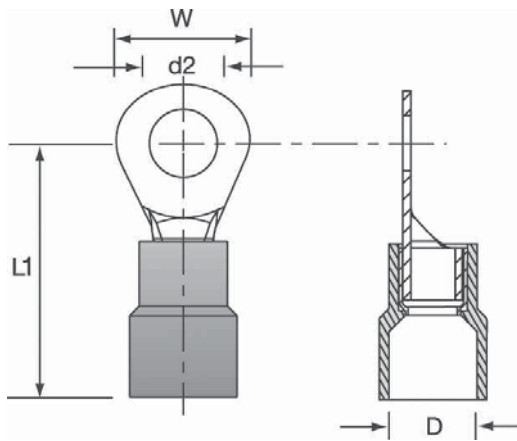
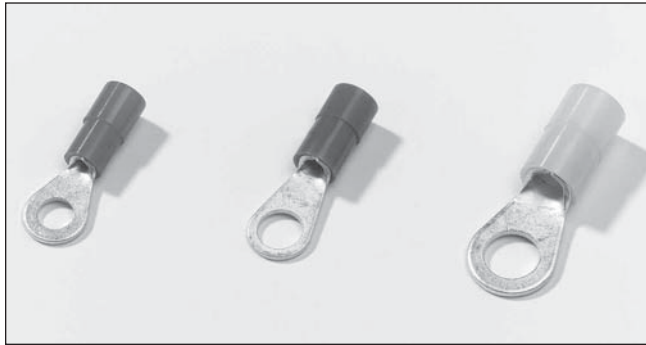

Technical Information

Material	Copper
Plating	Tin plated
Marking	Wire size and bolt size stamped on the tongue
Metal barrel	Brazed seam to prevent barrel separation
Insulation	PA = Polyamide Ideal for harsh environments, provides excellent chemical, impact and abrasion resistance
Temperature resistance	+85°C / +105°C
Colour coding of the insulation	According to the wire size

Ordering Information

Cat. No.	Wire Size Range (mm ²)	Colour	Stud Hole Size d2	Dimensions			Wt. (g/100)	Qty. (pieces)	Crimping Tool
				W (mm)	L1 (mm)	D (mm)			
TRA3	0.5 - 1.5	Red	M3	5.5	17.5	4.0	70	100	
TRA35	0.5 - 1.5	Red	M3.5	6.6	20.4	4.0	67	100	
TRA4	0.5 - 1.5	Red	M4	8.0	21.8	4.0	76	100	
TRA5	0.5 - 1.5	Red	M5	8.0	21.8	4.0	79	100	
TRA6	0.5 - 1.5	Red	M6	11.6	27.5	4.0	108	100	
TRA8	0.5 - 1.5	Red	M8	11.6	27.5	4.0	134	100	
TRB3	1.5 - 2.5	Blue	M3	6.0	20.6	4.5	79	100	
TRB35	1.5 - 2.5	Blue	M3.5	8.5	23.0	4.5	76	100	
TRB4	1.5 - 2.5	Blue	M4	8.5	23.0	4.5	79	100	
TRB5	1.5 - 2.5	Blue	M5	9.5	22.9	4.5	89	100	
TRB6	1.5 - 2.5	Blue	M6	12.0	28.0	4.5	117	100	
TRB8	1.5 - 2.5	Blue	M8	12.0	28.0	4.5	148	100	
TRB10	1.5 - 2.5	Blue	M10	13.6	31.7	4.5	204	100	
TRC4-EU	4.0 - 6.0	Yellow	M4	7.4	26.7	6.4	158	100	
TRC5-EU	4.0 - 6.0	Yellow	M5	9.5	26.7	6.4	175	100	
TRC6-EU	4.0 - 6.0	Yellow	M6	12.0	32.7	6.4	187	100	
TRC8	4.0 - 6.0	Yellow	M8	15.0	34.9	6.4	230	100	
TRC10	4.0 - 6.0	Yellow	M10	15.0	34.9	6.4	296	100	

ERG2001A
WT2124Y

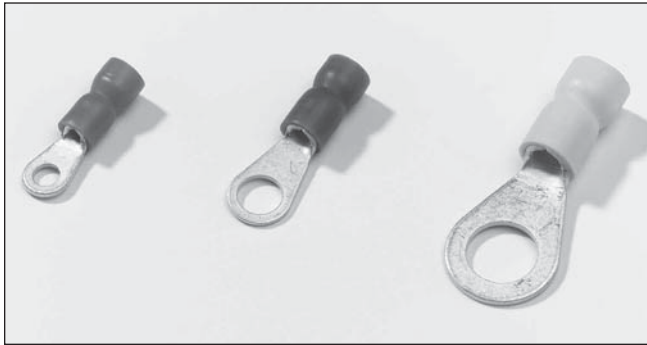

Technical Information

Material	Copper
Plating	Tin plated
Marking	Wire size and bolt size stamped on the tongue
Metal barrel	Brazed seam to prevent barrel separation
Insulation	PVC = Polyvinylchloride (Vinyl). Ideal for harsh environments, provides excellent chemical, impact and abrasion resistance
	+75°C 600 Volts max
	According to the wire size

Max. electrical rating
Colour coding of the insulation

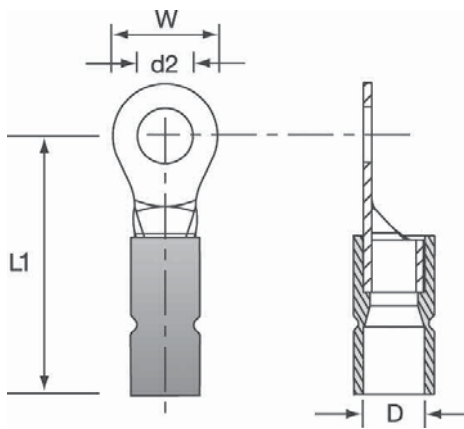

Ordering Information

Cat. No.	Wire Size Range (mm ²)	Colour	Stud Hole Size d2	Dimensions			Wt. (g/100)	Qty. (pieces)	Crimping Tool
				W (mm)	L1 (mm)	D (mm)			
VB-3RR	0.5 - 1.5	Red	M3	6.0	17.2	4.0	68	100	ERG2001A WT2124Y
VB-35RR	0.5 - 1.5	Red	M3.5	6.0	17.2	4.0	69	100	
VB-4RR	0.5 - 1.5	Red	M4	8.0	18.2	4.0	73	100	
VB-5RR	0.5 - 1.5	Red	M5	10.0	19.2	4.0	92	100	
VB-6RR	0.5 - 1.5	Red	M6	10.0	19.2	4.0	87	100	
VB-8RR	0.5 - 1.5	Red	M8	14.0	23.2	4.0	139	100	
VB-10RR	0.5 - 1.5	Red	M10	14.0	23.2	4.0	100	100	
VB-3BR	1.5 - 2.5	Blue	M3	6.0	17.5	4.5	80	100	
VB-35BR	1.5 - 2.5	Blue	M3.5	6.0	17.5	4.5	94	100	
VB-4BR	1.5 - 2.5	Blue	M4	8.0	18.5	4.5	83	100	
VB-5BR	1.5 - 2.5	Blue	M5	10.0	20.5	4.5	110	100	
VB-6BR	1.5 - 2.5	Blue	M6	11.0	22.5	4.5	122	100	
VB-8BR	1.5 - 2.5	Blue	M8	14.0	23.5	4.5	146	100	
VB-10BR	1.5 - 2.5	Blue	M10	15.0	23.5	4.5	204	100	
VB-4YR	4.0 - 6.0	Yellow	M4	8.0	22.1	6.3	167	100	
VB-5YR	4.0 - 6.0	Yellow	M5	10.0	23.1	6.3	196	100	
VB-6YR	4.0 - 6.0	Yellow	M6	11.0	24.1	6.3	195	100	
VB-8YR	4.0 - 6.0	Yellow	M8	14.0	27.1	6.3	250	100	
VB-10YR	4.0 - 6.0	Yellow	M10	18.0	29.1	6.3	305	100	

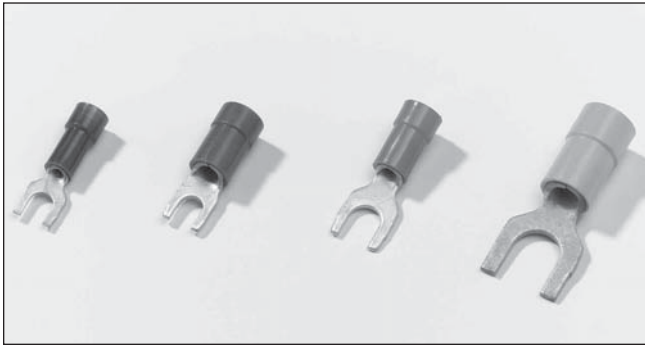

Technical Information

Material	Electrolytic copper
Plating	Tin plated
Marking	Wire size and bolt size stamped on the tongue
Metal barrel	Brazed seam to prevent barrel separation
Insulation	PC = Polycarbonate
Temperature resistance	+115°C / +125°C
Colour coding of the insulation	According to the wire size
Cable insertion	Easy entry

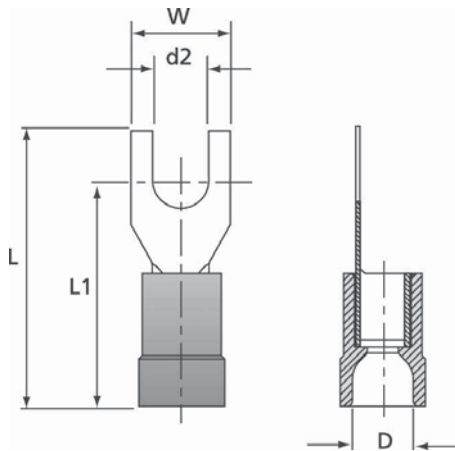

Ordering Information

Cat. No.	Wire Size Range (mm ²)	Colour	Stud Hole Size d2	Dimensions				Wt. (g/100)	Qty. (pieces)	Crimping Tool
				W (mm)	L (mm)	D (mm)	L1 (mm)			
RZ3F	0.25 - 0.75	Green	M3	5.5	18.0	3.2	15.0	41	100	ERG2510
RZ4F	0.25 - 0.75	Green	M4	7.5	21.0	3.2	17.5	41	100	
RA35F	0.5 - 1.5	Red	M3.5	5.5	21.0	4.0	17.5	62	100	
RA4F	0.5 - 1.5	Red	M4	7.0	20.5	4.0	17.0	64	100	
RA5F	0.5 - 1.5	Red	M5	9.0	22.5	4.0	18.0	75	100	
RA6F	0.5 - 1.5	Red	M6	11.0	26.5	4.0	21.0	90	100	
RB3F	1.5 - 2.5	Blue	M3	5.5	19.0	4.5	16.0	72	100	ERG2001A WT2124Y
RB4F	1.5 - 2.5	Blue	M4	7.0	20.5	4.5	17.0	84	100	
RB5F	1.5 - 2.5	Blue	M5	9.0	22.5	4.5	18.0	96	100	
RB6F	1.5 - 2.5	Blue	M6	11.0	26.5	4.5	21.0	113	100	
RC4F	4.0 - 6.0	Yellow	M4	8.0	24.0	6.4	20.5	159	100	
RC5F	4.0 - 6.0	Yellow	M5	9.0	25.0	6.4	20.5	161	100	
RC6F	4.0 - 6.0	Yellow	M6	11.0	28.5	6.4	23.0	174	100	
RC8F	4.0 - 6.0	Yellow	M8	14.0	31.0	6.4	24.0	207	100	
RC10F	4.0 - 6.0	Yellow	M10	18.0	36.0	6.4	27.0	280	100	

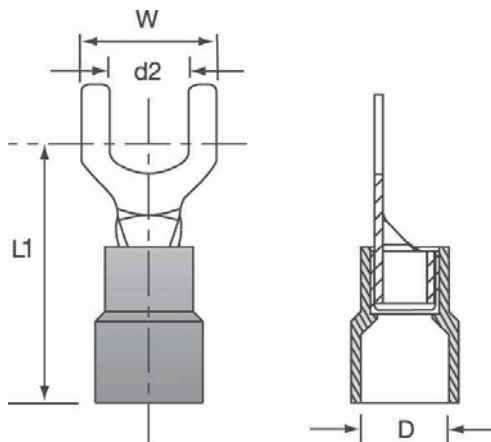
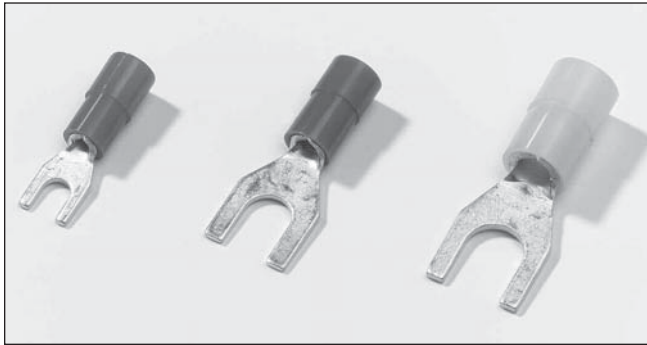

Technical Information

Material	Copper
Plating	Tin plated
Marking	Wire size and bolt size stamped on the tongue
Metal barrel	Brazed seam to prevent barrel separation
Insulation	PA = Polyamide Ideal for harsh environments, provides excellent chemical, impact and abrasion resistance
Temperature resistance	+85°C / +105°C
Colour coding of the insulation	According to the wire size
Cable insertion	Easy entry

Ordering Information

Cat. No.	Wire Size Range (mm ²)	Colour	Stud Hole Size d2	Dimensions			Wt. (g/100)	Qty. (pieces)	Crimping Tool
				W (mm)	L1 (mm)	D (mm)			
TRA3F	0.5 - 1.5	Red	M3	5.7	22.0	4.0	65	100	ERG2001A WT2124Y
TRA35F	0.5 - 1.5	Red	M3.5	6.2	22.0	4.0	62	100	
TRA4F	0.5 - 1.5	Red	M4	7.2	22.0	4.0	70	100	
TRA5F	0.5 - 1.5	Red	M5	8.0	22.0	4.0	92	100	
TRA6F	0.5 - 1.5	Red	M6	10.8	23.0	4.0	102	100	
TRB3F	1.5 - 2.5	Blue	M3	5.7	22.2	4.5	81	100	
TRB35F	1.5 - 2.5	Blue	M3.5	6.2	22.2	4.5	74	100	
TRB4F	1.5 - 2.5	Blue	M4	7.2	22.2	4.5	80	100	
TRB5F	1.5 - 2.5	Blue	M5	8.0	22.2	4.5	110	100	
TRB6F	1.5 - 2.5	Blue	M6	10.8	23.5	4.5	122	100	
TRC4F	4.0 - 6.0	Yellow	M4	8.2	26.7	6.4	163	100	
TRC5F	4.0 - 6.0	Yellow	M5	9.0	26.7	6.4	182	100	
TRC6F	4.0 - 6.0	Yellow	M6	12.0	30.3	6.4	190	100	

Sta-Kon®

Vinyl Insulated Fork Terminals DIN 46237

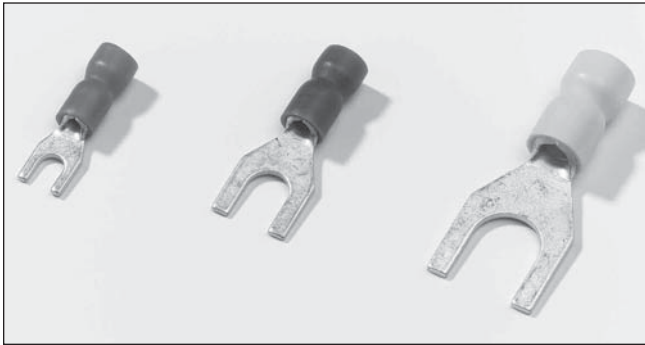

Technical Information

Material	Copper
Plating	Tin plated
Marking	Wire size and bolt size stamped on the tongue
Metal barrel	Brazed seam to prevent barrel separation
Insulation	PVC = Polyvinylchloride (Vinyl)
Max. electrical rating	+75°C 600 Volts
Colour coding of the insulation	According to the wire size
Cable insertion	Easy entry

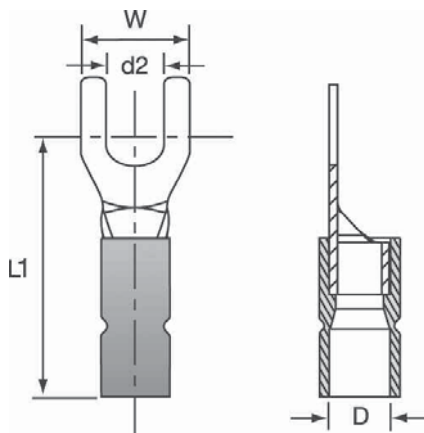

Ordering Information

Cat. No.	Wire Size Range (mm ²)	Colour	Stud Hole Size d2	Dimensions			Wt. (g/100)	Qty. (pieces)	Crimping Tool
				W (mm)	L1 (mm)	D (mm)			
VB-3RF	0.5 - 1.5	Red	M3	6.0	17.2	4.0	68	100	ERG2001A WT2124Y
VB-35RF	0.5 - 1.5	Red	M3.5	6.0	17.2	4.0	68	100	
VB-4RF	0.5 - 1.5	Red	M4	6.8	18.2	4.0	73	100	
VB-5RF	0.5 - 1.5	Red	M5	10.0	19.2	4.0	92	100	
VB-6RF	0.5 - 1.5	Red	M6	11.0	21.2	4.0	103	100	
VB-3BF	1.5 - 2.5	Blue	M3	5.5	19.5	4.5	90	100	
VB-35BF	1.5 - 2.5	Blue	M3.5	6.0	17.5	4.5	97	100	
VB-4BF	1.5 - 2.5	Blue	M4	6.8	19.2	4.5	83	100	
VB-5BF	1.5 - 2.5	Blue	M5	10.0	20.5	4.5	110	100	
VB-6BF	1.5 - 2.5	Blue	M6	11.0	22.5	4.5	121	100	
VB-4YF	2.5 - 6.0	Yellow	M4	8.0	22.1	6.3	169	100	
VB-5YF	2.5 - 6.0	Yellow	M5	10.0	23.1	6.3	189	100	
VB-6YF	2.5 - 6.0	Yellow	M6	11.0	24.1	6.3	200	100	
VB-8YF	2.5 - 6.0	Yellow	M8	14.0	27.1	6.3	235	100	
VB-10YF	2.5 - 6.0	Yellow	M10	18.0	29.1	6.3	305	100	

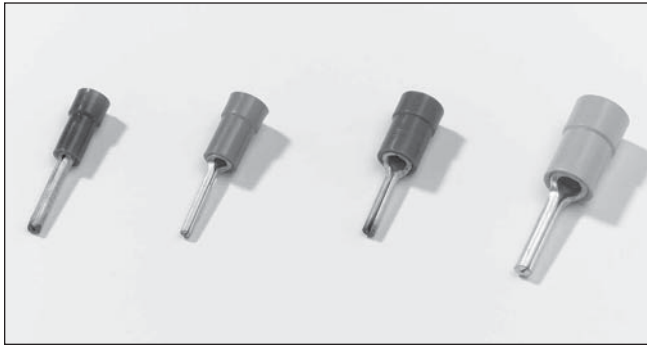

Technical Information

Material	Electrolytic copper
Plating	Tin plated
Metal barrel	Brazed seam to prevent barrel separation
Insulation	PC = Polycarbonate
Temperature resistance	+115°C / +125°C
Colour coding of the insulation	According to the wire size
Cable insertion	Easy entry

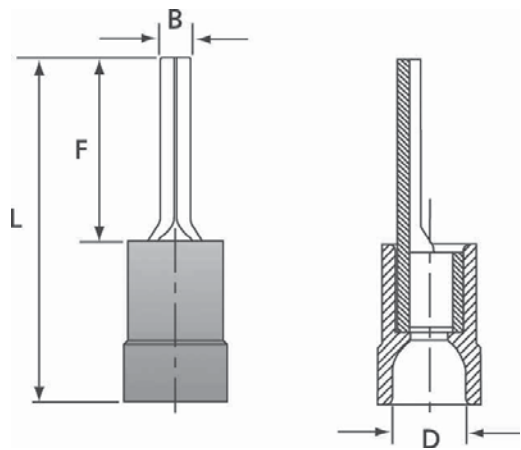

Ordering Information									
Cat. No.	Wire Size Range (mm ²)	Colour	Dimensions				Wt. (g/100)	Qty. (pieces)	Crimping Tool
			W (mm)	F (mm)	B (mm)	D (mm)			
RZP	0.25 - 0.75	Green	22.0	12.0	1.8	3.2	47	100	ERG2510
RAP	0.5 - 1.5	Red	22.0	12.0	1.9	4.0	67	100	ERG2001A WT2124Y
RBP	1.5 - 2.5	Blue	22.0	12.0	1.9	4.5	80	100	
RCP	4.0 - 6.0	Yellow	27.0	14.0	2.8	6.4	175	100	

Sta-Kon®

Insulated Female Disconnects DIN 46245

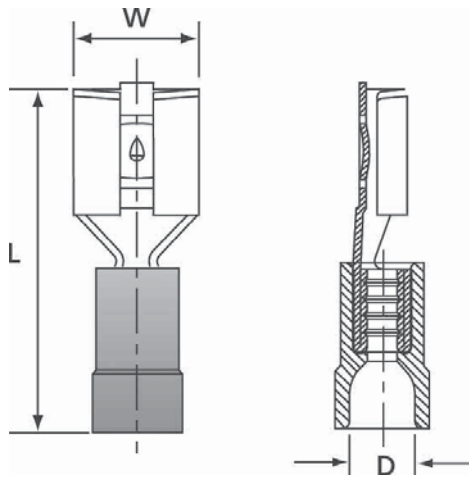
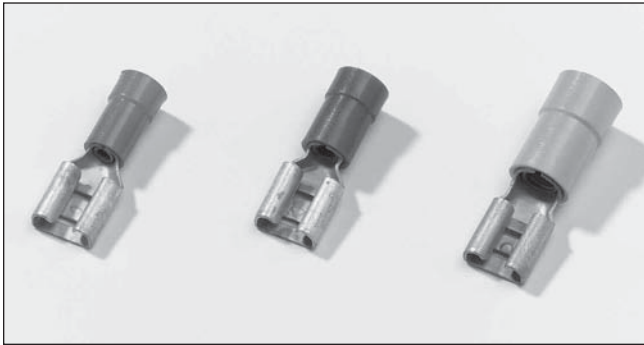

Technical Information

Material	Brass
Plating	Tin plated
Metal barrel	Brazed seam to prevent barrel separation
Insulation	PC = Polycarbonate
Temperature resistance	+115°C / +125°C (for PVC insulation +65°C / +75°C)
Colour coding of the insulation	According to the wire size (DIN)
Cable insertion	Easy entry

Ordering Information

Cat. No.	Wire Size Range (mm ²)	Male Tab Size (mm)	Colour	Dimensions			Wt. (g/100)	Qty. (pieces)	Crimping Tool
				L (mm)	D (mm)	W (mm)			
RA28	0.5 - 1.5	2.8 x 0.8	Red	18.5	3.3	3.5	60	100	
RA29	0.5 - 1.5	2.8 x 0.5	Red	18.5	3.3	3.5	60	100	
RA48**	0.5 - 1.5	4.8 x 0.8	Red	19.0	3.7	5.7	82	100	
RA49**	0.5 - 1.5	4.8 x 0.5	Red	19.0	3.7	5.7	83	100	
RA63	0.5 - 1.5	6.3 x 0.8	Red	20.0	4.0	7.6	96	100	
RB48**	1.5 - 2.5	4.8 x 0.5	Blue	19.0	4.4	5.7	91	100	ERG2001A WT2124Y
RB49**	1.5 - 2.5	4.8 x 0.8	Blue	19.0	4.4	5.7	87	100	
RB63	1.5 - 2.5	6.3 x 0.8	Blue	20.0	4.5	7.6	106	100	
RC63	4.0 - 6.0	6.3 x 0.8	Yellow	24.0	6.4	7.6	183	100	
RC95**	4.0 - 6.0	9.5 x 1.2	Yellow	31.0	6.2	11.0	233	100	

**Non-brazed, with support sleeve and PVC insulation, not easy entry.

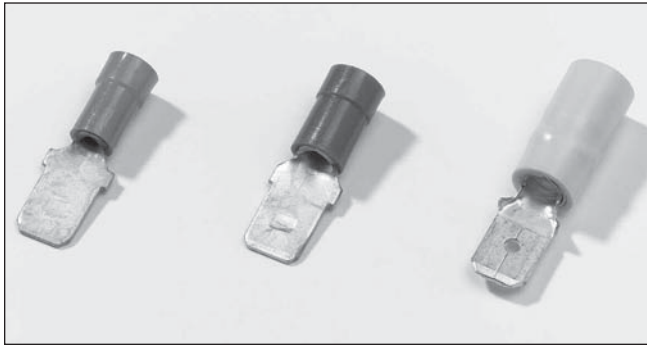

Technical Information

Material	Brass
Plating	Tin plated
Metal barrel	Brazed seam to prevent barrel separation
Insulation	PC = Polycarbonate
Temperature resistance	+115°C / +125°C (for PVC insulation +65°C / +75°C)
Colour coding of the insulation	According to the wire size (DIN)
Cable insertion	Easy entry

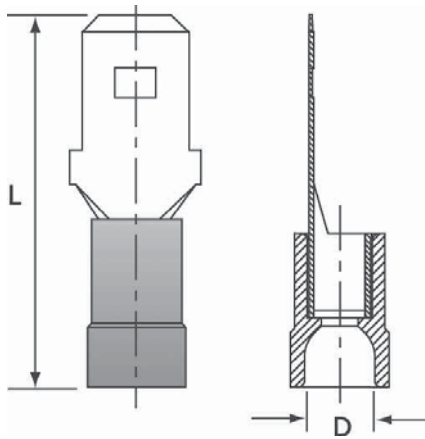

Ordering Information

Cat. No.	Wire Size Range (mm ²)	Male Tab Size (mm)	Colour	Dimensions		Wt. (g/100)	Qty. (pieces)	Crimping Tool
				L (mm)	D (mm)			
RA63M	0.5 - 1.5	6.3 x 0.8	Red	22.0	4.0	107	100	ERG2001A WT2124Y
RB63M	1.5 - 2.5	6.3 x 0.8	Blue	22.0	4.5	107	100	
RC63M**	4.0 - 6.0	6.3 x 0.8	Yellow	25.0	6.3	155	100	

**PVC insulation. No easy entry and non-brazed, with brass support sleeve.

Sta-Kon®

Fully Insulated Female Disconnects

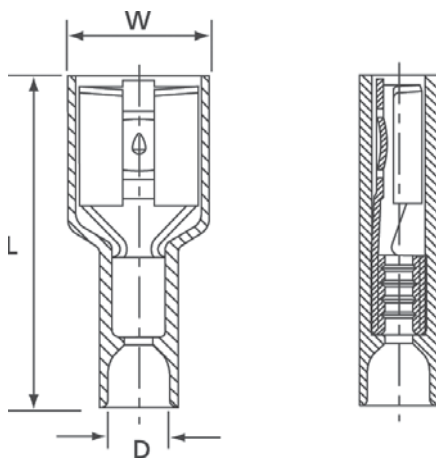
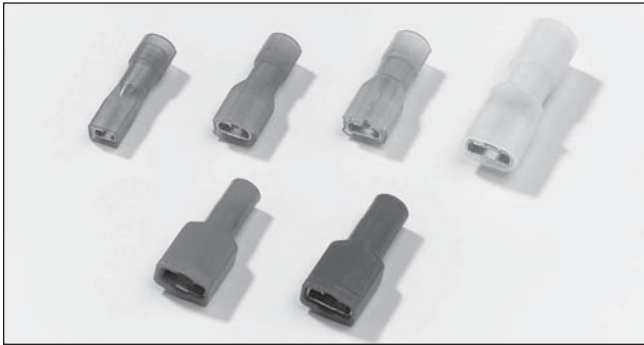

Technical Information

Material	Brass
Plating	Tin plated
Metal barrel	Non-brazed, with brass support sleeve
Insulation	PA = Polyamide Ideal for harsh environments, provides excellent chemical, impact and abrasion resistance
Temperature resistance	+85°C / +105°C
Colour coding of the insulation	According to the wire size (DIN)

Ordering Information

Cat. No.	Wire Size Range (mm ²)	Male Tab Size (mm)	Colour	Dimensions			Wt. (g/100)	Qty. (pieces)	Crimping Tool
				W (mm)	L (mm)	D (mm)			
RA28V	0.5 - 1.5	2.8 x 0.8	Red	5.0	19.3	3.8	110	100	ERG2001A WT2124Y
RA29V	0.5 - 1.5	2.8 x 0.5	Red	5.0	19.3	3.8	110	100	
RA48V	0.5 - 1.5	4.8 x 0.8	Red	7.4	20.2	3.6	115	100	
RA49V	0.5 - 1.5	4.8 x 0.5	Red	7.4	20.2	3.6	115	100	
RA63V**	0.5 - 1.5	6.3 x 0.8	Red	8.8	21.0	4.0	123	100	
RB48V	1.5 - 2.5	4.8 x 0.8	Blue	7.1	19.5	3.9	120	100	
RB49V	1.5 - 2.5	4.8 x 0.5	Blue	7.1	19.5	3.9	120	100	
RB63V**	1.5 - 2.5	6.3 x 0.8	Blue	8.8	21.0	4.5	132	100	
RC63V	4.0 - 6.0	6.3 x 0.8	Yellow	9.0	26.0	5.3	215	100	

**Easy entry and brazed barrel, polycarbonate insulator.

Sta-Kon®

Fully Insulated Butt Splices

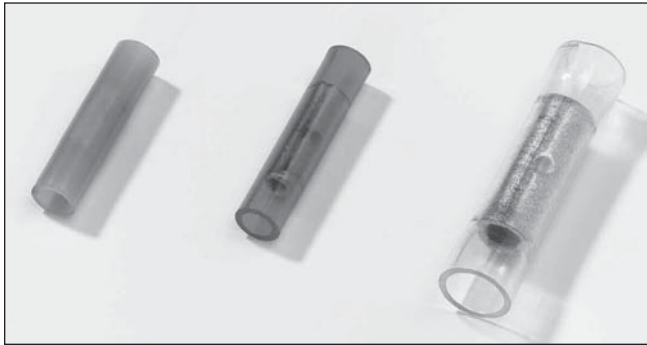

Technical Information

Material	Electrolytic copper
Plating	Tin plated
Metal barrel	Brazed seam to prevent barrel separation
Insulation	PC = Polycarbonate
Temperature resistance	+115°C / +125°C
Colour coding of the insulation	According to the wire size (DIN)
Cable insertion	Easy entry

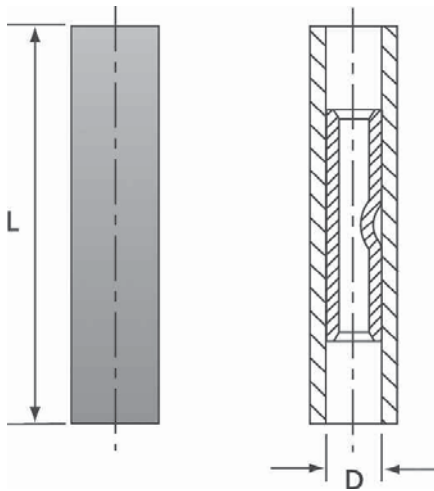

Ordering Information

Cat. No.	Wire Size Range (mm ²)	Colour	Dimensions		Wt. (g/100)	Qty. (pieces)	Crimping Tool
			L (mm)	D (mm)			
RAA15	0.5 - 1.5	Red	24.0	3.4	97	100	ERG2001A WT2124Y
RBB25	1.5 - 2.5	Blue	26.0	4.3	150	100	
RCC6	4.0 - 6.0	Yellow	33.0	6.5	316	100	

Sta-Kon®

Insulated Wire Joints

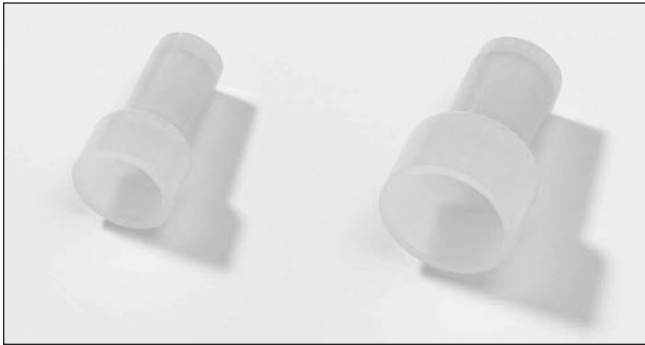

Technical Information

Material	Brass
Plating	Tin plated
Metal barrel	Brazed seam to prevent barrel separation
Insulation	PA = Polyamide Ideal for harsh environments, provides excellent chemical, impact and abrasion resistance
Temperature resistance	+85°C / 105°C

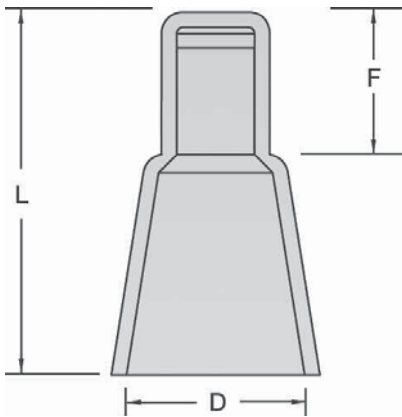

Ordering Information

Cat. No.	Wire Size Range (mm ²)	Colour	Dimensions			Wt. (g/100)	Qty. (pieces)	Crimping Tool
			F (mm)	L (mm)	D (mm)			
RBJ	1.0 - 3.0	White	8.0	15.2	6.4	86	100	ERG2001A
RCJ	2.0 - 6.0	White	9.0	17.7	9.2	166	100	WT2124Y

Ergonomic Hand Tools

- Ergonomic ratchet style hand tools used for installing insulated and non-insulated terminals.
- Specially designed ergonomic handles distribute the crimping force more evenly across the user's hands. This helps to reduce the risk of Carpal Tunnel Syndrome, the cause of almost one in two industrial injuries.
- Ratchet design greatly reduces handle forces over conventional hand tools and incorporates the **Shure-Stake® mechanism** which ensures a full crimp cycle every time.
- Most dies incorporate wire range mark for easy inspection (insulated only).
- Colour coded die nests (insulated only) make terminal and die nest selection easy.
- The product design and engineering results in a long lasting precision tool.
- Exists in 2 versions: with interchangeable dies or with fixed dies.

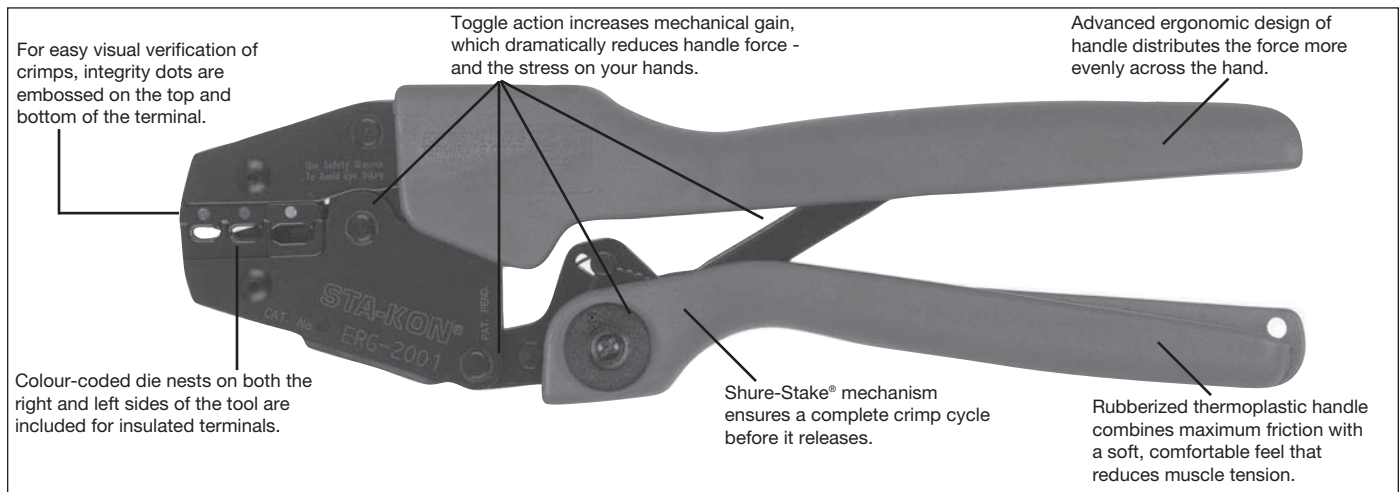

Ergonomic Hand Tools with Fixed Die

Product Ref.: ERG2001A

- Ergonomic fixed die tool, with three colour-coded die nests for easy selection
- For **insulated terminals** from:
0.5 to 1.5 mm² red
1.5 to 2.5 mm² blue
4.0 to 6.0 mm² yellow
- **Shure-Stake™ mechanism**
- Length: 255 mm
- Weight: 560 g

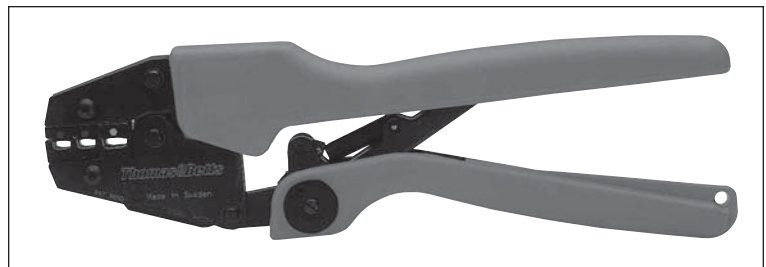

Product Ref.: ERG2510

- Ergonomic fixed die tool with 2 die nests
- For **insulated terminals** and **insulated bootlace ferrules** from:
0.25 to 0.5 mm²
0.5 to 1.0 mm²
- **Shure-Stake™ mechanism**
- Length: 220 mm
- Weight: 430 g

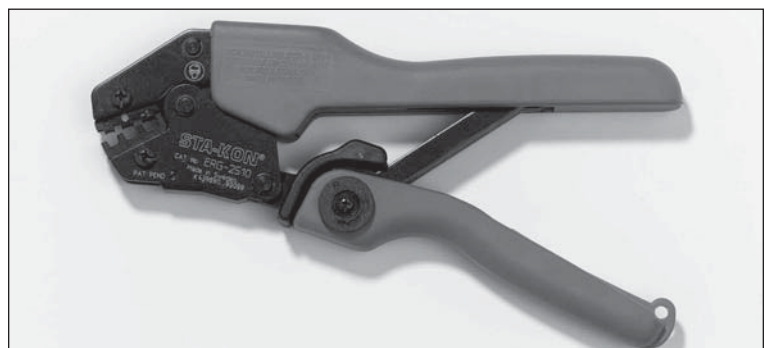

Crimping Tools

An extensive range of tooling is available, suiting a variety of requirements, to crimp the following terminals:

- Insulated terminals and bootlace ferrules
- Non-insulated terminals
- Copper tube terminals

Different types of tooling are offered, depending on volume and application:

- Plier type hand tools for occasional applications (“Do-It-Yourself” users)
- Standard hand tooling for low to medium volume applications
- Ergonomic hand tooling for low to medium volume applications, where high, repeatable quality is essential
- Hydraulic tooling for heavy-duty applications
- Smart tools where no die change is necessary

Standard Crimping Tools

Product Ref.: WT52

- Plier type tool
- For **insulated** and **non-insulated terminals** from 0.5 to 6 mm²
- Incorporates wire stripper and bolt cutters
- Recommended for “Do-It-Yourself” applications only
- Length: 225 mm
- Weight: 200 g

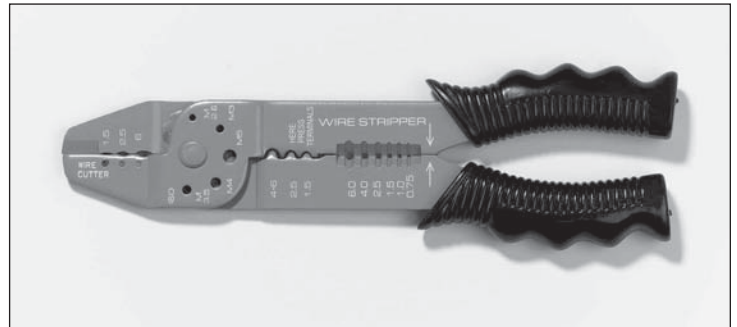

Product Ref.: WT2124Y

- Ratchet type hand tool, fixed die
- For **insulated** and **non-insulated terminals** from:
0.5 to 1.5 mm² red
1.5 to 2.5 mm² blue
4.0 to 6.0 mm² yellow
- Built in **Shure-Stake®** mechanism to ensure a full compression every time
- Length: 228 mm
- Weight: 533 g

