

Disconnect terminals provide a quick, reliable method of connection to terminal blocks and boards without the use of tools. They are supplied in a variety of styles to meet virtually all quick-disconnect requirements. Female disconnect terminals and matching male tabs accommodate a range of 22-10 AWG, and are available in non-insulated,

partially insulated, and fully insulated styles, in both nylon and vinyl. They are available in various tab widths including .250", .187", and .110", and a combination size. A unique construction of the female disconnect offers long-term dependability. The brazed seam serrated barrel provides maximum tensile strength.



RA18-250F

nylon self-insulated
installing tools – WT145C,
WT2000, ERG4001,
ERG2003, WT112M



18RA-250F

vinyl self-insulated
installing tools – WT145C,
WT2000, ERG4001,
ERG2003, WT112M



18RA-2577

nylon fully-insulated
installing tools – WT145C,
WT2000, ERG4001,
ERG2003, WT112M



RAS18-250AX

heat-shrinkable fully
insulated disconnects
installing tool – WT1255

250 Series – Female Disconnects

Cat. No.	Pkg. Qty.	Wire Range	Max. Ins.	Tab Size	Wt./lb. Per 1000	Dimensions	
						A	B
① RA18-250F	100	22-18	.136	.250 x .032	4	.91	.29
RA250TB	1000	22-18	.136	.250 x .032	4	.91	.29
RB14-250F	100	16-14	.162	.250 x .032	4	.91	.29
RB250	1000	16-14	.162	.250 x .032	4	.91	.29
RC10-250F	50	12-10	.215	.250 x .032	4	1.04	.29
RC250	500	12-10	.215	.250 x .032	4	1.04	.29
② 18RA-250F	100	22-18	.150	.250 x .032	3	.96	.29
RA257	1000	22-18	.150	.250 x .032	3	.96	.29
RA257-170	1000	22-18	.170	.250 x .032		.96	.29
14RB-250F	100	16-14	.170	.250 x .032	3	.96	.29
RB257	1000	16-14	.170	.250 x .032	3	.96	.29
RB257-200	1000	16-14	.200	.250 x .032		.96	.29
10RC-250F	50	12-10	.250	.250 x .032	4	1.03	.29
RC257	500	12-10	.250	.250 x .032	4	1.03	.29
③ 18RA-2577	100	22-18	.165	.250 x .032	3	1.01	.38
RA2573	1000	22-18	.165	.250 x .032	3	1.01	.38
14RB-2577	100	16-14	.185	.250 x .032	4	1.01	.38
RB2573	1000	16-14	.185	.250 x .032	4	1.01	.38
10RC-2577	50	12-10	.225	.250 x .032	5	1.04	.38
RC2573	500	12-10	.225	.250 x .032	5	1.04	.38
④ RAS18-250AX	25	22-18	.170	.250 x .032	4	1.83	–
RBS14-250AX	25	16-14	.200	.250 x .032	5	1.78	–
RCS10-250AX	50	12-10	.250	.250 x .032	6	1.80	–

Material: brass
Finish: tin plated
U.L. Listed **E66716**



Most standard bulk catalogue numbers can be put on Mylar Tape for reel fed applications (i.e. 12050 tool and application dies). See pages 196-197 for description of tooling. Please add the suffix "M" for Mylar Tape (i.e. RA2573-M).



①



RA18-250A
nylon open top insulated 90° flag installing tools – WT145C, WT2000, ERG4001, ERG2003, WT112M

②



A18-250
non-insulated installing tools – WT111M, WT1110M, WT2000, ERG4002, WT112M

③



B14-250F
non-insulated/insulation grip installing tool – WT110M

④



A18-250A
non-insulated 90° flag installing tools – WT110M, WT111M, WT2000, ERG4002, WT112M

250 Series – Female Disconnects – continued

Cat. No.	Pkg. Qty.	Wire Range	Max. Ins.	Tab Size	Wt./lb. Per 1000	Dimensions	
						A	B
① RA18-250A	50	22-18	.170	.250 x .032	4	.80	.71
RA2577F	500	22-18	.170	.250 x .032	4	.80	.71
RB14-250A	50	16-14	.190	.250 x .032	5	.80	.72
RB2577F	500	16-14	.190	.250 x .032	5	.80	.72
RC10-250A	50	12-10	.245	.250 x .032	6	.80	.88
RC2577F	500	12-10	.245	.250 x .032	6	.80	.88
② A18-250	100	22-18	–	.250 x .032	3	.73	.31
A250-TB	1000	22-18	–	.250 x .032	3	.73	.31
B14-250	100	16-14	–	.250 x .032	3	.73	.31
B250	1000	16-14	–	.250 x .032	3	.73	.31
C10-250F	50	12-10	–	.250 x .032	4	.73	.31
C250	500	12-10	–	.250 x .032	4	.73	.31
③ B14-250F	100	16-14	–	.250 x .032	5	.87	.31
B250G	1000	16-14	–	.250 x .032	5	.87	.31
④ A18-250A	50	22-18	–	.250 x .032	3	.58	.61
A252G	1000	22-18	–	.250 x .032	3	.58	.61
B14-250A	50	16-14	–	.250 x .032	3	.58	.62
B252G	1000	16-14	–	.250 x .032	3	.58	.62
C10-250A	50	12-10	–	.250 x .032	4	.64	.63
C252G	500	12-10	–	.250 x .032	4	.64	.63

U.L. Listed E66716

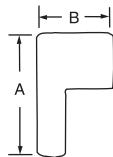
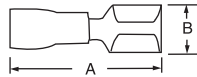

250 Series – Piggy Back Disconnects – Nylon Insulated

Cat. No.	Pkg. Qty.	Wire Range	Max. Ins.	Tab Size	Wt./lb. Per 1000	Dimensions		
						A	B	C
⑤ RA18-250FP	100	22-18	.136	.250 x .032	3	.87	.30	.43
RA250P	1000	22-18	.136	.250 x .032	3	.87	.30	.43
RB14-250FP	100	16-14	.163	.250 x .032	3	.87	.30	.43
RB250P	1000	16-14	.163	.250 x .032	3	.87	.30	.43

For stacking applications
Installing Tool – WT112M

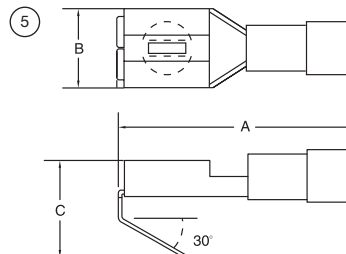

Most standard bulk catalogue numbers can be put on Mylar Tape for reel fed applications (i.e. 12050 tool and application dies). See pages 196-197 for description of tooling. Please add the suffix "M" for Mylar Tape (i.e. RA2573-M).



①



RAD18-183
nylon self-insulated
installing tools – WT145C,
WT2000, ERG4001,
ERG2003, WT112M

②



18RAD-183
vinyl self-insulated
installing tools – WT145C,
WT2000, ERG4001,
ERG2003, WT112M

③



18RAD-18377
nylon fully-insulated
installing tools – WT145C,
WT2000, ERG4001,
ERG2003, WT112M



AD18-183
non-insulated
installing tools –
WT111M, ERG4002,
WT2000, WT112M,

⑤



RAD18-187A
nylon fully-insulated 90° flag
installing tools – WT1145C,
WT2000, ERG4001,
ERG2003, WT112M

Disconnect terminals provide a quick, reliable method of connection to terminal blocks and boards without the use of tools. They are supplied in a variety of styles to meet virtually all quick-disconnect requirements. Female disconnect terminals and matching male tabs accommodate a range of 22-10 AWG, and are available in non-insulated, partially insulated, and fully insulated styles, in both nylon and vinyl. They are available in various tab widths including .250", .187", and .110", and a combination size. A unique construction of the female disconnect offers long-term dependability.

187 Series – Female Disconnects

Cat. No.	Pkg. Qty.	Tab Size	Wire Range	Max. Ins. Dia.	Dimensions	
					A	B
① RAD18-183	100	.187 x .032	22-18	.136	.83	.23
RAD1833	1000	.187 x .032	22-18	.136	.83	.23
RAD18-182	100	.187 x .020	22-18	.136	.83	.23
RAD1823	1000	.187 x .020	22-18	.136	.83	.23
RBD14-183	100	.187 x .032	16-14	.163	.83	.23
RBD1833	1000	.187 x .032	16-14	.163	.83	.23
RBD14-182	100	.187 x .020	16-14	.163	.83	.23
RBD1823	1000	.187 x .020	16-14	.163	.83	.23
② 18RAD-183	100	.187 x .032	22-18	.150	.85	.23
RAD1837	1000	.187 x .032	22-18	.150	.85	.23
18RAD-182	100	.187 x .020	22-18	.150	.85	.23
RAD1827	1000	.187 x .020	22-18	.150	.85	.23
14RBD-183	100	.187 x .032	16-14	.170	.85	.23
RBD1837	1000	.187 x .032	16-14	.170	.85	.23
14RBD-182	100	.187 x .020	16-14	.170	.85	.23
RBD1827	1000	.187 x .020	16-14	.170	.85	.23
③ 18RAD-18377	100	.187 x .032	22-18	.150	.89	.30
RAD18377	500	.187 x .032	22-18	.150	.89	.30
18RAD-18277	100	.187 x .020	22-18	.150	.89	.30
RAD18277	500	.187 x .020	22-18	.150	.89	.30
14RBD-18377	100	.187 x .032	16-14	.170	.89	.30
RBD18377	500	.187 x .032	16-14	.170	.89	.30
14RBD-18277	100	.187 x .020	16-14	.170	.89	.30
RBD18277	500	.187 x .020	16-14	.170	.89	.30
④ AD18-183	100	.187 x .032	22-18	–	.64	.23
AD183	1000	.187 x .032	22-18	–	.64	.23
AD18-182	100	.187 x .020	22-18	–	.64	.23
AD182	1000	.187 x .020	22-18	–	.64	.23
BD14-183	100	.187 x .032	16-14	–	.64	.23
BD183	1000	.187 x .032	16-14	–	.64	.23
BD14-182	100	.187 x .020	16-14	–	.64	.23
⑤ RAD18-187A	50	.187 x .032	22-18	.150	.74	.59
RAD1877F	500	.187 x .032	22-18	.150	.74	.59
RAD18-188A	50	.187 x .020	22-18	.150	.74	.59
RAD1887F	500	.187 x .020	22-18	.150	.74	.59
RBD14-187A	50	.187 x .032	16-14	.170	.74	.61
RBD1877F	500	.187 x .032	16-14	.170	.74	.61
RBD14-188A	50	.187 x .020	16-14	.170	.74	.61
RBD1887F	500	.187 x .020	16-14	.170	.74	.61

U.L. Listed E66716

Material: brass

Finish: tin plated

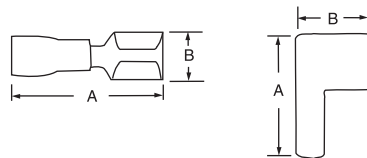

Most standard bulk catalogue numbers can be put on Mylar Tape for reel fed applications (i.e. 12050 tool and application dies). See pages 196-197 for description of tooling. Please add the suffix "M" for Mylar Tape (i.e. RA2573-M).



18RA-250T
vinyl self-insulated
installing tools – WT145C,
WT2000, ERG4001,
ERG2003, WT112M



18RA-251T
nylon fully insulated
installing tools – WT145C,
WT2000, ERG4001,
ERG2003, WT112M



18RAS-251TX
heat shrinkable nylon fully
insulated
installing tool – WT1255



A18-250T
Non-insulated/insulated grip
installing tool – WT110M



18-251T
Non-insulated
installing tools – WT110M,
WT111M, WT2000,
WT112M, ERG4002, WT112M

250 Series – Male Tabs

	Cat. No.	Pkg. Qty.	Wire Range	Max. Ins.	Tab Size	Wt./lb. Per 1000	Dimensions	
							A	B
①	18RA-250T	100	22-18	.150	.250 x .032	3	.95	–
	RA2517	1000	22-18	.150	.250 x .032	3	.95	–
	14RB-250T	100	16-14	.170	.250 x .032	3	.95	–
	RB2517	1000	16-14	.170	.250 x .032	3	.95	–
	10RC-250T	50	12-10	.250	.250 x .032	4	1.08	–
	RC2517	500	12-10	.250	.250 x .032	4	1.08	–
②	18RA-251T	50	22-18	.150	.250 x .032	5	1.13	.45
	RA25177	500	22-18	.150	.250 x .032	5	1.13	.45
	14RB-251T	50	16-14	.170	.250 x .032	5	1.13	.45
	RB25177	500	16-14	.170	.250 x .032	5	1.13	.45
	10RC-251T	25	12-10	.210	.250 x .032	5	1.17	.45
	RC25177	500	12-10	.210	.250 x .032	5	1.17	.45
③	18RAS-251TX	25	22-18	.170	.250 x .032	4	1.80	–
	14RBS-251TX	25	16-14	.200	.250 x .032	5	1.75	–
	10RCS-251TX	25	12-10	.250	.250 x .032	6	1.80	–
④	A18-250T	100	22-18	–	.250 x .032	3	.87	–
	B14-250T	100	20-14	–	.250 x .032	3	.87	–
⑤	A18-251T	100	22-18	–	.250 x .032	2	.68	–
	A251	1000	22-18	–	.250 x .032	2	.68	–
	B14-251T	100	16-14	–	.250 x .032	2	.68	–
	B251	1000	16-14	–	.250 x .032	2	.68	–
	C10-251T	50	12-10	–	.250 x .032	2	.68	–

Material: brass
Finish: tin plated

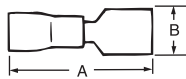

Most standard bulk catalogue numbers can be put on Mylar Tape for reel fed applications (i.e. 12050 tool and application dies). See pages 196-197 for description of tooling. Please add the suffix "M" for Mylar Tape (i.e. RA2573-M).



18RAD-187
vinyl insulated
installing tools – WT145C,
WT2000, ERG4001,
ERG2003, WT112M

187 Series – Male Tabs

Cat. No.	Pkg. Qty.	Tab Size	Wire Range	Max Ins.	Wt./lb. Per 1000	Dia. A
① 18RAD-187	100	.187 x .032	22-18	.150	4	.87
18RAD-188	100	.187 x .020	22-18	.150	4	.87
14RBD-187	100	.187 x .032	16-14	.170	4	.87
14RBD-188	100	.187 x .020	16-14	.170	4	.87

U.L. Listed E66716

Material: brass

Finish: tin plated

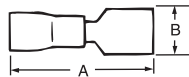

RA18-111F
nylon-insulated
installing tool –
WT465

110 Series – Disconnects*

Cat. No.	Pkg. Qty.	Tab Size	Wire Range	Max Ins.	Wt./lb. Per 1000	Dimensions	
						A	B
② RA18-110F	100	.110 x .032	22-18	.110	4	.75	.15
RA10SK	1000	.110 x .032	22-18	.110	4	.75	.15
RA18-111F	100	.110 x .020	22-18	.110	4	.75	.15
RA11	1000	.110 x .020	22-18	.110	4	.75	.15
RB14-110F	100	.110 x .032	16-14	.135	4	.75	.15
RB10-SK	1000	.110 x .032	16-14	.135	4	.75	.15
RB14-111F	100	.110 x .020	16-14	.135	4	.75	.15
RB11-TB	1000	.110 x .020	16-14	.135	4	.75	.15
③ A18-110F	100	.110 x .032	22-18	–	3	.59	.15
A10-TB	1000	.110 x .032	22-18	–	3	.59	.15
A18-111F	100	.110 x .020	22-18	–	3	.59	.15
A11	1000	.110 x .020	22-18	–	3	.59	.15
B14-110F	100	.110 x .032	16-14	–	3	.59	.15
B10TB	1000	.110 x .032	16-14	–	3	.59	.15
B14-111F	100	.110 x .020	16-14	–	3	.59	.15
B11-TB	1000	.110 x .020	16-14	–	3	.59	.15

*Not U.L. Listed or CSA approved.

Material: brass

Finish: tin plated

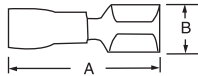

A18-111F
non-insulated
installing tools –
WT111M, WT2000,
WT112M

Most standard bulk catalogue numbers can be put on Mylar Tape for reel fed applications (i.e. 12050 tool and application dies). See pages 196-197. Please put the suffix M for Mylar Tape RA2573M. (Bulk number 1000 and 500 packages.)

RA Series requires a 12061 Die.

RB Series requires a 12062 Die.

Sta-Kon® Disconnects

①

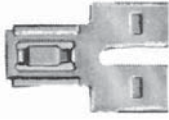

②



RB14-250
insulated coupler
no tool required
Male

250 Series – Adapters & Couplers †

Cat. No.	Pkg. Qty.	Tab Size	Wt./lb. Per 1000	Dimensions	
				A	B
① F250TA	50	.250 x .032	3	.82	.56
FTA250	1000	.250 x .032	3	.82	.56
② RB14-250	50	.250 x .032	7	2.35	.51
RBB250	500	.250 x .032	7	2.35	.51

† Not U.L. Listed

Cat. No. F250TA –

Material: brass

Finish: tin plated

Cat. No. RB14-250 –

Material: brass

Finish: none

Insulation: vinyl

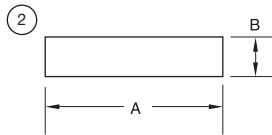
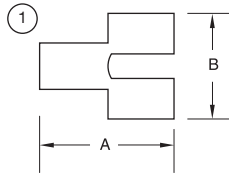

RA18D
Nylon-insulated wire barrels
installing tool –
WT2000 (Not U.L.)



B14-D
non-insulated/insulation grip
installing tool –
WT110M (Not U.L.)

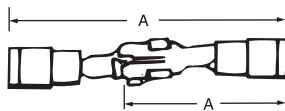

Nylon Insulated and Non-insulated
Picture shows wristlock assembled as 2 pieces. Parts are sold by the piece not assemblies.

Wristlock Disconnects †

Cat. No.	Pkg. Qty.	Wire Range	Max. Ins.	Wt./lb. Per 1000	Dimensions	
					A	A1
RA18D	50	22-18	.136	4	.99	1.70
RA23	1000	22-18	.136	4	.99	1.70
RB14D	50	16-14	.162	4	.99	1.70
RB23	500	16-14	.162	4	.99	1.70
B14-D	50	16-14	.187	4	.97	1.66
B23	1000	16-14	.187	4	.97	1.66

† Not U.L. Listed

Note: Not available on Mylar Tape.