

## **Fastener Accessories**

Pages 81-88

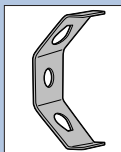

Page 82

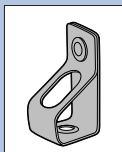

Page 82

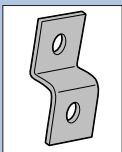

Page 83

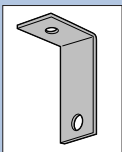

Page 83

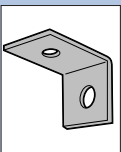

Page 83

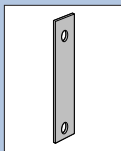

Page 83

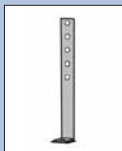

Page 83

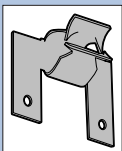

Page 84

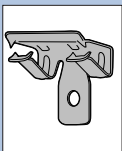

Page 84

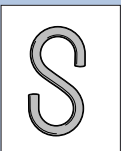

Page 85

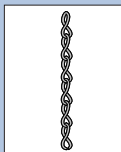

Page 85

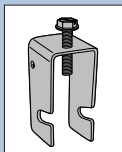

Page 86

# Steel City® Spring Steel Fasteners

## Miscellaneous Components

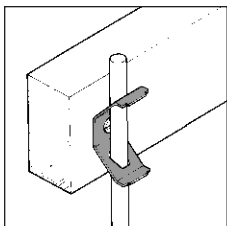

### Features

- Rod hanger with or without thread impression available for 1/4" and 3/8" threaded rod.

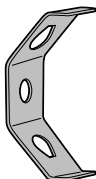

Fig. 1

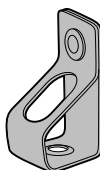

Fig. 2

## Miscellaneous Hangers

Catalog Number	Fig. No.	Description	Static Load Limit	Pkg. Per Box
SSF-HB8	1	Rod & wire hanger, #8 wire	160 lbs.	100
SSF-HB1/4	1	Rod & wire hanger, 1/4" plain rod	160 lbs.	100
SSF-HB3/8	1	Rod & wire hanger, 3/8" plain rod	160 lbs.	100
SSF-HA1/4T	2	Rod & wire hanger with thread impression 1/4" threaded rod	160 lbs.	100
SSF-HA3/8	2	Rod & wire hanger 1/4"-3/8" threaded rod, nuts required	160 lbs.	100
SSF-HA3/8T	2	Rod & wire hanger with thread impression 3/8" threaded rod	160 lbs.	100

# Steel City® Spring Steel Fasteners

## Miscellaneous Components

### Features

- Rod hanger available for 1/4" and 3/8" threaded rod with or without thread impression.
- Various steel brackets with 1/4" holes and galvanized finish.

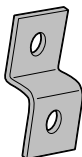
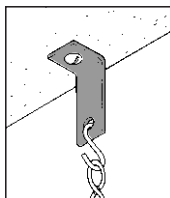

Fig. 1

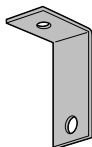

Fig. 2

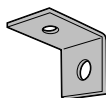

Fig. 3



Fig. 4



Fig. 5

### Miscellaneous Hangers

Catalog Number	Fig. No.	Description	Static Load Limit	Pkg. Per Box
SSF-HOB	1	Offset bracket with 1/4" hole	160	100
SSF-HAB	2	Angle bracket with 1/4" hole	160	100
SSF-HSAB	3	Short angle bracket with 1/4" hole	160	100
SSF-HFB*	4	Flat bracket with 1/4" hole	160	100
SSF-TA7*	5	For T-grid, with 1" snap-in conduit clip		100

Listed UL 2239

\*UL not applicable

Accessories



Thomas & Betts

# Steel City® Spring Steel Fasteners

## Miscellaneous Components

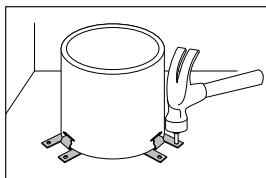

### Features

- Provides secure positioning of pipe sleeve for concrete pouring of wall and floor forms.
- Accommodates up to Schedule 80 pipe wall thicknesses.
- Installs easily with a hammer.

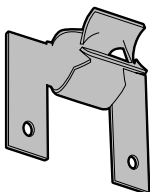

Fig. 1



Fig. 2

## Pipe Sleeve Positioner

Catalog Number	Fig. No.	Sleeve Dia.	Description / Wall Thickness	Pkg. Per Box
SSF-MPS	1	All dia.	Pipe sleeve positioner, 5/16" and under	100
SSF-MPS	1	2"-6"	Pipe sleeve positioner, Schedule 40 Pipe	100
SSF-BF1/2	2	6"	Pipe sleeve positioner, Schedule 80 Pipe	100
SSF-BF1/2	2	8"-10"	Pipe sleeve positioner, Schedule 40 Pipe	100
SSF-BF3/4	2	9"-14"	Pipe sleeve positioner, Schedule 80 Pipe	100

# Steel City® Spring Steel Fasteners

## Miscellaneous components

### Features

- Order s-hooks and jack chain with your Spring Steel orders to save on freight, energy, and purchase orders.
- S-hook supports 29 lbs. static load limit.

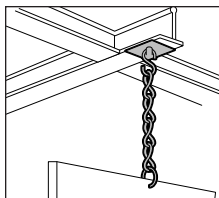

Fig. 1



Fig. 2

### S Hook and Jack Chain

Catalog Number	Fig. No.	Trade size	Description	Static Load Limit	Pkg. Per Box/Per foot
CI-8905	1		S-Hook	29	100
CI-8903	2	#2	Jack Chain	115	100
8903SP2	2	#2	Jack Chain	115	200
8903SP5	2	#2	Jack Chain	115	500
CI-8904	2	#3	Jack Chain	90	100
8904SP2	2	#3	Jack Chain	90	200
8904SP5	2	#3	Jack Chain	90	500
CI-8910	2	#10-T	Jack Chain	43	50
8910SP2	2	#10-T	Jack Chain	43	200
8910SP5	2	#10-T	Jack Chain	43	500
CI-8912	2	#12	Jack Chain	29	50

Accessories

# Steel City® Spring Steel Fasteners

## Miscellaneous Components

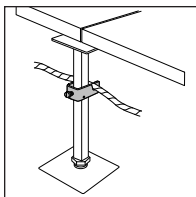

### Features

- Supports signal reference grid wires below computer room floors.
- One fastener supports wire sizes #8 stranded (.146) to #4 stranded (.232).
- Fits post sizes 3/4" to 1" round or square.
- Slots in fastener grip wire provides positive contact with post.
- Clamps grid wire directly to post allowing a low resistance connection across bare metal contacts.
- Installs easily with a screw driver or nut driver.

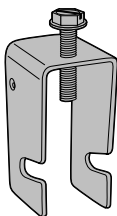

Fig. 1

Accessories

### Signal Reference Grid Wire Clamp

Catalog Number	Fig. No.	Description	Pkg. Per Box
3900	1	Signal reference grid wire clamp	100



Thomas & Betts