

Hangers

Pages 11-16

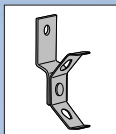

Page 12

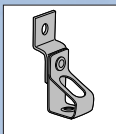

Page 12

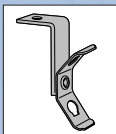

Page 13

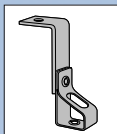

Page 13

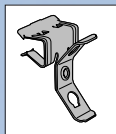

Page 14

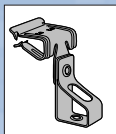

Page 14

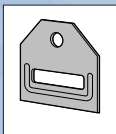

Page 15

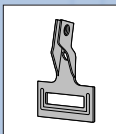

Page 15



Page 15



Page 15

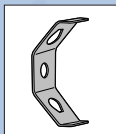

Page 16

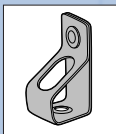

Page 16

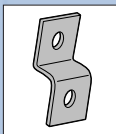

Page 16

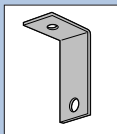

Page 16

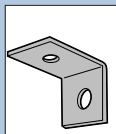

Page 16

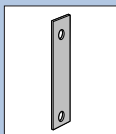

Page 16

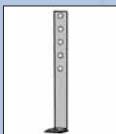

Page 16

Steel City® Spring Steel Fasteners

Hangers

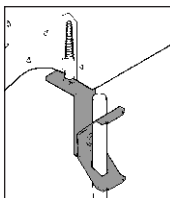

Features

- Offset bracket suspends plain rod, threaded rod or wire drops from laminated wood or concrete beams, joists, ceilings and walls.
- Supports 160 lbs. static load limit.

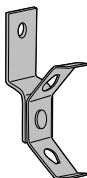

Fig. 1

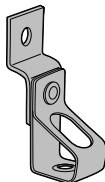

Fig. 2

Rod and Wire Hangers

Catalog Number	Fig. No.	Description	Static Load Limit	Pkg. Per Box
SSF-HB8-OB	1	Rod & wire hanger with offset bracket, #8 wire	160	25
SSF-HB1/4-OB	1	Rod & wire hanger with offset bracket, 1/4" plain rod	160	25
SSF-HB3/8-OB	1	Rod & wire hanger with offset bracket, 3/8" plain rod	160	25
SSF-HA1/4-OBT	2	Rod & wire hanger with offset bracket, 1/4" threaded rod	160	25
SSF-HA3/8-OBT	2	Rod & wire hanger with offset bracket, 3/8" threaded rod	160	25
SSF-HA3/8-OB	2	Rod & wire hanger with offset bracket, 1/4"-3/8" threaded rod, nuts required	160	25

Listed UL 2239



Features

- Angle Bracket suspends plain rod, threaded rod or wire drops from laminated wood or concrete beams, joists, ceilings and walls.
- Supports 160 pounds static load limit.

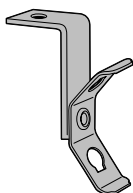
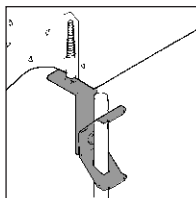

Fig. 1

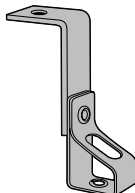

Fig. 2

Rod and Wire Hangers

Catalog Number	Fig. No.	Description	Static Load Limit	Pkg. Per Box
SSF-HB8-AB	1	Rod & wire angle bracket, #8 wire	160	25
SSF-HB1/4-AB	1	Rod & wire angle bracket hanger, 1/4" plain rod	160	25
SSF-HB3/8-AB	1	Rod & wire angle bracket hanger, 3/8" plain rod	160	25
SSF-HA1/4-ABT	2	Rod & wire hanger with angle bracket, 1/4" threaded rod	160	25
SSF-HA3/8-ABT	2	Rod & wire hanger with angle bracket, 3/8" threaded rod	160	25
SSF-HA3/8-AB	2	Rod & wire angle bracket hanger, 1/4"-3/8" threaded rod, nuts required	160	25

Listed UL 2239



Steel City® Spring Steel Fasteners

Hangers

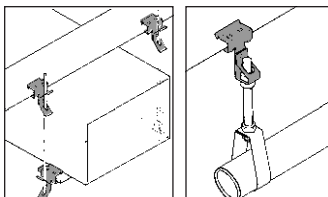

Features

- Used to suspend #8 wire, 1/4", 3/8" plain rod or 1/4" or 3/8" threaded rod from beam flanges 1/8" to 3/4" thick.
- Supports 200 lbs. static load limit.
- Installs easily with a hammer.



Fig. 1



Fig. 2

Plain and Threaded Rod Hangers

Catalog Number	Fig. No.	Description	Static Load Limit	Pkg. Per Box
SSF-HB8-F1/4	1	Rod/wire to beam hanger, 1/8"-1/4" flange, #8 wire	200	25
SSF-HB8-F1/2	1	Rod/wire to beam hanger, 5/16"-1/2" flange, #8 wire	200	25
SSF-HB8-F3/4	1	Rod/wire to beam hanger, 9/16"-3/4" flange, #8 wire	200	25
SSF-HB1/4-F1/4	1	Rod/wire to beam hanger, 1/8"-1/4" flange, 1/4" plain rod	200	25
SSF-HB1/4-F1/2	1	Rod/wire to beam hanger, 5/16"-1/2" flange, 1/4" plain rod	200	25
SSF-HB1/4-F3/4	1	Rod/wire to beam hanger, 9/16"-3/4" flange, 1/4" plain rod	200	25
SSF-HB3/8-F1/4	1	Rod/wire to beam hanger, 1/8"-1/4" flange, 3/8" plain rod	200	25
SSF-HB3/8-F1/2	1	Rod/wire to beam hanger, 5/16"-1/2" flange, 3/8" plain rod	200	25
SSF-HB3/8-F3/4	1	Rod/wire to beam hanger, 9/16"-3/4" flange, 3/8" plain rod	200	25
SSF-HA1/4-F1/4T	2	Hammer-on rod hanger, 1/8"-1/4" flange, 1/4" threaded rod	200	25
SSF-HA1/4-F1/2T	2	Hammer-on rod hanger, 5/16"-1/2" flange, 1/4" threaded rod	200	25
SSF-HA1/4-F3/4T	2	Hammer-on rod hanger, 9/16"-3/4" flange, 1/4" threaded rod	200	25
SSF-HA3/8-F1/4T	2	Hammer-on rod hanger, 1/8"-1/4" flange, 3/8" threaded rod	200	25
SSF-HA3/8-F1/2T	2	Hammer-on rod hanger, 5/16"-1/2" flange, 3/8" threaded rod	200	25
SSF-HA3/8-F3/4T	2	Hammer-on rod hanger, 9/16"-3/4" flange, 3/8" threaded rod	200	25
SSF-HA3/8-F1/4	2	Rod/wire to beam hanger, 1/8"-1/4" flange, 1/4" or 3/8" threaded rod	200	25
SSF-HA3/8-F1/2	2	Rod/wire to beam hanger, 5/16"-1/2" flange, 1/4" or 3/8" threaded rod	200	25
SSF-HA3/8-F3/4	2	Rod/wire to beam hanger, 9/16"-3/4" flange, 1/4" or 3/8" threaded rod	200	25

Listed UL 2239



Features

- Accepts strap widths up to 1-1/8".
- Can be attached to a wide variety of products.
- Supports 100 lbs. static load limit.
- Clips are made from galvanized steel.

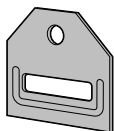
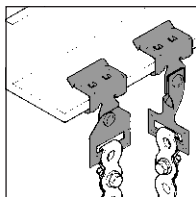

Fig. 1

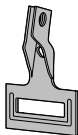

Fig. 2



Fig. 3



Fig. 4

Strap Hanger Clips

Catalog Number	Fig. No.	Description	Static Load Limit	Pkg. Per Box
SSF-HS	1	Strap hanger clip	200	100
SSF-HR	2	Strap hanger clip, right angle	200	100
SSF-HR-F1/4	3	Strap hanger clip, right angle, 1/8"-1/4" flange thickness	200	25
SSF-HR-F1/2	3	Strap hanger clip, right angle, 5/16"-1/2" flange thickness	200	25
SSF-HR-F3/4	3	Strap hanger clip, right angle, 9/16"-3/4" flange thickness	200	25
SSF-HS-F1/4	4	Strap hanger clip, flange thickness 1/8"-1/4"	200	25
SSF-HS-F1/2	4	Strap hanger clip, flange thickness 5/16"-1/2"	200	25
SSF-HS-F3/4	4	Strap hanger clip, flange thickness 5/16"-3/4"	200	25

Steel City® Spring Steel Fasteners

Hangers

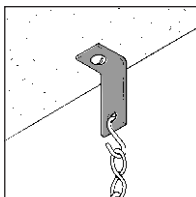

Features

- Rod hanger without thread impression available for 1/4" and 3/8" threaded rod.

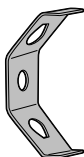

Fig. 1

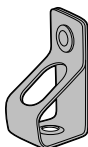

Fig. 2

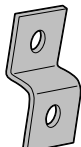

Fig. 3

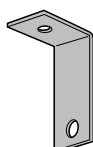

Fig. 4

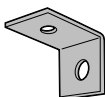

Fig. 5



Fig. 6



Fig. 7

Hangers

Miscellaneous Hangers

Catalog Number	Fig. No.	Description	Static Load Limit	Pkg. Per Box
SSF-HB8	1	Rod & wire hanger, #8 wire	160 lbs.	100
SSF-HB1/4	1	Rod & wire hanger, 1/4" plain rod	160 lbs.	100
SSF-HB3/8	1	Rod & wire hanger, 3/8" plain rod	160 lbs.	100
SSF-HA3/8	2	Rod & wire hanger 1/4"-3/8" threaded rod, nuts required	160 lbs.	100
SSF-HA1/4T	2	Rod & wire hanger with thread impression 1/4" threaded rod	160 lbs.	100
SSF-HA3/8T	2	Rod & wire hanger with thread impression 3/8" threaded rod	160 lbs.	100
SSF-H0B	3	Offset bracket with 1/4" hole	160 lbs.	100
SSF-HAB	4	Angle bracket with 1/4" hole	160 lbs.	100
SSF-HSAB	5	Short angle bracket with 1/4" hole	160 lbs.	100
SSF-HFB	6	Flat bracket with 1/4" hole	160 lbs.	100
SSF-MA7*	7	For T-grid, with 1" snap-in conduit clip	160 lbs.	100

Listed UL 2239

*UL and cUL not applicable



Thomas & Betts