

## POLYPHASE METER SOCKETS • 200 AMP. 600 VOLTS MAX.

### Product Specifications

- Conductor range: 6 AWG-250 kcmil
- Larger hub opening requires use of 3", 3-1/2" or 4" hubs unless BS052 adapter plate is used
- Supplied with screw type ring
- Weatherproof Type 3R enclosure
- **Primarily used in:** All provinces

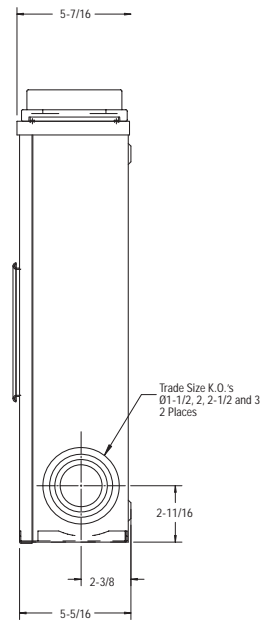
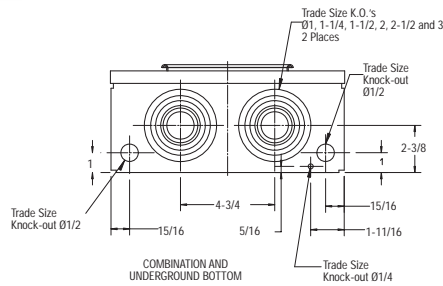
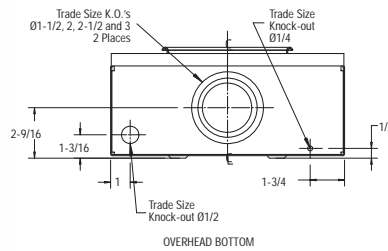

### Ordering Information

Dimensions are in inches

CATALOGUE NUMBER	DESCRIPTION	DIMENSIONS (inches)			WEIGHT EACH	
		H	W	D	lb	kg
<b>7 JAW</b>						
PL27-V	Overhead hub opening	20-1/8	12	5-7/16	18	8.1
PL27-TCV	Combination overhead-underground	20-1/8	12	5-7/16	18	8.1
PL27-IN-V	Overhead hub opening, Insulated neutral	20-1/8	12	5-7/16	18	8.1
PL27-IN-TCV	Combination overhead-underground, Insulated neutral	20-1/8	12	5-7/16	18	8.1