

Concrete Rings

and Accessories

IBERVILLE®



CI54521 / CI54561-1/2

(Shown with cover installed.)



CI54571



CI54581 / CI54591

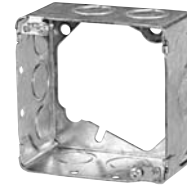

CI53171-ER



CI54560



CICBA

Extension ring.
Mounts directly on concrete rings.

SKETCH A

Knockout Configuration

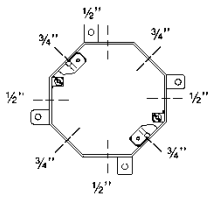

SKETCH B

Knockout Configuration

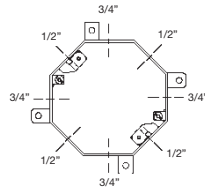

SKETCH C

Knockout Configuration

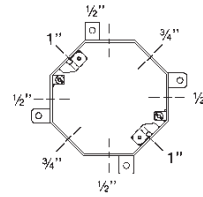

SKETCH D

Knockout Configuration

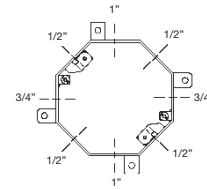

Technical Specifications

Cat. No.	Volume (Cu. in.)	Dimensions H x W x D (inches)	Knockouts			Sketch
			1/2" sides	3/4" sides	1" sides	
Concrete Rings						
CI54521	18.0	4 x 4 x 1-1/2	4	4	-	A
CI54531	24.0	4 x 4 x 2	4	4	-	A
CI54541	30.0	4 x 4 x 2-1/2	4	4	-	B
CI54551	36.0	4 x 4 x 3	4	4	-	B
CI54561	42.0	4 x 4 x 3-1/2	4	4	-	B
CI54561-1/2	42.0	4 x 4 x 3-1/2	8	-	-	All 1/2"
CI54571	48.0	4 x 4 x 4	4	2	2	C
CI54581	60.0	4 x 4 x 5	4	2	2	D
CI54591	72.0	4 x 4 x 6	4	2	2	D
Extension Rings						
CI53171-ER	30.0	4 x 4 x 2-1/8	10	6	-	-

NOTE: One CI54560 cover is supplied with each concrete ring.

Cat. No.	Description
Accessories	
CI54560	Round cover with 5 - 1/2" knockouts. One cover supplied with each concrete ring.
CICBA	For quick mounting and alignment of octagonal extension ring (BC55151-K, CI55171-K) on concrete ring.