

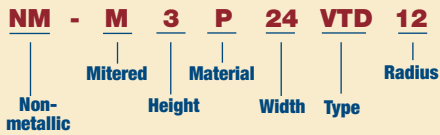

**NON-METALLIC CABLE TRAY & STRUT SYSTEMS**

# 3" VERTICAL TEES

**PART NUMBERING SYSTEM**



**VERTICAL TEES**

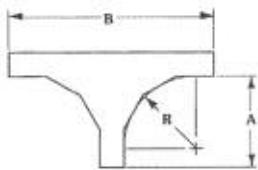

**VTD**  
Vertical Tee Down  
Mitered

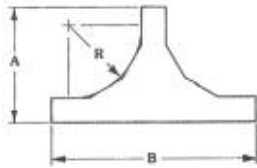

**VTU**  
Vertical Tee Up  
Mitered

-R- Bend Radius in.	Tray Width in.	Catalog No.	Vertical Tee Down		Vertical Tee Up	
			A in.	B in.	A in.	B in.
<b>12</b>	6	NM-M3-(Matl)-06-(*)12				
	9	NM-M3-(Matl)-09-(*)12				
	12	NM-M3-(Matl)-12-(*)12	23-15/16	50-7/8	26-15/16	50-7/8
	18	NM-M3-(Matl)-18-(*)12				
	24	NM-M3-(Matl)-24-(*)12				

\* Add: VTD - For vertical tee down / VTU - For vertical tee up  
Two pairs of stainless steel SS6 splice plates with SS6 hardware included.

Standard rung spacing for fittings is 9". For other types of splice plates, see page 51.

Dimensions for reference only, when critical contact factory. Consult factory for availability of molded fittings.



# 4" VERTICAL TEES

## NON-METALLIC CABLE TRAY & STRUT SYSTEMS

### PART NUMBERING SYSTEM

<b>NM</b>	-	<b>M</b>	<b>4</b>	<b>P</b>	<b>24</b>	<b>VTD</b>	<b>12</b>
Non-metallic		Mitered	Height	Material	Width	Type	Radius

† For molded fitting, if available, please remove "M" in the catalog number.  
Ex: NM-4P24VTD12

### VERTICAL TEES

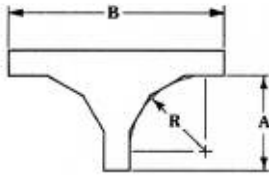

**VTD**  
Vertical Tee Down

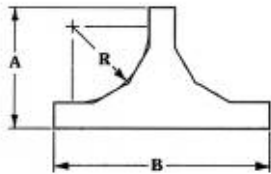

**VTU**  
Vertical Tee Up

-R-Bend Radius in.	Tray Width in.	Catalog No.	Vertical Tee Down		Vertical Tee Up	
			A in.	B in.	A in.	B in.
<b>12</b>	6	NM-M4-(Matl)-06-(*)12	19-1/4	42-1/2	23-1/4	42-1/2
	9	NM-M4-(Matl)-09-(*)12				
	12	NM-M4-(Matl)-12-(*)12				
	18	NM-M4-(Matl)-18-(*)12				
	24	NM-M4-(Matl)-24-(*)12				
	30	NM-M4-(Matl)-30-(*)12				
36	NM-M4-(Matl)-36-(*)12					
<b>24</b>	6	NM-M4-(Matl)-06-(*)24	31-1/4	66-1/2	35-1/4	66-1/2
	9	NM-M4-(Matl)-09-(*)24				
	12	NM-M4-(Matl)-12-(*)24				
	18	NM-M4-(Matl)-18-(*)24				
	24	NM-M4-(Matl)-24-(*)24				
	30	NM-M4-(Matl)-30-(*)24				
36	NM-M4-(Matl)-36-(*)24					
<b>36</b>	6	NM-M4-(Matl)-06-(*)36	37-3/4	79-1/2	41-3/4	79-1/2
	9	NM-M4-(Matl)-09-(*)36				
	12	NM-M4-(Matl)-12-(*)36				
	18	NM-M4-(Matl)-18-(*)36				
	24	NM-M4-(Matl)-24-(*)36				
	30	NM-M4-(Matl)-30-(*)36				

\* Add: VTD - For vertical tee down / VTU - For vertical tee up  
Two pairs of stainless steel SS6 splice plates with SS6 hardware included.

FITTINGS

Standard rung spacing for fittings is 9". For other types of splice plates, see page 51.

Dimensions for reference only, when critical contact factory. Consult factory for availability of molded fittings.



NON-METALLIC CABLE TRAY & STRUT SYSTEMS

6" VERTICAL TEES

PART NUMBERING SYSTEM

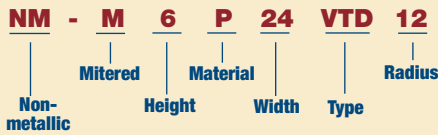

† For molded fitting, if available, please remove "M" in the catalog number. Ex: NM-6P24VTD12

VERTICAL TEES

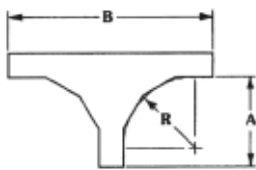

VTD  
Vertical Tee Down

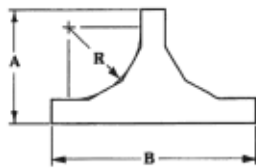

VTU  
Vertical Tee Up

-R-Bend Radius in.	Tray Width in.	Catalog No.	Vertical Tee Down		Vertical Tee Up	
			A in.	B in.	A in.	B in.
<b>12</b>	6	NM-M6-(Matl)-06-(*)12	26	58	32	58
	9	NM-M6-(Matl)-09-(*)12				
	12	NM-M6-(Matl)-12-(*)12				
	18	NM-M6-(Matl)-18-(*)12				
	24	NM-M6-(Matl)-24-(*)12				
	30	NM-M6-(Matl)-30-(*)12				
<b>24</b>	6	†NM-M6-(Matl)-06-(*)24	31-1/4	68-1/2	37-1/4	68-1/2
	9	†NM-M6-(Matl)-09-(*)24				
	12	†NM-M6-(Matl)-12-(*)24				
	18	†NM-M6-(Matl)-18-(*)24				
	24	†NM-M6-(Matl)-24-(*)24				
	30	†NM-M6-(Matl)-30-(*)24				
<b>36</b>	6	NM-M6-(Matl)-06-(*)36	43-1/2	92-1/2	49-1/2	92-1/2
	9	NM-M6-(Matl)-09-(*)36				
	12	NM-M6-(Matl)-12-(*)36				
	18	NM-M6-(Matl)-18-(*)36				
	24	NM-M6-(Matl)-24-(*)36				
	30	NM-M6-(Matl)-30-(*)36				
36	NM-M6-(Matl)-36-(*)36					

\* Add: VTD - For vertical tee down / VTU - For vertical tee up  
Two pairs of stainless steel SS6 splice plates with SS6 hardware included.  
† Denotes molded fitting available.

Standard rung spacing for fittings is 9". For other types of splice plates, see page 51.

Dimensions for reference only, when critical contact factory. Consult factory for availability of molded fittings.