

Installation instructions

1. Fasten the mounting bracket to the junction box using the two screws provided. The threaded nipple should be facing the outward direction.
2. Make the proper connections. The fixture is made for 6 or 12 VDC (see lamp voltage on marking). Connect the lamp wires to de DC supply wires.
3. Place the fixture against the mounting surface allowing the threaded nipple to pass through the fixture back plate. Secure with the lock nut and the cap nut provided.
4. Install the light bulb(s) Caution. Refer to the relamping label located near the lamp holder or the recommended maximum wattage. Do not exceed recommended wattage.
5. Secure the lens and decorative cover to the fixture with the screws provided.
6. Turn on DC power and check the operation of your lighting fixture.

Adjusting the lamps

The heads can be adjusted in two ways: by rotating it, and by tilting it.

Rotation: To rotate the heads, hold it and turn it either sides.
Tilt: To tilt the head, hold it and tilt upwards or downwards.

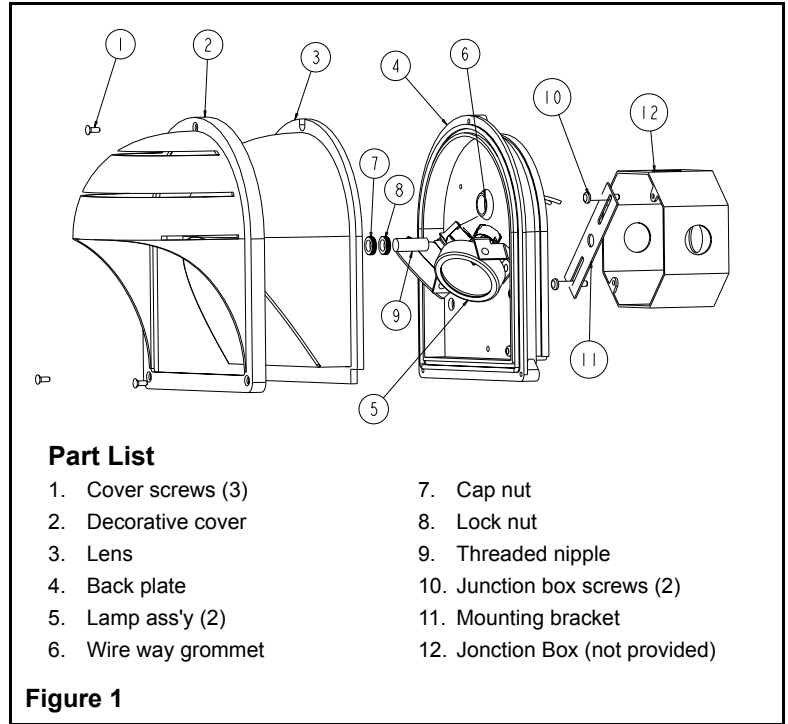

Part List

- | | |
|---------------------|---------------------------------|
| 1. Cover screws (3) | 7. Cap nut |
| 2. Decorative cover | 8. Lock nut |
| 3. Lens | 9. Threaded nipple |
| 4. Back plate | 10. Junction box screws (2) |
| 5. Lamp ass'y (2) | 11. Mounting bracket |
| 6. Wire way grommet | 12. Jonction Box (not provided) |

Figure 1

Installation instructions

1. Fasten the mounting bracket to the junction box using the two screws provided. The threaded nipple should be facing the outward direction.
2. Make the proper connections. The fixture is made for 6 or 12 VDC (see lamp voltage on marking). Connect the lamp wires to de DC supply wires.
3. Place the fixture against the mounting surface allowing the threaded nipple to pass through the fixture back plate. Secure with the lock nut and the cap nut provided.
4. Install the light bulb(s) Caution. Refer to the relamping label located near the lamp holder or the recommended maximum wattage. Do not exceed recommended wattage.
5. Secure the lens and decorative cover to the fixture with the screws provided.
6. Turn on DC power and check the operation of your lighting fixture.

Adjusting the lamps

The heads can be adjusted in two ways: by rotating it, and by tilting it.

Rotation: To rotate the heads, hold it and turn it either sides.
Tilt: To tilt the head, hold it and tilt upwards or downwards.

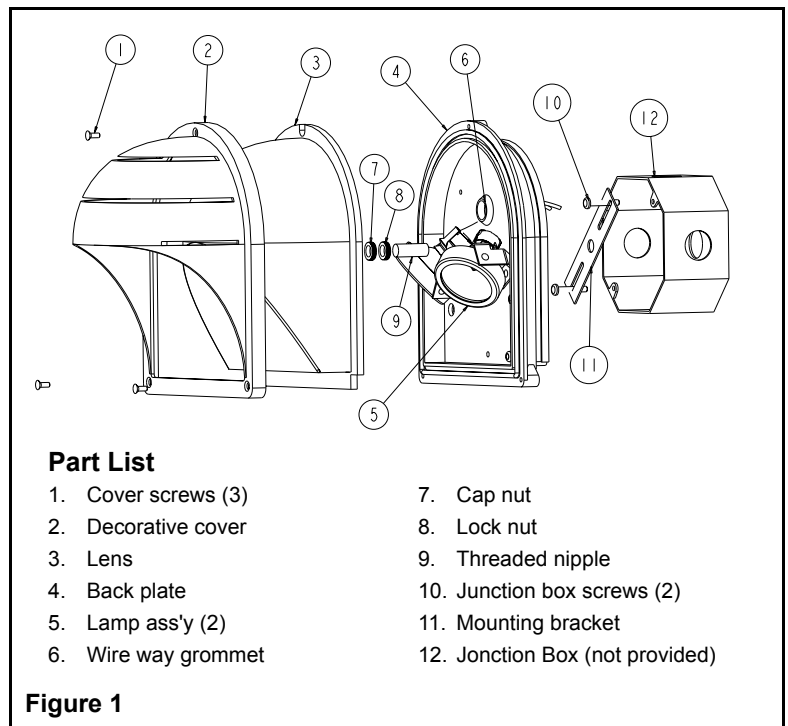

Part List

- | | |
|---------------------|---------------------------------|
| 1. Cover screws (3) | 7. Cap nut |
| 2. Decorative cover | 8. Lock nut |
| 3. Lens | 9. Threaded nipple |
| 4. Back plate | 10. Junction box screws (2) |
| 5. Lamp ass'y (2) | 11. Mounting bracket |
| 6. Wire way grommet | 12. Jonction Box (not provided) |

Figure 1