

## Pipe straps, pipe and conduit clamps and hangers

### Design loads

Where design loads are indicated, they provide for a safety factor of 3 in conformance with the American Standard Code for Pressure Piping.

### Hanger design

Pipe hangers are of advanced design to be user friendly.

### Finishes and special materials

The standard finish is electrogalvanized (EGC) or GoldGalv®. Some products are offered in aluminum and stainless steel where noted.

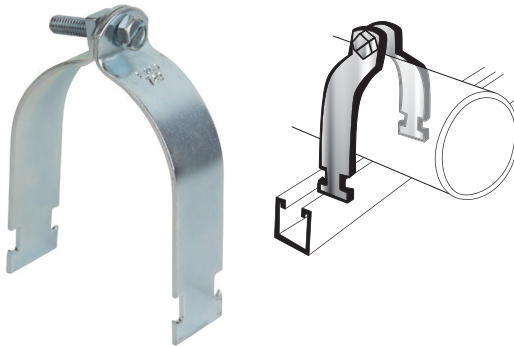

### 701 O.D. Pipe and conduit clamp

Machine screw and nut included.

### Standard finishes and materials

- PG Pregalvanized (i.e. 701-045PG)
- AL Aluminum (i.e. 701-045AL) with zinc-plated hardware
- SS6 Stainless steel type 316 (i.e. 701-045SS6)

Cat. no.	O.D. of pipe		Rigid	EMT	Std.
	(in.)	(mm)	conduit (in.)	conduit (in.)	
701-045PG	0.36-0.45	9-11.5	-	-	9 10
701-055PG	0.46-0.55	11.5-14	-	-	10 10
701-065PG	0.56-0.65	14-17	-	-	11 10
701-075PG	0.66-0.75	17-19.5	-	½	13 10
701-088PG	0.76-0.88	19.5-22.5	½	-	15 10
701-100PG	0.89-1.00	22.5-25.4	-	¾	16 10
701-113PG	1.01-1.13	25.5-29	¾	-	17 10
701-126PG	1.14-1.26	29-32	-	1	18 10
701-140PG	1.27-1.40	32-36	1	-	18 10
701-153PG	1.41-1.53	36-39	-	1¼	19 10
701-167PG	1.54-1.67	39-42.5	1¼	-	20 10
701-180PG	1.68-1.80	42.5-46	-	1½	23 10
701-193PG	1.81-1.93	46-49	1½	-	26 10
701-204PG	1.93-2.04	49-52	-	-	30 10
701-225PG	2.10-2.25	53-57.5	-	2	32 10
701-237PG	2.26-2.37	57.5-60	2	-	34 10
701-245PG	2.33-2.45	59.95-62.5	-	-	36 10
701-257PG	2.46-2.57	62.5-65.5	-	-	38 10
701-287PG	2.75-2.87	70-73	2½	2½	40 10
701-294PG	2.88-2.94	73-75	-	-	42 10
701-306PG	2.95-3.06	75-78	-	-	42.5 10
701-319PG	3.07-3.19	78-81	-	-	43 10
701-350PG	3.36-3.50	85.5-89	3	3	45 10
701-356PG	3.51-3.56	89-90	-	-	46 10
701-379PG	3.70-3.79	94-96.5	-	-	48 10
701-400PG	3.80-4.00	96.5-101.5	3½	3½	49 10
701-450PG	4.25-4.50	108-114	4	4	70 10
701-556PG	5.25-5.56	121-141	5	5	75 5
701-665PG	6.25-6.65	146-170	6	6	80 5
701-876PG	8.50-8.75	197-222	8	8	85 5

# Pipe straps, pipe and conduit clamps and hangers

## Conduit and cable clamps

### 703 Universal clamp



Cat. no.	EMT/rigid (in.)	Conduit O.D.	Material thickness (gauge)	Wt./C lb	Std. ctn.
703-1/2EG	½	0.706–0.840	16	13	100
703-3/4EG	¾	0.932–1.050	14	14	100
703-1EG	1	1.163–1.315	14	15	100
703-1-1/4EG	1¼	1.508–1.660	14	18	50
703-1-1/2EG	1½	1.738–1.900	14	28	50
703-2EG	2	2.195–2.375	14	29	50

Diagram

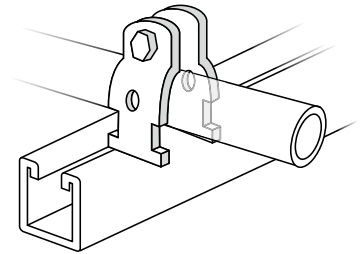

Standard finishes – GoldGalv® (i.e.) 703-1/2  
 Electrogalvanized (EG suffix) (i.e.) 703-1-1/2EG  
 One size fits both rigid and electric metal tubing (EMT).  
 Individually assembled with screw and nut.

### Quik Clamp II™



Cat. no.	Dimension Trade size in. (mm)	Dimension A EMT in. (mm)	Dimension A rigid conduit in. (mm)	Quantity per box	Wt./C lb	Design load 1 static load limit lb (kg)	Design load 2 lb (kg)	Design load 3 lb (kg)
TBQC050	½ (12.7)	½ (12.7)	½ (12.7)	100	10	200 (90)	50 (23)	50 (23)
TBQC075	¾ (19.05)	¾ (19.05)	¾ (19.05)	100	12	200 (90)	50 (23)	50 (23)
TBQC100	1 (44.5)	1 (44.5)	1 (44.5)	100	13	200 (90)	50 (23)	50 (23)
TBQC125	1 ¼ (31.75)	1 ¼ (31.75)	1 ¼ (31.75)	50	15	200 (90)	50 (23)	50 (23)
TBQC150	1 ½ (38.1)	1 ½ (38.1)	1 ½ (38.1)	50	16	200 (90)	50 (23)	50 (23)
TBQC200	2 (50.8)	2 (50.8)	2 (50.8)	50	19	200 (90)	50 (23)	50 (23)
TBQC250	2 ½ (63.5)	2 ½ (63.5)	2 ½ (63.5)	25	29	350 (158)	50 (23)	50 (23)
TBQC300	3 (76.2)	3 (76.2)	3 (76.2)	25	34	350 (158)	50 (23)	50 (23)
TBQC350	3 ½ (88.9)	3 ½ (88.9)	3 ½ (88.9)	25	38	350 (158)	50 (23)	50 (23)
TBQC400	4 (101.6)	4 (101.6)	4 (101.6)	25	42	350 (158)	50 (23)	50 (23)

Diagrams

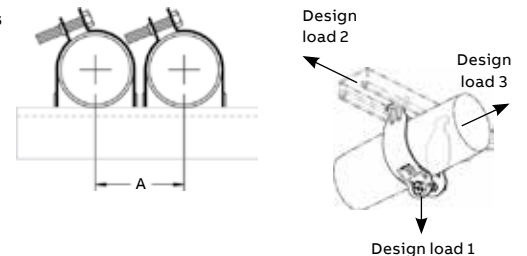

Design load 1 has a safety factor of 4.  
 Design loads 2 and 3 have a safety factor of 1.  
 Standard material electrogalvanized steel.

## Pipe straps, pipe and conduit clamps and hangers

### Conduit and cable clamps



Cobra® clamp



Cat. no.	Rigid EMT cond. trade size (in.)		Cable O.D. range (in.)	Static load limit (lb) safety factor = 4	Qty. per box	Wt./C lb	Torque value (in.-lb)	Design load 1		
	size (in.)	size (in.)						Static load limit (lb) (kg)	Design load 2 (lb) (kg)	Design load 3 (lb) (kg)
CPC025	¼	¼	0.312–0.600	200	100	8	35	200 (91)	50 (23)	50 (23)
CPC050	½	½	0.650–0.890	200	100	10	35	200 (91)	50 (23)	50 (23)
CPC075	¾	¾	0.860–1.110	200	100	12	35	200 (91)	50 (23)	50 (23)
CPC100	1	1	1.100–1.400	200	100	14	35	200 (91)	50 (23)	50 (23)
CPC125	1¼	1¼	1.400–1.725	200	50	16	35	200 (91)	50 (23)	50 (23)
CPC150	1½	1½	1.690–1.980	200	50	18	35	200 (91)	50 (23)	50 (23)
CPC200	2	2	1.980–2.576	200	50	24	35	200 (91)	50 (23)	50 (23)
CPC250	2½	2½	2.576–3.060	350*	25	36	35	350 (159)	50 (23)	50 (23)
CPC300	3	3	3.060–3.626	350*	25	42	35	350 (159)	50 (23)	50 (23)
CPC350	3½	3½	3.626–4.126	350*	25	46	35	350 (159)	50 (23)	50 (23)
CPC400	4	4	4.126–4.626	350*	25	50	35	350 (159)	50 (23)	50 (23)

Diagram

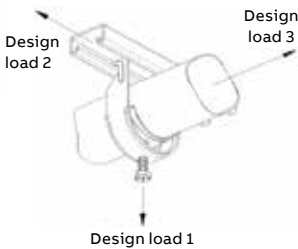

\* Aluminum product has a static load of 250 lb  
 Standard material is commercial-grade, bright electrogalvanized steel.  
 Aluminum: Add the suffix AL to the catalogue number (i.e. CPC050AL)  
 Stainless steel: Add the suffix SS6 to catalogue number (i.e.: CPC050SS6). Stainless steel bolt head is hexagonal and slotted only.



Loc-King Cobra™ clamp

- Superior design load capabilities for heavy-duty applications
- Pre-set torque prevents over-tightening
- Anti-vibration nut
- Steel construction with GoldGalv® finish



Cat. no.	Rigid EMT cond. trade size (in.)		Cable O.D. range (in.)	Static load limit (lb) safety factor = 4	Qty. per box	Wt./C lb	Torque value (in.-lb)	Design load 1		
	size (in.)	size (in.)						Static load limit (lb) (kg)	Design load 2 (lb) (kg)	Design load 3 (lb) (kg)
LKCPC050	½	½	0.650–0.890	100	15	10	35	300 (136)	50 (23)	50 (23)
LKCPC075	¾	¾	0.860–1.110	100	16	12	35	300 (136)	50 (23)	50 (23)
LKCPC100	1	1	1.100–1.400	50	19	14	35	300 (136)	50 (23)	50 (23)
LKCPC125	1¼	1¼	1.400–1.725	50	23	16	35	300 (136)	50 (23)	50 (23)
LKCPC150	1½	1½	1.690–1.980	50	27	18	35	300 (136)	50 (23)	50 (23)
LKCPC200	2	2	1.980–2.576	50	38	24	35	300 (136)	50 (23)	50 (23)
LKCPC250	2½	2½	2.576–3.060	25	44	36	35	450 (204)	50 (23)	50 (23)
LKCPC300	3	3	3.060–3.626	25	53	42	35	450 (204)	50 (23)	50 (23)
LKCPC350	3½	3½	3.626–4.126	25	58	46	35	450 (204)	50 (23)	50 (23)
LKCPC400	4	4	4.126–4.626	25	66	50	35	450 (204)	50 (23)	50 (23)

Diagram

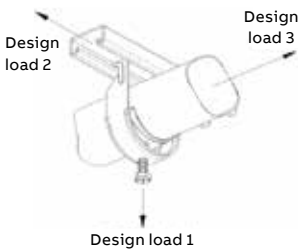

## Pipe straps, pipe and conduit clamps and hangers

### Conduit and cable clamps

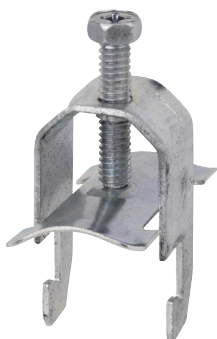

**CH118 Heavy-duty cable clamp**

Diagram	Cat. no.	O.D. of cable or pipe		Rigid cond. (in.)	EMT cond. (in.)	WT./C. lb
		(in.)	(mm)			
	CH118-055EG	0.40-0.55	10-14	-	-	8
	CH118-081EG	0.50-0.81	13-21	1/2	1/2	9
	CH118-110EG	0.70-1.10	18-28	3/4	3/4	17
	CH118-125EG	0.85-1.25	22-27	3/4	1	18
	CH118-135EG	1.00-1.35	26-36	1	1	19
	CH118-175EG	1.33-1.75	34-44	1 1/4	1 1/4	21
	CH118-205EG	1.65-2.05	42-52	1 1/2	1 1/2	24
	CH118-250EG	2.12-2.50	54-64	2	2	48
	CH118-300EG	2.60-3.00	66-76	2 1/2	2 1/2	54
	CH118-325EG	2.75-3.25	70-82	-	-	65
	CH118-375EG	3.25-3.75	82-94	3	3	105
	CH118-425EG	3.75-4.25	94-110	3 1/2	3 1/2	113
	CH118-475EG	4.25-4.75	110-120	4	4	124

Available in double or triple configurations.

**Example: Double – CH128-047EG**

**Triple – CH138-047EG**

Standard finishes – Electrogalvanized (EG)

Stainless steel type 316 clamp comes with type 304 stainless steel hardware.

**CB118 Counterbed**  
**EB118 Extended bed**  
**DB118 Double bed**

Diagrams	Cat. no.	Wt./C. lb	
	<b>Counterbed</b>		
	CB118-055PG	1	
	CB118-090PG	2	
	CB118-110PG	3 1/2	
	CB118-140PG	4	
	CB118-175PG	4 1/2	
	CB118-200PG	5	
	CB118-250PG	11	
	CB118-300PG	13	
	<b>Extended bed</b>		
	EB118-047PG	4	
	EB118-055PG	4 1/2	
	EB118-090PG	6	
EB118-110PG	13 1/2		
EB118-140PG	16		
EB118-175PG	17		
EB118-200PG	20		
EB118-250PG	30		
EB118-300PG	38		
<b>Double bed</b>			
DB118-047PG	2		
DB118-055PG	2		
DB118-070PG	3		

Standard finish – Pregalvanized (PG)

## Pipe straps, pipe and conduit clamps and hangers

### Conduit and cable clamps



#### A716 Snap-Guard® cushioned clamp tube series

#### P716 Snap-Guard® cushioned clamp pipe series

- Assembly consisting of GoldGalv® finish steel clamp with bolt/locknut and cushion
- Secure pipes, tubes and hoses for fluid conductors
- Installation is easy and requires no more time than a simple pipe clamp installation
- Cushion absorbs the shocks and associated vibrations from fluid surges in tubes, pipes and hoses
- It can handle temperatures from 149 °C to -40 °C (300 °F to -40 °F)
- Cushioned clamp assemblies are available individually bagged

Diagram	Assembly cat. no.	Tubing		Assembly cat. no.	Standard pipe		
		Tube O.D. (in.)	Wt./C lb		Nominal pipe size (in.)	Std. ctn.	Wt./C lb
	A716-1/4	¼	10	P716-1/4	¼	25	10
	A716-3/8	⅜	14	P716-3/8	⅜	25	14
	A716-1/2	½	16	P716-1/2	½	25	16
	A716-5/8	⅝	16	P716-3/4	¾	25	18
	A716-3/4	¾	18	P716-1	1	25	22
	A716-7/8	⅞	18	P716-1-1/4	1¼	25	27
	A716-1	1	22	P716-1-1/2	1½	10	36
	A716-1-1/8	1⅛	24	P716-2	2	10	43
	A716-1-1/4	1¼	27	P716-2-1/2	2½	10	49
	A716-1-3/8	1⅜	27	P716-3	3	10	60
	A716-1-1/2	1½	36	P716-3-1/2	3½	10	62
	A716-1-5/8	1⅝	37	P716-4	4	10	94
	A716-1-3/4	1¾	37	-	-	10	-
	A716-1-7/8	1⅞	43	-	-	10	-
	A716-2	2	43	-	-	10	-
	A716-2-1/8	2⅛	44	-	-	10	-
	A716-2-3/8	2⅜	49	-	-	10	-
	A716-2-5/8	2⅝	53	-	-	10	-
	A716-3-1/8	3⅛	62	-	-	10	-
	A716-4-1/8	4⅛	94	-	-	10	-

## Pipe straps, pipe and conduit clamps and hangers

### Conduit and cable clamps

#### U716 Two-hole cushioned clamp

- Guides, protects and uniformly spaces line runs. Low cost, time saving method of attaching tubing and hose to equipment.
- Cushion is built to withstand the effects of most oils, chemical and industrial cleaning compounds, in temperatures from -45 °C to 121 °C (-50 °F to 275 °F). Interlock edge ensures cushion remains in place.
- Attached with two standard fasteners to any flat surface, this clamp eliminates the use of special channels, providing a savings in both space requirements and cost
- Cushioned clamps reduce vibration, shock and noise in fluid systems and eliminates electrolysis

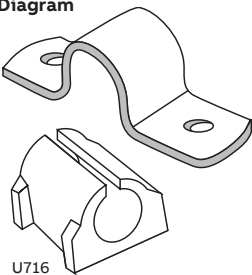
	Assembly cat. no.	Copper and steel tubing O.D. (in.)	Copper water pipe (nom.) (in.)	Normal pipe size (in.)	Std. ctn.	Wt./C lb
<b>Diagram</b>  U716	U716-1/4	3/4	–	–	25	3
	U716-3/8	3/8	3/4	–	25	4
	U716-1/2	1/2	3/8	3/4	25	6
	U716-5/8	5/8	1/2	3/8	25	6
	U716-3/4	3/4	5/8	–	25	7
	U716-7/8	7/8	3/4	1/2	25	7
	U716-1	1	–	–	25	8
	U716-1-1/8	1-1/8	1	–	25	8
	U716-1-1/4	1-1/4	–	–	10	17
	U716-1-3/8	1-3/8	1 1/4	–	10	20
	U716-1-1/2	1-1/2	–	–	10	22
	U716-1-5/8	1-5/8	1 1/2	–	10	23
	U716-2	2	–	–	10	41
	U716-2-1/8	2-1/8	–	–	10	41
	U716-2-3/8	2-3/8	–	–	10	44

Standard finish – GoldGalv®

## Pipe straps, pipe and conduit clamps and hangers

### Conduit and cable clamps

#### 6H series conduit and pipe hanger

##### Features

- Accommodates ½ in. through 4 in. EMT or rigid conduit
- Can be used for either vertical or horizontal installation
- 6HTB Series have a built-in nut so there are fewer parts to handle or drop
- Installs easily with a screwdriver

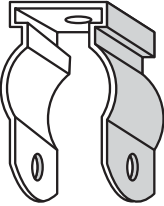
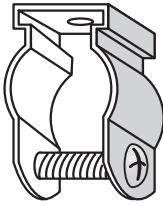
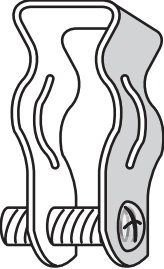
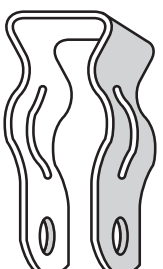
Diagrams	Cat. no.	Conduit size		Wt./C. lb
		Rigid (in.)	EMT (in.)	
 <p>6H Series</p>	6H0	¾–½	½	5
	6H0-B	¾–½	½	7
 <p>6H-B Series with bolt and hex nut</p>	6H0-T	¾–½	½	5
	6H0-TB	¾–½	½	6
 <p>6H-TB Threaded series</p>	6H1	¾	¾	6
	6H1-B	¾	¾	7
	6H1-T	¾	¾	6
	6H1-TB	¾	¾	7
 <p>6H-T Threaded series</p>	6H2	1	1	7
	6H2-B	1	1	9
	6H2-1/2	–	1¼	8
	6H2-1/2-B	–	1¼	10
	6H3-SC	1¼	1½	8
	6H3-B	1¼	1½	10
	6H3-TB	1¼	1½	10
	6H4	1½	–	17
	6H4-B	1½	–	19
	6H4-TB	1½	–	19
	6H5	2	2	24
	6H5-B	2	2	26
	6H5-TB	2	2	26
	6H6	2½	2½	28
	6H6-B	2½	2½	30
	6H7	3	3	36
	6H7-B	3	3	38
	6H8	3½	3½	39
	6H8-B	3½	3½	41
	6H9	4	4	44
	6H9-B	4	4	47

Standard finish – Electrogalvanized (no suffix)

## Pipe straps, pipe and conduit clamps and hangers

### Conduit and cable clamps



When fastening wire bundles, cables or hoses to framing channels, you can cut costs considerably by using this mounting base. It is made of smooth, weather-resistant nylon and designed to protect cable insulation and hoses from the wear or damage that can occur with metal clamps. The mounting base may be used for both indoor or outdoor applications. It installs in the framing channel with a simple push and twist. It requires

no screws, nuts or tools. The mounting base fits all 1½ in. and 1¾ in. channels regardless of channel depth. Ty-Rap® and Ty-Fast® cable ties can be ordered separately.

- Installs with a push and twist
- Designed for indoor or outdoor use
- Smooth design protects cable insulation
- Takes range of cable diameters

Cat. no.	Channel size (in.)	Maximum tie width accom. (in.)	Unit qty.	Std. pkg.
TC5363X	1½ and 1¾	0.301	50	250

#### Installation

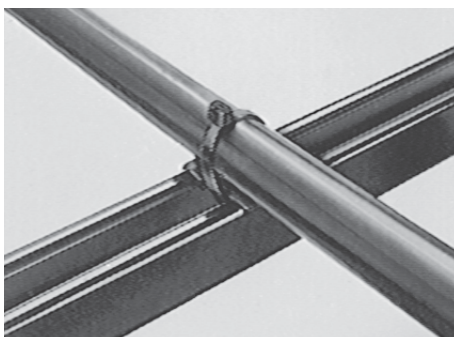
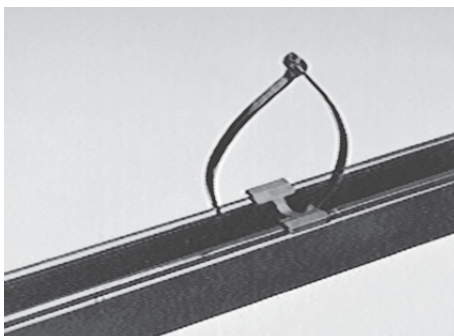
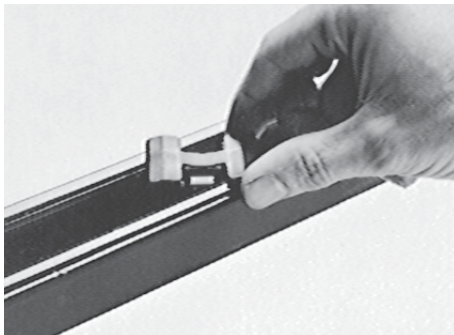



# Pipe straps, pipe and conduit clamps and hangers

## Conduit and cable clamps

**WS716 Maple hardwood saddle**  
Std. pack 10

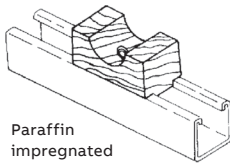

Paraffin impregnated maple.

Cat. no.	Dimensions						
	Hardwood paraffin imp.	Depth (in.)	Depth (mm)	Width (in.)	Width (mm)	Height (in.)	Height (mm)
WS716-3/4	3/4	19.0	3	76.2	1 3/4	44.4	
WS716-1	1	25.4	3	76.2	1 3/4	44.4	
WS716-1-1/4	1 1/4	31.7	3 1/2	88.9	2	50.8	
WS716-1-1/2	1 1/2	38.1	3 1/2	88.9	2	50.8	
WS716-1-3/4	1 3/4	44.4	4	101.6	2 1/4	57.1	
WS716-2	2	50.8	4	101.6	2 1/4	57.1	
WS716-2-1/4	2 1/4	57.1	4 1/2	114.3	2 1/2	63.5	
WS716-2-1/2	2 1/2	63.5	4 1/2	114.3	2 1/2	63.5	
WS716-2-3/4	2 3/4	69.8	5	127	2 3/4	69.8	
WS716-3	3	76.2	5	127	2 3/4	69.8	
WS716-3-1/4	3 1/4	82.5	5 1/2	139.7	2 3/4	76.2	
WS716-3-1/2	3 1/2	88.9	5 1/2	139.7	3	76.	
WS716-3-3/4	3 3/4	95.2	6	152.4	3 1/4	82.5	
WS716-4	4	101	6	152.4	3 1/4	82.5	
WS716-4-1/2	4 1/2	114.3	6 1/2	165.1	3 1/2	88.9	
WS716-5	5	127	7	177.8	3 3/4	95.2	
WS716-5-1/2	5 1/2	139.7	7 1/2	190.5	4	101.6	
WS716-6	6	152.4	8	203.2	4 1/4	107.9	
WS716-6-1/2	6 1/2	165.1	8 1/2	215.9	4 1/2	114.3	
WS716-7	7	177.8	9	228.6	4 3/4	120.6	

Diagram

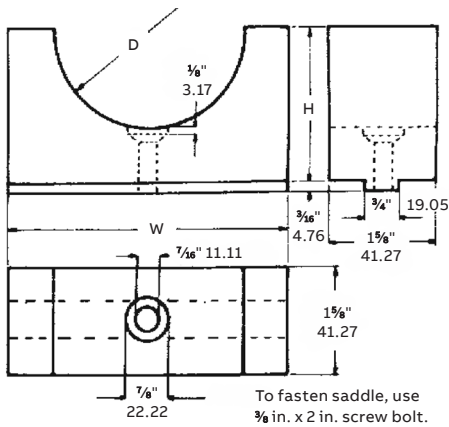

## Pipe straps, pipe and conduit clamps and hangers

### Conduit and cable clamps

AB880 3 in. Porcelain saddle  
 AB881 4 in. Porcelain saddle



	Cat. no.	A (in.)	Max. cable diam. (in.)	Wt./C lb
Diagram	AB880	3	3	73
	AB881	4	4½	104

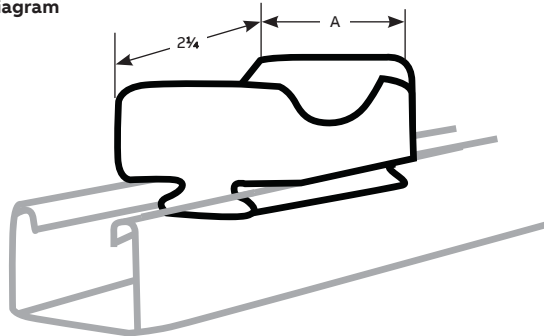

C755 Porcelain cable clamps

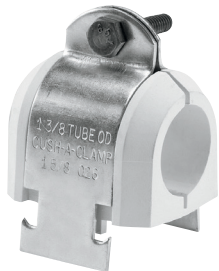

Cat. no.	Hole size (in.)	A (in.)	Wt./C lb	Cat. no.	Hole size (in.)	A (in.)	Wt./C lb
C755-1A	3/8	1 1/16	50	C755-7	3 1/4	5 13/16	340
C755-1B	1/2	1 1/16	50	C755-7A	3 3/8	5 13/16	330
C755-1C	5/8	1 1/16	50	C755-7B	3 1/2	5 13/16	318
C755-2	3/4	2 5/32	91	C755-7C	3 5/8	5 13/16	387
C755-2A	7/8	2 5/32	90	C755-8	3 3/4	6 7/8	565
C755-2B	1	2 5/32	85	C755-8A	3 7/8	6 7/8	550
C755-2C	1 1/8	2 5/32	82	C755-8B	4	6 7/8	535
C755-3	1 1/4	2 5/8	114	C755-8C	4 1/8	6 7/8	520
C755-3A	1 3/8	2 5/8	110	C755-8D	4 1/4	6 7/8	490
C755-3B	1 1/2	2 5/32	105	C755-8E	4 3/8	6 7/8	475
C755-3C	1 5/8	2 5/8	102	C755-8F	4 1/2	6 7/8	460
C755-4	1 3/4	3 3/4	220				
C755-4A	1 7/8	3 3/4	214				
C755-4B	2	3 3/4	205				
C755-4C	2 1/8	3 3/4	200				
C755-5	2 1/4	4 1/4	260				
C755-5A	2 3/8	4 1/4	250				
C755-5B	2 1/2	4 1/4	243				
C755-5C	2 5/8	4 1/4	240				
C755-6	2 3/4	4 3/4	250				
C755-6A	2 7/8	4 3/4	240				
C755-6B	3	4 3/4	230				
C755-6C	3 1/8	4 3/4	220				

Diagram

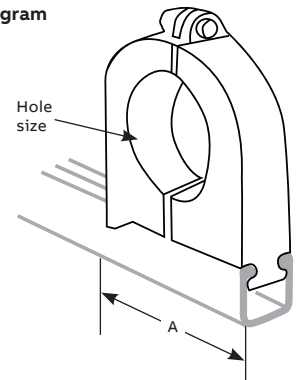

Standard finish – GoldGalv® with bronze hardware  
 Also fits 1 1/2 in. wide channel.  
 For minimum order quantities, contact your Regional Sales Office.

# Pipe straps, pipe and conduit clamps and hangers

## Conduit and cable clamps



For use with 701 O.D. tubing and pipe clamp. To determine 701 clamp size add 1/4 in. to O.D. tube size to allow for the cushioned strip material.

### S716-TB Cushioned strip for isolation and vibration applications

1/4 in. markings for fast measuring and cutting. Measurement chart is printed on back of carton. 20 feet included in each carton. Prevent metal-to-metal contact with the cushioned strip material. It aids in sound insulation, shock

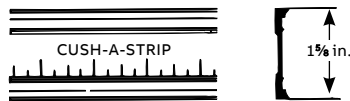

absorption and protects against corrosion, distortion and abrasion. Cushioned strip material is designed for optimal use between -1 °C and 149 °C (30 °F and 300 °F). Cushioned strip material combined with the Superstrut 701 pipe strap can handle clamping assignments from 1/4 in. to 6 in.

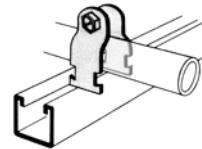

Order 701 clamp separately.

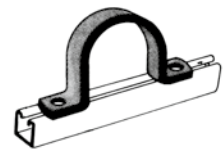

Carbon Steel

### C708U Short strap for channel or wall mounting

	Pipe size (in.)	A (in.)	B (in.)	Thickness (in.)	Width (in.)	Hole size (in.)	Design load lb	Wt./C lb
Diagram	1/2	2 7/8	2	1/8	1 5/8	9/32	650	23
	3/4	3 1/16	2 3/16	1/8	1 5/8	9/32	650	26
	1	3 3/8	2 1/2	1/8	1 5/8	9/32	650	31
	1 1/4	3 11/16	2 13/16	1/8	1 5/8	9/32	650	35
	1 1/2	3 15/16	3 1/16	1/8	1 5/8	9/32	650	39
	2	5 3/4	4 1/8	1/4	1 5/8	7/16	650	94
	2 1/2	6 3/16	4 9/16	1/4	1 5/8	7/16	1,000	114
	3	6 13/16	5 3/16	1/4	1 5/8	7/16	1,000	133
	3 1/2	7 5/16	5 11/16	1/4	1 5/8	7/16	1,000	152
	4	7 13/16	6 3/16	1/4	1 5/8	7/16	1,200	176
	5	8 7/8	7 1/4	1/4	1 5/8	7/16	1,200	198
	6	9 15/16	8 5/16	1/4	1 5/8	7/16	1,200	246

Standard finish – GoldGalv®

Example: C708U-1/2

No clearance between pipe and channel.

## Pipe straps, pipe and conduit clamps and hangers

### Conduit and cable clamps



Standard

C711 "J" Pipe hanger

Pipe size (in.)	A rod size (in.)	B (in.)	C (in.)	Overall dimension D (in.)	E (in.)	F (in.)	Bolt size (in.)	G (in.)	Thickness	Width (in.)	Max. rec. load lb	Approx. Wt./C lb
1/2	3/8	2 5/8	1 3/4	7/16	1 1/2	1 15/16	1/4	3 3/32	12 ga	3/4	400	18
3/4	3/8	2 7/8	1 7/8	7/16	1 11/16	2 1/8	1/4	3 1/2	12 ga	3/4	400	21
1	3/8	2 15/16	1 15/16	7/16	1 13/16	2 5/16	1/4	3 11/16	12 ga	3/4	400	22
1 1/4	3/8	3 1/4	2	7/16	2 1/16	2 5/8	1/4	4 1/8	12 ga	3/4	400	25
1 1/2	3/8	3 9/16	2 3/16	7/16	2 7/16	2 7/8	1/4	4 5/8	12 ga	3/4	400	27
2	3/8	3 11/16	2 1/8	7/16	2 9/16	3 1/16	1/4	5	12 ga	3/4	400	29
2 1/2	1/2	4 7/16	2 7/16	9/16	3 3/16	3 5/8	3/8	6	12 ga	1 1/4	500	64
3	1/2	4 13/16	2 9/16	9/16	3 1/2	4 1/16	3/8	6 21/32	12 ga	1 1/4	500	72
3 1/2	1/2	5 1/8	2 5/8	9/16	3 3/4	4 3/8	3/8	7 1/16	3/16	1 1/4	500	84
4	5/8	6 1/8	3 3/16	9/16	4 5/8	5 5/16	3/8	8 9/16	3/16	1 1/4	550	138
5	5/8	6 3/4	3 1/4	9/16	5 1/16	5 5/8	3/8	9 23/32	3/16	1 1/4	550	162
6*	3/4	7 3/4	3 9/16	9/16	5 13/16	6 5/8	3/8	11 1/4	3/16	1 1/4	600	249
8*	7/8	9 3/16	3 11/16	9/16	6 15/16	8	3/8	13 11/16	3/16	1 1/4	760	291

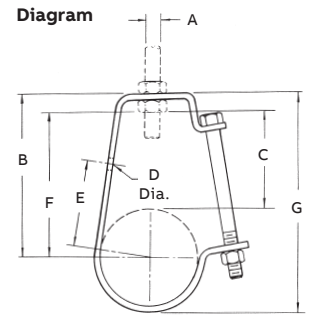

\*Hangers 6 in. and over have hole instead of slot.

Standard finishes – GoldGalv®, electrogalvanized (EG)

Complies with specification MSS SP69, Type 5. Hole provided for side mounting to wall as bracket.

Example: C711-1/2

## Pipe straps, pipe and conduit clamps and hangers

### Conduit and cable clamps



**C727 Adjustable ring**

Tube size (in.)	Rod size (in.)	A (in.)	B (in.)	C (in.)	Thickness	Width (in.)	Approx max. rec. load	Wt./C lb
½	⅜	3⅜	2⅝	1⅜	16 ga	1	400	9
¾	⅜	3⅜	2½	1⅝	16 ga	1	400	9
1	⅜	3⅜	2⅝	1⅝	16 ga	1	400	9
1¼	⅜	3¾	2⅞	1⅝	16 ga	1	400	10
1½	⅜	3⅞	2⅞	1	16 ga	1	400	11
2	⅜	4¼	3	1	16 ga	1	400	12
2½	½*	5¾	4¼	1⅝	14 ga	1⅜ <sub>16</sub>	600	28
3	½*	6	4⅝	1¼	14 ga	1⅜ <sub>16</sub>	600	30
3½	½*	7⅜	5¼	2⅝	14 ga	1⅜ <sub>16</sub>	600	34
4	⅝*	7⅞	5	2⅝	14 ga	1¼	1,000	37
5	⅝*	9	6⅝	2¼	14 ga	1¼	1,250	83
6	¾**	9⅜	6½	1⅝	14 ga	1¼	1,250	95

**Diagram**

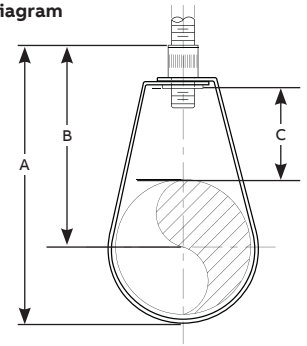

\*⅜ in. nut is used when NFPA rod sizing is requested.

\*\*½ in. nut is used when NFPA rod sizing is requested.

Standard finish – Pregalvanized (no suffix)

Carbon steel. For suspension of non-insulated pipe lines. Complies with specification MSS SP69, Type 10.

**Example: C727-1/2**

## Pipe straps, pipe and conduit clamps and hangers

### Pipe hangers

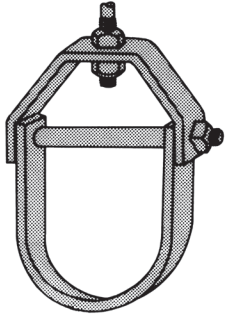

**C710 Adjustable clevis hanger**

Pipe size (in.)	Size of steel (in.)		A (in.)	B (in.)	C (in.)	D (in.)	E (in.)	F (in.)	Max. rec. load, lb	Wt./C lb
	Upper	Lower								
½	½ x 1	½ x 1	¾	1 <sup>11</sup> / <sub>16</sub>	2 <sup>1</sup> / <sub>8</sub>	2 <sup>1</sup> / <sub>2</sub>	7 <sup>7</sup> / <sub>16</sub>	7 <sup>1</sup> / <sub>16</sub>	610	30
¾	½ x 1	½ x 1	¾	1 <sup>7</sup> / <sub>8</sub>	2 <sup>7</sup> / <sub>16</sub>	2 <sup>1</sup> / <sub>2</sub>	1	½	610	32
1	½ x 1	½ x 1	¾	2 <sup>1</sup> / <sub>8</sub>	2 <sup>13</sup> / <sub>16</sub>	2 <sup>1</sup> / <sub>2</sub>	1 <sup>1</sup> / <sub>4</sub>	¾	610	36
1¼	½ x 1	½ x 1	¾	2 <sup>9</sup> / <sub>16</sub>	3 <sup>7</sup> / <sub>16</sub>	2 <sup>1</sup> / <sub>2</sub>	1 <sup>3</sup> / <sub>4</sub>	7 <sup>7</sup> / <sub>16</sub>	610	42
1½	½ x 1	½ x 1	¾	3	4	2 <sup>1</sup> / <sub>2</sub>	2 <sup>1</sup> / <sub>8</sub>	1 <sup>1</sup> / <sub>16</sub>	610	55
2	½ x 1	½ x 1	¾	3 <sup>11</sup> / <sub>16</sub>	4 <sup>7</sup> / <sub>8</sub>	2 <sup>1</sup> / <sub>2</sub>	2 <sup>13</sup> / <sub>16</sub>	1 <sup>5</sup> / <sub>8</sub>	610	60
2½	¾ x 1¼	¾ x 1¼	½	4 <sup>11</sup> / <sub>16</sub>	6 <sup>1</sup> / <sub>8</sub>	3	3 <sup>13</sup> / <sub>16</sub>	2	1,130	115
3	¾ x 1¼	¾ x 1¼	½	4 <sup>3</sup> / <sub>4</sub>	6 <sup>9</sup> / <sub>16</sub>	3	3 <sup>7</sup> / <sub>8</sub>	1 <sup>3</sup> / <sub>4</sub>	1,130	132
3½	¾ x 1¼	¾ x 1¼	½	4 <sup>15</sup> / <sub>16</sub>	6 <sup>15</sup> / <sub>16</sub>	3	4 <sup>1</sup> / <sub>16</sub>	1 <sup>3</sup> / <sub>4</sub>	1,130	156
4	¾ x 1¼	¾ x 1¼	5 <sup>7</sup> / <sub>8</sub>	5 <sup>9</sup> / <sub>16</sub>	7 <sup>13</sup> / <sub>16</sub>	3½	4 <sup>1</sup> / <sub>2</sub>	1 <sup>15</sup> / <sub>16</sub>	1,430	190
5	¾ x 1¼	¾ x 1¼	5 <sup>7</sup> / <sub>8</sub>	6 <sup>3</sup> / <sub>16</sub>	9	3½	5 <sup>5</sup> / <sub>8</sub>	1 <sup>3</sup> / <sub>4</sub>	1,430	240
6	¾ x 1½	¾ x 1½	¾	6 <sup>13</sup> / <sub>16</sub>	10 <sup>5</sup> / <sub>8</sub>	4	5 <sup>5</sup> / <sub>8</sub>	1 <sup>7</sup> / <sub>8</sub>	1,940	320
8	¾ x 1¾	¾ x 1¾	7 <sup>7</sup> / <sub>8</sub>	8 <sup>7</sup> / <sub>16</sub>	12 <sup>5</sup> / <sub>8</sub>	4¼	7	2 <sup>1</sup> / <sub>8</sub>	1,940	500

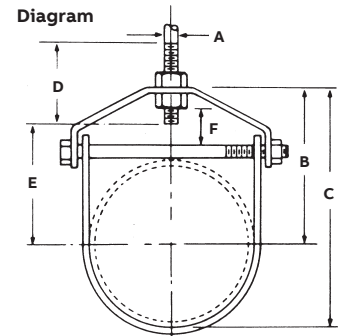

Standard finishes – GoldGalv®, electrogalvanized (EG)

Complies with specification MSS SP69, Type 1.

**Example: C710-1/2EG**

# Pipe straps, pipe and conduit clamps and hangers

## Pipe hangers



CL710 Light-duty adjustable clevis hanger

Pipe size (in.)	Thickness of steel (in.)		A (in.)	B (in.)	C (in.)	D (in.)	E (in.)	F (in.)	Max. rec. load, lb	Wt./C lb
	Upper	Lower								
3/8	16 ga. x 7/8	16 ga. x 7/8	3/8	1 1/8	2 3/16	2 1/2	1 1/4	9/16	150	12
1/2	16 ga. x 7/8	16 ga. x 7/8	3/8	1 3/4	2 3/16	2 1/2	1 1/8	9/16	150	13
3/4	16 ga. x 7/8	16 ga. x 7/8	3/8	1 7/8	2 1/4	2 1/2	1 1/4	1/2	250	15
1	16 ga. x 7/8	16 ga. x 7/8	3/8	2 3/16	2 3/4	2 1/2	1 1/2	3/4	250	18
1 1/4	16 ga. x 7/8	16 ga. x 7/8	3/8	2 5/8	3 3/8	2 1/2	1 3/4	1	250	20
1 1/2	13 ga. x 7/8	13 ga. x 7/8	3/8	3	3 7/8	2 1/2	2 1/4	1 3/16	250	30
2	13 ga. x 7/8	13 ga. x 7/8	3/8	3 3/16	4 3/4	2 1/2	2 13/16	1 5/8	250	38
2 1/2	1/8 x 1 1/4	1/8 x 1 1/4	1/2	4	5 1/2	3	3 1/4	1 3/8	350	80
3	1/8 x 1 1/4	1/8 x 1 1/4	1/2	4 9/16	6 1/2	3	3 9/16	1 1/2	350	89
3 1/2	1/8 x 1 1/4	1/8 x 1 1/4	1/2	5	7	3	4 1/8	1 3/4	350	106
4	3/16 x 1 1/4	1/8 x 1 1/4	1/2	5 1/4	7 1/2	3 1/2	4 1/4	1 7/8	400	146
6	1/4 x 1 1/2	3/16 x 1 1/2	3/4	6 13/16	10 3/8	4	5 5/8	1 7/8	1,940	320
8	1/4 x 1 3/4	3/16 x 1 3/4	7/8	8 3/16	12 5/8	4 1/4	7	2 1/8	1,940	500

Diagram

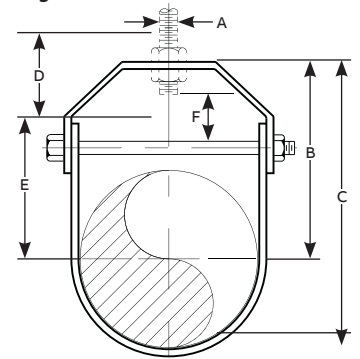

Standard finishes – GoldGalv®, Bare (B), electrogalvanized (EG), fiberglass (FG).

Carbon steel

Used on non-insulated, stationary pipelines. A lock nut above the clevis yoke is required for full rated load.

**Example: CL710-3/8B**

# Pipe straps, pipe and conduit clamps and hangers

## Pipe hangers



**M718 Split pipe ring**

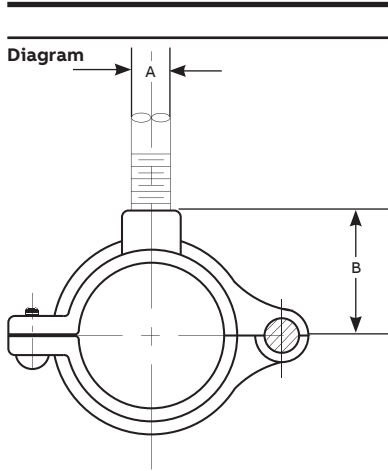

Pipe size (in.)	A (in.)	B (in.)	Max. rec. load, lb	Wt./C approx.
Diagram				
3/8	3/8	1 3/16	180	10
1/2	3/8	7/8	180	13
3/4	3/8	1	180	14
1	3/8	1 1/8	180	16
1 1/4	3/8	1 5/16	180	22
1 1/2	3/8	1 7/16	180	24
2	3/8	1 11/16	180	31
2 1/2	1/2	2 1/8	300	60
3	1/2	2 1/4	300	74
4	1/2	2 15/16	300	116

Standard finishes – Bare (B) or electrogalvanized (EG) malleable iron.  
 For suspension of non-insulated, stationary pipelines.  
**Example: M718-3/8B**

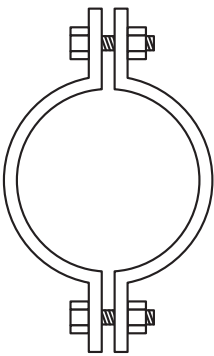

**C725 Medium pipe clamp**

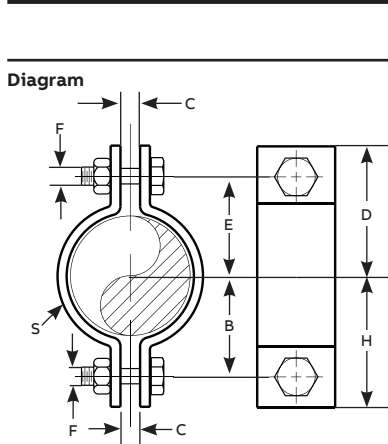

Pipe size (in.)	B (in.)	C (in.)	D (in.)	E (in.)	F (in.)	H (in.)	S (in.)	Max. rec. load, lb	Wt./C approx.
Diagram									
1/2	1	7/16	1 3/8	1	5/16	1 1/2	1/8 x 1	500	29
3/4	1 1/8	7/16	1 3/4	1 1/4	5/16	1 3/4	1/8 x 1	500	32
1	1 1/4	7/16	1 13/16	1 1/4	5/16	1 13/16	1/8 x 1	500	33
1 1/4	1 7/16	7/16	2	1 7/16	5/16	2	1/8 x 1	500	38
1 1/2	1 5/8	1/2	2 1/16	1 1/2	5/16	2 1/4	1/8 x 1	715	39
2	2 1/8	9/16	3 3/8	2 1/4	1/2	3	1/4 x 1	1,040	117
2 1/2	2 5/16	9/16	3 5/16	2 1/2	1/2	3 3/4	1/4 x 1	1,040	128
3	2 3/4	9/16	3 3/4	2 3/4	1/2	3 5/8	1/4 x 1	1,040	140
3 1/2	3 3/8	5/8	3 3/4	3	1/2	3 7/8	1/4 x 1	1,040	145
4	3 5/16	3/4	4 1/4	3 5/16	5/8	4 1/4	1/4 x 1 1/4	1,040	238
6	4 7/8	7/8	5 7/8	5	3/4	5 3/4	3/8 x 1 1/2	1,615	542
8	6	1	7	6 5/8	3/4	6 7/8	3/8 x 1 1/2	1,615	651
10	7 5/16	1	8 3/16	7 1/16	7/8	8 7/16	1/2 x 2	2,490	1,360
12	8 1/4	1	9 3/16	8 7/16	7/8	9 3/8	1/2 x 2	2,490	1,605

Based on the allowable stresses shown in ANSI Code for pressure piping.  
 For sizes 14 to 24, contact your regional sales office.  
 Standard finishes – GoldGalv®, Bare (B), electrogalvanized (EG) carbon steel. For suspension of pipelines where little or no insulation is required.  
 Complies with specification MSS SP69, Type 23.  
**Example: C725-1/2B**



# Pipe straps, pipe and conduit clamps and hangers

## Pipe hangers



**C720 Riser clamp**

Diagram	Pipe size (in.)	A (in.)	Thickness (in.)	Width (in.)	Bolt (in.)	Max. rec. load, lb	Wt./ea. approx.
<p>Standard riser</p>	1/2	9 1/8	3/16	1	3/8 x 1 1/2	220	1,01
	3/4	9 1/4	3/16	1	3/8 x 1 1/2	220	1,06
	1	9 3/8	3/16	1	3/8 x 1 1/2	220	1,07
	1 1/4	9 3/4	1/4	1	3/8 x 1 1/2	250	1,12
	1 1/2	10	1/4	1	3/8 x 1 1/2	250	1,20
	2	10 1/2	1/4	1	3/8 x 1 1/2	300	1,25
	2 1/2	11 1/16	1/4	1	3/8 x 1 1/2	400	1,67
	3	11 13/16	1/4	1	3/8 x 1 1/2	500	1,81
	3 1/2	13	1/4	1	1/2 x 1 1/2	600	2,12
	4	13 1/2	1/4	1	1/2 x 1 1/2	750	2,22
	5	14	1/4	1 1/2	1/2 x 1 3/4	1,500	3,44
	6	15 3/16	1/4	1 1/2	1/2 x 1 3/4	1,600	3,65
8	19	3/8	1 1/2	5/8 x 2 1/2	2,500	7,24	

Standard finishes – GoldGalv®, bare (B)  
 Available in sizes 1/2 in. through 10 in.  
 Complies with specification MSS SP69, Type 8.  
**Example: C720-1-1/2B**

**C726 Double bolt pipe clamp**

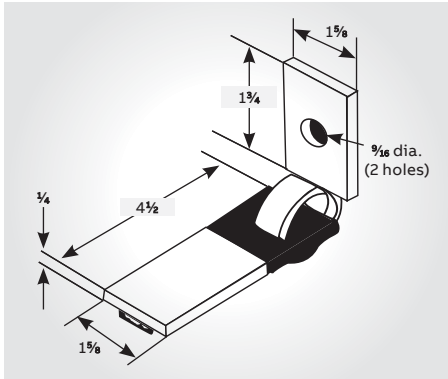

Diagram	Pipe size (in.)	B (in.)	C (in.)	D (in.)	E (in.)	F (in.)	H (in.)	S (in.)	Max. rec. load, lb	Wt./C approx.
	3/4	1 1/16	5/8	3 3/16	2 1/2	3/8	1 11/16	3/16 x 1	950	66
	1	1 1/2	5/8	3 3/4	2 1/2	3/8	2 1/16	3/16 x 1	950	69
	1 1/4	1 1/2	3/4	3 11/16	2 7/8	3/8	2 1/4	3/16 x 1	950	75
	1 1/2	1 13/16	1 1/16	4 7/8	3 3/4	3/8	2 13/16	1/4 x 1 1/4	1,545	181
	2	2 1/4	1 1/16	5 11/16	4 11/16	3/8	3 3/16	1/4 x 1 1/4	1,545	200
	2 1/2	2 5/8	1 1/16	6 1/2	5 3/8	3/8	3 1/2	1/4 x 1 1/4	1,545	232
	3	2 3/4	1 1/16	6 7/8	6	3/8	3 3/4	1/4 x 1 1/4	1,545	258
	3 1/2	3	1 1/16	7 1/16	6 3/16	3/8	4	1/4 x 1 1/4	1,545	264
	4	3 3/8	1 1/16	7 3/8	6 1/2	3/4	4 1/2	3/8 x 2	2,500	750
	5	3 15/16	1 1/16	8 3/8	7	3/4	5	3/8 x 2	2,500	813
	6	4 3/4	1 1/16	9 15/16	8 3/16	1	6 3/8	3/8 x 2 1/2	2,865	1311
	8	5 3/4	1 1/16	10 15/16	9 3/16	1	7 3/8	3/8 x 2 1/2	2,865	1467

Standard finish – bare (B)  
 carbon steel. For the suspension of insulated pipelines.  
 Normally used with weldless eye nut.  
**Example: C726-1/2B**

## Pipe straps, pipe and conduit clamps and hangers

### Seismic bracing



01

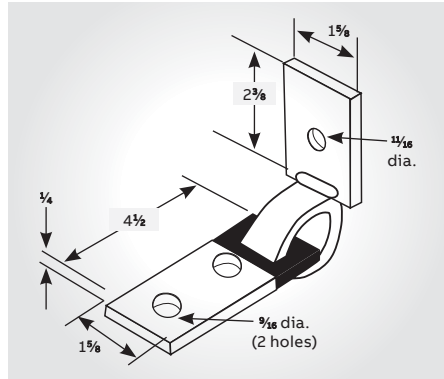

02

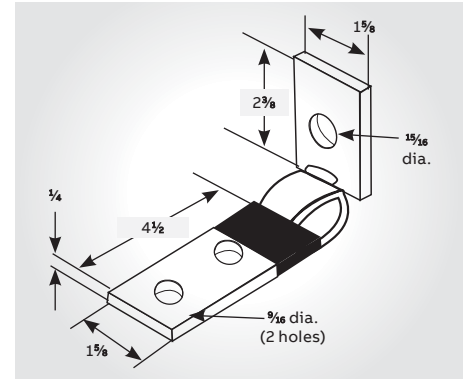

03

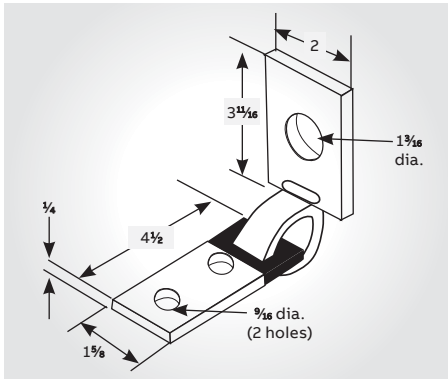

04

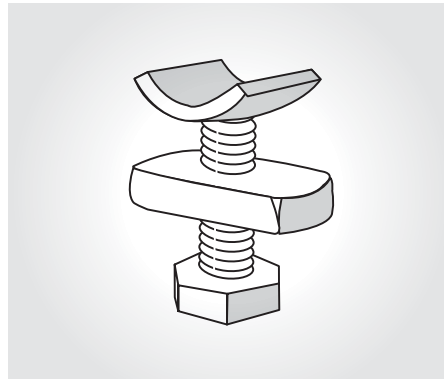

05

01 **C749N Seismic brace**  
Standard finish  
– GoldGalv®  
1650 lb load  
Safety factor 3  
Wt./C 61 lb

02 **C749N-5/8 Seismic brace**  
Standard finish  
– GoldGalv®  
1650 lb load  
Safety factor 3  
Wt./C 56 lb

03 **C749N-7/8 Seismic brace**  
Standard finish  
– GoldGalv®  
1650 lb load  
Safety factor 3  
Wt./C 74 lb

04 **C749N-1 1/8 Seismic brace**  
Standard finish  
– GoldGalv®  
1650 lb load  
safety factor 3  
Wt./C 72 lb

05 **ES142**  
Standard finish  
– GoldGalv®

Cat. no.	Bolt dia.	Wt./C lb
ES-142-1/2 x 1-1/2	1/2	21

Seismic bracing rod  
stiffener connector.  
Wt./C 21 lb

All dimensions shown are in in.

All braces have  
plastisol coating  
on the flat member.  
Plastisol insulates  
against vibration noise  
transmission and  
eliminates rattle at  
the connection points.